

Type ANE Automotive / Marine Limiter Fast Acting



www.optifuse.com (619) 593-5050

Specifications:

- **Voltage Rating:** 125 VAC, 32 VDC
- **Amperage Rating:** 40A, 50A, 60A, 80A, 100A, 125A, 130A, 150A, 175A, 180A, 200A, 225A, 250A, 275A, 300A, 325A, 350A, 400A

- **Interrupt Ratings:**
1000A @ 32VDC
1500A @ 125VAC

Time Characteristics	
% of Rated Current	Clearing Time
100%	Min 4h
250%	Max 300s

- **Construction:**
Body Material: FR4
Terminals: Gold-plated Copper

Recommended Mounting:

- Optifuse Fuse Block BLC-09 to 200A
- Optifuse Fuse Block BLC-209 to 800A

Mechanical Dimensions: Inches [mm]

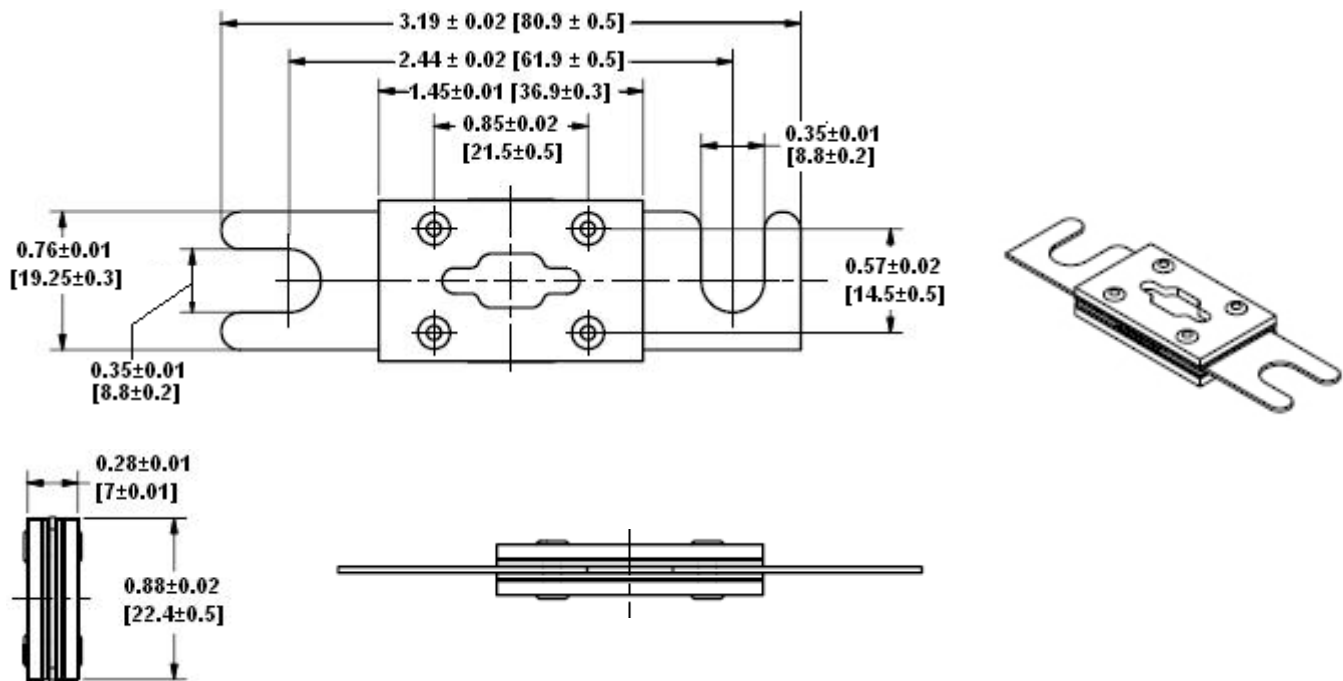

	<p>Warning: -Operation beyond the specified maximum ratings or improper use may result in damage and possible electrical arcing and/or flame.</p>
	<p>-Avoid contact of device with chemical solvent. Prolonged contact may damage the device performance.</p>

Type ANE
Automotive / Marine Limiter
Fast Acting



www.optifuse.com

(619) 593-5050

TIME CURRENT CURVE GRAPH

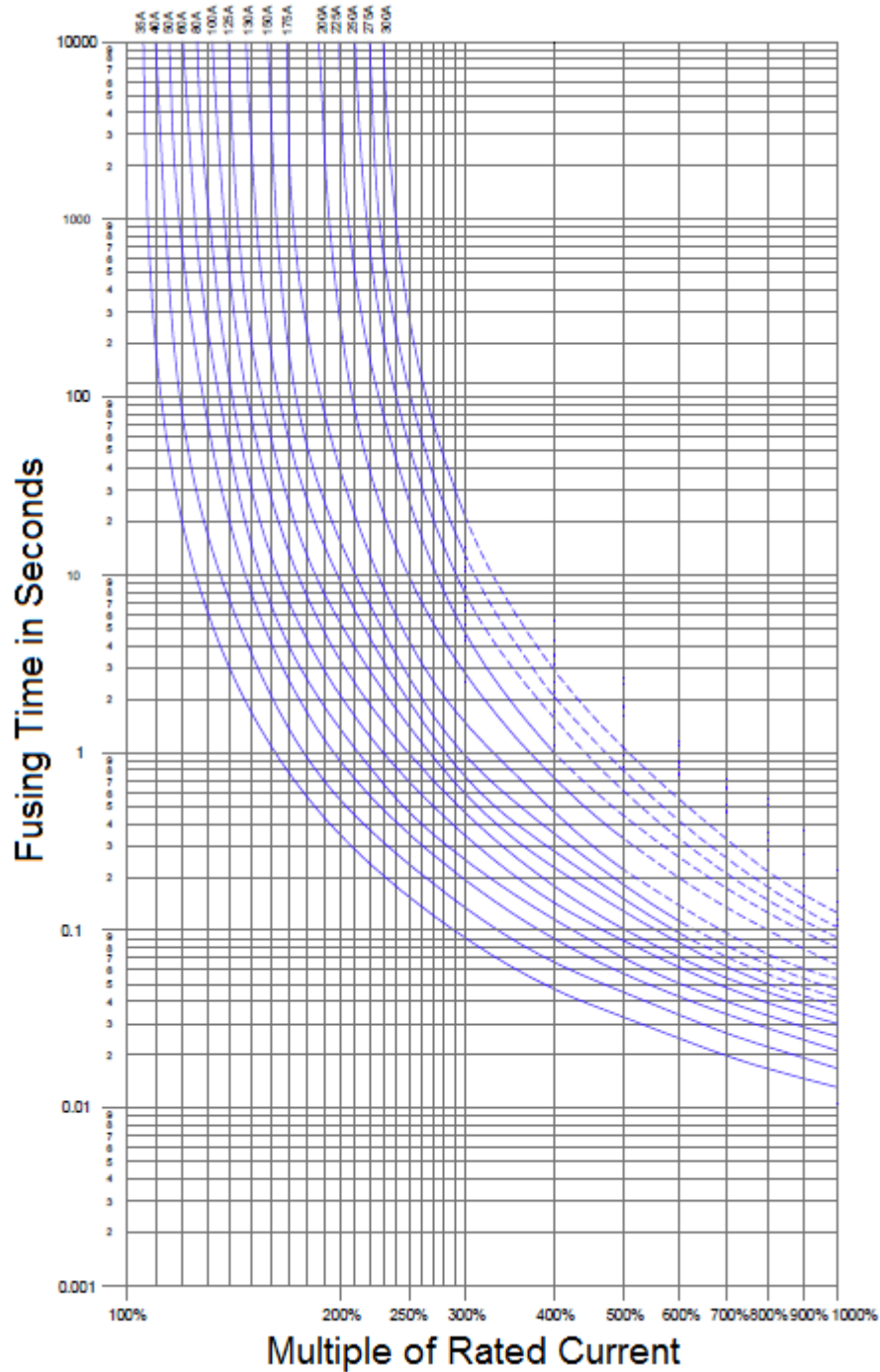

X-ON Electronics

Largest Supplier of Electrical and Electronic Components

Click to view similar products for [Automotive Fuses](#) category:

Click to view products by [Optifuse](#) manufacturer:

Other Similar products are found below :

[HBO-10](#) [HBO-100](#) [HBO-150](#) [HBO-40](#) [HBO-50](#) [AFX-150](#) [AT-10](#) [AT-30](#) [AT-5](#) [ATM-10ID](#) [ATM-4LP](#) [ACL-50](#) [AFX-50](#) [299080](#) [HBO-15](#)
[AT-20](#) [AT-3](#) [0287015](#) [142.7010.5502](#) [FMM-15](#) [0MIN015.HXGLO](#) [0695030.PXPS](#) [0695040.PXPS](#) [0297003.WXT](#) [0MIN025.HXGLO](#)
[0MIN030.HXGLO](#) [0695025.PXPS](#) [0695015.PXPS](#) [0695050.PXPS](#) [0695060.PXPS](#) [MRBF-075](#) [0200300](#) [02400106P](#) [0297002.WXT](#)
[0297004.WXT](#) [0297010.WXT](#) [0297015.WXT](#) [0297020.WXT](#) [0297025.WXT](#) [0297030.WXT](#) [029707.5WXT](#) [0602925](#) [0602930](#) [0602935](#)
[0602940](#) [0602950](#) [0602960](#) [0611100](#) [0611125](#) [0611150](#)