

Type FSG-G
Automotive Glass Fuse
13/32" x 1-1/2" (10.3 x 38.1mm)



www.optifuse.com (619) 593-5050

Fuse Size: 13/32" x 1 1/2" (10.3 x 38.1mm)

Ampere Rating: 1A ~ 80A

Voltage Rating: 32V AC/DC

| Time Characteristics: | | | |
|------------------------------|------|------|------|
| Rated Current | 100% | 135% | 200% |
| | Min. | Max. | Max. |
| 1A – 30A | 4h | 1h | 120s |
| 35A-80A | 4h | 1h | |

Interrupt Rating: 1000A, 32 VDC

Terminals: Gold plated

Specifications according to UL 248-1, 14

Mechanical Dimensions: Inches[mm]

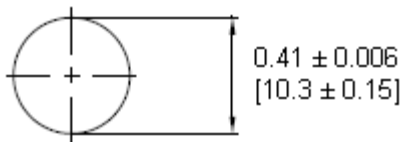
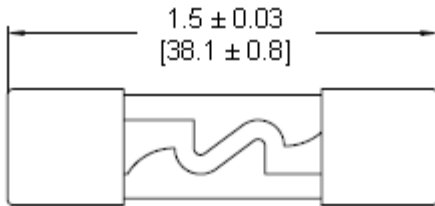

| Part Number | Ampere Rating | Voltage Rating |
|--------------------|----------------------|-----------------------|
| FSG-G-1A | 1A | 32V AC/DC |
| FSG-G-2A | 2A | |
| FSG-G-3A | 3A | |
| FSG-G-4A | 4A | |
| FSG-G-5A | 5A | |
| FSG-G-8A | 8A | |
| FSG-G-10A | 10A | |
| FSG-G-15A | 15A | |
| FSG-G-20A | 20A | |
| FSG-G-25A | 25A | |
| FSG-G-30A | 30A | |
| FSG-G-35A | 35A | |
| FSG-G-40A | 40A | |
| FSG-G-50A | 50A | |
| FSG-G-60A | 60A | |
| FSG-G-70A | 70A | |
| FSG-G-80A | 80A | |

| | |
|--|---|
| | Warning: -Operation beyond the specified maximum ratings or improper use may result in damage and possible electrical arcing and/or flame. |
| | -Avoid contact of Fuse device with chemical solvent. Prolonged contact may damage the device performance. |

X-ON Electronics

Largest Supplier of Electrical and Electronic Components

Click to view similar products for [Optifuse manufacturer](#):

Other Similar products are found below :

[FSC-3.5A](#) [TSA-250MA](#) [BLR-304](#) [BLR-504](#) [BLC-05-GTA](#) [BLR-I-504](#) [BLM-304](#) [CBW57-EL4-10A](#) [FPK-10A](#) [FPK-1A](#) [FPK-30A](#) [LPM-08](#)
[LPX-23B-08R-LOOP](#) [FPK-12A](#) [FPK-15A](#) [FPK-20A](#) [FPK-25A](#) [FPK-2A](#) [FPK-3A](#) [FPK-4A](#) [FPK-5A](#) [FPK-6A](#) [FPK-7A](#) [FPK-8A](#) [FPK-R-](#)
[1.5A](#) [FPK-R-10A](#) [FPK-R-15A](#) [FPK-R-1A](#) [FPK-R-20A](#) [FPK-R-25A](#) [FPK-R-2A](#) [FPK-R-30A](#) [FPK-R-3A](#) [FPK-R-4A](#) [FPK-R-5A](#) [FPK-R-6A](#)
[FPK-R-8A](#) [LPM-01B-12R](#) [ACB-12-V-50A](#) [LPR-13C-10R](#) [ACBP4-PM-5A](#) [BLR-306](#) [ACB-12-V-30A](#) [CBW57-EL4-5A](#) [CBW57-ES-5A](#)
[CBW57-PB-10A-5X](#) [CBW57-PS-10A-5X](#) [CBW57-PS-3A-1X](#) [CBW28-1A](#) [FCD-4A](#)