

# Type LPM-05 Water-Proof In-Line Fuse Holder Automotive Mini. Blade Type



www.optifuse.com (619) 593-5050

**Specifications:**

- Rating:** 32VDC
- Body/Cap Material:** Polycarbonate
- Seal Material:** Silicon rubber
- Contacts:** Bronze, Tin/Nickel plated
- IP Rating:** IP67
- For use w/ Type APM, ANR Fuse (Miniature Automotive Blade)
- Water-proof with Inter-Locking Cap
- Attached Mounting Bracket
- Standard Wire:** #12, #14, #16 AWG – 12” Loop - Red Color  
(Other wire sizes and colors available as special order)

**Part number format**

**LPM-05B-##R**

Where

## = Wire Gauge (12,14,16 AWG)

Wire Gauge	Max. Amperage
12 AWG	30 A
14 AWG	20 A
16 AWG	15 A

**Mechanical Dimensions: Inches [mm]**

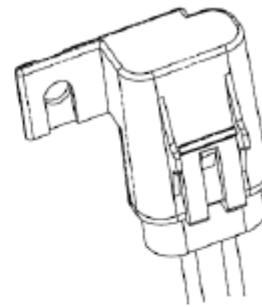
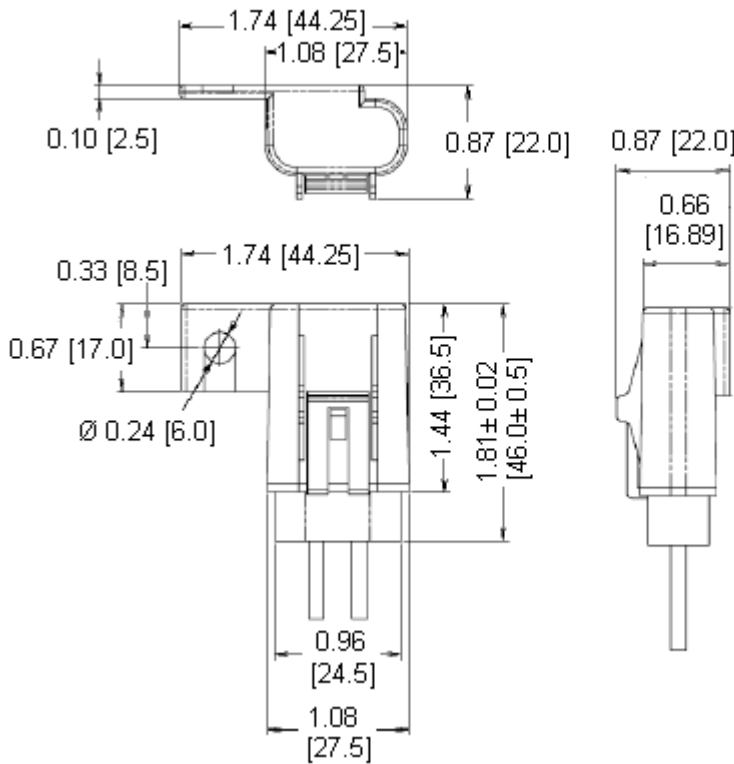

**Warning:**



- Operation beyond the specified maximum ratings or improper use may result in damage and possible electrical arcing and/or flame.
- Device are intended for occasional overcurrent protection. Application for repeated overcurrent condition and/or prolonged trip are not anticipated.
- Avoid contact of device with chemical solvent. Prolonged contact will damage the device performance.
- Not intended for submersible water applications.

## X-ON Electronics

Largest Supplier of Electrical and Electronic Components

*Click to view similar products for [Fuse Holder](#) category:*

*Click to view products by [Optifuse](#) manufacturer:*

Other Similar products are found below :

[570-290-741P40](#) [570-290-751P40](#) [020417G](#) [020418E](#) [6R30A1B](#) [F600A3B](#) [80910030](#) [8601.2020](#) [G15A2SPQ](#) [9-3557-GP REV A](#) [HDJ-B](#)  
[R6J30A3S](#) [HFH-1](#) [RF30A1S](#) [RF30A2B](#) [RF30A3SP](#) [15600-08-10](#) [BK/FHN19G](#) [BK/HHM](#) [BK/HKP-CCHH](#) [BK/HKP-JJ](#) [BK/HTJ-LES-](#)  
[FUSE](#) [HMG-241](#) [HTJ-LES-FUSE](#) [C4044-1](#) [2086-1](#) [2193](#) [2602](#) [2650](#) [178.000100](#) [FHN31G1](#) [T30A2B](#) [G4PB8](#) [2660](#) [2799](#) [CQ-209V](#) [HKP-](#)  
[CCHH](#) [R6F30A2S](#) [341001A](#) [345621A](#) [CVRMCC](#) [4202](#) [4407](#) [4408](#) [4413](#) [4423](#) [4532](#) [4537](#) [TSD1404-12](#) [BK/FHN31G1](#)