

ILLUMINATED VANDAL RESISTANT PUSHBUTTONS

LP5-V
ILLUMINATED
VANDAL RESISTANT
PUSHBUTTONS

ALTERNATE ACTION RING ILLUMINATED, METAL CASE & BUTTON



High Profile
Curved Button



The LP5-V series is an alternate action switch that has been designed to provide attractive, lighted position indication for applications in harsh environments, where security and reliability are paramount. The series features both aluminum and stainless steel cases watertight to IP68S. UL1500 ignition protected. Momentary action is available in the LP3-V series.

This high reliability switch offers the durability and ruggedness our customers have come to expect with the added benefit of illumination. Ideal for marine, off-highway and industrial control applications that require an illuminated switch.

This switch offers positive tactile feedback, less than 25mΩ contact resistance, and a variety of LED colors available in both flat and domed actuator bezel shapes.

Features:

- Security (aluminum) or vandal resistant (stainless steel) case & button
- Ring illuminated
- Watertight to IP68S
- Less than 25mΩ contact resistance
- Variety of button options and LED colors
- Drop in replacement to the P5-V series
- UL recognized & CSA certified
- RoHS/WEEE/Reach compliant

Standard Characteristics/Ratings:

ELECTRICAL RATINGS:

Load	Sea Level @ 28VDC or 115VAC, 60/400Hz
Resistive	5A
Inductive	3A
Lamp	1A
Motor	3A
DWV	1050Vrms through switch contacts only
Low Level	10mA @ 30mV
Electrical Life:	25,000 cycles

LIGHTING:

Light Source Voltage (DC)	Actual Voltage Nominal (DC)	Voltage Max (DC)
2	2	2.6
6	7	8
12	13.5	14.5
24	28	28.6

Mechanical Life:	200,000 cycles
Seal:	IP64 or IP68S
Operating Temp Range:	-40°C to +85°C
Operating Force:	3.0 lbs. +1.0/-0.5 lb.
Total Travel:	0.180 inches max
Overtravel:	0.012 inches min

MATERIALS:

Case:	Stainless steel or anodized aluminum alloy
Button:	Thermoplastic
Center Cap:	Stainless steel or aluminum
Terminals:	Standard and low level options available
Mounting Hardware:	Hex nut, lockwasher and panel seal gasket

LP5-V PART NUMBER CODE

Type	Case Style	Circuit Rating	Light Source Type* w/ Rev. Pol Protection	Seal Level	Case/Center Cap Color	Button Profile
A. Aluminum	1. 5/8-24 & Hex Nut	0. Indicator Light	A. 2V Red LED	2. Dusttight	1. Silver	1. High Profile Flat Button
V. Stainless	2. 5/8-24 & Knurl Nut	1. SPST/Std.	B. 2V Green LED	3. Watertight	2. Black**	2. High Profile Curved Button
	3. 5/8-24 W/D-Flat & Hex Nut	2. SPDT/Std.	C. 2V Amber LED			3. Low Profile Flat Button
	4. 5/8-24 W/D-Flat & Knurl Nut	3. SPST/Low Level	D. 6V Red LED			4. Low Profile Curved Button
	5. 3/4-20 & Hex Nut	4. SPDT/Low Level	E. 6V Green LED			5. Flush Profile Flat Button
	6. 3/4-20 & Knurl Nut		F. 6V Amber LED			
	7. 3/4-20 W/D-Flat & Hex Nut		G. 12V Red LED			
	8. 3/4-20 W/D-Flat & Knurl Nut		H. 12V Green LED			
			J. 12V Amber LED			
			K. 24V Red LED			
			L. 24V Green LED			
			M. 24V Amber LED			
			N. 2V Blue LED			
			P. 6V Blue LED			
			Q. 12V Blue LED			
			R. 24V Blue LED			
			S. 2V Deep Green			
			T. 6V Deep Green			
			U. 12V Deep Green			
			V. 24V Deep Green			

* For additional LED lighting options, contact factory.
** Only available on LP5-A styles.

ILLUMINATED VANDAL RESISTANT PUSHBUTTONS

ALTERNATE ACTION RING ILLUMINATED, STAINLESS STEEL CASE & BUTTON

High Profile Flat Button
Button Profile Style 1

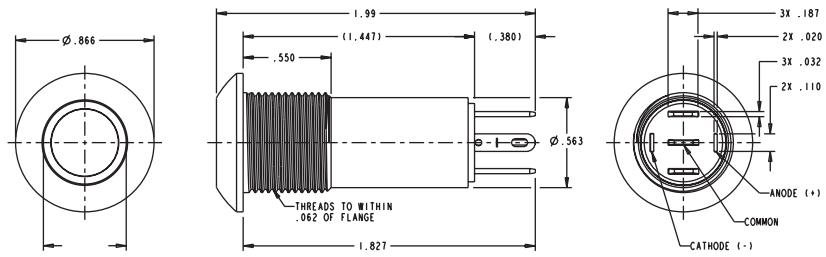
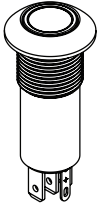

High Profile Curved Button
Button Profile Style 2

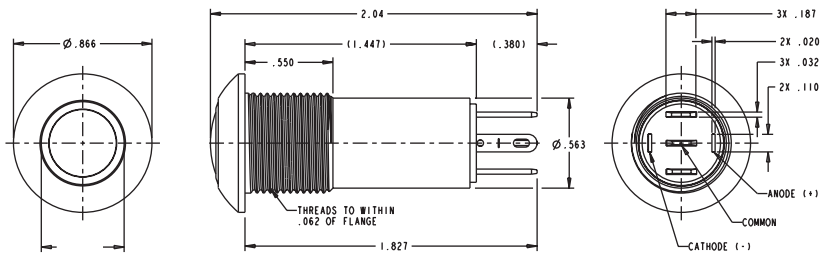
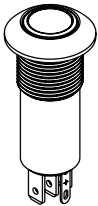

Low Profile Flat Button
Button Profile Style 3

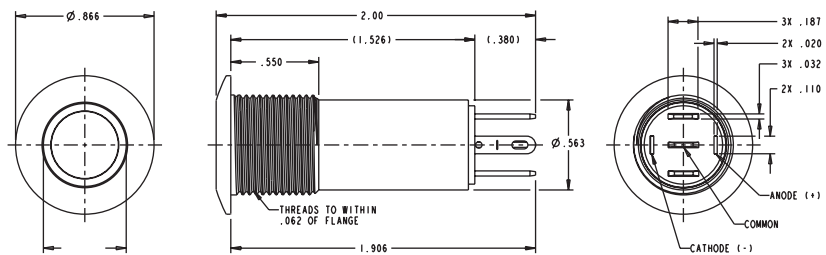
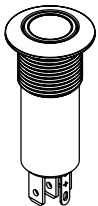

Low Profile Curved Button
Button Profile Style 4

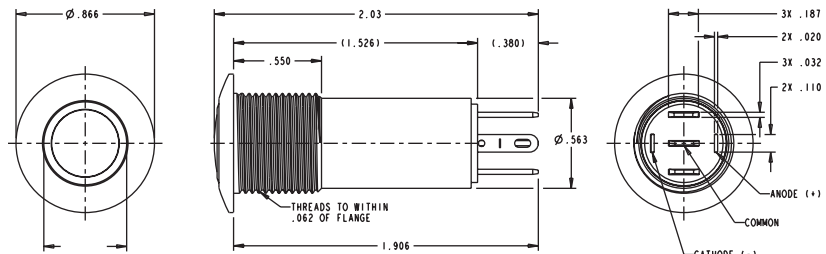
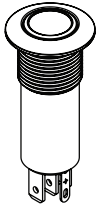

Flush Profile Flat Button
Button Profile Style 5

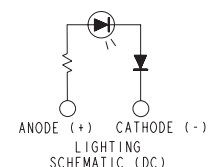
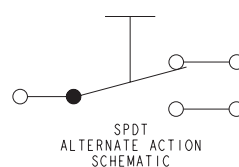
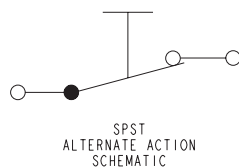
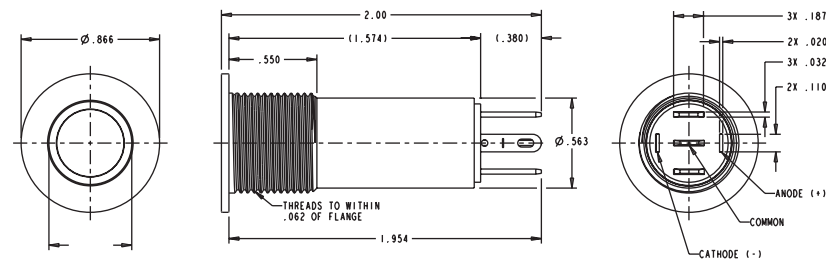
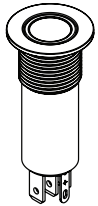

X-ON Electronics

Largest Supplier of Electrical and Electronic Components

Click to view similar products for [Pushbutton Switches](#) category:

Click to view products by [OTTO](#) manufacturer:

Other Similar products are found below :

[8940K2012](#) [LW1L-M1C10V-A](#) [LW1L-M1C70-A](#) [LW2L-A1C20M-GD](#) [LW2L-M1C20M-A](#) [60324L](#) [M22-D-R-GB0/K11](#) [M7E-HRN2](#)
[67021K512](#) [67081K512X](#) [701PB580](#) [7199K101](#) [810K12910](#) [810KSV30B](#) [MML21EA2ADK](#) [MML21KA3ABK](#) [MML23KA3AC05K-001](#)
[MML23KW3AA01W](#) [8418K2](#) [8442K3](#) [8450K1](#) [860K11911T01A](#) [861901](#) [861K11911T01A07](#) [861K13810T00A14](#) [861K13911](#)
[8646AB6X718UL](#) [8646ABUL](#) [9001KXRK](#) [907AYY100](#) [PMHD155A1](#) [9533CD4+U574+U4922](#) [95-414.000](#) [99-450.837](#) [99-453.837](#)
[PV3H2B0NN-341](#) [1203MRA](#) [A22NZBGANGA](#) [A22NZBNANGA](#) [A22NZMPATRA](#) [A2PMA1X03EC56](#) [A3A-5123-02](#) [A3A-7140](#) [A3A-7310](#) [A3A-7340](#) [A3U-TMW-A2C-5M](#) [A595](#) [12037A2ULCSA](#) [ABD122N-B](#) [1211390004](#)