

6LR61AD POWERLINE

IEC DIMENSIONS (MM)

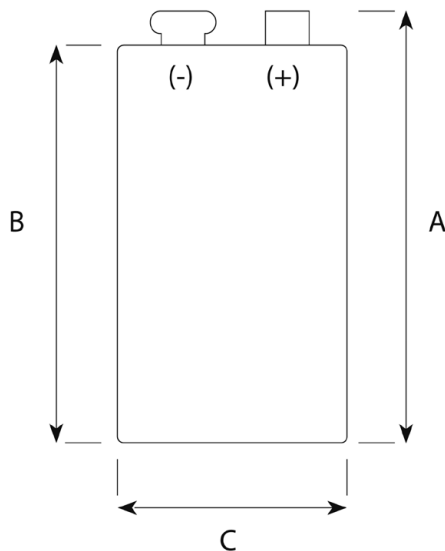
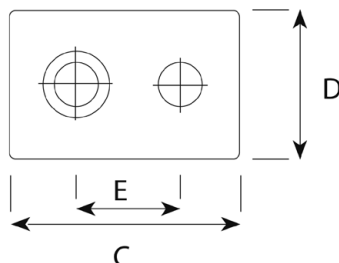

Dimensions	max. (mm)	min. (mm)
A	48.5	46.5
B	46.4	
C	26.5	24.5
D	17.5	15.5
E	12.95	12.45

SPECIFICATIONS

Name	9V / 6LR61 / 6AM6 / MN1604 / 1604A / 1604AC
Made in	Belgium
Type	Alkaline foil
Nominal voltage	9V
Electrolyte	Potassium Hydroxide
Average weight	44.3g
Storage temperature range	+10°C ~ +25°C
Operating temperature range	-20°C ~ +45°C
Average impedance	approx. 2.3Ω @ 1kHz AC
Heavy metals	No added mercury [Hg], Cadmium [Cd] or Lead [Pb]
Compliant with	IEC 60086 non dangerous goods regulation Nordic Ecolabel (White Swan) version 3.7 EC directive 91/157EC, 98/101EC, 2006/66/EC
Recommended cut-off voltage	4.8V per battery

6LR61AD POWERLINE

TYPICAL DISCHARGE VALUES

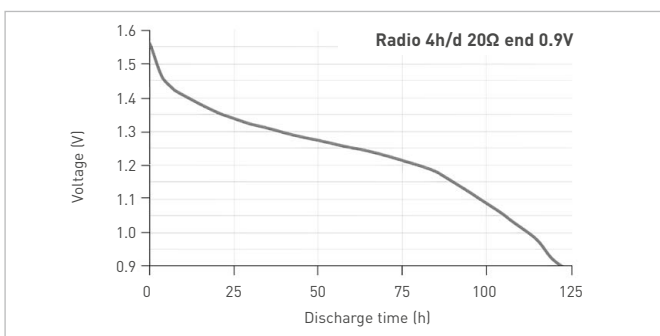
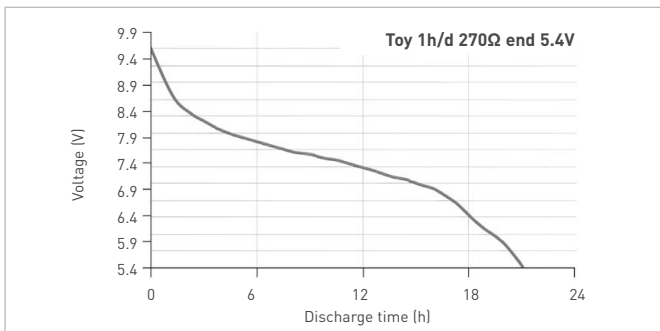
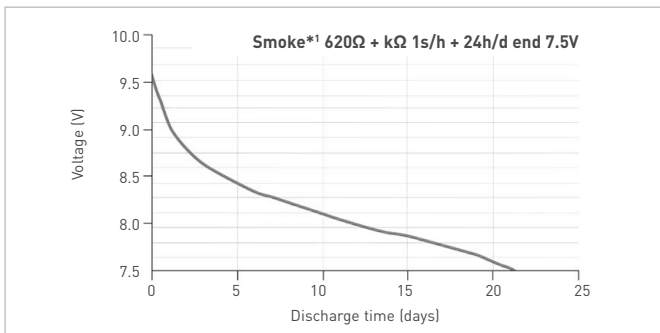
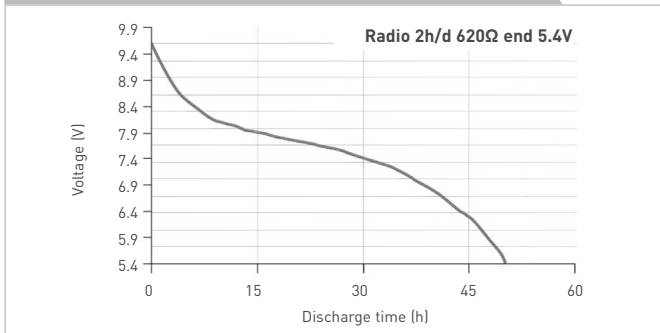

*1 Smoke detector.

DISCHARGE TEMPERATURE CHARACTERISTICS

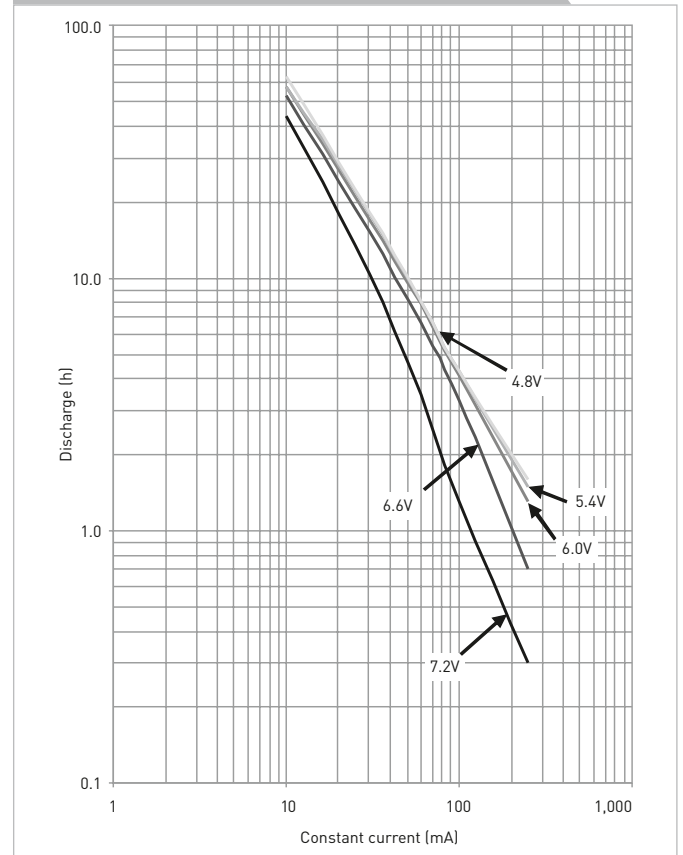

X-ON Electronics

Largest Supplier of Electrical and Electronic Components

Click to view similar products for [Control Switches](#) category:

Click to view products by [Panasonic](#) manufacturer:

Other Similar products are found below :

[80887-99](#) [80932-99](#) [86855-00](#) [88814-30](#) [1424293-1](#) [HW4S-2TC10](#) [89721-12](#) [89804-08](#) [SSN](#) [RL01801](#) [ASD2L20N-LVO](#) [50051857-17](#)
[50099156-001-05](#) [51.155R-15200](#) [50058920-26](#) [CP-FA51](#) [CP-FA49](#) [ACCU-SC/L-3000](#) [PP9M](#) [PP87G](#) [PP86GA](#) [PP71G](#) [PP70G](#) [PP6G](#)
[PP62G](#) [PP58BL](#) [PP56G](#) [PP86GB](#) [PP77GA](#) [PP76G](#) [PP4M](#) [PP47G](#) [PP46G](#) [PP41M](#) [PP40G](#) [PP32G](#) [RD-20](#) [PP23M](#) [PP12G](#) [PORTAPRO](#)
[POM-2708](#) [PNB-2005](#) [3057.0012](#) [CV-075](#) [CV-140SB](#) [CV-150](#) [CV-150S](#) [214X20XK](#) [CV-180](#) [CV-200MB](#)