

PICPAL36 – 3.7V / 1300 mAh

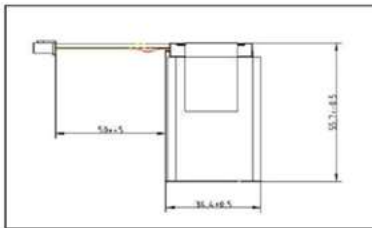

Dimensions

length: 35mm +1/-0,5mm

width: 6,5mm +1/-0,5mm (Swelling 1mm possible)

height: 55,7 +1mm/-0,5mm

Data for pack

Nominal Voltage	3,7V	3,0V – 4,2V	
Nominal capacity	1300mAh	typical	
Used cell in Pack	1x	Sanyo UF653450S	
internal resistance pack	150mOhm	100 - 180 mOhm	
Max charge voltage	4,2V		
Charge current	standard	1,250mA	
	rapid	1,250mA	
Discharge	standard	1,250mA	
	max.cont.	2,500mA	
	max.peak	2,750mA	
Short circuit current	≈20A	<500μs	
NTC	10 kOhm	Tolerance 5%; B-value 25°C/85°C = 3980K	
Connector	JST	XHP-3	Pin 1 : GND black
			Pin 2: NTC yellow
			Pin 3: +3,7V red
Cable length	50mm	±5mm	
Weight	27g	±2,5g	
Watt hour rating	4,625 Wh	acc. UN38.3	

Limitations by Safety Unit (SU)

over voltage	cut off	4,28V	±25mV
	release	4,08V	±100mV
under voltage	cut off	2,25V	±100mV
	release	3,0V	2,250V – 3,450V
Current limit 1 by SU		2,600mA	continuous (typical)
Current limit 2 by SU		>2,730mA	<150ms (typical)
Current limit 3 by SU		<14A	<4ms (typical)
Power consumption	active	12,5μA	-0/+7,5μA
	shutdown	1,5μA	-0/+1,0μA
ESD Protection		no	

X-ON Electronics

Largest Supplier of Electrical and Electronic Components

Click to view similar products for [Panasonic](#) manufacturer:

Other Similar products are found below :

[EVQ-21505R](#) [EET-HC2W151JA](#) [EET-HC2D102DA](#) [ABS1416509](#) [ECOS1EP332BA](#) [EVU-E2AF25D14](#) [ECQ-U2A393ML](#) [ECH-U1C223JB5](#) [ERG-2SJ683E](#) [LT4HL8-AC24V](#) [EVAL_PAN1555](#) [EVN-D8AA03B55](#) [EVP-BD6C1A000](#) [EVQ-PAC09K](#) [EVQ-PF003M](#) [EVQ-PNF04M](#) [EX-19B](#) [EXB-24N121JX](#) [EXB-2HV104JV](#) [MC-NA40-4](#) [EX-F61-PN-C5](#) [EZP-E1B306MTA](#) [MFECA0010WJD](#) [MFMCA0030AEB](#) [FCR-M50-AC208V](#) [FC-SF2N-A14](#) [MHMA102A1C](#) [FD-S9](#) [FP2-C2](#) [FP2-EM6](#) [FP2-MCU](#) [FP2-Y64P](#) [FPG-COM3](#) [FPG-PN4AN](#) [FTP-500](#) [FT-V23](#) [FT-Z30E](#) [FX-13P](#) [FX-AT4G1](#) [PM4HA-H-DC12V](#) [GK-05](#) [PM-R24-R](#) [GP-X10M](#) [GP-X8S](#) [GX-5SB](#) [GX-5SU](#) [GX-F12B-P-R](#) [GX-F15AI-C5](#) [GX-F6AI-C5](#) [GX-H15BI-C5](#)