

THIS COPY IS PROVIDED ON A RESTRICTED BASIS AND IS NOT TO BE USED IN ANY WAY DETRIMENTAL TO THE INTERESTS OF PANDUIT CORP.

PART#	COLOR	DESCRIPTION	WEIGHT*
CJS5E88TGY	BLACK	8 POSITION, 8 WIRE SHIELDED MODULE WITH INTEGRAL SHIELD. WIRE CAP LABEL IS COLOR CODED FOR T568A AND T568B WIRING SCHEMES.	3.715 LB/100 PCS (1685g/100 PCS)
CJS5E88TGRDY	RED		
CJS5E88TGBUY	BLUE		
CJS5E88TGGRY	GREEN		
CJS5E88TGVLY	VIOLET		
CJS5E88TGWHY	WHITE		
CJS5E88TGYLY	YELLOW		

\*WEIGHT IS APPROXIMATE

NOTES:

1. RED WIRE CAP DESIGNATES CATEGORY 5E PERFORMANCE.
2. MATERIAL:  
MODULE HOUSING-ABS  
SHIELD-TIN PLATED OVER PHOS. BRONZE  
WIRE CAP/CLIP - ZINC AND PC
3. ALL TX5e,6 AND 6A 8 POSITION, 8 WIRE JACK MODULES ARE UNIVERSAL IN DESIGN. THEY ACCEPT SIX AND EIGHT POSITION MODULAR PLUGS WITHOUT DAMAGE.
4. DIMENSIONS IN PARENTHESES ARE IN METRIC.
5. .187 x .010" GROUNDING TAB PROVIDED AS OPTIONAL CONDUCTIVE PATH FOR GROUNDING.

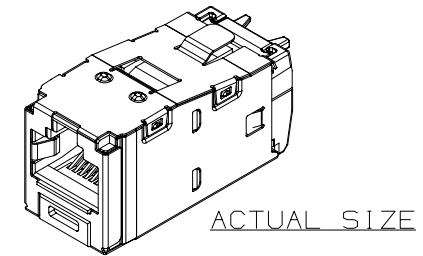
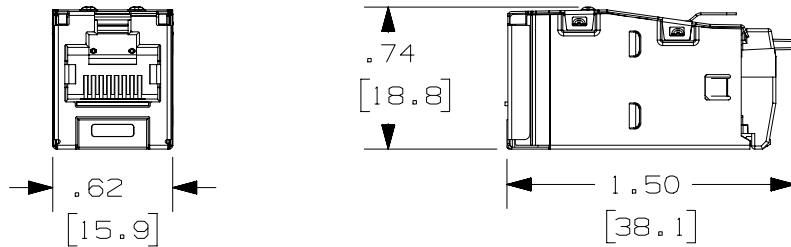
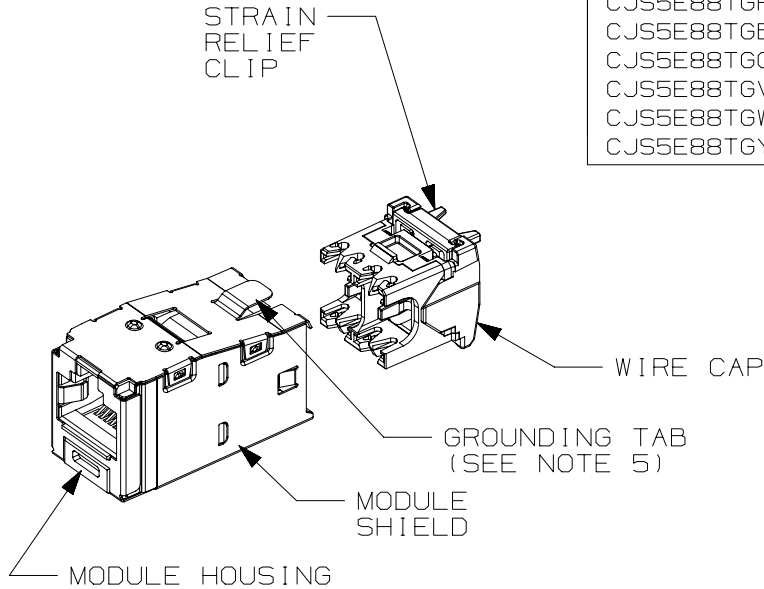

PART NUMBER		CJS5E88TG**Y	
TITLE		TX5E SHIELDED JACK MODULE	
		CUSTOMER DRAWING	
ITEM REVISION NAME		M02479NR/06	
DATASET FILE NAME		M02479NR_DC356/06C	
UNLESS OTHERWISE SPECIFIED, DIMENSIONAL TOLERANCES ARE: IN [mm]		MATERIAL:	
.x ± .xx ± .03 (.8)		.xxx ± .010 (.3)	
ANGLES ±		SEE NOTE 2	
THIRD ANGLE PROJECTION		DRAWING NUMBER:	
02479-356		02479-356	
DRAWN BY	DATE	CHK	SCALE
AFW	3-11-06	CEF	FULL
SHT 1 OF 1		A	

REV	DATE	BY	CHK	APR	DESCRIPTION	ECN
8	4-26-18	BJN	BSN	TMBA	UPDATED WEIGHT ALIGNED METRIC DIMENSIONAL EQUIVALENTS	02479-356
7	4-12-18	BJN	MDJR	TMBA	ADDED WHITE TO COLOR OPTIONS	02479-356
6	2-15-17	ROJC	NAGL	TMBA	MODEL REVISION UPDATED REMOVED PREVIOUS REVISIONS FOR CLARITY	02479-356

D10100DA/14

## X-ON Electronics

Largest Supplier of Electrical and Electronic Components

*Click to view similar products for [Modular Connectors / Ethernet Connectors](#) category:*

*Click to view products by [Panduit](#) manufacturer:*

Other Similar products are found below :

[8949-H88/06BLKA/SN](#) [74441-0010/BKN](#) [MP1010RX-1000](#) [MP44RX-1000](#) [PHP-6P6C-5](#) [GAX-3-66](#) [GAX-8-62](#) [GDCX-PA-66-50](#) [GDCX-PN-64](#) [GDCX-PN-66](#) [GDCX-PN-66-50](#) [GDLX-A-66](#) [GDLX-N-66](#) [GDLX-S-66](#) [GDLX-S-88K](#) [GDTX-S-88-50](#) [GDX-PA-1010](#) [GLX-N-1010M-BLK](#) [GLX-S-88M-BLK](#) [GMX-N-1010](#) [GMX-S-1010](#) [GMX-S-66](#) [GMX-SMT4-N-88](#) [GPX-2-64](#) [GSGX-N-2-88](#) [GSGX-N-4-88](#) [GSX-NS2-88-3.05](#) [GSX-NS2-88-3.05-50](#) [GSX-NS-88-3.05-50](#) [PT-108A-8C-UL](#) [PT-J951-8C](#) [PTS-J531-8CS-50UL](#) [1-1775629-2](#) [A-2014-0-4](#) [GWLX-S-88-GR](#) [GWLX-S9-88-YG](#) [DC-1021-8-WH-6](#) [1300530003](#) [1324640-4](#) [RJ11FTVC2G](#) [RJ11FTVC2N](#) [RJFTVX2SA1G](#) [132764-001](#) [1413235](#) [MP88X-1000](#) [MPS88RX-5000](#) [E5288-S000K3-L](#) [E5908-15A242-L](#) [155302-001](#) [AX100653](#)