

THIS COPY IS PROVIDED ON A RESTRICTED BASIS AND IS NOT TO BE USED IN ANY WAY DETRIMENTAL TO THE INTERESTS OF PANDUIT CORP.

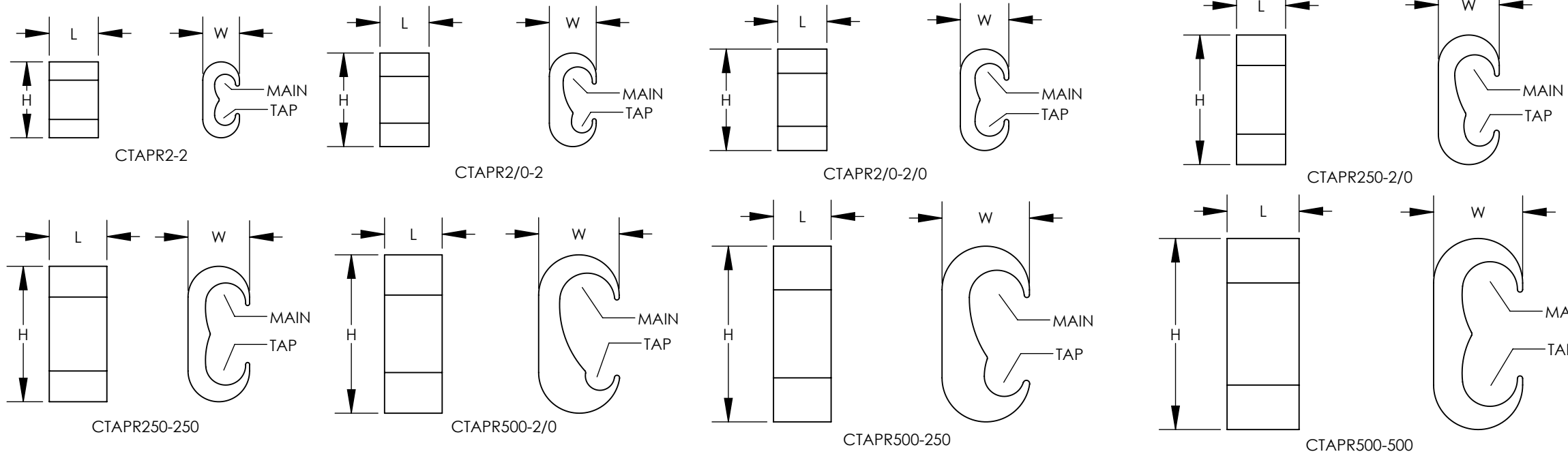

NOTES:

1. MATERIAL: HIGH CONDUCTIVITY COPPER
2. PRE-APPLIED ANTI-OXIDANT COMPOUND ENSURES A HIGH QUALITY MECHANICAL AND ELECTRICAL BOND, SPEEDING INSTALLATION.
3. UL LISTED PER 486A/B FOR WIRE TO WIRE POWER CONNECTOR APPLICATIONS UP TO 35KV.
4. UL TEMPERATURE RATING 90° C.
5. UL LISTED PER UL467 FOR GROUNDING AND BONDING AND SUITABLE FOR DIRECT BURIAL IN EARTH OR CONCRETE FOR WIRE TO WIRE AND WIRE TO GROUND ROD APPLICATIONS.
6. CTAPR FOR USE WITH GROUND RODS ARE cULus LISTED PER UL 467 FOR GROUNDING ONLY.

7. PACKAGING QTY CODES:

-6 = 6
-X = 10



DB
RATED

WIRE CONNECTOR
GROUND CONNECTOR

PART NUMBER	MAIN (AWG)		TAP (AWG)	MAIN (METRIC)		TAP (METRIC)	DIMENSIONS - IN [mm]			CRIMP TOOLS		
	COPPER CONDUCTOR RANGE	ROD DIAMETER	COPPER CONDUCTOR RANGE	COPPER CONDUCTOR RANGE	ROD DIAMETER	COPPER CONDUCTOR RANGE	L ± .05 [1.3]	W ± .06 [1.5]	H ± .04 [1.0]	12-TON* CT-920, CT-920CH, CT-2920, CT-2931	14-TON** CT-930, CT-930CH, CT-2930	15-TON*** CT-940CH/BJO, CT-2940, CT-2940/L, CT-2940/LE
CTAPR2-2-X	6 STR - 2 STR 6 SOL - 1 SOL	1/4" COPPER GROUND ROD	6 STR - 2 STR 6 SOL - 1 SOL	16mm ² - 25mm ² 16mm ² SOL - 35mm ² SOL	6.4mm COPPER GROUND ROD	16mm ² - 25mm ² 16mm ² SOL - 35mm ² SOL	0.75 [19.1]	0.56 [14.2]	1.16 [29.5]	CRIMP DIE (DIE INDEX) (# OF CRIMPS) CD-920-C (PC) (1)		
CTAPR2/0-2-X	1 STR - 2/0 STR	3/8" COPPER CLAD GROUND ROD	6 STR - 2 STR 6 SOL - 1 SOL	50mm ²	9.0mm COPPER CLAD GROUND ROD	16mm ² - 25mm ² 16mm ² SOL - 35mm ² SOL	0.75 [19.1]	0.72 [18.2]	1.43 [36.3]	CD-920-O (PO) (1)		
CTAPR2/0-2/0-X	1 STR - 2/0 STR	3/8" COPPER CLAD GROUND ROD	1 STR - 2/0 STR	50mm ²	9.0mm COPPER CLAD GROUND ROD	50mm ²	0.75 [19.1]	0.74 [18.8]	1.55 [39.4]	CD-920-O (PO) (1)		
CTAPR250-2/0-6	3/0 STR - 250 kcmil	1/2" - 5/8" COPPER CLAD GROUND ROD	6 STR - 2/0 STR 6 SOL - 3/0 SOL	95 mm ² - 120 mm ²	12.8mm - 14.2mm COPPER CLAD GROUND ROD	16mm ² - 50mm ² 16mm ² SOL - 70mm ² SOL	0.75 [19.1]	0.93 [23.6]	1.98 [50.3]	CD-930G-250 (PG25) (1)		
CTAPR250-250-6	3/0 STR - 250 kcmil	1/2" - 5/8" COPPER CLAD GROUND ROD	3/0 STR - 250 kcmil	95 mm ² - 120 mm ²	12.8mm - 14.2mm COPPER CLAD GROUND ROD	95 mm ² - 120 mm ²	0.88 [22.4]	0.94 [23.9]	2.07 [52.6]	CD-930G-250 (PG25) (1)		
CTAPR500-2/0-6	300 kcmil - 500 kcmil	3/4" COPPER CLAD GROUND ROD	6 STR - 2/0 STR 6 SOL - 3/0 SOL	185 mm ² - 240 mm ²	17.2mm COPPER CLAD GROUND ROD	16mm ² - 50mm ² 16mm ² SOL - 70mm ² SOL	0.88 [22.4]	1.23 [31.2]	2.42 [61.5]	CD-920C-500 (P500) (2)		
CTAPR500-250-6	300 kcmil - 500 kcmil	-----	3/0 STR - 250 kcmil	185 mm ² - 240 mm ²	-----	95 mm ² - 120 mm ²	0.88 [22.4]	1.34 [33.9]	2.69 [68.2]	CD-920C-500 (P500) (2)		
CTAPR500-500-6	300 kcmil - 500 kcmil	-----	300 kcmil - 500 kcmil	185 mm ² - 240 mm ²	-----	185 mm ² - 240 mm ²	1.10 [27.9]	1.36 [34.5]	2.92 [74.2]	CD-920C-500 (P500) (3)		

* CTAPR500-500 AND CTAPR500-250 CANNOT BE INSTALLED WITH A CT-2920, WHEN INSTALLING CTAPR CONNECTORS WITH THE CT-920CH, USE BLACKFIN TOOL ONLY

** CTAPR500-500 CANNOT BE INSTALLED WITH A CT-930CH OR CT-930

*** CD-920 DIES CAN BE USED WITH THE CT-940CH AND CT-2940 TOOLS WITH THE APPROPRIATE DIE ADAPTERS

							TITLE CTAPR COPPER COMPRESSION CONNECTORS CUSTOMER DRAWING		
							ITEM REVISION NAME 00320EBU/01		
							DATASET FILE NAME 00320EBU-DC/01.SLDDRW		
							UNLESS OTHERWISE SPECIFIED, DIMENSIONAL TOLERANCES ARE: IN [mm]		
							.X ± .XXX ± .XX ± ANGLES ±		
01	7/19	JHNU	BKR	RGB	REVISED TOLERANCES: L ±.05, W ±.06, H ±.04 WAS ALL DIMENSIONS ±.04		00320EBU-DC		
00	3/19	JHNU	BKR	RGB	DRAWING RELEASED		00320EBU-DC		
REV	DATE	BY	CHK	APR	DESCRIPTION		ECN		
							DRAWN BY JHNU		
							DATE 3/19		
							CHK BKR		
							SCALE FULL		
							THIRD ANGLE PROJECTION		
							DRAWING NUMBER 00320EBU-DC		
							SHEET 1 OF 1		
							SIZE B		

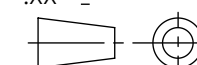

X-ON Electronics

Largest Supplier of Electrical and Electronic Components

Click to view similar products for [Terminals](#) category:

Click to view products by [Panduit](#) manufacturer:

Other Similar products are found below :

[HT-13-10](#) [71M-250-32-NB](#) [01-2065-1-0216](#) [00581P0075](#) [M10-10RX](#) [M10BCK](#) [60205-1](#) [604200-1](#) [60598-1-CUT-TAPE](#) [60617-1-C](#) [60873-1](#) [M14-516R/SK](#) [M14-6RSX](#) [M18-10FLX](#) [M18-8FBX](#) [M18-8R/LX](#) [M18BCK](#) [61314-6-C](#) [61-S](#) [61-SN](#) [61-SN-A](#) [62-NBM-A](#) [62-SN](#) [62-SP](#) [63-S](#) [640179-1](#) [640917-2-CUT-TAPE](#) [6501550002](#) [66107-2-C](#) [66107-4-C](#) [696683-1](#) [696834-1](#) [696861-1](#) [696931-1](#) [696999-1](#) [M8-516RK](#) [M86700006](#) [MA250DMFMX-A](#) [701-2007](#) [701-2307](#) [701-7761-03](#) [70F-110-32-PB](#) [718-N-A](#) [71M-187-20-NBL](#) [71M-250-32-NBL](#) [72F-187-20-NBL](#) [72M-250-32-NBL](#) [7310](#) [73F-250-32](#) [73F-250-32-NBL](#)