

PART NUMBER	TAB SIZE	WIRE RANGE AWG	DIMENSIONS in.		
			A $\pm .015$	B $\pm .010$	C $\pm .010$
D18-250B	.250 X .032 (6.4 X 0.8)	22-18	.63 (16.0)	.30 (7.6)	.12 (3.0)
D14-250B	.250 X .032 (6.4 X 0.8)	16-14	.63 (16.0)	.30 (7.6)	.12 (3.0)

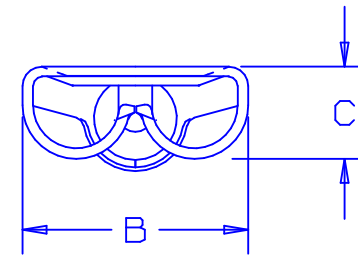

NOTES:

- USED FOR:
A. STRANDED COPPER WIRE ONLY
B. 302°F (150°C) MAX TEMP RATING
- PACKAGE QTY:
A. STD: C=100
B. BULK: M=1000
- MATERIAL:
A. STAMPING: .016 (0.41) THK BRASS, TIN PLATED
- WIRE STRIP LENGTH $9/32 \begin{matrix} +1/32 \\ -0 \end{matrix}$ ($7.1 \begin{matrix} +0.8 \\ -0 \end{matrix}$)
- FIRST INSERTION FORCE: 12 LB (53N) MAX
FIRST WITHDRAWAL FORCE: 12 LB (53N) MAX
6 LB (27N) MIN
- INSTALLATION TOOLS:
A. CT-100 (POCKET B)
- DIMENSIONS IN BRACKETS ARE IN MILLIMETERS OR mm²

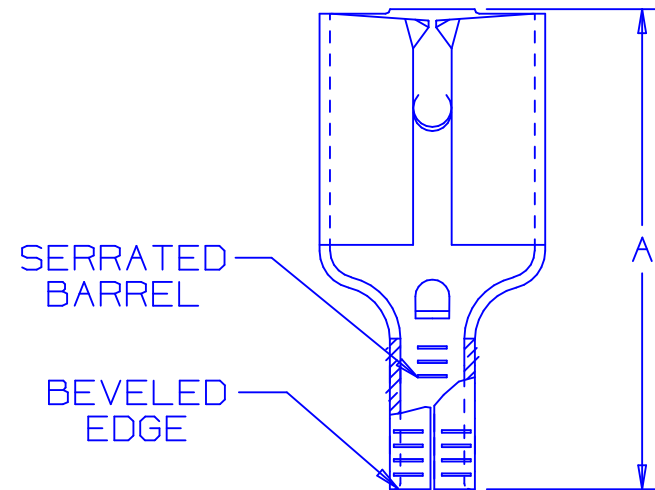

CERTIFIED
LR31212

A41209_07

07	7/03	KLFU		ADDED INTERNAL SERRATIONS			
06	1/01	KMDSKB		CAD FILE SPEC. WAS N41209AA_PCD_05	8938	JAC	CCH
05	6-95	MS		UPDATED NOTES AND DIMENSIONS	03372		
04	8-88	DW	MC	REDRAWN WITH REVISIONS			JRB
REV	DATE	BY	CHK	DESCRIPTION	ECN#	CUST	PM

PANDUIT

CORP.

TINLEY PARK, ILLINOIS

NON-INSULATED FEMALE DISCONNECT
(BUTTED SEAM)

DRAWN BY
DAW

CHK'D

SCALE
NONE

DRAWING NO.
A41209

X-ON Electronics

Largest Supplier of Electrical and Electronic Components

Click to view similar products for [Terminals](#) category:

Click to view products by [Panduit](#) manufacturer:

Other Similar products are found below :

[HT-13-10](#) [71M-250-32-NB](#) [01-2065-1-0216](#) [00581P0075](#) [M10-10RX](#) [M10BCK](#) [60205-1](#) [604200-1](#) [60598-1-CUT-TAPE](#) [60617-1-C](#) [60873-1](#) [M14-516R/SK](#) [M14-6RSX](#) [M18-8FBX](#) [M18-8R/LX](#) [M18BCK](#) [61314-6-C](#) [61-S](#) [61-SN-A](#) [62-NBM-A](#) [63-S](#) [640179-1](#) [640917-2-CUT-TAPE](#) [6501550002](#) [66107-2-C](#) [696683-1](#) [696834-1](#) [696861-1](#) [696931-1](#) [696999-1](#) [M8-516RK](#) [M86700006](#) [MA250DMFMX-A](#) [701-2007](#) [701-2307](#) [701-7761-03](#) [70F-110-32-PB](#) [718-N-A](#) [71M-187-20-NBL](#) [71M-250-32-NBL](#) [72F-187-20-NBL](#) [72M-250-32-NBL](#) [7310](#) [73F-250-32](#) [73F-250-32-NL](#) [F14-10C](#) [F-1M](#) [751-250](#) [76650-5002](#) [76828-149](#)