

THIS COPY IS PROVIDED ON A RESTRICTED BASIS AND IS NOT TO BE USED IN ANY WAY DETRIMENTAL TO THE INTERESTS OF PANDUIT CORP.

PANDUIT P/N	WEIGHT (APPROX.)
DPKR48688TG	2.40 LB (1088.6 g)

NOTES:

- SEE CURRENT CATALOG FOR VARIOUS APPLICATIONS AS WELL AS OPTIONAL ICONS.
- KIT INCLUDES THE FOLLOWING:
 - 1 - LABEL SET 1-24
 - 1 - LABEL SET 25-48
 - 1 - BLANK LABEL
 - 9 - LABEL HOLDERS
 - 1 - STRAIN RELIEF BAR
 - 1 - DP6 PLUS 48 PORT PATCH PANEL
 - 8 - 12-24 X 1/2" ROUND HEAD SCREWS
- MATERIAL:
 - PANEL HOUSING: STEEL
 - RJ45 MODULE: THERMOPLASTIC RESIN UL94V-0
 - PUNCHDOWN BLOCKS: THERMOPLASTIC RESIN UL94V-0
 - BEZEL ASSEMBLY: THERMOPLASTIC RESIN UL94H-B
 - RETENTION CAP: THERMOPLASTIC RESIN UL94V-0
 - STRAIN RELIEF BAR: STEEL BAR STOCK
 - LABEL: VINYL
 - LABEL HOLDER: CLEAR VINYL
- 48 PORT PATCH PANEL 8 POSITION 8 WIRE.
- THE PATCH PANEL AND STRAIN RELIEF BAR ARE DESIGNED FOR MOUNTING TO 19" UNIVERSAL RACKS.
- DIMENSIONS IN PARENTHESES ARE IN METRIC.
- USE 110 STYLE TERMINATION TOOL FOR PUNCHDOWN.
- RETENTION CAPS (ONE PER CONNECTOR) PROVIDED FOR SNAP-IN ON TERMINATED CONNECTORS.

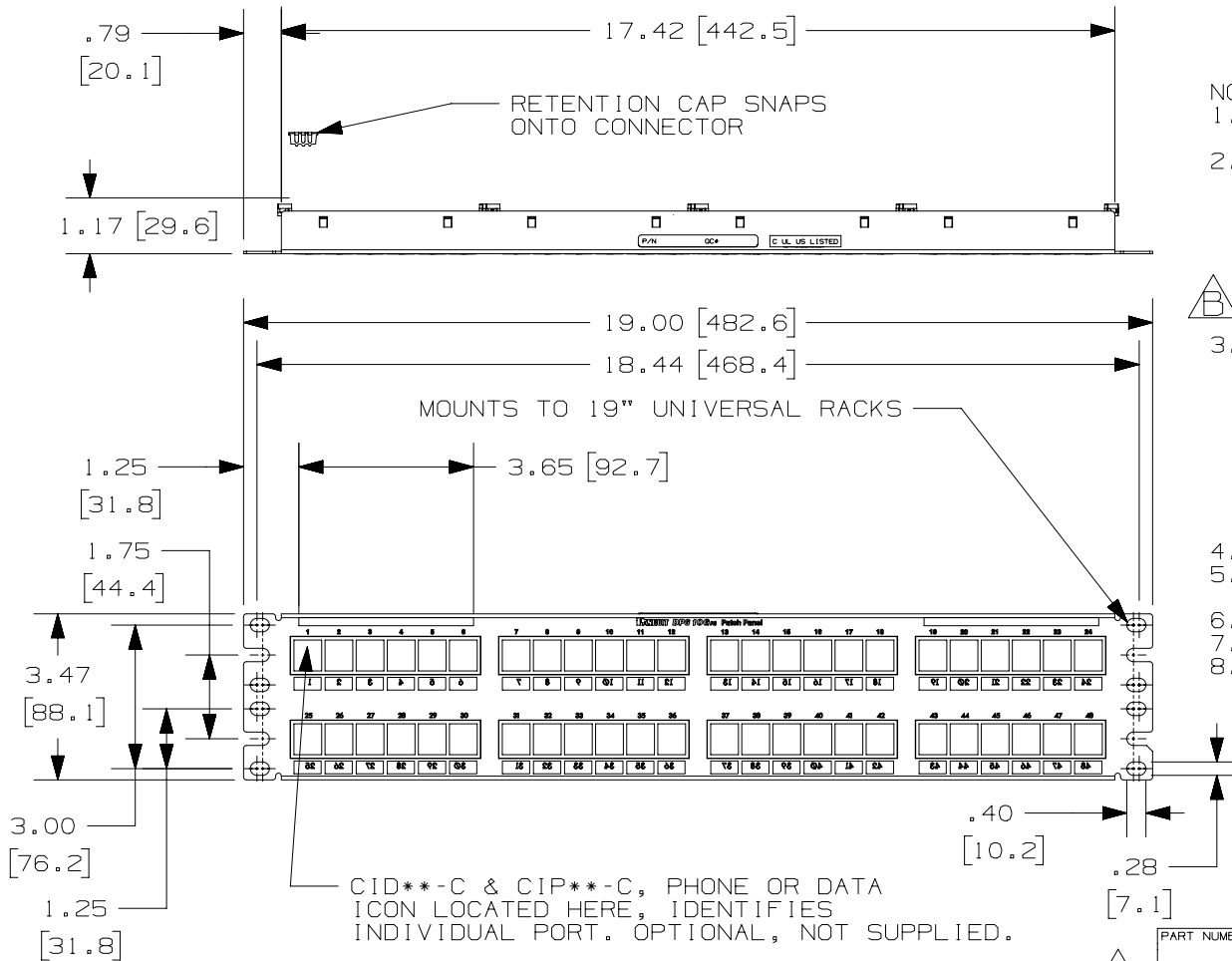
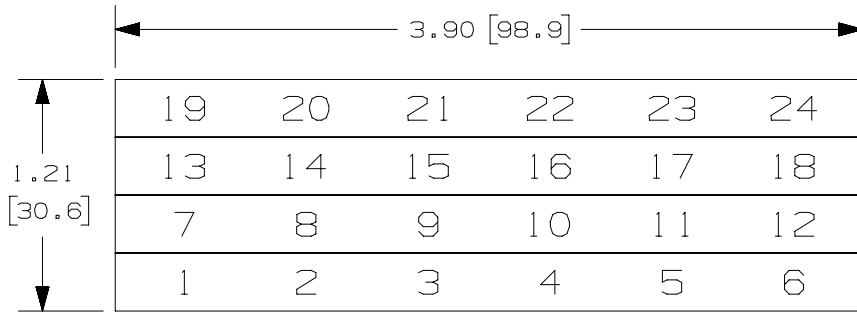

FIGURE 1
DP6 PLUS 48 PORT PATCH PANEL

PART NUMBER		DPKR48688TG	
TITLE			
DP6 PLUS 48 PORT PATCH PANEL WITH STRAIN RELIEF BAR AND LABEL KIT			
CUSTOMER DRAWING			
ITEM REVISION NAME		M01537E0/02	
DATASET FILE NAME		M01537E0_DC54/02A	
UNLESS OTHERWISE SPECIFIED, DIMENSIONAL TOLERANCES ARE: IN [mm]		MATERIAL:	
.x ± .03 (.8)		SEE NOTE 3	
.xxx ± .010 (.3)		DRAWING NUMBER:	
ANGLES ±		01537-54	
THIRD ANGLE PROJECTION		SHT 1 OF 2	
DRAWN BY	DATE	CHK	SCALE
BJN	11/26/07	RJDU	NONE
REV	DATE	BY	CHK
2	11/15/18	BAME	KRKE
1	6/02/14	MDJR	REFR
R	11/26/07	BJN	RJDU
APR		VMB	
DESCRIPTION		ECN	
B. REMOVED METRIC MOUNTING SCREWS		01537-54	
A. UPDATED TITLE BLOCKS.		01537-54	
RELEASED TO PRODUCTION		01537-54	

D10100DA/14

THIS COPY IS PROVIDED ON A RESTRICTED BASIS AND IS NOT TO BE USED IN ANY WAY DETRIMENTAL TO THE INTERESTS OF PANDUIT CORP.



LABEL SET 1 - 24

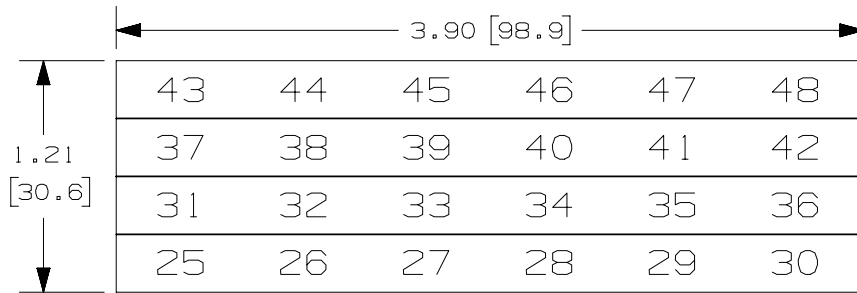

LABEL SET 25 - 48

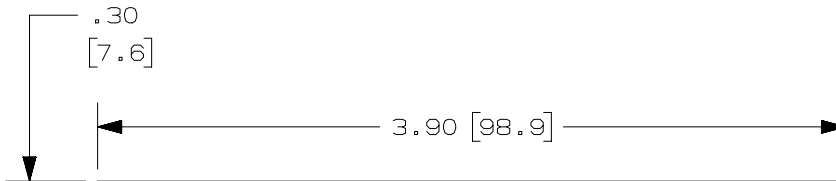

BLANK LABEL

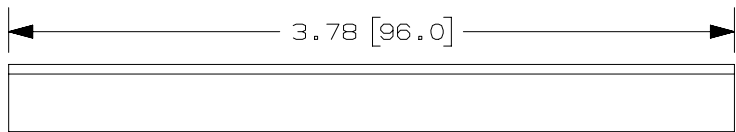

LABEL HOLDER
FIGURE 2
LABEL KIT

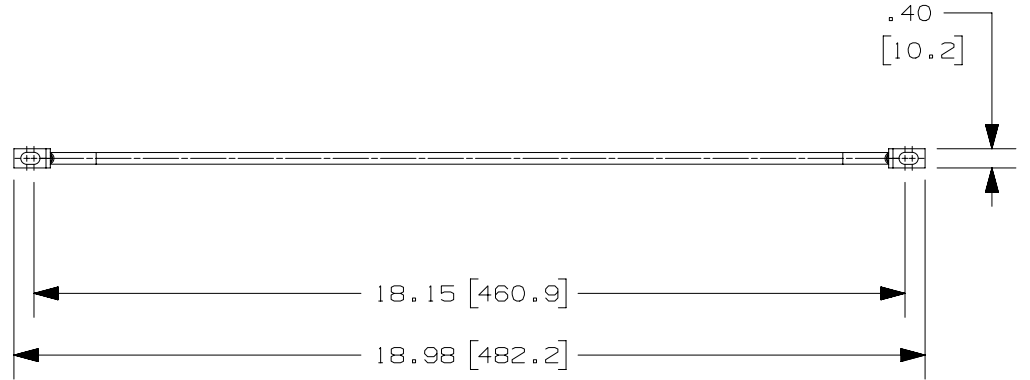
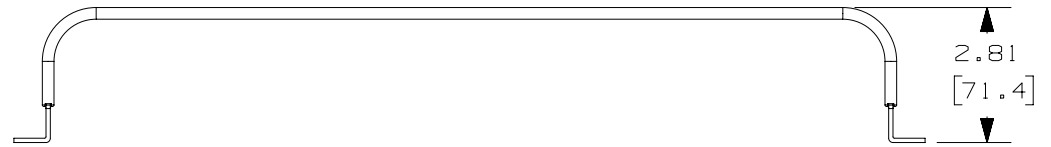

FIGURE 3
STRAIN RELIEF BAR

PART NUMBER		DPKR48688TG	
TITLE			
DP6 PLUS 48 PORT PATCH PANEL WITH STRAIN RELIEF BAR AND LABEL KIT			
CUSTOMER DRAWING			
ITEM REVISION NAME		M01537E0/02	
DATASET FILE NAME		M01537E0_DC54/02A	
UNLESS OTHERWISE SPECIFIED, DIMENSIONAL TOLERANCES ARE: IN [mm]			MATERIAL: SEE NOTE 3 ON SHEET 1
.X ± .XX ± .03 [.8] .XXX ± .010 [.3] ANGLES ±			
THIRD ANGLE PROJECTION			DRAWING NUMBER: 01537-54
DRAWN BY	DATE	CHK	SCALE
BJN	11/26/07	RJDU	NONE
SHT 2 OF 2			SIZE A

2	11/15/18	BAME	KRKE	MME	SEE SHEET 1 OF 2 FOR CHANGES.	01537-54
1	6/02/14	MDJR	REFR	MMR	SEE SHEET 1 OF 2 FOR CHANGES.	01537-54
R	11/26/07	BJN	RJDU	VMB	SEE SHEET 1 OF 2 FOR CHANGES.	01537-54
REV	DATE	BY	CHK	APR	DESCRIPTION	ECN

D10100DA/14

X-ON Electronics

Largest Supplier of Electrical and Electronic Components

Click to view similar products for [Modular Connectors / Ethernet Connectors](#) category:

Click to view products by [Panduit](#) manufacturer:

Other Similar products are found below :

[8949-H88/06BLKA/SN](#) [74441-0010/BKN](#) [MP1010RX-1000](#) [MP44RX-1000](#) [PHP-6P6C-5](#) [GAX-3-66](#) [GAX-8-62](#) [GDCX-PA-66-50](#) [GDCX-PN-64](#) [GDCX-PN-66](#) [GDCX-PN-66-50](#) [GDLX-A-66](#) [GDLX-N-66](#) [GDLX-S-66](#) [GDLX-S-88K](#) [GDTX-S-88-50](#) [GDX-PA-1010](#) [GLX-N-1010M-BLK](#) [GLX-S-88M-BLK](#) [GMX-N-1010](#) [GMX-S-1010](#) [GMX-S-66](#) [GMX-SMT4-N-88](#) [GPX-2-64](#) [GSGX-N-2-88](#) [GSGX-N-4-88](#) [GSX-NS2-88-3.05](#) [GSX-NS2-88-3.05-50](#) [GSX-NS-88-3.05-50](#) [PT-108A-8C-UL](#) [PT-J951-8C](#) [PTS-J531-8CS-50UL](#) [1-1775629-2](#) [A-2014-0-4](#) [GWLX-S-88-GR](#) [GWLX-S9-88-YG](#) [DC-1021-8-WH-6](#) [1300530003](#) [1324640-4](#) [RJ11FTVC2G](#) [RJ11FTVC2N](#) [RJFTVX2SA1G](#) [132764-001](#) [1413235](#) [MP88X-1000](#) [MPS88RX-5000](#) [E5288-S000K3-L](#) [E5908-15A242-L](#) [155302-001](#) [AX100653](#)