

THIS COPY IS PROVIDED ON A RESTRICTED BASIS AND IS NOT TO BE USED IN ANY WAY DETRIMENTAL TO THE INTERESTS OF PANDUIT CORP.

| PANDUIT PART # | WIRE RANGE AWG [mm ²] | TAB SIZE in. [mm] | HOUSING COLOR | MAX WIRE INSUL DIA | DIMENSIONS in. [mm] | | | WIRE STRIP LENGTH in. [mm] +1/32 [0,8] -0 | TOOLS |
|----------------|-----------------------------------|-------------------------|---------------|--------------------|---------------------|---------------|---------------|---|----------|
| | | | | | L ± .04 [1,1] | W ± .01 [0,3] | M ± .02 [0,6] | | |
| EDNF18-187MB | #22-16 [0.5-1.5] | .187 X .032 [4.8 X 0.8] | RED | 0.145 [3.7] | 0.79 [20.0] | 0.19 [4.8] | .43 [11.0] | 9/32 [6.8] | KST2000C |
| EDNF14-187MB* | #16-14 [1.5-2.5] | | BLUE | 0.165 [4.2] | 0.79 [20.0] | 0.19 [4.8] | .43 [11.0] | | |

*NOT UL LISTED

NOTES:

- UL LISTED FOR:
 - A. STRANDED COPPER WIRE ONLY - INTERNAL WIRING
 - B. 221°F (105°C) MAX TEMP RATING
 - C. 300V MAX VOLTAGE RATING
- MATERIAL:
 - A. STAMPING: .016" [0.4] THICK BRASS, TIN PLATED
 - B. HOUSING: NYLON
- SEE www.panduit.com FOR PACKAGE QUANTITIES
- DIMENSIONS IN BRACKETS ARE METRIC EQUIVALENT

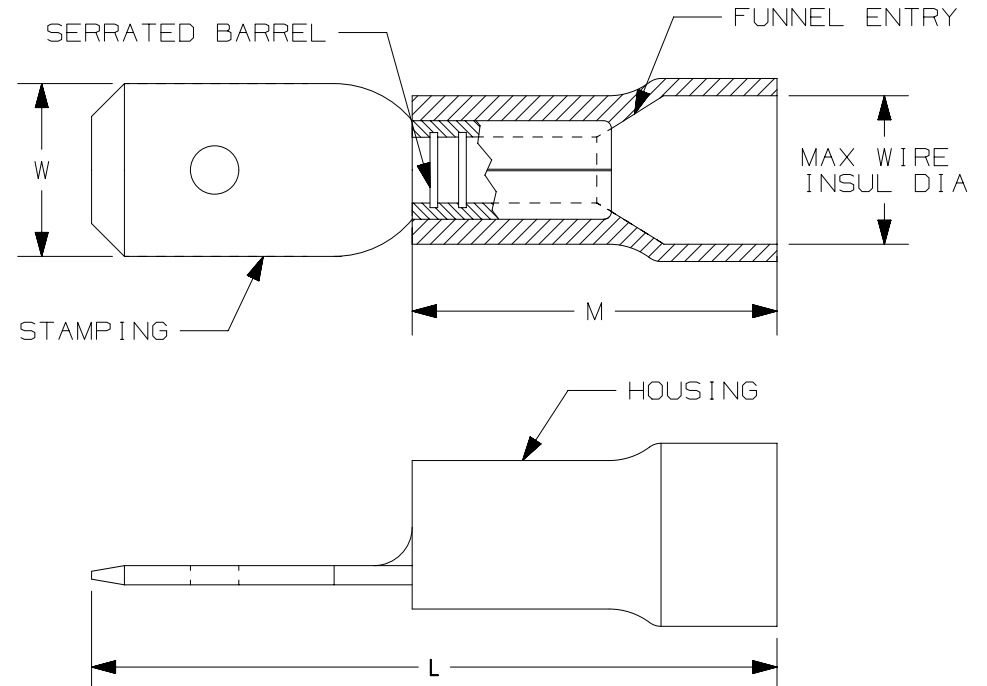

| | | | |
|--|------------|--------------------------------|-----------|
| TITLE STRONGHOLD MALE DISCONNECTS (187 SERIES) NYLON INSULATED #22-14 AWG | | CUSTOMER DRAWING | |
| ITEM REVISION NAME 00123SSM/00 | | PANDUIT TM | |
| DATASET FILE NAME 00123SSM_DC/00 | | | |
| UNLESS OTHERWISE SPECIFIED, DIMENSIONAL TOLERANCES ARE: IN [mm] .x ± .1 [2.54] .xxx ± .005 [0.127] .xx ± .01 [0.25] ANGLES ± 5° | | MATERIAL: SEE NOTES | |
| DRAWN BY JHNU | | DRAWING NUMBER: 00123SSM-DC | |
| DATE - | CHK RLS | SCALE N.T.S. | SIZE A |

| REV | DATE | BY | CHK | APR | DESCRIPTION | ECN |
|-----|------|------|-----|-----|------------------|---------|
| 00 | 2/18 | JHNU | TMR | RGB | DRAWING RELEASED | 00123SS |

D101000DA/12

X-ON Electronics

Largest Supplier of Electrical and Electronic Components

Click to view similar products for [Terminals](#) category:

Click to view products by [Panduit](#) manufacturer:

Other Similar products are found below :

[00-054007-01074-6](#) [00-054007-70206-1](#) [00-054007-70210-8](#) [00-054007-70217-7](#) [00-054007-70226-9](#) [00-054007-70228-3](#) [00-054007-70248-1](#) [00-054007-70256-6](#) [00-054007-70301-3](#) [00-054007-70316-7](#) [0-0320562-0](#) [00-054007-49560-4](#) [00-054007-70209-2](#) [00-054007-70225-2](#) [00-054007-70227-6](#) [00-054007-70231-3](#) [00-054007-70241-2](#) [00-054007-70242-9](#) [00-054007-70244-3](#) [00-054007-70246-7](#) [00-054007-70263-4](#) [00-054007-70288-7](#) [00-054007-70290-0](#) [00-054007-70300-6](#) [00-054007-70304-4](#) [01-2065-1-0216](#) [01-2900-1-04412](#) [00581P0075](#) [600TS-10](#) [60205-1](#) [604200-1](#) [605601-1](#) [60598-1-CUT-TAPE](#) [61314-6-C](#) [61810-3](#) [61-S](#) [61-SN](#) [626-0194](#) [62-NBM-A](#) [62-SN](#) [62-SP](#) [63-S](#) [640179-1](#) [M55155/059I03](#) [M55155/079C01](#) [M55155/099H02](#) [M55155/109H01](#) [M55155/109H02](#) [M55155/12XH05](#) [M55155/16XH02](#)