

THIS COPY IS PROVIDED ON A RESTRICTED BASIS AND IS NOT TO BE USED IN ANY WAY DETRIMENTAL TO THE INTERESTS OF PANDUIT CORP.

PANDUIT PART #	WIRE RANGE AWG [ mm <sup>2</sup> ]	TAB SIZE INCH [ mm ]	COLOR	MAX. WIRE INSULATION DIAMETER	DIMENSIONS in. [ mm ]		
					L± .03 [ 0,8 ]	W± .01 [ 0,3 ]	H± .01 [ 0,3 ]
EDV10-250	#12-10 [ 4,0-6,0 ]	.250 X .032 [ 6,3 X 0,8 ]	YELLOW	.23 [ 5,8 ]	1.03 [ 26,2 ]	.30 [ 7,6 ]	.13 [ 3,3 ]

NOTES:

- USED FOR:
  - A. STRANDED COPPER WIRE ONLY
  - B. 194°F [90°C] MAX. OPERATING TEMP.
  - C. 600 V. MAX. VOLTAGE RATING
- MATERIAL:
  - A. STAMPING: BRASS, TIN PLATED
  - B. HOUSING: VINYL
  - C. SLEEVE: BRASS, TIN PLATED
- INSTALLATION TOOLS:
  - A. UL LISTED AND CSA CERTIFIED: CT-1550, CT-1551, CT-2500, CT-600A
  - B. PANDUIT APPROVED: CT-100A, CT-160, CT-260, CT-460
- WIRE STRIP LENGTH:  $9/32'' \begin{smallmatrix} +1/32 \\ -0 \end{smallmatrix} [7,1\text{mm} \begin{smallmatrix} +0,8 \\ -0 \end{smallmatrix}]$
- SEE [www.panduit.com](http://www.panduit.com) FOR PACKAGE QUANTITIES INDICATED BY PART NUMBER SUFFIX
- DIMENSIONS IN BRACKETS ARE METRIC EQUIVALENT

MAX. WIRE INSUL. DIA. (SEE CHART)

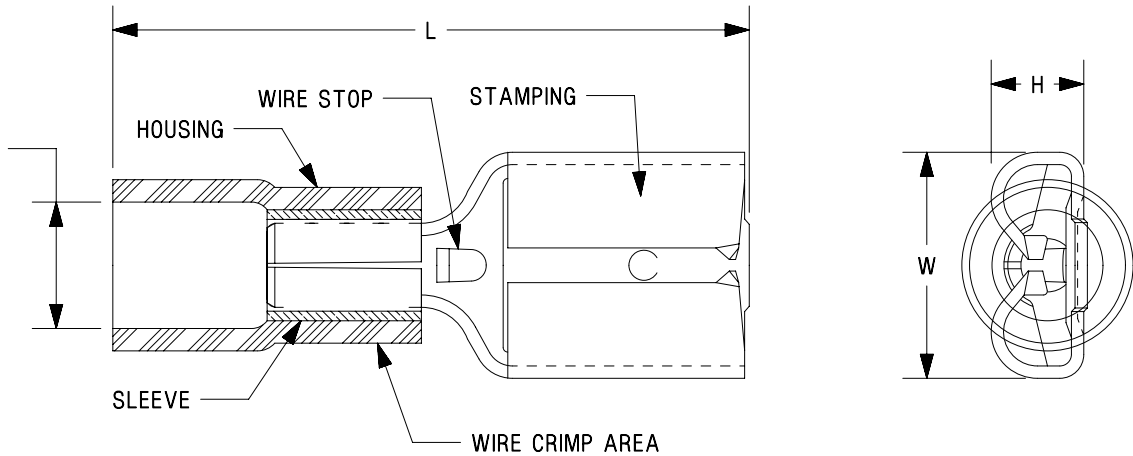

RECOGNIZED E78522 CERTIFIED LR31212

TITLE <b>STRONGHOLD FEMALE DISCONNECTS (250 SERIES)</b> <b>VINYL INSULATED, METAL SLEEVE #12-10 AWG</b> CUSTOMER DRAWING							
ITEM REVISION NAME		00123SHI/00					
DATASET FILE NAME		00123SHI_DC/00					
UNLESS OTHERWISE SPECIFIED, DIMENSIONAL TOLERANCES ARE: IN [ mm ]				MATERIAL:  <b>SEE NOTES</b>			
.x ± .1 [ 2.54 ]		.xxx ± .005 [ .127 ]					
.xx ± .01 [ .25 ]		ANGLES ± 5 °		DRAWING NUMBER: <b>SH41199</b>			
		THIRD ANGLE PROJECTION					
DRAWN BY	DATE	CHK	SCALE	SIZE			
JHNU	2/18	TMR	N.T.S.	A			
REV		DATE		DESCRIPTION	ECN		
00	2/18	JHNU	TMR	RELEASED	00123SH		
REV		DATE	BY	CHK	APR	DESCRIPTION	ECN
00	2/18	JHNU	TMR	RGB	RELEASED	00123SH	

D110100DA/12

## X-ON Electronics

Largest Supplier of Electrical and Electronic Components

*Click to view similar products for [Terminals](#) category:*

*Click to view products by [Panduit](#) manufacturer:*

Other Similar products are found below :

[00-054007-01074-6](#) [00-054007-70206-1](#) [00-054007-70210-8](#) [00-054007-70217-7](#) [00-054007-70226-9](#) [00-054007-70228-3](#) [00-054007-70248-1](#) [00-054007-70256-6](#) [00-054007-70301-3](#) [00-054007-70316-7](#) [0-0320562-0](#) [00-054007-49560-4](#) [00-054007-70209-2](#) [00-054007-70225-2](#) [00-054007-70227-6](#) [00-054007-70231-3](#) [00-054007-70241-2](#) [00-054007-70242-9](#) [00-054007-70244-3](#) [00-054007-70246-7](#) [00-054007-70263-4](#) [00-054007-70288-7](#) [00-054007-70290-0](#) [00-054007-70300-6](#) [00-054007-70304-4](#) [01-2065-1-0216](#) [01-2900-1-04412](#) [00581P0075](#) [600TS-10](#) [60205-1](#) [604200-1](#) [605601-1](#) [60598-1-CUT-TAPE](#) [61314-6-C](#) [61810-3](#) [61-S](#) [61-SN](#) [626-0194](#) [62-NBM-A](#) [62-SN](#) [62-SP](#) [640179-1](#) [M55155/059I03](#) [M55155/079C01](#) [M55155/099H02](#) [M55155/109H01](#) [M55155/109H02](#) [M55155/12XH05](#) [M55155/16XH02](#) [M55155/29-5S](#)