

THIS COPY IS PROVIDED ON A RESTRICTED BASIS AND IS NOT TO BE USED IN ANY WAY DETRIMENTAL TO THE INTERESTS OF PANDUIT CORP.

PANDUIT PART #	WIRE RANGE AWG [mm ²]	TAB SIZE in. [mm]	HOUSING COLOR	MAX WIRE INSUL DIA	DIMENSIONS in. [mm]			WIRE STRIP LENGTH in. [mm] +1/32 [0,8] -0	TOOLS
					L ± .04 [1,1]	W ± .01 [0,3]	M ± .02 [0,6]		
EDV18-187MB	#22-16 [0.5-1.5]	.187 X .032 [4.8 X 0.8]	RED	0.145 [3.7]	0.75 [19.0]	0.19 [4.8]	.39 [10.0]	9/32 [6.8]	KST2000C
EDV14-187MB	#16-14 [1.5-2.5]		BLUE	0.165 [4.2]	0.75 [19.0]	0.19 [4.8]	.39 [10.0]		

NOTES:

- 1. UL LISTED FOR:
 - A. STRANDED COPPER WIRE ONLY - INTERNAL WIRING
 - B. 167°F (75°C) MAX TEMP RATING
 - C. 300V MAX VOLTAGE RATING
- 2. MATERIAL:
 - A. STAMPING: .016" [0.4] THICK BRASS, TIN PLATED
 - B. HOUSING: VINYL
- 3. SEE www.panduit.com FOR PACKAGE QUANTITIES
- 4. DIMENSIONS IN BRACKETS ARE METRIC EQUIVALENT

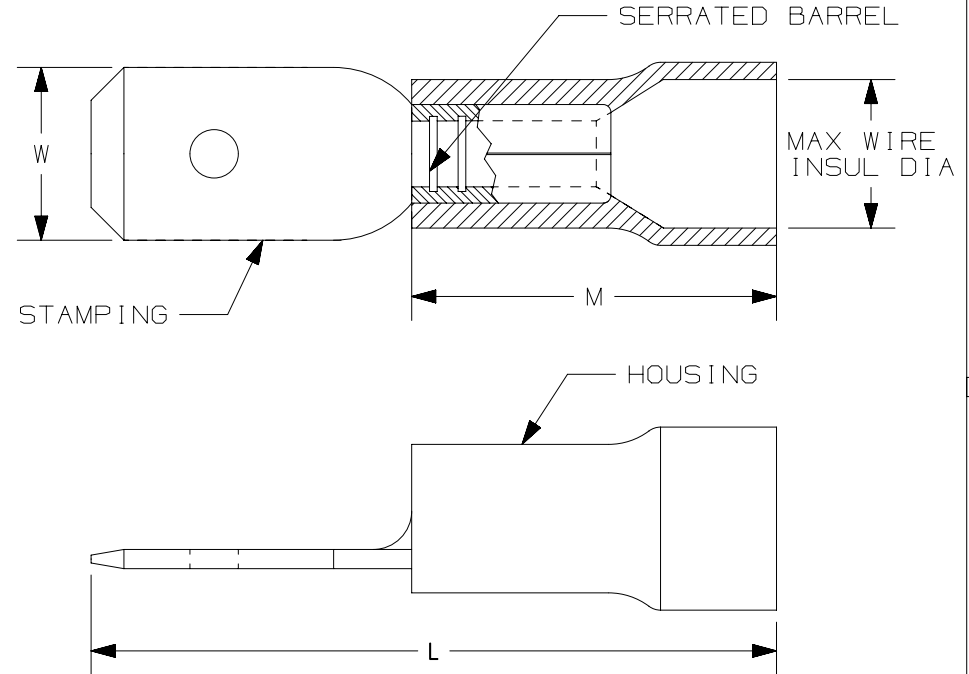

00	2/18	JHNU	TMR	RGB	DRAWING RELEASED		00123SS			
REV	DATE	BY	CHK	APR	DESCRIPTION	ECN				

TITLE
 STRONGHOLD MALE DISCONNECTS (187 SERIES)
 VINYL INSULATED #22-14 AWG
 CUSTOMER DRAWING

ITEM REVISION NAME
 00123SSN/00

DATASET FILE NAME
 00123SSN_DC/00

UNLESS OTHERWISE SPECIFIED,
 DIMENSIONAL TOLERANCES ARE: IN [mm]
 .x ± .1 [2.54] .xxx ± .005 [0.127]
 .xx ± .01 [0.25] ANGLES ± 5°

THIRD ANGLE PROJECTION

PANDUIT™

MATERIAL:
 SEE NOTES

DRAWING NUMBER:
 00123SSN-DC

DRAWN BY: JHNU DATE: - CHK: RLS SCALE: N.T.S.

SHEET 1 OF 1 SIZE: A

D10100DA/12

X-ON Electronics

Largest Supplier of Electrical and Electronic Components

Click to view similar products for [Terminals](#) category:

Click to view products by [Panduit](#) manufacturer:

Other Similar products are found below :

[00-054007-01074-6](#) [00-054007-70206-1](#) [00-054007-70210-8](#) [00-054007-70217-7](#) [00-054007-70226-9](#) [00-054007-70228-3](#) [00-054007-70248-1](#) [00-054007-70256-6](#) [00-054007-70301-3](#) [00-054007-70316-7](#) [0-0320562-0](#) [00-054007-49560-4](#) [00-054007-70209-2](#) [00-054007-70225-2](#) [00-054007-70227-6](#) [00-054007-70231-3](#) [00-054007-70241-2](#) [00-054007-70242-9](#) [00-054007-70244-3](#) [00-054007-70246-7](#) [00-054007-70263-4](#) [00-054007-70288-7](#) [00-054007-70290-0](#) [00-054007-70300-6](#) [00-054007-70304-4](#) [01-2065-1-0216](#) [01-2900-1-04412](#) [00581P0075](#) [600TS-10](#) [60205-1](#) [604200-1](#) [605601-1](#) [60598-1-CUT-TAPE](#) [61314-6-C](#) [61810-3](#) [61-S](#) [61-SN](#) [626-0194](#) [62-NBM-A](#) [62-SN](#) [62-SP](#) [63-S](#) [640179-1](#) [M55155/059I03](#) [M55155/079C01](#) [M55155/099H02](#) [M55155/109H01](#) [M55155/109H02](#) [M55155/12XH05](#) [M55155/16XH02](#)