

THIS COPY IS PROVIDED ON A RESTRICTED BASIS AND IS NOT TO BE USED IN ANY WAY DETRIMENTAL TO THE INTERESTS OF PANDUIT CORP.

| PANDUIT PART # | WIRE RANGE AWG [mm ²] | TAB SIZE INCH [mm] | HOUSING COLOR | DIMENSIONS in. [mm] | |
|----------------|-----------------------------------|-------------------------|---------------|---------------------|--------------------------|
| | | | | L ± .03 [0,8] | MAX WIRE INSULATION DIA. |
| EDV18-250M | #22-18 [0,5-1,0] | .250 X .032 [6,3 X 0,8] | RED | .98 [24,9] | .154 [3,91] |
| EDV14-250M | #16-14 [1,5-2,5] | | BLUE | .96 [24,3] | .180 [4,57] |

NOTES:

- CSA CERTIFIED FOR:
 - STRANDED COPPER WIRE ONLY
 - 221°F (105°C) MAX TEMP RATING
 - 600V MAX VOLTAGE
- MATERIAL:
 - STAMPING: .031" (0.8) THK COPPER, NICKEL PLATED
 - HOUSING: VINYL
- INSTALLATION TOOLS: CT-500, CT-550, CT-1550, CT-1551
- WIRE STRIP LENGTH $9/32'' \begin{matrix} +1/32 \\ -0 \end{matrix}$ [7,1mm $\begin{matrix} +0.8 \\ -0 \end{matrix}$]
- SEE WWW.PANDUIT.COM FOR PACKAGE QUANTITIES INDICATED BY PART NUMBER SUFFIX
- DIMENSIONS IN BRACKETS ARE METRIC EQUIVALENT

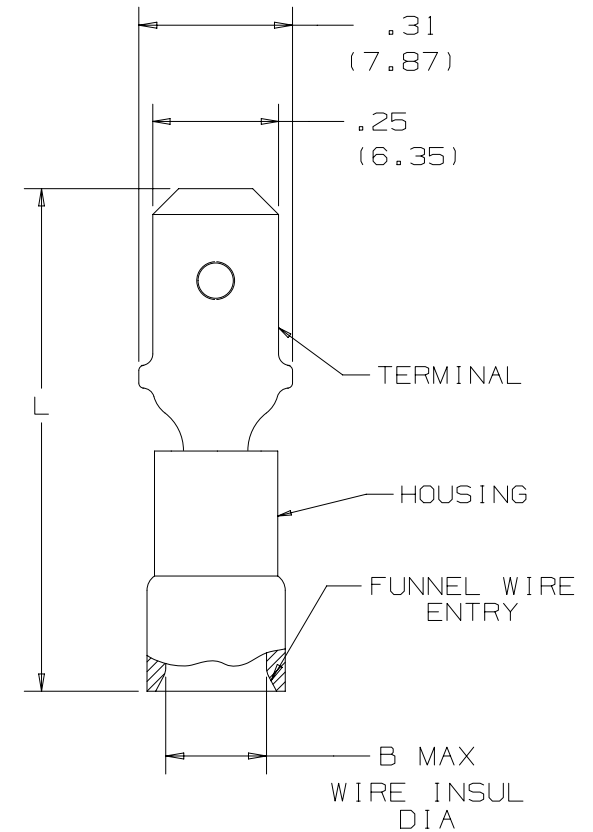

CERTIFIED LR31212

| | | | | | |
|---|------|------|-------------|------------|-----------------------------------|
| TITLE STRONGHOLD MALE DISCONNECT (250 SERIES) VINYL INSULATED, BRAZED SEAM #22-14 AWG CUSTOMER DRAWING | | | | | |
| ITEM REVISION NAME | | | 00123SHZ/00 | | |
| DATASET FILE NAME | | | 00123SHZ/00 | | |
| UNLESS OTHERWISE SPECIFIED, DIMENSIONAL TOLERANCES ARE: IN [mm] .x ± .1 [2.54] .xxx ± .005 [.127] .xx ± .01 [.25] ANGLES ± 5 ° | | | | | MATERIAL: SEE NOTES |
| DRAWING NUMBER: SH41405 | | | | | |
| DRAWN BY | DATE | CHK | SCALE | | |
| JHNU | 2/18 | TMR | NTS | SHT 1 OF 1 | |
| REV | DATE | BY | CHK | APR | DESCRIPTION |
| 00 | 2/18 | JHNU | TMR | RGB | RELEASED |
| | | | | | 00123SH |
| | | | | | ECN |

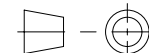

THIRD ANGLE PROJECTION

D10100DA/20

X-ON Electronics

Largest Supplier of Electrical and Electronic Components

Click to view similar products for [Terminals](#) category:

Click to view products by [Panduit](#) manufacturer:

Other Similar products are found below :

[00-054007-01074-6](#) [00-054007-70206-1](#) [00-054007-70210-8](#) [00-054007-70217-7](#) [00-054007-70226-9](#) [00-054007-70228-3](#) [00-054007-70248-1](#) [00-054007-70256-6](#) [00-054007-70301-3](#) [00-054007-70316-7](#) [0-0320562-0](#) [00-054007-49560-4](#) [00-054007-70209-2](#) [00-054007-70225-2](#) [00-054007-70227-6](#) [00-054007-70231-3](#) [00-054007-70241-2](#) [00-054007-70242-9](#) [00-054007-70244-3](#) [00-054007-70246-7](#) [00-054007-70263-4](#) [00-054007-70288-7](#) [00-054007-70290-0](#) [00-054007-70300-6](#) [00-054007-70304-4](#) [01-2065-1-0216](#) [01-2900-1-04412](#) [00581P0075](#) [600TS-10](#) [60205-1](#) [604200-1](#) [605601-1](#) [60598-1-CUT-TAPE](#) [61314-6-C](#) [61810-3](#) [61-S](#) [61-SN](#) [626-0194](#) [62-NBM-A](#) [62-SN](#) [62-SP](#) [640179-1](#) [M55155/059I03](#) [M55155/079C01](#) [M55155/099H02](#) [M55155/109H01](#) [M55155/109H02](#) [M55155/12XH05](#) [M55155/16XH02](#) [M55155/29-5S](#)