

THIS COPY IS PROVIDED ON A RESTRICTED BASIS AND IS NOT TO BE USED IN ANY WAY DETRIMENTAL TO THE INTERESTS OF PANDUIT CORP.

PANDUIT PART #	TAP		RUN		DIMENSIONS in. [mm]					TOOLS
	AWG [mm ²]	∅ ±.01 [0.3]	AWG [mm ²]	∅ ±.01 [0.3]	L ±.02 [0.5]	W ±.02 [0.5]	H ±.02 [0.5]	C ±.02 [0.4]	M ±.02 [0.6]	
EQSP10-18D	#18-14 [0.75-1.5]	.16 [4.0]	#12-10 [4.0]	.19 [4.7]	.83 [21.1]	0.60 [15.2]	0.43 [10.9]	0.43 [10.9]	1.32 [33.5]	KST2000-211D

NOTES:

- USED FOR:
 - A. STRANDED COPPER WIRE ONLY
 - B. 221°F [105°C] MAX. OPERATING TEMPERATURE
 - C. 600 V. MAX VOLTAGE RATING
- MATERIAL:
 - A. STAMPING: .028" [0.7] THICK BRASS, TIN PLATED
 - B. HOUSING: POLYPROPYLENE, BROWN
- SEE www.panduit.com FOR PACKAGE QUANTITIES
- DIMENSIONS IN BRACKETS ARE METRIC EQUIVALENT

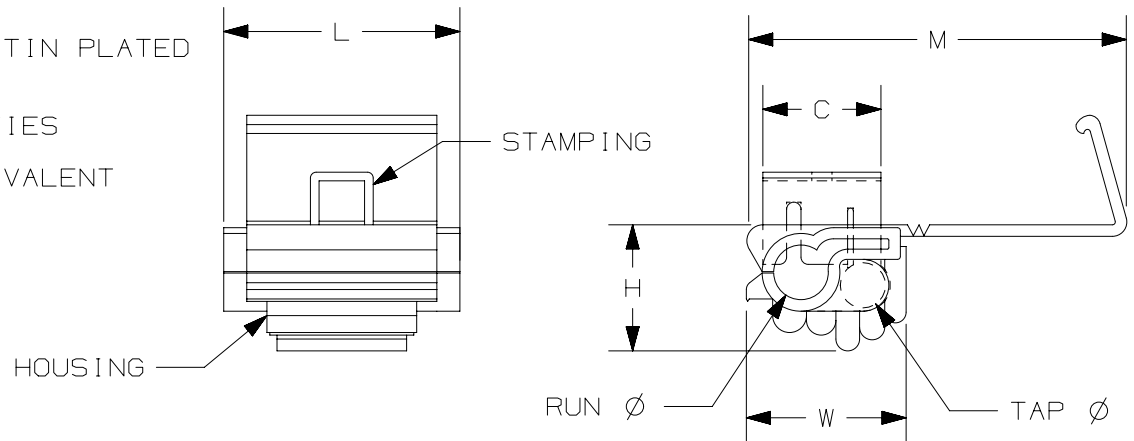

LISTED
2000
E52164

TITLE		STRONGHOLD QUICK SPLICE CONNECTOR INSULATION DISPLACEMENT #18-14 TO #12-10 CUSTOMER DRAWING	
ITEM REVISION NAME		00123SSI/00	
DATASET FILE NAME		00123SSI/00	
UNLESS OTHERWISE SPECIFIED, DIMENSIONAL TOLERANCES ARE: IN [mm]		MATERIAL:	
.x ± .1 [2.54] .xx ± .01 [.25]		SEE NOTES	
.xxx ± .005 [.127] ANGLES ± 5°		DRAWING NUMBER: 00123SSI-DC	
THIRD ANGLE PROJECTION		SHT 1 OF 1	
DRAWN BY	DATE	CHK	SCALE
JHNU	-	-	N.T.S.
REV	DATE	BY	CHK
00	2/18	JHNU	TMR
APR	DESCRIPTION		ECN
	DRAWING RELEASED		00123SS

D101000DA/15

X-ON Electronics

Largest Supplier of Electrical and Electronic Components

Click to view similar products for [Terminals](#) category:

Click to view products by [Panduit](#) manufacturer:

Other Similar products are found below :

[HT-13-10](#) [71M-250-32-NB](#) [01-2065-1-0216](#) [00581P0075](#) [M10-10RX](#) [M10BCK](#) [60205-1](#) [604200-1](#) [60598-1-CUT-TAPE](#) [60617-1-C](#) [60873-1](#) [M14-516R/SK](#) [M14-6RSX](#) [M18-10FLX](#) [M18-8FBX](#) [M18-8R/LX](#) [M18BCK](#) [61314-6-C](#) [61-S](#) [61-SN-A](#) [62-NBM-A](#) [63-S](#) [640179-1](#) [640917-2-CUT-TAPE](#) [6501550002](#) [66107-2-C](#) [696683-1](#) [696834-1](#) [696861-1](#) [696931-1](#) [696999-1](#) [M8-516RK](#) [M86700006](#) [MA250DMFMX-A](#) [701-2007](#) [701-2307](#) [701-7761-03](#) [70F-110-32-PB](#) [718-N-A](#) [71M-187-20-NBL](#) [71M-250-32-NBL](#) [72F-187-20-NBL](#) [72M-250-32-NBL](#) [7310](#) [73F-250-32](#) [73F-250-32-NBL](#) [73F-250-32-NL](#) [F14-10C](#) [F-1M](#) [751-250](#)