

THIS COPY IS PROVIDED ON A RESTRICTED BASIS AND IS NOT TO BE USED IN ANY WAY DETRIMENTAL TO THE INTERESTS OF PANDUIT CORP.

PANDUIT PART #	STUD SIZE	DIMENSIONS in. [mm]					TOOLS
		L ± .03 [0,8]	W ± .01 [0,3]	C ± .02 [0,5]	M ± .03 [0,8]	H ± .01 [0,3]	
EV10-6LFB	#6	1.03 [26,2]	.30 [7,6]	.23 [5,8]	.80 [20,3]	.14 [3,6]	*CT-100A CT-600A (CT-550CH) CT-1550 CT-1551 CT-2500 (CT-2550CH)
EV10-8LFB	#8	1.05 [26,7]	.30 [7,6]	.23 [5,8]	.80 [20,3]	.16 [4,1]	
EV10-10LFB	#10	1.04 [26,4]	.34 [8,6]	.23 [5,8]	.80 [20,3]	.19 [4,8]	
EV10-14LFB	1/4"	1.19 [30,2]	.46 [11,7]	.36 [9,1]	.90 [22,9]	.25 [6,4]	

*RATED FOR 300V, 75°C WITH CT-100A

NOTES:

- UL LISTED AND CSA CERTIFIED FOR:
 - A. #12-10 AWG [4,0-6,0 mm²] STRANDED COPPER WIRE
 - B. 221°F [105°C] MAX. OPERATING TEMPERATURE
 - C. 600 V. MAX. VOLTAGE RATING (1000 V. IN SIGNS, FIXTURES & LUMINARIES)
- MATERIAL:
 - A. STAMPING: .04" [1,0] THK COPPER, TIN PLATED
 - B. HOUSING: VINYL, YELLOW
- WIRE STRIP LENGTH: $5/16'' +^{1/32}_0$ [7,9mm $+^{0,8}_0$]
- SEE www.panduit.com FOR PACKAGE QUANTITIES
- DIMENSIONS IN BRACKETS ARE METRIC EQUIVALENT

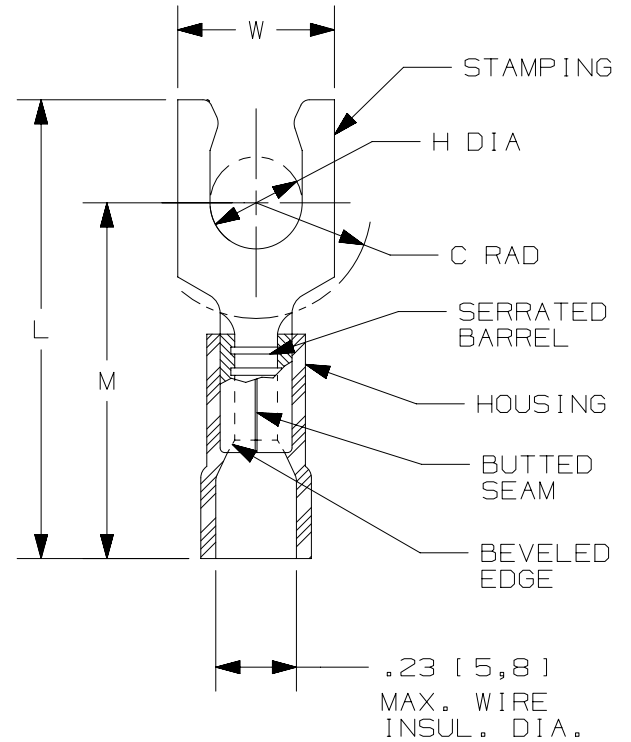

00	2/18	JHNU	TMR	RGB	RELEASED			00123SH									
REV	DATE	BY	CHK	APR	DESCRIPTION	ECN											

TITLE STRONGHOLD LOCKING FORK TERMINALS VINYL INSULATED, BUTTED SEAM #12-10 AWG		
CUSTOMER DRAWING		
ITEM REVISION NAME 00123SHT/00	PANDUIT ™	
DATASET FILE NAME 00123SHT_DC/00	MATERIAL: SEE NOTES	
UNLESS OTHERWISE SPECIFIED, DIMENSIONAL TOLERANCES ARE: IN [mm]		DRAWING NUMBER: SH41226
.X ± .XX ±	.XXX ± ANGLES ±	
THIRD ANGLE PROJECTION		
DRAWN BY JHNU	DATE 2/18	SCALE N.T.S.
CHK TMR	SHEET 1 OF 1	
SIZE A		

D101000DA/12

X-ON Electronics

Largest Supplier of Electrical and Electronic Components

Click to view similar products for [Terminals](#) category:

Click to view products by [Panduit](#) manufacturer:

Other Similar products are found below :

[00-054007-01074-6](#) [00-054007-70206-1](#) [00-054007-70210-8](#) [00-054007-70217-7](#) [00-054007-70226-9](#) [00-054007-70228-3](#) [00-054007-70248-1](#) [00-054007-70256-6](#) [00-054007-70301-3](#) [00-054007-70316-7](#) [0-0320562-0](#) [00-054007-49560-4](#) [00-054007-70209-2](#) [00-054007-70225-2](#) [00-054007-70227-6](#) [00-054007-70231-3](#) [00-054007-70241-2](#) [00-054007-70242-9](#) [00-054007-70244-3](#) [00-054007-70246-7](#) [00-054007-70263-4](#) [00-054007-70288-7](#) [00-054007-70290-0](#) [00-054007-70300-6](#) [00-054007-70304-4](#) [01-2065-1-0216](#) [01-2900-1-04412](#) [00581P0075](#) [600TS-10](#) [60205-1](#) [604200-1](#) [605601-1](#) [60598-1-CUT-TAPE](#) [61314-6-C](#) [61810-3](#) [61-S](#) [61-SN](#) [626-0194](#) [62-NBM-A](#) [62-SN](#) [62-SP](#) [63-S](#) [640179-1](#) [M55155/059I03](#) [M55155/079C01](#) [M55155/099H02](#) [M55155/109H01](#) [M55155/109H02](#) [M55155/12XH05](#) [M55155/16XH02](#)