

THIS COPY IS PROVIDED ON A RESTRICTED BASIS AND IS NOT TO BE USED IN ANY WAY DETRIMENTAL TO THE INTERESTS OF PANDUIT CORP.

| PANDUIT PART # | STUD SIZE |        | DIMENSIONS in. [mm] |               |               |               |               |
|----------------|-----------|--------|---------------------|---------------|---------------|---------------|---------------|
|                | ENGLISH   | METRIC | L ± .03 [0,8]       | W ± .01 [0,3] | C ± .02 [0,5] | M ± .03 [0,8] | H ± .01 [0,3] |
| EV14-6RB       | #6        | M3     | .92 [23,4]          | .31 [7,9]     | .25 [6,4]     | .76 [19,3]    | .15 [3,8]     |
| EV14-8RB       | #8        | M4     | .92 [23,4]          | .31 [7,9]     | .25 [6,4]     | .76 [19,3]    | .17 [4,3]     |
| EV14-10RB      | #10       | M5     | .92 [23,4]          | .31 [7,9]     | .25 [6,4]     | .76 [19,3]    | .20 [5,1]     |
| EV14-14RB      | 1/4"      | M6     | 1.12 [28,5]         | .46 [11,7]    | .38 [9,7]     | .89 [22,6]    | .27 [6,9]     |
| EV14-56RB      | 5/16"     | M8     | 1.12 [28,5]         | .46 [11,7]    | .38 [9,7]     | .89 [22,6]    | .34 [8,6]     |

\*RATED FOR 167°F [75°C] MAX TEMP. WITH CT-100A

NOTES:

- USED FOR:
  - A. 16-14 AWG [1,5-2,5 mm<sup>2</sup>] STRANDED COPPER WIRE
  - B. 221°F [105°C] MAX. OPERATING TEMPERATURE
  - C. 600V. MAX. BLDG WIRE (1000 V. MAX. IN SIGNS, FIXTURES & LUMINAIRES)
- MATERIAL:
  - A. STAMPING: .032" [0,8] THK COPPER, TIN PLATED
  - B. HOUSING: VINYL, BLUE
- INSTALLATION TOOLS PANDUIT APPROVED:
  - A. UL APPROVED: CT-100A\*, CT-600-A (CT-550CH) CT-1550, CT-1551, CT-2500 (CT-2550CH)
  - B. PANDUIT APPROVED: CT-160, CT-260, CT-400
- WIRE STRIP LENGTH: 5/16" <sup>+1/32</sup><sub>-0</sub> [7,9mm <sup>+0,8</sup><sub>-0</sub>]
- SEE [www.panduit.com](http://www.panduit.com) FOR PACKAGE QUANTITIES INDICATED BY PART NUMBER SUFFIX
- DIMENSIONS IN BRACKETS ARE METRIC EQUIVALENT

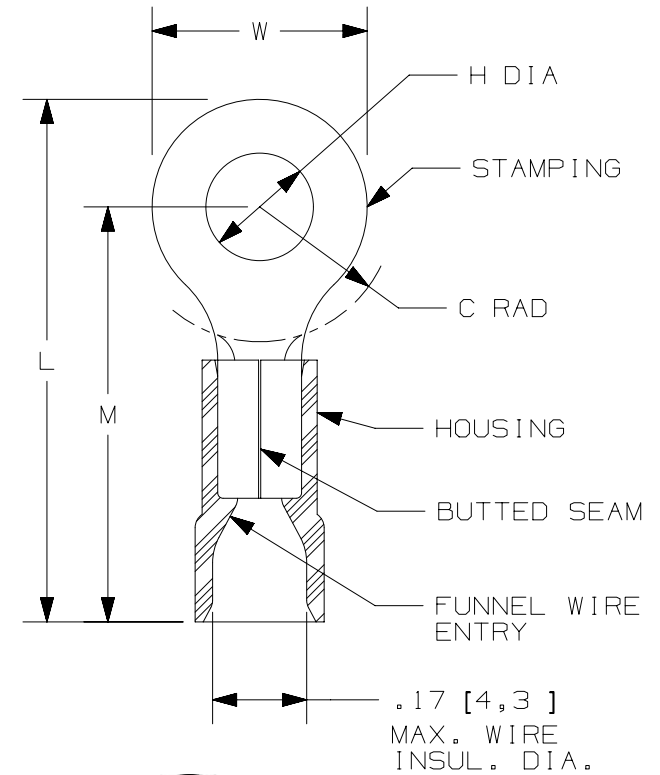

LISTED  
587H  
E52164



CERTIFIED  
LR31212

|                                                                           |      |                                                                              |        |      |
|---------------------------------------------------------------------------|------|------------------------------------------------------------------------------|--------|------|
| TITLE                                                                     |      | <b>STRONGHOLD RING TERMINALS<br/>VINYL INSULATED, BUTTED SEAM #16-14 AWG</b> |        |      |
|                                                                           |      | CUSTOMER DRAWING                                                             |        |      |
| ITEM REVISION NAME                                                        |      | 00123STG/00                                                                  |        |      |
| DATASET FILE NAME                                                         |      | 00123STG_DC/00                                                               |        |      |
| UNLESS OTHERWISE SPECIFIED,<br>DIMENSIONAL TOLERANCES ARE: IN [mm]        |      | <b>PANDUIT</b> <sup>TM</sup>                                                 |        |      |
| .x ± .1 [2.54]      .xxx ± .005 [.13]<br>.xx ± .01 [.25]      ANGLES ± 5° |      |                                                                              |        |      |
| DRAWING NUMBER:                                                           |      | SH41184                                                                      |        |      |
| DRAWN BY                                                                  | DATE | CHK                                                                          | SCALE  | SIZE |
| JHNU                                                                      | 2/18 | TMR                                                                          | N.T.S. | A    |

| REV | DATE | BY   | CHK | APR | DESCRIPTION | ECN     |
|-----|------|------|-----|-----|-------------|---------|
| 00  | 2/18 | JHNU | TMR | RGB | RELEASED    | 00123SH |

D101000DA/12

## X-ON Electronics

Largest Supplier of Electrical and Electronic Components

*Click to view similar products for [Terminals](#) category:*

*Click to view products by [Panduit](#) manufacturer:*

Other Similar products are found below :

[00-054007-01074-6](#) [00-054007-70206-1](#) [00-054007-70210-8](#) [00-054007-70217-7](#) [00-054007-70226-9](#) [00-054007-70228-3](#) [00-054007-70248-1](#) [00-054007-70256-6](#) [00-054007-70301-3](#) [00-054007-70316-7](#) [0-0320562-0](#) [00-054007-49560-4](#) [00-054007-70209-2](#) [00-054007-70225-2](#) [00-054007-70227-6](#) [00-054007-70231-3](#) [00-054007-70241-2](#) [00-054007-70242-9](#) [00-054007-70244-3](#) [00-054007-70246-7](#) [00-054007-70263-4](#) [00-054007-70288-7](#) [00-054007-70290-0](#) [00-054007-70300-6](#) [00-054007-70304-4](#) [01-2065-1-0216](#) [01-2900-1-04412](#) [00581P0075](#) [600TS-10](#) [60205-1](#) [604200-1](#) [605601-1](#) [60598-1-CUT-TAPE](#) [61314-6-C](#) [61810-3](#) [61-S](#) [61-SN](#) [626-0194](#) [62-NBM-A](#) [62-SN](#) [62-SP](#) [63-S](#) [640179-1](#) [M55155/059I03](#) [M55155/079C01](#) [M55155/099H02](#) [M55155/109H01](#) [M55155/109H02](#) [M55155/12XH05](#) [M55155/16XH02](#)