

| | |
|------------------------|-----------------------------|
| PANDUIT PART NUMBER | FRFWCSC12W4 |
| WEIGHT | 1.10 LB/EACH (499g/EACH) |

NOTES:

1. SEE CURRENT CATALOG FOR ADDITIONAL PART SUFFIXES TO INDICATE COLOR AND/OR PACKAGE QUANTITY.
2. THE FIBERRUNNER 12x4 FOUR-WAY CROSS WITH 4" EXITS SPLIT COVER REQUIRES NO TOOLS FOR INSTALLATION AND/OR REMOVAL. THE SPLIT COVER CREATES A 3/4" (19.1) RADUSED OPENING TO ALLOW FOR NEW CABLES TO BE ADDED WITHOUT THE NEED FOR REMOVING THE COVERS.
3. DIMENSIONS IN PARENTHESES ARE IN METRIC.

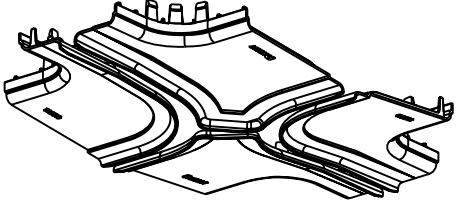
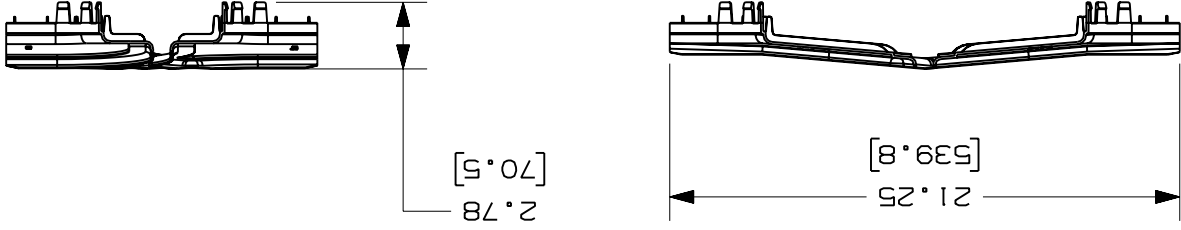
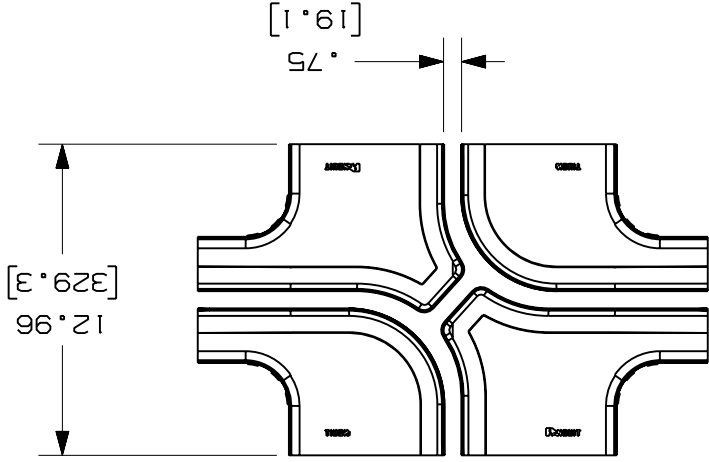

ENG. REF.: D39774B1_DC/00_FRFWCS12W4

CAD FILENAME/LAYERS

FRFWCSC12W4.ppt

PANDUIT
CORP
TINLEY PARK, ILLINOIS

FIBERRUNNER 12x4 FOUR-WAY CROSS WITH
4" EXITS SPLIT COVER (FRFWCSC12W4)
CUSTOMER DRAWING

UNLESS OTHERWISE SPECIFIED,
DIMENSIONAL TOLERANCES ARE:
(.XX) ±.03 (.8)
(.XXX) ±
INCHES, THIRD ANGLE PROJECTION.

SCALE
NONE

DRAWN BY
MSO

DATE
10-22-08

CHK'D
SL

ABS

DRAWING NO.
39774-09

SIZE
A

| | | | | | | | | | | |
|-----|----------|-----|-----|------------------------|----------|----|------|-----|------|----------|
| REV | DATE | BY | CHK | DESCRIPTION | ECN | R | CUST | SUP | GMBH | SL |
| R | 10-22-08 | MSO | SL | RELEASED TO PRODUCTION | 39774-09 | RN | RN | | | 10-22-08 |

X-ON Electronics

Largest Supplier of Electrical and Electronic Components

Click to view similar products for [panduit manufacturer](#):

Other Similar products are found below :

[PK10-56R-L](#) [PCMBR-13](#) [PCPA11IW](#) [CRE32](#) [M200X042UPT](#) [M200X050ACT](#) [M200X050Y7T](#) [M200X080FQT](#) [M200X100ACT](#)
[M200X100AIT](#) [CRTW](#) [CSVBP](#) [CT-1000](#) [CT-1004](#) [CT-1104](#) [CT-2550CH](#) [CT-2570CH](#) [M300X050ACT](#) [M300X100ACT](#) [CT-900HPH](#)
[CUFB48BL](#) [CVED32VE](#) [CVED32VEPG](#) [CVED40VEN](#) [CVED40VEPG](#) [CWF400](#) [CWMPV2340](#) [CWMPV2440](#) [CWMPV3340](#)
[CWMPV3440](#) [MBEH-TLR](#) [MBH-MR](#) [MBH-MR316](#) [MBH-TLR316](#) [MBSH-TR](#) [MBS-MR](#) [MBS-MR316](#) [MBS-TLR316](#) [F512B10-NM1](#)
[F512B10-NM2](#) [F512D5-5F140Y](#) [F512D5-5F15Y](#) [F512D5-5F200Y](#) [F512D5-5F26Y](#) [F512D5-5F30Y](#) [F512D5-5F33Y](#) [F512D5-5F34Y](#)
[F512D5-5F45Y](#) [F512D5-5F50Y](#) [F512D5-5F54Y](#)