

THIS COPY IS PROVIDED ON A RESTRICTED BASIS AND IS NOT TO BE USED IN ANY WAY DETRIMENTAL TO THE INTERESTS OF PANDUIT CORP.

PART NUMBER	A	B	L	T
GCESTUD-14-X	.25 [6.4]	.26 [6.6]	4.81 [122]	.19 [5]
GCESTUD-38-X	.38 [9.7]	.39 [10]	5.81 [148]	.25 [6.4]
GCESTUD-916-X	.56 [14.2]	.57 [14.5]	5.68 [144]	.38 [10]
GCESTUD-34-X	.75 [19]	.76 [19.3]	5.81 [148]	.51 [13]

NOTES:

1. MATERIAL: STEEL, COPPER CLAD FINISH
2. PACKAGING: -X = 10 PCS
3. DIMENSIONS IN BRACKETS ARE MILLIMETERS.

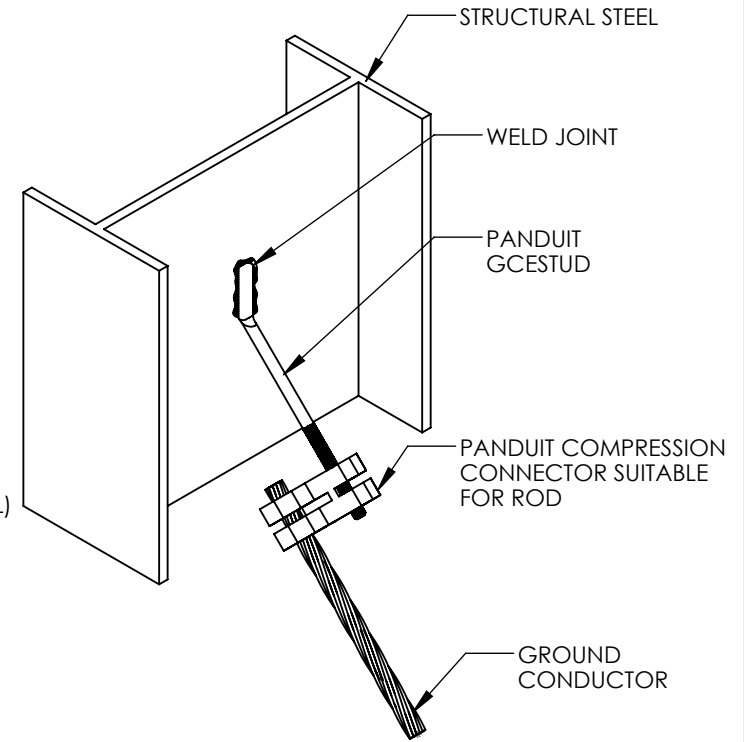
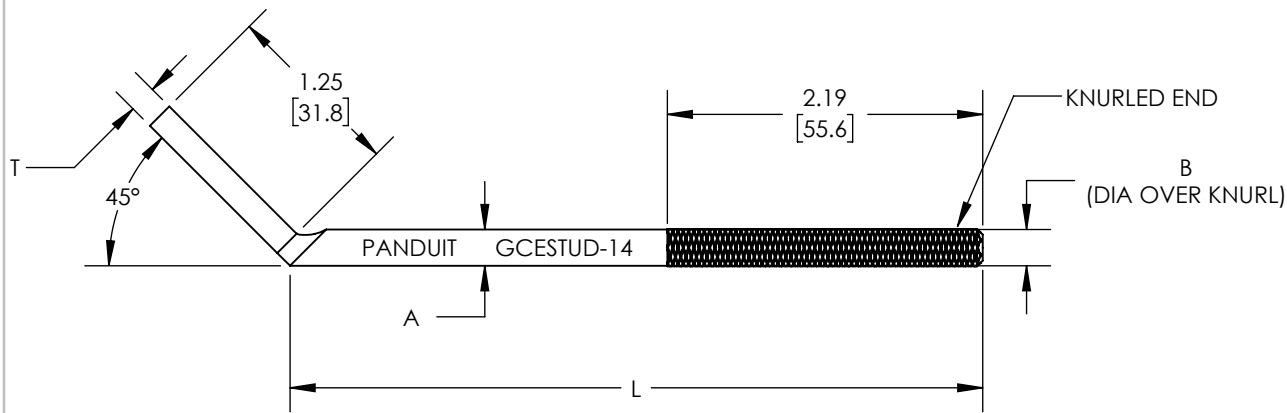

REV	DATE	BY	CHK	APR	DESCRIPTION	ECN
00	3/19	JHNU	JHNU	RGB	DRAWING RELEASED	00127EBS-DC

TITLE GROUNDING WELD STUD (GCESTUD) CUSTOMER DRAWING			
ITEM REVISION NAME 00127EBS/00		PANDUIT	
DATASET FILE NAME 00127EBS-DC/00.SLDDRW			
UNLESS OTHERWISE SPECIFIED, DIMENSIONAL TOLERANCES ARE: IN [mm] .X ± .XXX ± .XX ± .02 [0.5] ANGLES ±		MATERIAL SEE NOTES	
DRAWN BY JHNU		DRAWING NUMBER 00127EBS-DC	
DATE 3/19		SCALE N/A	
CHK RGB		SHEET 1 OF 1	
THIRD ANGLE PROJECTION		SIZE A	

X-ON Electronics

Largest Supplier of Electrical and Electronic Components

Click to view similar products for [Terminals](#) category:

Click to view products by [Panduit](#) manufacturer:

Other Similar products are found below :

[00-054007-01074-6](#) [00-054007-70206-1](#) [00-054007-70210-8](#) [00-054007-70217-7](#) [00-054007-70226-9](#) [00-054007-70228-3](#) [00-054007-70248-1](#) [00-054007-70256-6](#) [00-054007-70301-3](#) [00-054007-70316-7](#) [0-0320562-0](#) [00-054007-49560-4](#) [00-054007-70209-2](#) [00-054007-70225-2](#) [00-054007-70227-6](#) [00-054007-70231-3](#) [00-054007-70241-2](#) [00-054007-70242-9](#) [00-054007-70244-3](#) [00-054007-70246-7](#) [00-054007-70263-4](#) [00-054007-70288-7](#) [00-054007-70290-0](#) [00-054007-70300-6](#) [00-054007-70304-4](#) [01-2065-1-0216](#) [01-2900-1-04412](#) [00581P0075](#) [600TS-10](#) [60205-1](#) [604200-1](#) [605601-1](#) [60598-1-CUT-TAPE](#) [61314-6-C](#) [61810-3](#) [61-S](#) [61-SN](#) [626-0194](#) [62-NBM-A](#) [62-SN](#) [62-SP](#) [63-S](#) [640179-1](#) [M55155/059I03](#) [M55155/079C01](#) [M55155/099H02](#) [M55155/109H01](#) [M55155/109H02](#) [M55155/12XH05](#) [M55155/16XH02](#)