

THIS COPY IS PROVIDED ON A RESTRICTED BASIS AND IS NOT TO BE USED IN ANY WAY DETRIMENTAL TO THE INTERESTS OF PANDUIT CORP.

DIMENSIONS - IN [mm]

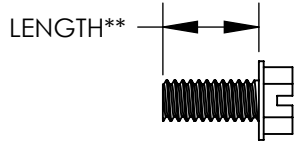
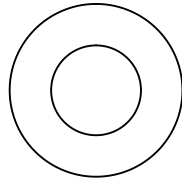
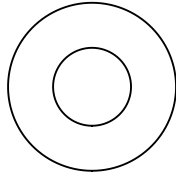
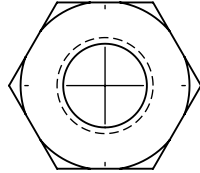
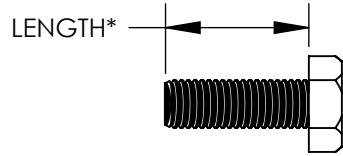

COMPONENT DESCRIPTION	PART NUMBER			
	HDW1/4-KT	HDW3/8-KT	HDW1/4-A-KT	HDW3/8-A-KT
STAINLESS STEEL 1/4-20 HEX BOLT, 1.00 [25.4] LONG* INSTALLATION TOOL: 7/16" WRENCH	2	N/A	2	N/A
STAINLESS STEEL 3/8-16 HEX BOLT, 1.00 [25.4] LONG* INSTALLATION TOOL: 9/16" WRENCH	N/A	2	N/A	2
STAINLESS STEEL 1/4-20 HEX NUT INSTALLATION TOOL: 9/16"	2	N/A	2	N/A
STAINLESS STEEL 3/8-16 HEX NUT INSTALLATION TOOL: 9/16"	N/A	2	N/A	2
STAINLESS STEEL 1/4 FLAT WASHER	4	N/A	4	N/A
STAINLESS STEEL 3/8 FLAT WASHER	N/A	4	N/A	4
STAINLESS STEEL 1/4 BELLEVILLE COMPRESSION WASHER	2	N/A	2	N/A
STAINLESS STEEL 3/8 BELLEVILLE COMPRESSION WASHER	N/A	2	N/A	2
#12-24 THREAD FORMING SCREW, .45 [11.4] LONG** INSTALLATION TOOL: SLOTTED SCREWDRIVER / 5/16" WRENCH	2	2	N/A	N/A
#10-32 THREAD FORMING SCREW, .45 [11.4] LONG** INSTALLATION TOOL: SLOTTED SCREWDRIVER / 5/16" WRENCH	N/A	N/A	2	2
M5 THREAD FORMING SCREW, .45 [11.4] LONG** INSTALLATION TOOL: SLOTTED SCREWDRIVER / 8mm WRENCH	N/A	N/A	2	2
M6 THREAD FORMING SCREW, .45 [11.4] LONG** INSTALLATION TOOL: SLOTTED SCREWDRIVER / 8mm WRENCH	2	2	N/A	N/A

REV	DATE	BY	CHK	DESCRIPTION	ECN	SUP
02	2/12	JHNU	JHNU	ADDED LENGTH TO HEX BOLT & SCREW IN TABLE	N41736BB-C41736	RGB
01	3/10	JHNU	JHNU	ADDED INSTALLATION TOOL TO COMPONENT DESCRIPTION		
00	5/08	JHNU	JHNU	DRAWING RELEASED		

PANDUIT CORP. TINLEY PARK, ILLINOIS

STAINLESS STEEL HARDWARE KITS
(HDW1/4-KT, HDW3/8-KT, HDW1/4-A-KT, HDW3/8-A-KT)
CUSTOMER DRAWING

SCALE	N/A	DRAWING NO / CAD FILE	C41736_02
-------	-----	-----------------------	-----------

X-ON Electronics

Largest Supplier of Electrical and Electronic Components

Click to view similar products for [Mounting Fixings](#) category:

Click to view products by [Panduit](#) manufacturer:

Other Similar products are found below :

[5912235-2](#) [007541](#) [627](#) [M3783-7001](#) [71-074914-006](#) [71-441549-19S](#) [75-69211-3P](#) [75-69214-6P](#) [75-69220-27S](#) [75-69224-5S](#) [7717-8DAP](#)
[85048GBESR](#) [FPK-02-R10](#) [PMS27488-001-01](#) [1-18023-0](#) [H-118-2](#) [D83999/20WC8SN](#) [DB1](#) [1302030464](#) [DC31-14W19PN](#) [DC31-](#)
[14W19PW](#) [DC32-18W32SN](#) [DC36-18-32SW](#) [DC36-18-32SX](#) [DC37-14-19PW](#) [DC37-22-21PX](#) [1302010957](#) [1302263564](#) [1302340393](#)
[1404-0016-78](#) [14540](#) [149331-9811](#) [1561-60](#) [1566](#) [1566](#) [17542](#) [BR16A](#) [HS5659MB98PN](#) [NT20SATT01](#) [201C5058-01-201](#) [REV E](#) [22594-8](#)
[KBB-141](#) [89078GBEPR](#) [89078GBESR](#) [915060](#) [SF4011-60101](#) [97-CS-50](#) [1671](#) [LS10215R14-15PN](#) [LS10215R14-7PN L/C](#)