

THIS COPY IS PROVIDED ON A RESTRICTED BASIS AND IS NOT TO BE USED IN ANY WAY DETRIMENTAL TO THE INTERESTS OF PANDUIT CORP.

NOTES, UNLESS OTHERWISE SPECIFIED:

DIMENSIONS IN BRACKETS ARE IN MILLIMETERS

DIMENSIONS ARE FOR REFERENCE ONLY

HEXAGONS ARE FOR COMMUNICATION PURPOSES ONLY.

NOT SHOWN: TORX BIT

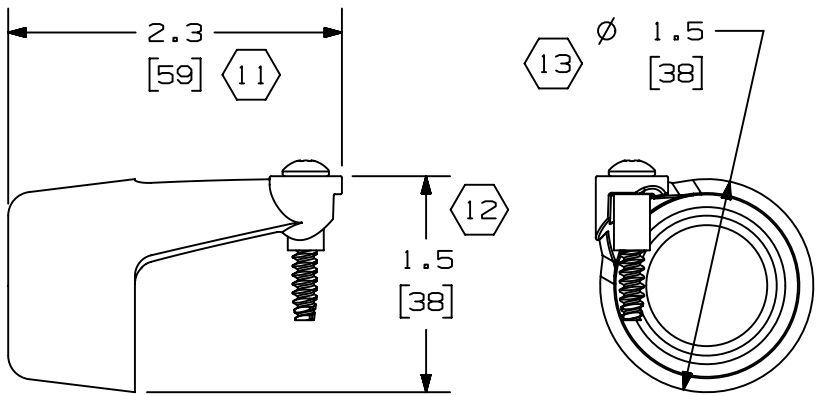

PART NO.	DESCRIPTION	KIT BOM QUANTITIES	
		KGTS-ETLS	KGS24-ETLS
WB29240D01	TENSION LOCKOUT	1	1
WB29274A01	BUSHING	1	1
CA29218A01	T20 TORX SCREW	1	-
CA29275A01	T20 TORX BIT	1	-
CA29463A01	T15 TORX SCREW	-	1
CA29462A01	T15 TORX BIT	-	1

KGTS-ETLS : FOR USE WITH GTS-E AND GTH-E TOOLS

KGS24-ETLS: FOR USE WITH GS2B-E, GS4H-E, GS4EH-E AND GS4MT-E TOOLS

THESE KITS PROVIDE TAMPER-RESISTANT TENSION SETTING LOCKOUT SOLUTION

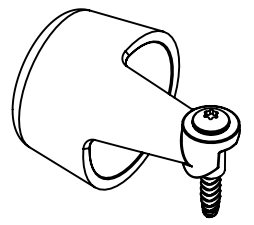
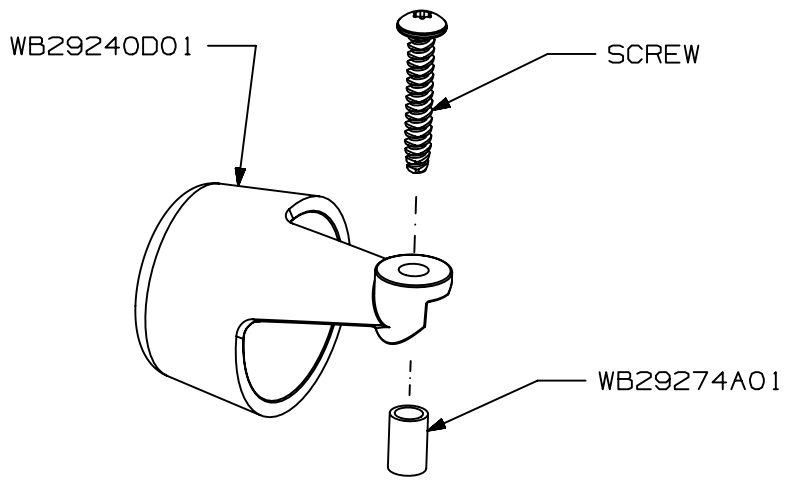

XGLOBAL-ASIZE

REV	DATE	BY	CHK	APR	DESCRIPTION	ECN
01	12.18.18	BDK	ALP	JADE	ADDED KGS24-ETLS, TOOL USE NOTES AND TAMPER-RESISTANT NOTE	042000
00	09.21.18	BDK	ALP	JADE	RELEASED TO PRODUCTION	037079

TITLE KGTS-ETLS & KGS24-ETLS TENSION LOCKOUT KITS CUSTOMER DRAWING					
ITEM REVISION NAME R29273BA/01			PANDUIT		
DATASET FILE NAME R29273BA_DC_WB29273A01/01					
UNLESS OTHERWISE SPECIFIED, DIMENSIONAL TOLERANCES ARE: IN [mm]			MATERIAL: N/A		
.X ± .XX ±		.XXX ± ANGLES ±		DRAWING NUMBER: WB29273A01	
DRAWN BY BDK		DATE 09.21.18		SCALE N.T.S.	
THIRD ANGLE PROJECTION		CHK ALP		SIZE A	
SHT 1 OF 1					

X-ON Electronics

Largest Supplier of Electrical and Electronic Components

Click to view similar products for [Panduit](#) manufacturer:

Other Similar products are found below :

[PCM-39](#) [PCMBR-13](#) [PCM-V](#) [D14-188-C](#) [MBCH-QR316](#) [MBH-MR](#) [MBH-TLR](#) [MBMS-S10-CY](#) [F6D2-2M9Y](#) [F92-32-L](#) [F9D3-3M3Y](#)
[F9E3-10M10Y](#) [F9LD2-2M3](#) [F9LE10-10M3](#) [FAP12WBUSCZ](#) [FAP6WBUDSC](#) [FAP6WBUSCZ](#) [FCZ-24-10Y](#) [FJPMR](#) [MLT4EH15-LP](#)
[MLT8EH-LP316](#) [MLTC8H-LP316](#) [FLCDM900EIY](#) [FMT1](#) [FMTJW24](#) [FOVRA2X2LG](#) [FRAFC58](#) [PCPA13R20IWY](#) [PCSBMT2/0-12-1Y](#)
[PCSBMT2/0-4-3Y](#) [FRRA4X4YL](#) [FRTR4X4YL](#) [PCV-230C](#) [PDL-124-10](#) [PDL-145](#) [PDL-20](#) [FST24H3](#) [FVTHD2X2BL](#) [PEEF36IG-X](#)
[FXD3-3M2Y](#) [FXD3-3M3Y](#) [PGKE96](#) [G2X5LG6](#) [PICF3IG-X](#) [PICF6IW-X](#) [GB2D0008TPI-1](#) [GB2D0044TPI-1](#) [GB4B0624TPI-1](#) [PLL-22-Y2-1](#) [PLT2S-C2](#)