

PANDUIT PART NUMBER	CONDUCTOR SIZE	STUD SIZE	OVERALL LENGTH "A" +/- .12	BARREL LENGTH "B" MIN	BARREL		TONGUE WIDTH "W" +/- .060	TONGUE THICKNESS "T" +/- .020	TONGUE LENGTH "P" MIN	HOLE OFFSET "G" +/- .031	STUD HOLE DIA "D" +/- .02	WRENCH CLEARANCE "C" REF	WIRE STRIP LENGTH	PANDUIT DIE COLOR CODE PANDUIT DIE INDEX NUMBER (BURNDY DIE INDEX NUMBER)
					I.D. +/- .010	O.D. +/- .010								
LAA300-38-2 LAA300-12-2	300 kcmil	3/8" 1/2"	4.00	2.25	0.65	1.01	1.38	0.34	1.31	0.63	0.41 0.53	0.68	2-5/16"	BLUE DIE P76 (470)
LAA350-12-2	350 kcmil	1/2"	4.28	2.25	0.72	1.11	1.51	0.38	1.31	0.63	0.53	0.68	2-5/16"	BROWN DIE P87 (299)
LAA400-58-2R	400 kcmil	5/8"	4.88	2.50	0.76	1.19	1.61	0.41	1.25	0.63	0.66	0.62	2-9/16"	GREEN DIE P94 (472)
LAA500-12-2 LAA500-58-2	500 kcmil	1/2" 5/8"	5.50	3.00	0.84	1.32	1.74	0.45	1.50	0.63	0.53 0.66	0.87	3-1/16"	PINK DIE P99 (300)
LAA750-12-1 LAA750-58-1	750 kcmil	1/2" 5/8"	6.50	3.38	1.03	1.59	1.74	0.54	1.88	0.88	0.53 0.66	1.00	3-7/16"	RED DIE P125 (301)
LAA1000-58-1	1000 kcmil	5/8"	7.31	4.50	1.19	1.84	2.56	0.63	1.88	0.88	0.66	1.00	4-3/4"	BROWN DIE P161 (302)

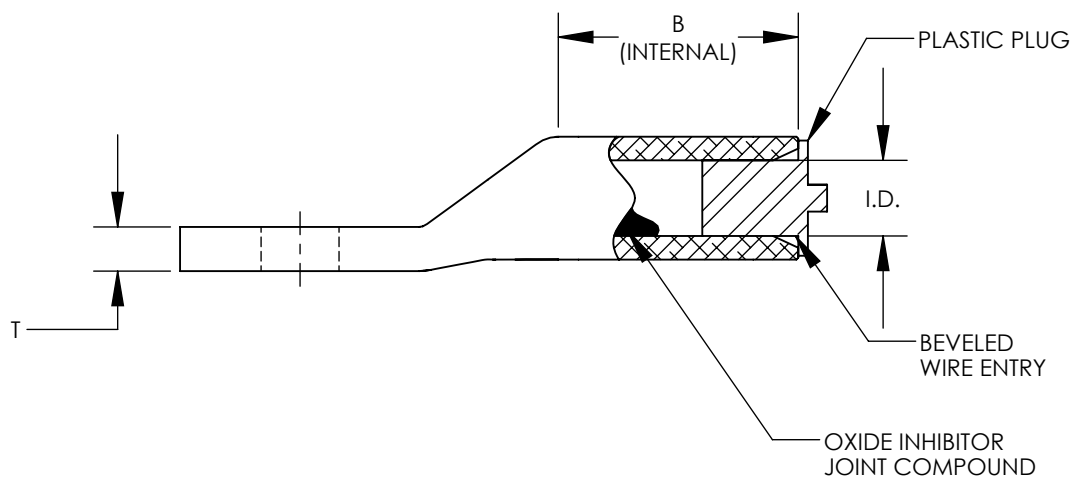

NOTES:

1. MATERIAL: SEAMLESS ALUMINUM TUBING, TIN PLATED
2. BARREL COLOR CODED WITH DIE SET INDEX NUMBER
3. FOR STRANDED ALUMINUM AND COPPER WIRE
4. UL LISTED & CSA CERTIFIED TEMPERATURE RATED 90° C (AL9CU)
5. UL LISTED & CSA CERTIFIED VOLTAGE RATING 35 KV
6. ALL DIMENSIONS IN INCHES

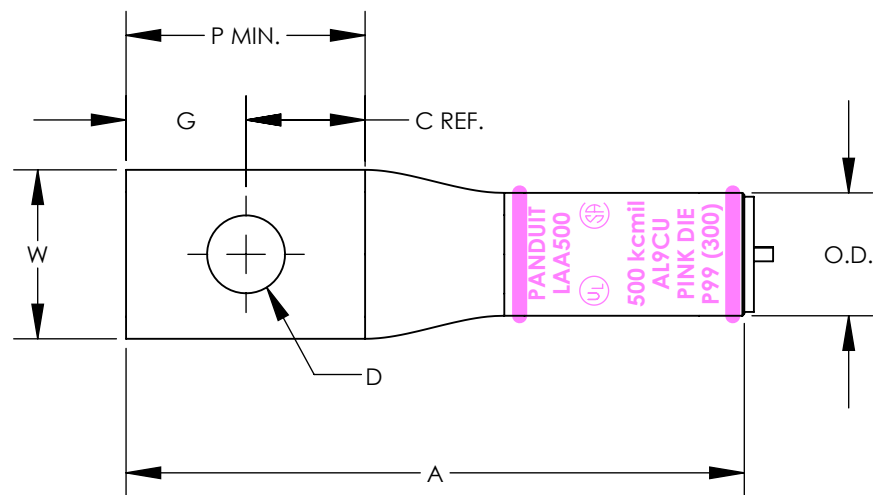

REV	DATE	BY	CHK	APR	DESCRIPTION	ECN
10	7/16	JHNU	JHNU	RGB	REVISED OVERALL LENGTH FOR LAA400-58-2R: 4.88 WAS 4.68	N41129BB-C41129
09	5/16	JHNU	JHNU	RGB	ADDED NOTE TO SPECIFY LAA750-12-1 IS cULus	N41129BB-C41129
08	8/15	JHNU	JHNU	RGB	ADDED "D" DIMENSION	N41129BB-C41129
07	3/15	JHNU	JHNU	RGB	REVISED A DIMENSION: LAA400-58-2R WAS 4.88	N41129BB-C41129
06	3/15	JHNU	JHNU	RGB	REVISED DIMENSIONS, REVISED NOTES ADDED BARREL MARKING ADDED COLOR CODE/DIE INDEX NUMBER REMOVED LAA400-58-2, ADDED LAA400-58-2R	N41129BB-C41129
05	3/13	JHNU	JHNU	RGB	REVISED TITLE BLOCK CONVERTED TO SOLIDWORKS	N41129BB-C41129

TITLE		LAA SERIES 300kcmil-1000kcmil ALUMINUM LUGS CUSTOMER DRAWING	
ITEM REVISION NAME	N41129BB-C41129/10		
DATASET FILE NAME	C41129/10.SLDDRW		
UNLESS OTHERWISE SPECIFIED, DIMENSIONAL TOLERANCES ARE: IN [mm]		MATERIAL	
.X ±	.XXX ±	SEE NOTES	
.XX ±	ANGLES ±	DRAWING NUMBER	
THIRD ANGLE PROJECTION		C41129	
DRAWN BY	DATE	CHK	SCALE
WL	2/93	GRM	NONE
SHEET 1 OF 1			SIZE
			B

## X-ON Electronics

Largest Supplier of Electrical and Electronic Components

*Click to view similar products for [Wire Ducting & Raceways](#) category:*

*Click to view products by [Panduit](#) manufacturer:*

Other Similar products are found below :

[FG5EI25-A](#) [PED12](#) [PED8](#) [PEVEP](#) [FXOE3-10M3](#) [FZD3-3M2](#) [FZLE10-10M2](#) [FZOE10-10M1](#) [FZOLE10-10M2](#) [FZPE3-10M2](#) [923223-000](#)  
[PRAF6WH-X](#) [A0405538](#) [1301150342](#) [1301230083](#) [1301150343](#) [1301230086](#) [1301240054](#) [AX101472](#) [AX102652](#) [AX102653](#) [AX102737](#)  
[S62DS](#) [S65DS](#) [S75DSH](#) [A0405536](#) [A0405537](#) [A0649869](#) [FXOD3-3M1](#) [FXOE10-10M2](#) [FZLD3-3M2](#) [FZOE3-10M1](#) [FZOE3-10M2](#)  
[FZOLE3-10M2](#) [FZOPE10-10M1](#) [FZPD3-3M2](#) [PZRFE4](#) [PZWIFIEN](#) [PZWIFIENA](#) [CNPSNH](#) [CNSPC](#) [5400ES](#) [WDLT-1216-72](#) [655287-000](#)  
[S75DS](#) [1301180028](#) [801A-LSP](#) [TGECAW](#) [206461-000](#) [853425-000](#)