

THIS COPY IS PROVIDED ON A RESTRICTED BASIS AND IS NOT TO BE USED IN ANY WAY DETRIMENTAL TO THE INTERESTS OF PANDUIT CORP.

| PART NUMBER  | PANEL THICKNESS           | WIRE DIAMETER             | RECOMMENDED FOR USE WITH 1000V SOLAR WIRES | DIMENSIONS - IN [mm] |               |              |              |
|--------------|---------------------------|---------------------------|--|----------------------|---------------|--------------|--------------|
|              |                           |                           |  | F                    | H             | S            | W            |
| MEC100-PV-C  | .051-.098"<br>[1.3-2.5mm] | .161-.240"<br>[4.1-6.1mm] | 1 OR 2<br>12 GAUGE, USE-2 WIRES            | .44<br>[11.2]        | .73<br>[18.5] | .20<br>[5.1] | .38<br>[9.7] |
| MEC100-2PV-C | .051-.098"<br>[1.3-2.5mm] | .200-.300"<br>[5.1-7.6mm] | 1 OR 2<br>10 GAUGE, PV WIRES               | .44<br>[11.2]        | .73<br>[18.5] | .28<br>[7.1] | .38<br>[9.7] |

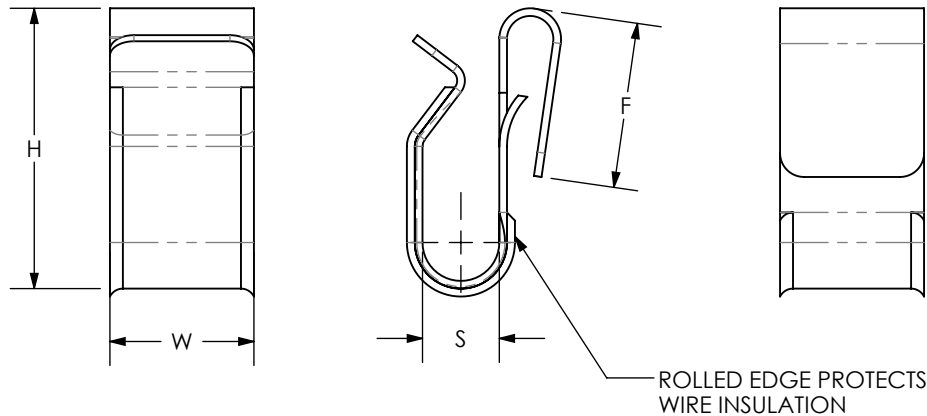
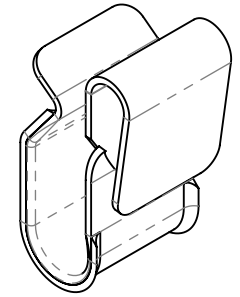

**NOTES:**

1. UL LISTED TO US AND CANADIAN REQUIREMENTS UNDER FILE E136577
2. MATERIAL: .02" [.5] THICK 410 STAINLESS STEEL
3. CABLE ORIENTATION IS PARALLEL TO PANEL EDGE
4. NO INSTALLATION TOOLS REQUIRED
5. PACKAGING QTY: C = 100

| REV | DATE  | BY   | CHK | APR | DESCRIPTION                                | ECN    |
|-----|-------|------|-----|-----|--|--------|
| 01  | 12/19 | JHNU | TMR | RGB | REVISED UPPER LIMIT ON WIRE DIAMETER RANGE | 056434 |
| 00  | 11/19 | JHNU | TMR | RGB | DRAWING RELEASED                           | 056434 |

|  |  |  |  |  |  |  |  |
|--|--|--|--|--|--|--|--|
| TITLE  |  |  |  | SOLAR METAL EDGE CLIP<br>(MEC100-PV-C, MEC100-2PV-C)<br>CUSTOMER DRAWING |  |  |  |
| ITEM REVISION NAME   |  |  |  | 00494EBK/00  |  |  |  |
| DATASET FILE NAME  |  |  |  | 00494EBK-DC/00.SLDDRW  |  |  |  |
| UNLESS OTHERWISE SPECIFIED,<br>DIMENSIONAL TOLERANCES ARE: IN [mm] |  |  |  | MATERIAL   |  |  |  |
| .X ±<br>.XX ± .04 [1.0]  |  |  |  | .XXX ±<br>ANGLES ±   |  |  |  |
| DRAWN BY   |  |  |  | DRAWING NUMBER   |  |  |  |
| JHNU   |  |  |  | 00494EBK-DC  |  |  |  |
| DATE   |  |  |  | SCALE  |  |  |  |
| 11/19  |  |  |  | N/A  |  |  |  |
| CHK  |  |  |  | SHEET 1 OF 1   |  |  |  |
| TMR  |  |  |  | SIZE   |  |  |  |
| A  |  |  |  |  |  |  |  |

SEE NOTES

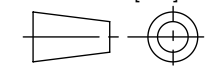

THIRD ANGLE PROJECTION

## X-ON Electronics

Largest Supplier of Electrical and Electronic Components

*Click to view similar products for [Cable Mounting & Accessories](#) category:*

*Click to view products by [Panduit](#) manufacturer:*

Other Similar products are found below :

[8945](#) [8950](#) [8961](#) [582603-1](#) [009333-000](#) [CXA-0069](#) [D-150-0175CS2902](#) [70.060.1628.0](#) [727844N003](#) [770-1102](#) [770-1204](#) [770-1205-10](#)  
[770-1301-10](#) [770-1306](#) [770-1422](#) [770-1602](#) [770-1603](#) [770-1604](#) [770-1607](#) [790-1002](#) [809090N001](#) [843188-000](#) [843459N001](#) [8666](#)  
[PVC10512-BLACK-500](#) [PVC1056-BLACK-500](#) [DB-11](#) [1301800416](#) [1302030548](#) [1302264450](#) [1300830184](#) [1300830729](#) [1300900039](#)  
[1301580036](#) [1301850553](#) [1301860900](#) [1301860939](#) [1302000074](#) [1302261315](#) [1302264431](#) [APA18-AK](#) [MSK-0001](#) [1-787307-1](#) [1868](#) [HP-](#)  
[6N](#) [C-202-C](#) [202C221-13-0](#) [CA7308-000](#) [229408-1](#) [KC-201](#)