

THIS COPY IS PROVIDED ON A RESTRICTED BASIS AND IS NOT TO BE USED IN ANY WAY DETRIMENTAL TO THE INTERESTS OF PANDUIT CORP.

| | |
|-------------|------------------------------|
| PANDUIT P/N | WEIGHT |
| NCMHAEF4 | 10.6 LBS/EACH 4808 g/EACH |

- NOTES:
- IDENTIFICATION: ACTIVE EQUIPMENT CABLE MANAGER
PANDUIT P/N: NCMHAEF4 COLOR: BLACK
 - CAN BE MOUNTED TO ANY 19" EIA STANDARD RACK.
 - COMPONENTS:
(4) 12-24 SCREWS.
(4) M6 METRIC SCREWS
 - DIMENSIONS IN PARENTHESIS ARE METRIC.

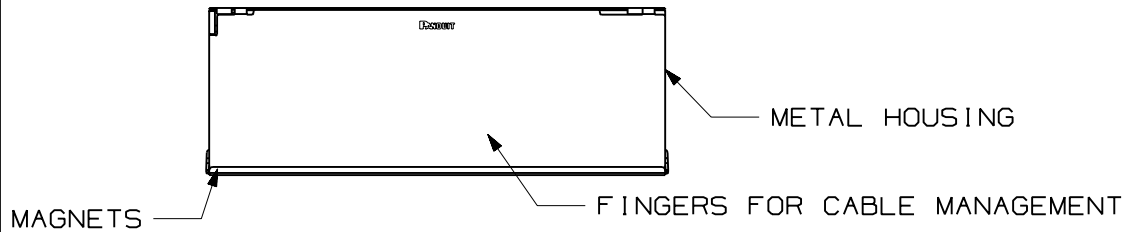
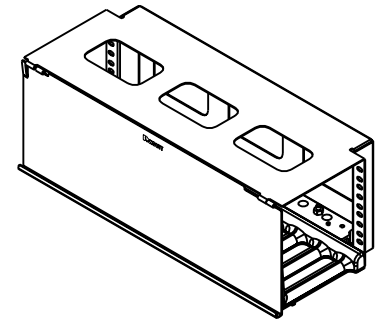
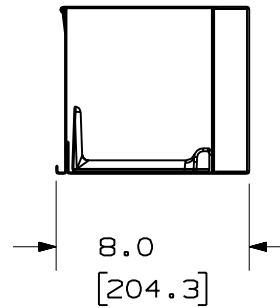
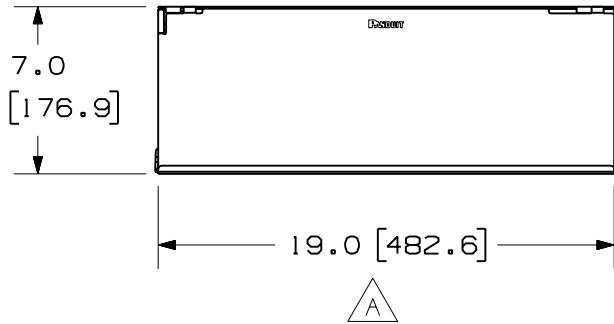
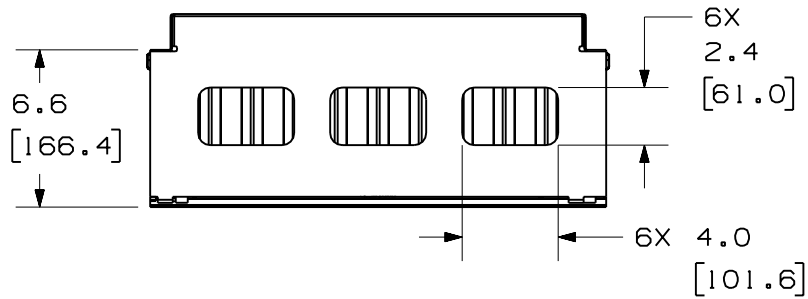

SHOWN WITH DOOR REMOVED

| | |
|---|----------------------------|
| MODEL FILENAME | V10024AA_HORIZONTAL_02.PRT |
| CAD FILENAME/LAYERS | V10024AA_DC_00B.PRT |
| <h1>PANDUIT</h1> CORP. TINLEY PARK, ILLINOIS | |
| ACTIVE EQUIPMENT CABLE MANAGER (NCMHAEF4) CUSTOMER DRAWING | |

UNLESS OTHERWISE SPECIFIED,
DIMENSIONAL TOLERANCES ARE:
(.X) ± .03 (.XXX) ± .005
(.XX) ± .015 ANGLES ± 1°

UNLESS OTHERWISE SPECIFIED,
ALL DIMENSIONS ARE GIVEN
IN INCHES, THIRD ANGLE PROJECTION.

| REV | DATE | BY | CHK | DESCRIPTION | ECN | R | CUST | SUP | OTH |
|-----|---------|------|------|---|----------|---|------|------|-----|
| 1 | 2-19-07 | MLVO | | B. METRIC MEASUREMENT CHANGED TO ONE DECIMAL PLACE. A. REPOSITIONED DIMENSION CONSTRAINTS. | 10024-07 | | | | |
| R | 3-26-02 | JDWE | MECA | RELEASED TO PRODUCTION | 10024-07 | | RTSV | RTSV | |

| | | |
|------------------|--|-------------------------|
| DRAWN BY JDWE | MAT'L: HOUSING- STEEL FINGERS- PLASTIC | SCALE NONE |
| DATE 3-26-02 | CHK'D MECA | DRAWING NO. 10024-07 |
| | | DWG SIZE A |

X-ON Electronics

Largest Supplier of Electrical and Electronic Components

Click to view similar products for [Wire Ducting](#) category:

Click to view products by [Panduit](#) manufacturer:

Other Similar products are found below :

[66200A-10](#) [CVED32VEPG](#) [CVED40VEPG](#) [F512D5-5F140Y](#) [F512D5-5F200Y](#) [F512D5-5F26Y](#) [F512D5-5F30Y](#) [F512D5-5F33Y](#) [F512D5-5F34Y](#) [F512D5-5F45Y](#) [F512D5-5F50Y](#) [F512D5-5F54Y](#) [F512D5-5F66Y](#) [F512D5-5F70Y](#) [F512D5-5F75Y](#) [F512D5-5F90Y](#) [F612D5-5F100Y](#) [F612D5-5F130Y](#) [F612D5-5F50Y](#) [F612D5-5F56Y](#) [F612D5-5F58Y](#) [F6L12D5-5F46](#) [F912D5-5F11Y](#) [F912D5-5F170Y](#) [F912D5-5F175Y](#) [F912D5-5F230Y](#) [F912D5-5F300Y](#) [F912D5-5F55Y](#) [F912D5-5F56Y](#) [F912D5-5F63Y](#) [F912D5-5F6Y](#) [F912D5-5F75Y](#) [F912D5-5F85Y](#) [F912D5-5F86Y](#) [F912D5-5F88Y](#) [F912D5-5F96Y](#) [FAP0047WBLMTP](#) [FAP12WBRDRDDLZ](#) [FAP12WDYLYLDLZ](#) [FAP12WEORORDLZ](#) [FAP6WEORORDLZ](#) [FAP6WFDBDBDLZ](#) [FAP8WEORORDLZ](#) [FCE2UWCL](#) [800A-LB](#) [802A-ECSP](#) [802I-ICSP](#) [FJQADH](#) [FJQFXT](#) [PED10](#)