

THIS COPY IS PROVIDED ON A RESTRICTED BASIS AND IS NOT TO BE USED IN ANY WAY DETRIMENTAL TO THE INTERESTS OF PANDUIT CORP.

PART NO.	LEGEND
PESG-C-1	
PESG-C-2	 <span style="float: right;">⚠</span>
PESG-C-4	 <span style="float: right;">⚠</span>

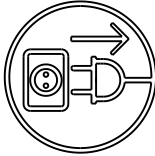
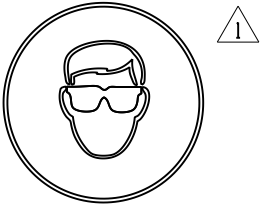
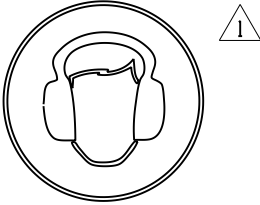
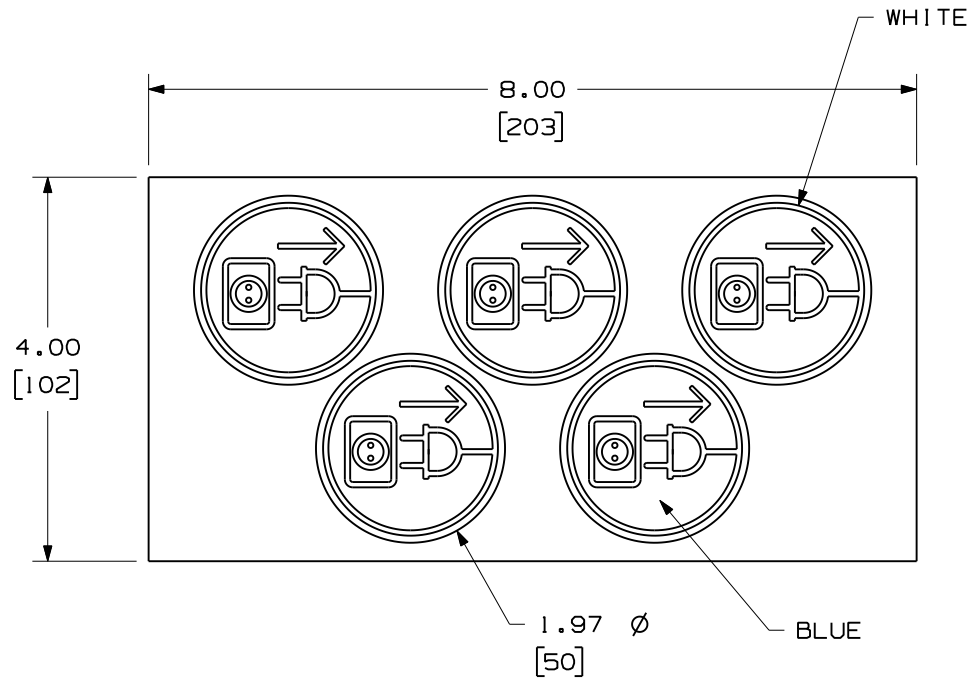

NOTE:

1. MILLIMETER ARE IN [    ].
2. 5 MARKERS PER CARD.
3. 10 CARDS PER PACKAGE.

CAD FILENAME/LAYERS		I00318LU_DC_C10660/00B	
PANDUIT		CORP. TINLEY PARK, ILLINOIS	
		CUSTOMER DRAWING PESG-C-* MANDATORY AND PROHIBITION SIGNS	
UNLESS OTHERWISE SPECIFIED, DIMENSIONAL TOLERANCES ARE: (.X) ± .1      (.XXX) ± .025 (.XX) ± .050      ANGLES ± 5°		UNLESS OTHERWISE SPECIFIED, ALL DIMENSIONS ARE GIVEN IN INCHES, THIRD ANGLE PROJECTION.	
1	7-29-09	JHAC	UPDATED LEGEND IMAGES
R	9-23-96	RVU	DRAWING RELEASE
REV	DATE	BY	CHK
DESCRIPTION			
ECN	R	CUST	SUP
DRAWN BY RVU		MAT'L:	
DATE 9/23/96		GMV1-OL VINYL FILM	
CHK'D		SCALE	
		DRAWING NO. C10660	
		DWG A SIZE	

## X-ON Electronics

Largest Supplier of Electrical and Electronic Components

*Click to view similar products for [Labels and Industrial Warning Signs](#) category:*

*Click to view products by [Panduit](#) manufacturer:*

Other Similar products are found below :

[ESSW30-025](#) [FTP-020P0704](#) [QC101](#) [QC105](#) [QCC613](#) [QCC615](#) [132465](#) [142810](#) [15288](#) [15425](#) [18511](#) [HTS795-1](#) [30288](#) [1768021-2](#) [18432](#)  
[1878679-3](#) [2-1878614-6](#) [PTL-31-427-YL](#) [30239](#) [QC154](#) [QCC612](#) [30545](#) [35070](#) [WM-15-PK](#) [WM-20-PK](#) [5-1768021-6](#) [06770](#) [11197](#)  
[111852](#) [111932](#) [KMT-02513V-9](#) [06742](#) [8-1768039-4](#) [1878983-4](#) [06736](#) [B422 25X85MM](#) [PAXLBK10](#) [LAT-52-361-1](#) [PTL-20-486](#) [PTL-](#)  
[38-486](#) [PTLFT-01-425](#) [13903](#) [11237](#) [18389](#) [18341](#) [18603](#) [29904](#) [18519](#) [18524](#) [115110](#)