

THIS COPY IS PROVIDED ON A RESTRICTED BASIS AND IS NOT TO BE USED IN ANY WAY DETRIMENTAL TO THE INTERESTS OF PANDUIT CORP.

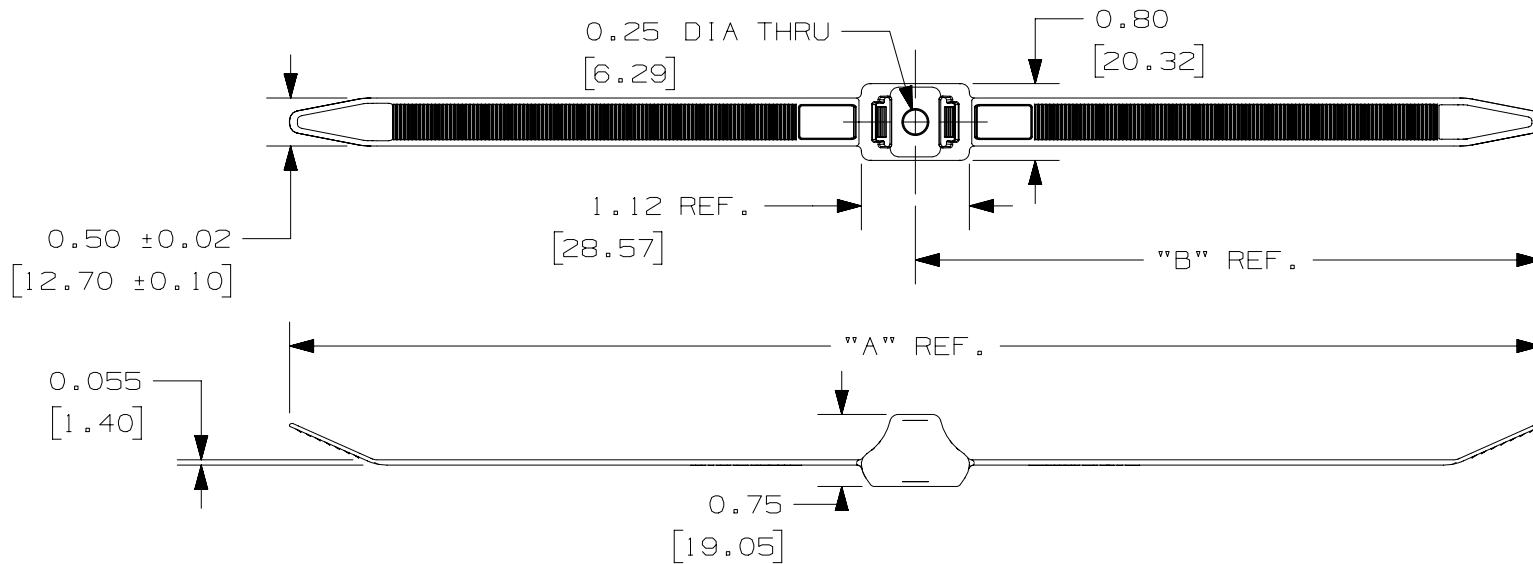

PANDUIT PART NO.	BUNDLE DIA.		"A"	"B"	MIN. LOOP TENSILE lbs. (N)	CROSS SECTION	TIP STYLE	WEIGHT lbs. (g) /100 pcs.
	MIN. in. (mm)	MAX. in. (mm)						
PLDC1.5EH	0.20 (5.1)	1.30 (33.0)	13.1 (333)	6.55 (166.4)	150 (667)	EXTRA HEAVY	CURVED	0.0226 (10.2)
PLDC2.5EH	0.20 (5.1)	2.30 (58)	19.2 (489)	9.63 (244.6)	150 (667)	EXTRA HEAVY	CURVED	0.0294 (13.3)

NOTES:
 * SEE www.panduit.com FOR PART NUMBER SUFFIX DESIGNATION FOR PACKAGE SIZE, PART MATERIAL, PART COLOR AND ANY THIRD PARTY RECOGNITION OR COMPLIANCE.

DIMENSIONS IN PARENTHESES ARE IN METRIC UNITS.

REV	DATE	BY	CHK	APR	DESCRIPTION	ECN	TITLE	ITEM REVISION NAME	DATASET FILE NAME	MATERIAL	DRAWING NUMBER
00	10/05/16	BWG	DJSL	JADE	DRAWING RELEASED.	010056/00	DOUBLE CLAMP TIE CUSTOMER DRAWING	00071SBA/08	00071SBA_DC/08 00071SBA_REV00	NYLON 6.6	00071SBA_DC
							UNLESS OTHERWISE SPECIFIED, DIMENSIONAL TOLERANCES ARE: IN (mm)		DRAWING NUMBER:		
							.x ± .02 [.5] .xx ± .02 [.5]		DRAWING NUMBER: 00071SBA_DC		
							THIRD ANGLE PROJECTION		SHT 1 OF 1		
							DRAWN BY: BWG DATE: 5/05/16		SCALE: NONE		SIZE: A

X-ON Electronics

Largest Supplier of Electrical and Electronic Components

Click to view similar products for [Cable Ties](#) category:

Click to view products by [Panduit](#) manufacturer:

Other Similar products are found below :

[20093-0](#) [SJ-3463](#) [SJ3518FR-1x50](#) [SJ3526N-Beige-2"x50yd](#) [SJ3526N BLACK 58" X 50YD](#) [SJ3571](#) [SJ-3571-1"x50yd-Black](#) [20113-0](#)
[T56137](#) [3-350087-0](#) [CTB75X75BKA-C](#) [3722](#) [561-B110120](#) [561-EZAB580T](#) [561-EZS375B40](#) [561-N3510](#) [561-TA250125](#) [08350-0](#) [08443-0](#)
[08600-0](#) [10035-0](#) [10036-0](#) [10037-0](#) [10325-0](#) [10362-0](#) [10606-0](#) [561-EZ250](#) [561-EZ500](#) [561-EZ625](#) [561-EZ750](#) [561-TA00600](#) [SJ3519FR](#)
[BLACK 1X50](#) [SJ3527N-Beige-2"x50yd](#) [SJ3527N-LOOP-BLACK-1](#) [SJ3572-2"x50yd-Black](#) [157-00039](#) [3719](#) [SJ-3401 BLACK 1"](#) [08445-0](#)
[08582-0](#) [08386-0](#) [10431-0](#) [08359-0](#) [10056-0](#) [10620-0](#) [10345-0](#) [10344-0](#) [08416-0](#) [08384-0](#) [08401-0](#)