

THIS COPY IS PROVIDED ON A RESTRICTED BASIS AND IS NOT TO BE USED IN ANY WAY DETRIMENTAL TO THE INTERESTS OF PANDUIT CORP.

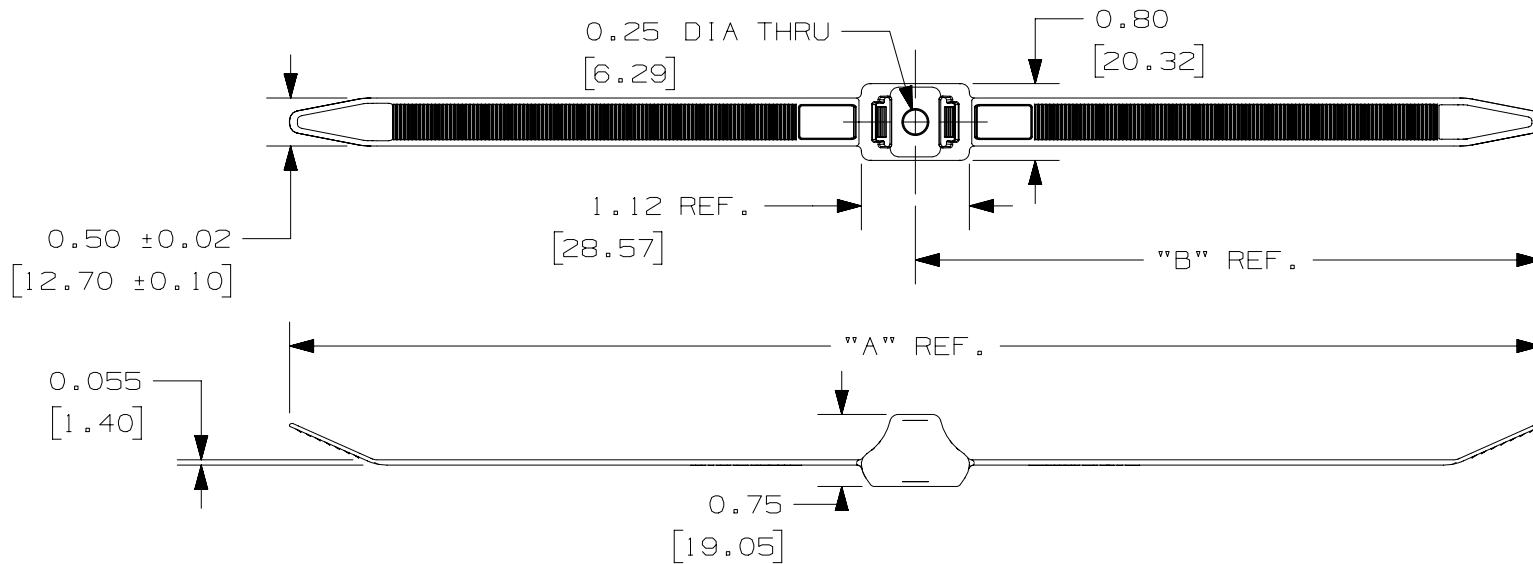

PANDUIT PART NO.	BUNDLE DIA.		"A"	"B"	MIN. LOOP TENSILE lbs. (N)	CROSS SECTION	TIP STYLE	WEIGHT lbs. (g) /100 pcs.
	MIN. in. (mm)	MAX. in. (mm)						
PLDC1.5EH	0.20 (5.1)	1.30 (33.0)	13.1 (333)	6.55 (166.4)	150 (667)	EXTRA HEAVY	CURVED	0.0226 (10.2)
PLDC2.5EH	0.20 (5.1)	2.30 (58)	19.2 (489)	9.63 (244.6)	150 (667)	EXTRA HEAVY	CURVED	0.0294 (13.3)

NOTES:
 * SEE www.panduit.com FOR PART NUMBER SUFFIX DESIGNATION FOR PACKAGE SIZE, PART MATERIAL, PART COLOR AND ANY THIRD PARTY RECOGNITION OR COMPLIANCE.

DIMENSIONS IN PARENTHESES ARE IN METRIC UNITS.

						TITLE DOUBLE CLAMP TIE					
						CUSTOMER DRAWING					
						ITEM REVISION NAME 00071SBA/08		PANDUIT			
						DATASET FILE NAME 00071SBA_DC/08 00071SBA_REV00					
						UNLESS OTHERWISE SPECIFIED, DIMENSIONAL TOLERANCES ARE: IN (mm) .x ±xxx ± .020 (.51) .xx ± .02 (.5) ANGLES ±		MATERIAL: NYLON 6.6			
00 10/05/16 BWG DJSL JADE DRAWING RELEASED.						010056/00		DRAWING NUMBER: 00071SBA_DC			
REV	DATE	BY	CHK	APR	DESCRIPTION	DRAWN BY BWG	DATE 5/05/16	CHK DJSL	SCALE NONE	SHT 1 OF 1	SIZE A

X-ON Electronics

Largest Supplier of Electrical and Electronic Components

Click to view similar products for [Cable Ties](#) category:

Click to view products by [Panduit](#) manufacturer:

Other Similar products are found below :

[65037-C](#) [770-1751-10](#) [REL50L0C2](#) [20093-0](#) [SF600-120X](#) [SJ3518FR-1x50](#) [SJ3526N-Beige-2"x50yd](#) [SJ3526N BLACK 58" X 50YD](#) [SJ3571](#)
[SJ-3571-1"x50yd-Black](#) [PLT2S-C4](#) [34-455-C](#) [3722](#) [561-B110120](#) [561-N3510](#) [TYZ528M](#) [34-463-C](#) [URT20S-M](#) [06226](#) [08350-0](#) [08600-0](#)
[08376-0](#) [10037-0](#) [10325-0](#) [10362-0](#) [10606-0](#) [1122-4JW8](#) [561-EZ250](#) [561-EZ625](#) [SJ3527N-Beige-2"x50yd](#) [SJ3527N-LOOP-BLACK-1](#)
[SJ3572-2"x50yd-Black](#) [CF5625-000](#) [65004-C](#) [65005-C](#) [65007-C](#) [65036-C](#) [157-00039](#) [770-1708](#) [770-1753-10](#) [770-1752](#) [SPNY-041-9](#)
[SF400-120X](#) [3719](#) [08582-0](#) [08386-0](#) [10431-0](#) [08359-0](#) [10620-0](#) [10345-0](#)