

THIS COPY IS PROVIDED ON A RESTRICTED BASIS AND IS NOT TO BE USED IN ANY WAY DETRIMENTAL TO THE INTERESTS OF PANDUIT CORP.

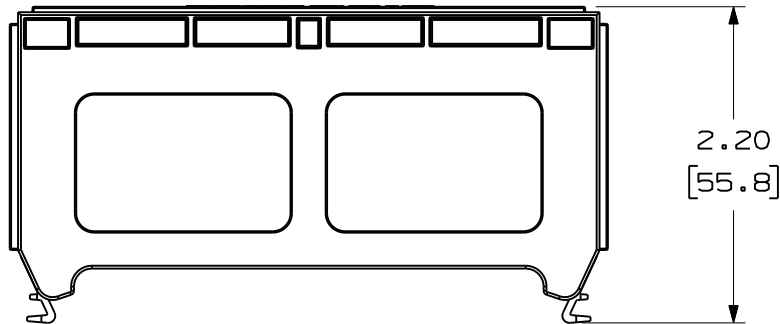
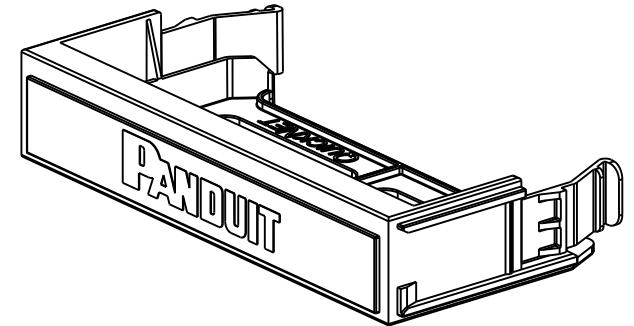
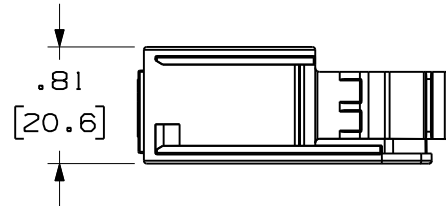
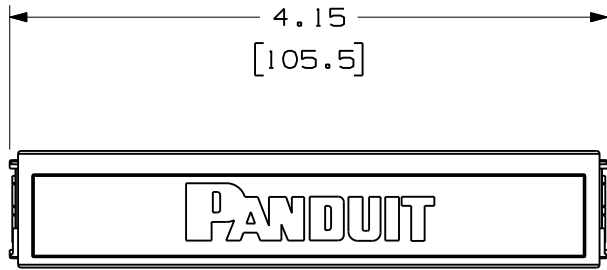

NOTES:

1. SEE CURRENT CATALOG FOR VARIOUS APPLICATIONS.
2. THE 6 PORT PANEL ADAPTER IS DESIGNED FOR USE WITH QuickNET QPP24 AND QPP48 SERIES STRAIGHT AND ANGLED PATCH PANELS.
3. DIMENSIONS IN BRACKETS ARE IN METRIC.

PANDUIT PART NUMBER	WEIGHT (APPOX.)
QPPBBL	0.04 lbs (20.0 g)



MODEL FILENAME	10F094BD/01	SIZE A
DRAWING FILENAME	M02582CJ_DC43/04C	

QuickNET PATCH PANEL
BLANK CUSTOMER DRAWING



I.I. NUMBER	
PRODUCT SPEC/ PKG SPEC	
ASSY METHOD/ TEST METHOD	
SCALE	.75 TO 1
PART NO.	QPPBBL
DRAWING NO.	02582-43

ALL DIMENSIONS ARE GIVEN IN INCHES, UNLESS OTHERWISE SPECIFIED.
DIMENSIONAL TOLERANCES ARE:
(.X) ±.03 (.XXX) ±.005
(.XX) ±.01 ANGLES ± 1°

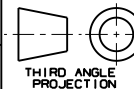

DRAWN BY	KSM
DATE	1-03-07
CHK'D	WFM

REVIEW DRAWING NUMBERS	
MAT'L	BLACK POLYCARBONATE

REV	DATE	BY	CHK	DESCRIPTION	ECN	R	CUST	SUP	OTH
2	3-11-11	BJN	WFM	B. UPDATED MODEL TO 10F094BD/01	02582-43		JPMC		
1	5-25-07	MDJr	WFM	A. UPDATED MODEL TO REVISION 04	02582-43		TRW		
R	1-31-07	MDJr	WFM	RELEASED FOR PRODUCTION	02582-43				

X-ON Electronics

Largest Supplier of Electrical and Electronic Components

Click to view similar products for [Racks & Rack Cabinet Accessories](#) category:

Click to view products by [Panduit](#) manufacturer:

Other Similar products are found below :

[M00-PLN](#) [F2424](#) [8351-832-A-24](#) [9104](#) [9105](#) [PLFF2000](#) [H-9163-B](#) [1427C3](#) [HTS10](#) [PC-79](#) [SC10-3A](#) [SC4-28](#) [CG3-340S/12](#) [CP-001BK](#)
[M6123-4007-SS](#) [AX61400TB](#) [TS170](#) [LP40](#) [5261304-07](#) [CG3-160G](#) [7112C-PLN](#) [ALUM](#) [CM10](#) [8610-3124-S-26](#) [TS81](#) [7142](#) [GP134](#)
[M6125-4007-A-24](#) [M6127-4007-SS](#) [PBCOVER](#) [512](#) [AEG-4000G](#) [AEG-3000G](#) [HD99](#) [SR2-66A2](#) [FP10B4HP-1](#) [FP52-2](#) [1406-1006-01](#)
[29478](#) [TS2535](#) [TS169-6](#) [CAC2](#) [HA19-3U](#) [BR-19-10-1](#) [TS180](#) [CG3-ESD](#) [SC11-1](#) [CFS-1.00/2.20](#) [AX6145WM](#) [HEC0800PB](#) [ZC633R](#)