

THIS COPY IS PROVIDED ON A RESTRICTED BASIS AND IS NOT TO BE USED IN ANY WAY DETRIMENTAL TO THE INTERESTS OF PANDUIT CORP.

NOTES:

1. 4-POST RACK WITH CAGE NUT EQUIPMENT
RAIL GROUND BAR KIT
PART NUMBER: RGRB19CN
2. PACKAGING: 1 KIT PER BOX
3. DIMENSIONS IN PARENTHESIS ARE MILLIMETERS.
4. ALL COMPONENTS THAT MAKE UP THIS KIT
ARE ROHS COMPLIANT.

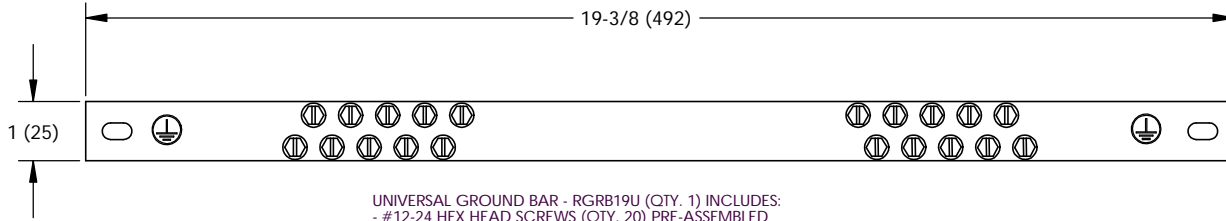

UNIVERSAL GROUND BAR - RGRB19U (QTY. 1) INCLUDES:
- #12-24 HEX HEAD SCREWS (QTY. 20) PRE-ASSEMBLED

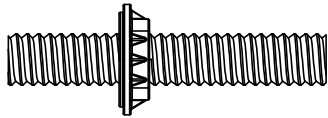

CAGE NUT BONDING STUD (QTY. 2)

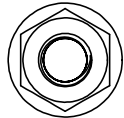

#12-24 BONDING NUT (QTY. 4)

C41669_00

PANDUIT CORP. TINLEY PARK, ILLINOIS

EQUIPMENT RAIL CAGE NUT
GROUNDING BUSBAR KIT (RGRB19CN)
CUSTOMER DRAWING

UNLESS OTHERWISE SPECIFIED
DIMENSIONAL TOLERANCES ARE:
(X) ± (XXX) ±
(XX) ± ANGLES ±

UNLESS OTHERWISE SPECIFIED,
ALL DIMENSIONS ARE GIVEN IN
INCHES, THIRD ANGLE PROJECTION

DRAWN BY JHNU MAT'L:

SCALE NONE

DATE 6/06

DRAWING NO / CAD FILE

| REV | DATE | BY | CHK | DESCRIPTION | ECN | PM | CUST |
|-----|------|------|------|------------------|---------|----|------|
| 00 | 6/06 | JHNU | JMAR | DRAWING RELEASED | PC00466 | | |

CHK'D

C41669

DWG
B
SIZE

X-ON Electronics

Largest Supplier of Electrical and Electronic Components

Click to view similar products for [Racks & Rack Cabinet Accessories](#) category:

Click to view products by [Panduit](#) manufacturer:

Other Similar products are found below :

[M00-PLN](#) [F2424](#) [8351-832-A-24](#) [9104](#) [9105](#) [PLFF2000](#) [H-9163-B](#) [1427C3](#) [HTS10](#) [PC-79](#) [SC10-3A](#) [SC4-28](#) [CG3-340S/12](#) [CP-001BK](#)
[M6123-4007-SS](#) [AX61400TB](#) [TS170](#) [LP40](#) [5261304-07](#) [CG3-160G](#) [7112C-PLN](#) [ALUM](#) [CM10](#) [8610-3124-S-26](#) [TS81](#) [7142](#) [GP134](#)
[M6125-4007-A-24](#) [M6127-4007-SS](#) [PBCOVER](#) [512](#) [AEG-4000G](#) [AEG-3000G](#) [HD99](#) [SR2-66A2](#) [FP10B4HP-1](#) [FP52-2](#) [1406-1006-01](#)
[29478](#) [TS2535](#) [TS169-6](#) [CAC2](#) [HA19-3U](#) [BR-19-10-1](#) [TS180](#) [CG3-ESD](#) [SC11-1](#) [CFS-1.00/2.20](#) [AX6145WM](#) [HEC0800PB](#) [ZC633R](#)