

THIS COPY IS PROVIDED ON A RESTRICTED BASIS AND IS NOT TO BE USED IN ANY WAY DETRIMENTAL TO THE INTERESTS OF PANDUIT CORP.

PART NUMBER	NOMINAL SIZE	THICKNESS	O.D.
SBITW25-C	1/4	.028 [0.71]	.48 [12.2]
SBITW31-C	5/16	.034 [0.86]	.61 [15.5]
SBITW38-C	3/8	.040 [1.0]	.69 [17.5]
SBITW44-C	7/16		.79 [20.0]
SBITW50-C	1/2	.045 [1.14]	.90 [22.9]
SBITW62-C	5/8	.050 [1.27]	1.07 [27.2]

NOTES:

1. MATERIAL: PHOSPHORUS BRONZE
2. DIMENSIONS IN BRACKETS ARE MILLIMETERS
3. PKG. QTY.:
C = 100

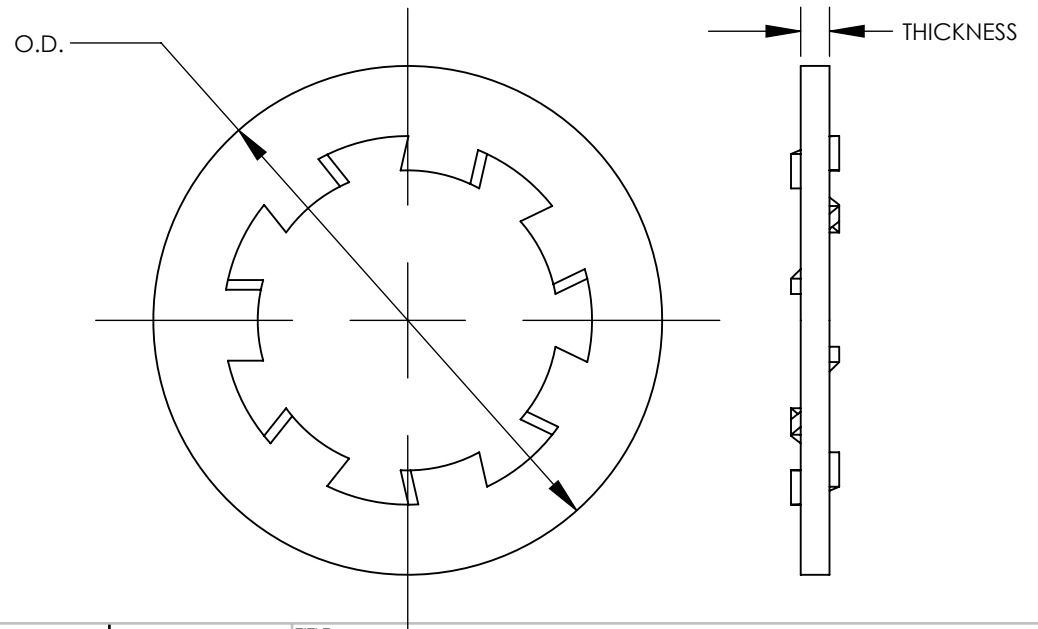

REV	DATE	BY	CHK	APR	DESCRIPTION	ECN
00	2/16	JHNU	JHNU	RGB	DRAWING RELEASED	15J350BE-DC

TITLE SILICON BRONZE INTERNAL TOOTH WASHER (SBITW SERIES) CUSTOMER DRAWING			
ITEM REVISION NAME		15J350BE/00	
DATASET FILE NAME		15J350BE-DC/00.SLDDRW	
UNLESS OTHERWISE SPECIFIED, DIMENSIONAL TOLERANCES ARE: IN [mm]			
.X ±		.XXX ±	
.XX ± .02 [0.5]		ANGLES ±	
		THIRD ANGLE PROJECTION	
DRAWN BY		DATE	
JHNU		2/16	
CHK		SCALE	
RGB		N/A	
DRAWING NUMBER			SIZE
15J350BE-DC			A
SHEET 1 OF 1			



MATERIAL
SEE NOTES

X-ON Electronics

Largest Supplier of Electrical and Electronic Components

Click to view similar products for [Terminals](#) category:

Click to view products by [Panduit](#) manufacturer:

Other Similar products are found below :

[00-054007-01074-6](#) [00-054007-70206-1](#) [00-054007-70210-8](#) [00-054007-70217-7](#) [00-054007-70226-9](#) [00-054007-70228-3](#) [00-054007-70248-1](#) [00-054007-70256-6](#) [00-054007-70301-3](#) [00-054007-70316-7](#) [0-0320562-0](#) [00-054007-49560-4](#) [00-054007-70209-2](#) [00-054007-70225-2](#) [00-054007-70227-6](#) [00-054007-70231-3](#) [00-054007-70241-2](#) [00-054007-70242-9](#) [00-054007-70244-3](#) [00-054007-70246-7](#) [00-054007-70263-4](#) [00-054007-70288-7](#) [00-054007-70290-0](#) [00-054007-70300-6](#) [00-054007-70304-4](#) [01-2065-1-0216](#) [01-2900-1-04412](#) [00581P0075](#) [600TS-10](#) [60205-1](#) [604200-1](#) [605601-1](#) [60598-1-CUT-TAPE](#) [61314-6-C](#) [61810-3](#) [61-S](#) [61-SN](#) [626-0194](#) [62-NBM-A](#) [62-SN](#) [62-SP](#) [63-S](#) [640179-1](#) [M55155/059I03](#) [M55155/079C01](#) [M55155/099H02](#) [M55155/109H01](#) [M55155/109H02](#) [M55155/12XH05](#) [M55155/16XH02](#)