

THIS COPY IS PROVIDED ON A RESTRICTED BASIS AND IS NOT TO BE USED IN ANY WAY DETRIMENTAL TO THE INTERESTS OF PANDUIT CORP.

PANDUIT P/N	WEIGHT
T70FH4	.77 LB/10 PCS (350 g/10 PCS)

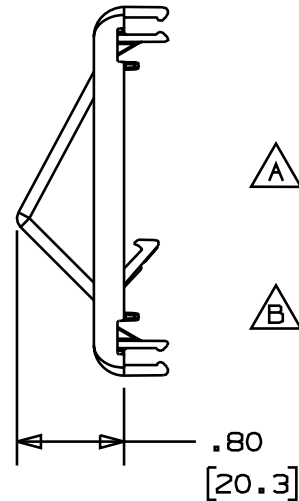
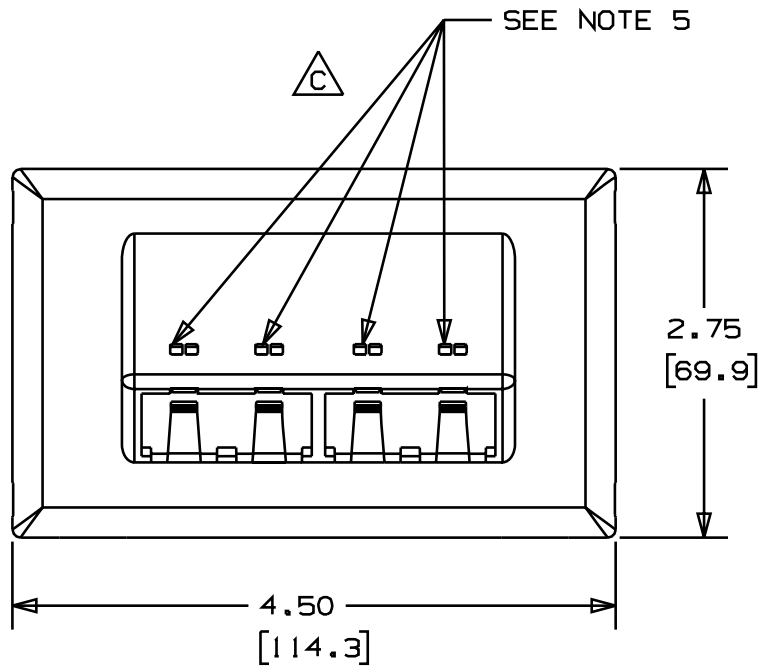

NOTES:

- SEE CURRENT CATALOG FOR ADDITIONAL PART SUFFIXES TO INDICATE COLOR AND OR PACKAGE QUANTITY.
- THE T70FH4 ACCEPTS 4 MINI-COM MODULES.
- DIMENSIONS IN PARENTHESES ARE IN METRIC.
- A THE T70FH4 FACEPLATE CAN BE USED WITH PANDUIT SURFACE RACEWAY SYSTEMS AND BOXES THAT ACCEPT 70mm SNAP-ON FACEPLATES (INCLUDES: T-70, TWIN-70, TE70, TG-70, ETC.)
- B POCKETS TO BE USED WITH PANDUIT PART NUMBER CIP***-C AND CIP***-C

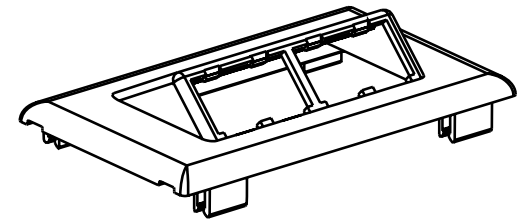

CAD FILENAME/LAYERS D37245BF_DC_T70PBH2_00C

PANDUIT CORP. TINLEY PARK, ILLINOIS
 FOUR MINI-COM MODULE HORIZONTAL
 SLOPED SNAP-ON FACEPLATE (T70FH4)
 CUSTOMER DRAWING

UNLESS OTHERWISE SPECIFIED,
 DIMENSIONAL TOLERANCES ARE:
 (.X) ± (.XXX) ±
 (.XX) ± .03 (.8) ANGLES ±

UNLESS OTHERWISE SPECIFIED,
 ALL DIMENSIONS ARE GIVEN
 IN INCHES, THIRD ANGLE PROJECTION.

REV	DATE	BY	CHK	DESCRIPTION	ECN	R	CUST	SUP
2	4/18/00	REWE	HIW	C. REVISED GEOMETRY TO INCLUDE ICON POCKETS B. ADDED NOTE 5	37245-07	HIW	HIW	
1	3/2/00	JHNU	HIW	A. ADDED NOTE 4	37245-07	HIW	HIW	
R	9/7/99	DW	CEO	RELEASED TO PRODUCTION.	37245-07	HIW	HIW	

DRAWN BY DW	MATERIAL: PVC	SCALE NONE
DATE 8/12/99		DRAWING NO. 37245-07
CHK'D HIW		DWG A SIZE

X-ON Electronics

Largest Supplier of Electrical and Electronic Components

Click to view similar products for [Wire Ducting & Raceways](#) category:

Click to view products by [Panduit](#) manufacturer:

Other Similar products are found below :

[800A-LB](#) [801I-LSP](#) [802A-ECSP](#) [802I-ICSP](#) [923223-000](#) [PRAF6WH-X](#) [A0405538](#) [1301150342](#) [1301160034](#) [1301170070](#) [1301180011](#)
[1301230083](#) [1301230153](#) [1301240273](#) [1301250006](#) [1302261238](#) [1302261321](#) [1302262552](#) [1302263103](#) [1302263178](#) [1302263259](#)
[1302263816](#) [1302263860](#) [1302264375](#) [1302264390](#) [1301150343](#) [1301160030](#) [1301170050](#) [1301170051](#) [1301170061](#) [1301180013](#)
[1301230086](#) [1301230130](#) [1301240054](#) [1302260055](#) [1302260376](#) [1302261343](#) [1302261344](#) [1302262674](#) [1302263095](#) [1302263166](#)
[1302263209](#) [1302263513](#) [1302263851](#) [1302263870](#) [1302264137](#) [1302264218](#) [DD1/J](#) [AX101472](#) [AX102007](#)