

THIS COPY IS PROVIDED ON A RESTRICTED BASIS AND IS NOT TO BE USED IN ANY WAY DETRIMENTAL TO THE INTERESTS OF PANDUIT CORP.

PANDUIT PART NUMBER *	WEIGHT lbs/100 pcs (g)/100 pcs	MAXIMUM BUNDLE CAPACITY	PANEL DIMENSIONS	
			THICKNESS	HOLE SIZE
VWS106----	0.397 (180)	1.06 (26.9)	UP TO 0.090 (UP TO 2.29)	0.187 (4.76)

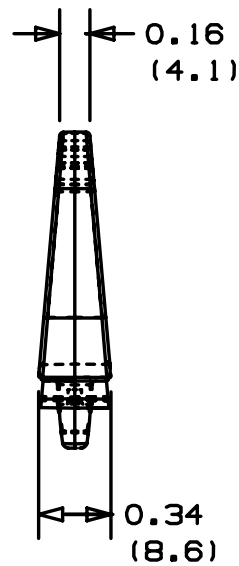

- NOTES:
* 1. SEE CURRENT PRICE SHEET FOR PART NUMBER SUFFIX DESIGNATION FOR PACKAGE SIZE.
2. -20 MATERIAL DESIGNATION IS PIGMENTED BLACK

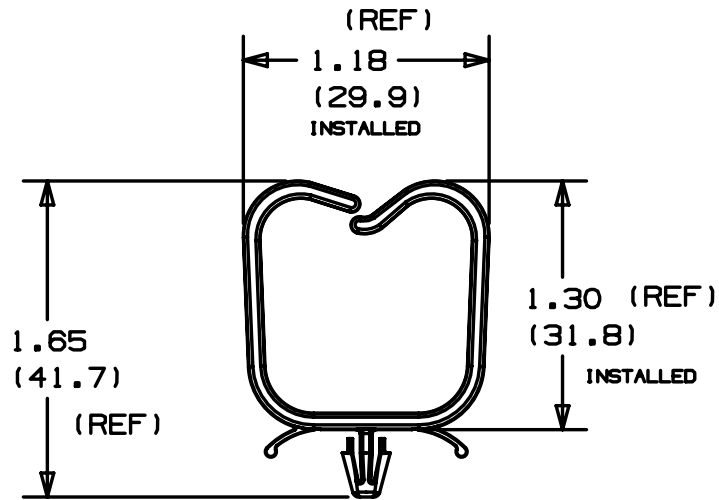
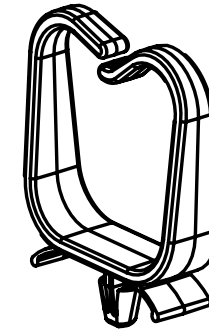

DIMENSIONS IN BRACKETS ARE METRIC [mm]

CAD FILENAME/LAYERS G01332BB_PB_VWS106_03

PANDUIT CORP. TINLEY PARK, ILLINOIS

VWS106-
VERTICAL WIRE SADDLE

UNLESS OTHERWISE SPECIFIED,
DIMENSIONAL TOLERANCES ARE:
(.X) ±0.05 [1.3] (.XXX) ±0.010 [0.25]
(.XX) ±0.02 [0.5] ANGLES ± 5°

UNLESS OTHERWISE SPECIFIED,
ALL DIMENSIONS ARE GIVEN
IN INCHES, THIRD ANGLE PROJECTION.

DRAWN BY JAD MAT'L:

SCALE NONE

DATE 7-24-97

NYLON 6/6

DRAWING NO.

GB1332BB

DWG
A
SIZE

REV	DATE	BY	CHK	DESCRIPTION	ECN	R	CUST	SUP
3	7-03-01	LGG		UPDATED AND ADDED REF	G01332BB	3		
2	4-21-98	MLD		DIM 0.34 (8.6) WAS 0.36 (9.1)	G01332BB	2		
1	7-29-97	JAD		MAX PANEL THICKNESS CHANGED FROM .105 TO .090. ADDED 1.18 DIM, ADDED 'INSTALLED' TO 1.3 DIM.	G01332BB	1		
R	7-24-97	JAD		INITIAL RELEASE	G01332BB	R		

X-ON Electronics

Largest Supplier of Electrical and Electronic Components

Click to view similar products for [Cable Mounting & Accessories](#) category:

Click to view products by [Panduit](#) manufacturer:

Other Similar products are found below :

[582603-1](#) [009333-000](#) [727844N003](#) [747](#) [809090N001](#) [843188-000](#) [8666](#) [967279N002](#) [DB-11](#) [1300840039](#) [1300900096](#) [1301800416](#)
[1302264450](#) [1300830184](#) [1300830729](#) [1300900039](#) [1301580036](#) [1301850553](#) [1301860939](#) [1302000074](#) [1302261315](#) [1302264431](#)
[1337706-2](#) [APA18-AK](#) [1724](#) [1-787307-1](#) [185491N001](#) [1868](#) [HP-6N](#) [C-202-C](#) [202C221-13-0](#) [CA7308-000](#) [8S23-75FR-CS8184](#) [2684](#) [9648](#)
[3089](#) [988382-000](#) [A72821-000](#) [AA401](#) [173506-000](#) [1823](#) [202C292-13-0](#) [202C302-13-0](#) [2109](#) [300625](#) [3330](#) [3412](#) [356247-1](#) [M9142](#)
[M9143](#)