

THIS COPY IS PROVIDED ON A RESTRICTED BASIS AND IS NOT TO BE USED IN ANY WAY DETRIMENTAL TO THE INTERESTS OF PANDUIT CORP.

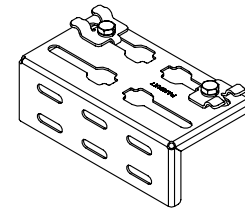
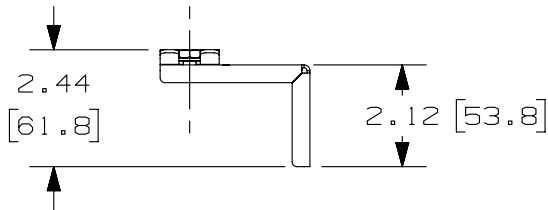
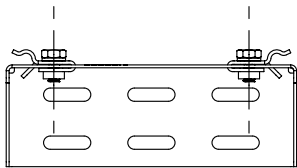
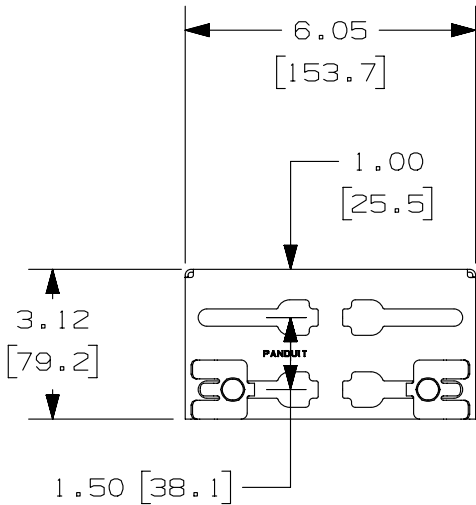

PANDUIT PART NUMBER	WEIGHT
WGWMTB8	.57 LBS (259 g)

NOTES 1

1. SEE CURRENT CATALOG FOR PART NUMBER DESIGNATION FOR TYPE AND COLOR.
2. WYR-GRID WALL MOUNT BRACKET MOUNTS TO A VERTICAL SURFACE, SUCH AS A WALL, TO SUPPORT WYR-GRID PATHWAY.
3. EACH PACKAGE CONSISTS OF:
  - (1) WYR-GRID WALL MOUNT BRACKET
  - (2) WYR-GRID QUICK LOCK CLIP
  - (2) 1/4-20x1/2 HEX HEAD CAP SCREW
  - (2) 1/4 HELICAL SPRING LOCKWASHER
4. DIMENSIONS IN PARENTHESES ARE METRIC.

REV	DATE	BY	CHK	APR	DESCRIPTION	ECN
R	12-05-13	SSP	DWW	RN	RELEASED TO PRODUCTION	09D017IR-DC

TITLE		WYR-GRID 8" WALL MOUNT TERMINATION BRACKET (WGWMTB8)	
CUSTOMER DRAWING			
ITEM REVISION NAME		09D017IR/00	
DATASET FILE NAME		09D017IR_DC/00A WGWMTB8	
UNLESS OTHERWISE SPECIFIED, DIMENSIONAL TOLERANCES ARE: IN (mm)		MATERIAL:	
.X ± .XX ± .05 [ 1.3 ]		STEEL	
.XXX ± ANGLES ± 5 °		DRAWING NUMBER:	
THIRD ANGLE PROJECTION		09D017IR-DC	
DRAWN BY	DATE	CHK	SCALE
SSP	12-05-13	DWW	NONE
SHT 1 OF 1			SIZE
			A

D10100DA/16

## X-ON Electronics

Largest Supplier of Electrical and Electronic Components

*Click to view similar products for [Wire Ducting & Raceways](#) category:*

*Click to view products by [Panduit](#) manufacturer:*

Other Similar products are found below :

[800A-LB](#) [801I-LSP](#) [802A-ECSP](#) [802I-ICSP](#) [923223-000](#) [PRAF6WH-X](#) [A0405538](#) [1301150342](#) [1301160034](#) [1301170070](#) [1301180011](#)  
[1301230083](#) [1301230153](#) [1301240273](#) [1301250006](#) [1302261238](#) [1302261321](#) [1302262552](#) [1302263103](#) [1302263178](#) [1302263259](#)  
[1302263816](#) [1302263860](#) [1302264375](#) [1302264390](#) [1301150343](#) [1301160030](#) [1301170050](#) [1301170051](#) [1301170061](#) [1301180013](#)  
[1301230086](#) [1301230130](#) [1301240054](#) [1302260055](#) [1302260376](#) [1302261343](#) [1302261344](#) [1302262674](#) [1302263095](#) [1302263166](#)  
[1302263209](#) [1302263513](#) [1302263851](#) [1302263870](#) [1302264137](#) [1302264218](#) [DD1/J](#) [AX101472](#) [AX102007](#)