

LED machine light - PLD M 280 W-40 284 - 2702491

Please be informed that the data shown in this PDF Document is generated from our Online Catalog. Please find the complete data in the user's documentation. Our General Terms of Use for Downloads are valid (<http://phoenixcontact.com/download>)



LED machine light, 24 V DC, emission angle 40 °, color temperature 6500 K, length 284 mm, Light housing: Anodized aluminum, Pane: Single-pane safety glass (ESG, thermally toughened float glass), resistant to coolants and lubricants

Product Description

This LED machine light is designed to provide illumination inside or on machinery. You can use the light in harsh environments.

This is possible thanks to:

- The high degree of protection
- Resistance to common cooling agents and lubricants
- Resistance to vibrations and shock
- The safety glass

The IP67/IPX9 protection allows use in machines that undergo high-pressure cleaning.

Your advantages

- ✓ Space saving, thanks to the low height
- ✓ Ready to connect by means of punched-on 3 m supply line
- ✓ Focused illumination, thanks to 40° emission angle
- ✓ IP67 protection and resistance to cooling agents and lubricants enables use in machine tools
- ✓ IP69 protection enables use even under the most demanding requirements in terms of the degree of protection
- ✓ Safety glass enables use even in environments with potential mechanical strain
- ✓ ETL approval permits use on the North American market
- ✓ Particularly economical thanks to energy-efficient LED technology and an LED service life of at least 50,000 h

Key Commercial Data

Packing unit	1 pc
GTIN	 4 055626 216850
GTIN	4055626216850

Technical data

Dimensions

Width	74 mm
Height	20 mm

LED machine light - PLD M 280 W-40 284 - 2702491

Technical data

Dimensions

Length	284 mm
--------	--------

Ambient conditions

Ambient temperature (operation)	0 °C ... 40 °C
Ambient temperature (storage/transport)	-20 °C ... 50 °C
Permissible humidity (operation)	95 %
Permissible humidity (storage/transport)	95 % (non-condensing)
Air pressure (operation)	69 kPa ... 102 kPa
Air pressure (storage/transport)	69 kPa ... 102 kPa
Degree of protection	IP67/IPX9

General

Color	aluminum color
Net weight	1000 g
Mounting type	Screw mounting
Mounting position	any

Power supply for module electronics

Connection method	open cable end
Cable length	approx. 3 m
Supply voltage	24 V DC
Supply voltage range	22 V DC ... 26 V DC
Current consumption	typ. 0.54 A (at 24 V DC)
Power consumption	approx. 13 W (at 24 V DC)
Type of protection	Surge protection
	Reverse polarity protection

Light properties

Source of light type	LED
Number of LEDs	6
Service life, lighting appliance	50,000 h (L70)
Light color	daylight white
Color temperature / wavelength	6500 K ±10 %
Color rendering index	65
Luminous flux	approx. 460 lm (Net luminous flux)
Illumination	max. 869 lx (Distance of 1 m)
Average illumination	347 lx (Distance of 1 m over 1 m ² area)
Emission angle	40 °

Standards and Regulations

Protection class	III (IEC 61140, EN 61140, VDE 0140-1)
------------------	---------------------------------------

Environmental Product Compliance

China RoHS	Environmentally Friendly Use Period = 50 years
------------	--

LED machine light - PLD M 280 W-40 284 - 2702491

Technical data

Environmental Product Compliance

	For details about hazardous substances go to tab "Downloads", Category "Manufacturer's declaration"
--	---

Drawings

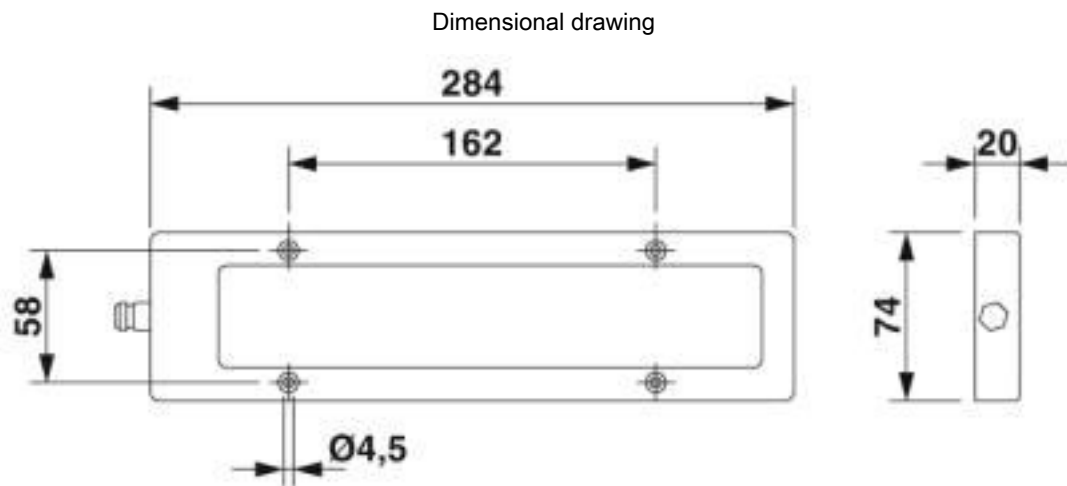

Classifications

eCl@ss

eCl@ss 10.0.1	27110345
eCl@ss 4.0	27110800
eCl@ss 4.1	27110800
eCl@ss 5.0	27119100
eCl@ss 5.1	27119100
eCl@ss 7.0	27119010
eCl@ss 8.0	27119010
eCl@ss 9.0	27110345

ETIM

ETIM 3.0	EC000348
ETIM 4.0	EC000348
ETIM 5.0	EC000348
ETIM 6.0	EC000302
ETIM 7.0	EC000302

UNSPSC

UNSPSC 6.01	39111510
UNSPSC 7.0901	39111510
UNSPSC 11	39111510

LED machine light - PLD M 280 W-40 284 - 2702491

Classifications

UNSPSC

UNSPSC 12.01	39111510
UNSPSC 13.2	39101601
UNSPSC 18.0	39101601
UNSPSC 19.0	39101601
UNSPSC 20.0	39101601
UNSPSC 21.0	39101601

Approvals

Approvals

Approvals

ETLus / cETL / cETLus

Ex Approvals

Approval details

ETLus		http://www.intertek.com	LV-Lighting-Systems
-------	--	---	---------------------

cETL		http://www.intertek.com	Luminaires
------	--	---	------------

cETLus			
--------	--	--	--

Phoenix Contact 2020 © - all rights reserved
<http://www.phoenixcontact.com>

PHOENIX CONTACT GmbH & Co. KG
Flachsmarktstr. 8
32825 Blomberg
Germany
Tel. +49 5235 300
Fax +49 5235 3 41200
<http://www.phoenixcontact.com>

X-ON Electronics

Largest Supplier of Electrical and Electronic Components

Click to view similar products for [LED Lighting Fixtures](#) category:

Click to view products by [Phoenix Contact](#) manufacturer:

Other Similar products are found below :

[1301080067](#) [XVEC21P](#) [XVEC2B7](#) [2576960000](#) [113163000-00662717](#) [113472000-00691461](#) [XVBC2B3](#) [XVBC2B7](#) [XVBC4B4](#) [XVBC4B5](#)
[XVBC4B6](#) [XVBC4M3](#) [XVBC4M4](#) [XVBC4M5](#) [XVBC4M8](#) [XVBZ01](#) [XVBZ03A](#) [XVBZ04](#) [E35600](#) [NB-RLAMP01-LED](#) [FLK7LED](#)
[XVBZ04A](#) [XVBC4M7](#) [XVBC4M6](#) [XVBC4B3](#) [XVBC2B8](#) [2700127](#) [2702933](#) [2702477](#) [2403122](#) [2403121](#) [2402991](#) [89406068](#) [148-00076](#)
[113261000-00641180](#) [190007019-00014904](#) [226108019-00610754](#) [4823](#) [4824](#) [4868](#) [112887037-00076065](#) [113021000-00564565](#)
[113473000-00704968](#) [NB-RLAMP01](#) [112577000-00539774](#) [113458000-00668976](#) [E35500](#) [408001403-00671626](#) [SL7/4-FW](#) [LML-6TER-](#)
[CAB](#)