

# Head-mounted transducer - MCR-FL-HT-T-I-EX - 2864532

Please be informed that the data shown in this PDF Document is generated from our Online Catalog. Please find the complete data in the user's documentation. Our General Terms of Use for Downloads are valid (<http://phoenixcontact.com/download>)



MCR head-mounted temperature transducers, programmable, intrinsically safe, for resistance thermometers, thermocouples, resistance-type sensors and voltage sensors. For Pt 100 resistance thermometers

## Your advantages

- ✓ Input for resistance thermometers, thermocouples, and linear mV signals, Ex ia IIC
- ✓ Configuration via software
- ✓ Can be installed in zone 0
- ✓ 2-way electrical isolation
- ✓ Loop-powered
- ✓ 1-channel
- ✓



## Key Commercial Data

Packing unit	1 pc
GTIN	
GTIN	4017918893231

## Technical data

### Ambient conditions

Ambient temperature (operation)	-40 °C ... 55 °C
Degree of protection	IP00
	IP66 (Installed in the connection head)

### Input data

Configurable/programmable	Yes, programmable
Sensor types (RTD) that can be used	Pt, Ni (100, 500, 1000); min. measurement range 10 K
Sensor types that can be used (TC)	B, C, D, E, J, K, L, N, R, S, T, U; min. measurement range 50 K/500 K
Connection technology	2, 3, 4-wire
Input signal range	10 Ω ... 400 Ω (min. measurement range 10 Ω)

# Head-mounted transducer - MCR-FL-HT-T-I-EX - 2864532

## Technical data

### Input data

	10 Ω ... 2000 Ω (min. measurement range 100 Ω)
	-10 mV ... 100 mV (min. measurement range 5 mV)

### Output data

Configurable/programmable	Yes, programmable
Current output signal	4 mA ... 20 mA
	20 mA ... 4 mA
Max. current output signal	≤ 25 mA
Output current with short-circuit	≤ 3.6 mA or ≥ 21 mA (adjustable, not for thermocouples)
Output current with wire break	≤ 3.6 mA or ≥ 21 mA (adjustable)
Output current range with overrange/underrange	3.8 mA ... 20.5 mA (linear increase/decrease)
Load/output load current output	≤ 720 Ω (For $U_V = 24\text{ V}$ ; $U_{\text{supply}} = 8\text{ V} / 0.025\text{ A}$ )
Configurable/programmable	no

### Power supply

Designation	Loop-powered
Supply voltage range	8 V DC ... 30 V DC
Max. current consumption	< 3.5 mA

### Connection data

Connection method	Screw connection
Stripping length	8 mm
Screw thread	M3
Conductor cross section solid	0.2 mm <sup>2</sup> ... 1.75 mm <sup>2</sup>
Conductor cross section flexible	0.2 mm <sup>2</sup> ... 1.75 mm <sup>2</sup>
Conductor cross section AWG	24 ... 15
Torque	0.5 Nm ... 0.6 Nm
pluggable	no

### General

Step response (10-90%)	< 2 s
Switch-on delay	6 s
Configuration	Using MCR-PI-CONF-WIN configuration software package
Standards/regulations	NAMUR recommendation NE 21
Housing material	Polycarbonate, PC
Color	green
Line monitoring	NE 43

### Safety data

Max. output voltage $U_o$	8.2 V DC
Max. output current $I_o$	4.6 mA
Max. output power $P_o$	9.35 mW
Max. ambient temperature	Category 1: T4 = 60°C, T5 = 50°C, T6 = 40°C

# Head-mounted transducer - MCR-FL-HT-T-I-EX - 2864532

## Technical data

### Safety data

Group	IIB
Max. external inductivity $L_o$	8.5 mH
Max. external capacitance $C_o$	1.9 $\mu$ F
Group	IIC
Max. external inductivity $L_o$	4.5 mH
Max. external capacitance $C_o$	974 nF
Safety-related maximum voltage $U_m$	250 V

### Standards and Regulations

Standards/regulations	NAMUR recommendation NE 21
Conformance	CE-compliant
ATEX	# II 1 G Ex ia IIC T6/T5/T4
UL, USA/Canada	cULus
Group	IIB
	IIC

### Environmental Product Compliance

China RoHS	Environmentally friendly use period: unlimited = EFUP-e
	No hazardous substances above threshold values

## Drawings

# Head-mounted transducer - MCR-FL-HT-T-I-EX - 2864532

Dimensional drawing

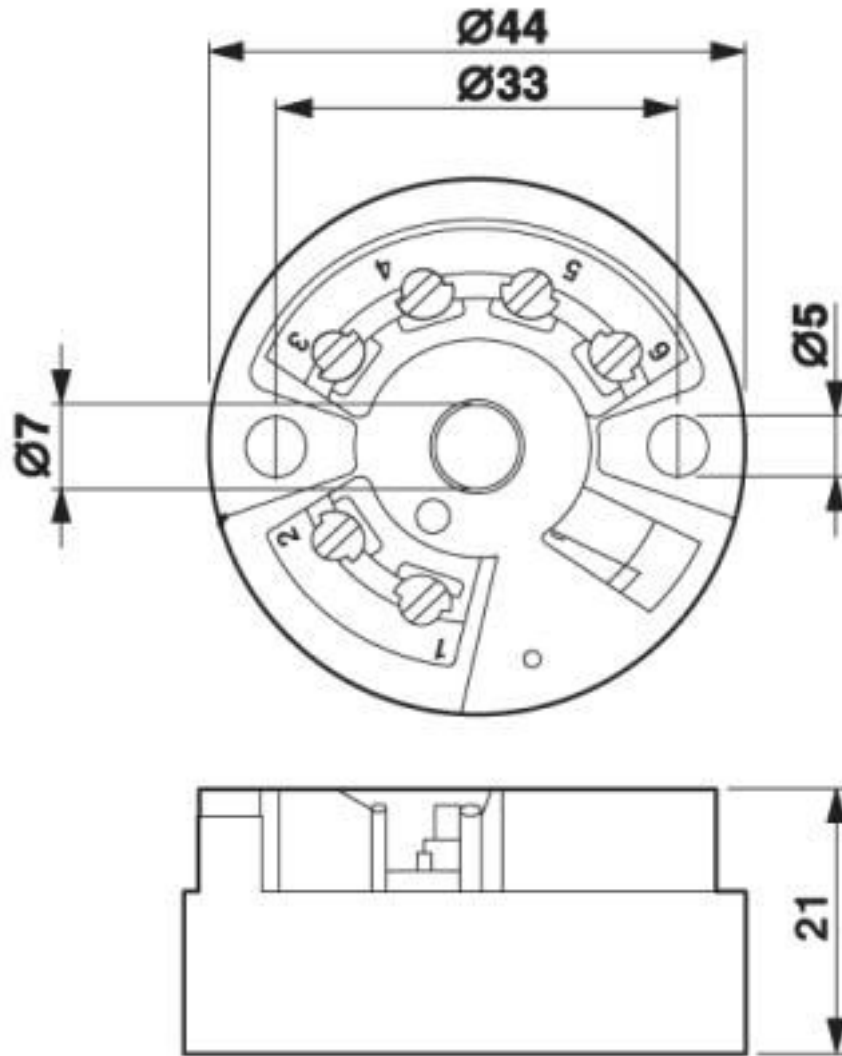

Dimensional drawing

# Head-mounted transducer - MCR-FL-HT-T-I-EX - 2864532

Block diagram

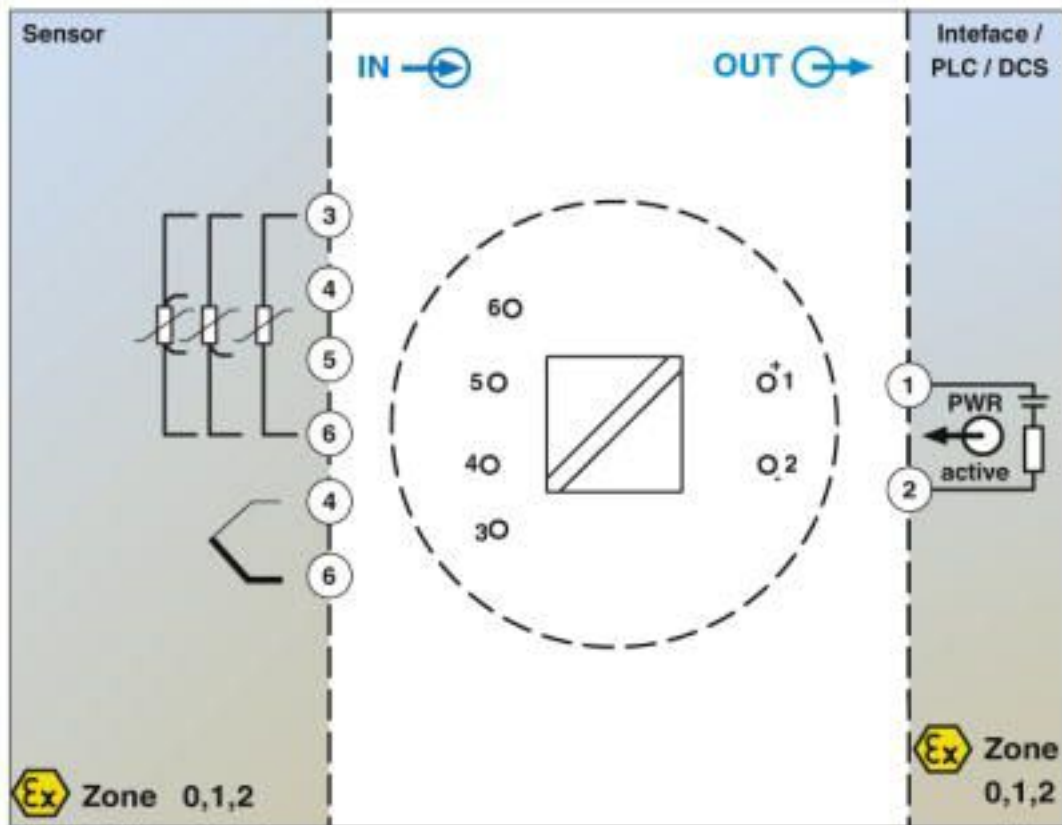

Block diagram MCR-FL-HT-T-I-EX

Pictogram

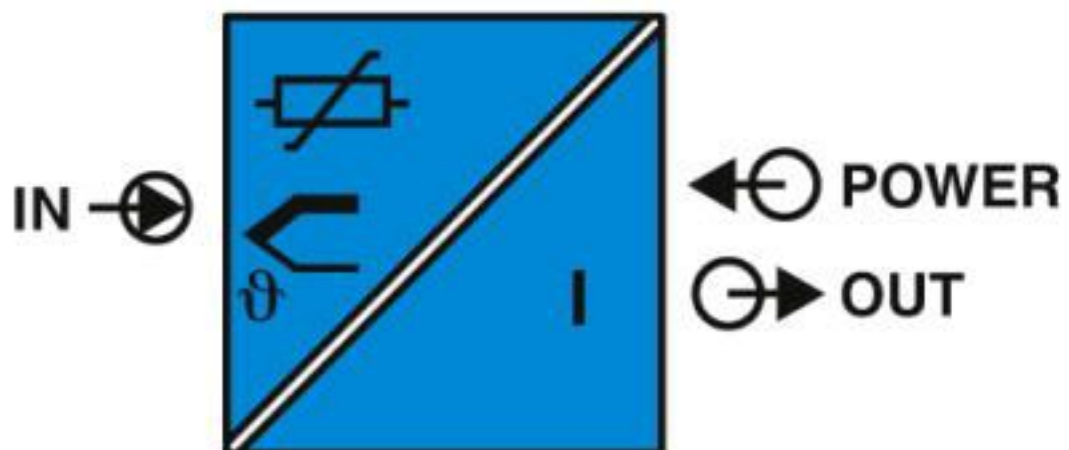

# Head-mounted transducer - MCR-FL-HT-T-I-EX - 2864532

## Classifications

### eCl@ss

eCl@ss 10.0.1	27210129
eCl@ss 4.0	27200200
eCl@ss 4.1	27200200
eCl@ss 5.0	27200200
eCl@ss 5.1	27200200
eCl@ss 6.0	27200200
eCl@ss 7.0	27200206
eCl@ss 8.0	27200206
eCl@ss 9.0	27210129

### ETIM

ETIM 2.0	EC001446
ETIM 3.0	EC001446
ETIM 4.0	EC001446
ETIM 5.0	EC001446
ETIM 6.0	EC002919
ETIM 7.0	EC002919

### UNSPSC

UNSPSC 6.01	30211506
UNSPSC 7.0901	39121008
UNSPSC 11	39121008
UNSPSC 12.01	39121008
UNSPSC 13.2	41112105
UNSPSC 18.0	41112105
UNSPSC 19.0	41112105
UNSPSC 20.0	41112105
UNSPSC 21.0	41112105

## Accessories

### Accessories

#### Mounting rail adapter

Adapter - MCR-DIN-RAIL-ADAPTER HT - 2864671



DIN rail adapter for head-mounted transducers. Suitable for 35 mm DIN rails in accordance with EN 60715.

#### Programming adapter

## Head-mounted transducer - MCR-FL-HT-T-I-EX - 2864532

### Accessories

Programming adapter - MCR-PAC-T-USB - 2309000

Programming adapter with USB and T port interface, 2.4 m for programming FA MCR-..., MCR-...-LP-..., and MCR-...-HT-... modules



---

Phoenix Contact 2020 © - all rights reserved  
<http://www.phoenixcontact.com>

PHOENIX CONTACT GmbH & Co. KG  
Flachsmarktstr. 8  
32825 Blomberg  
Germany  
Tel. +49 5235 300  
Fax +49 5235 3 41200  
<http://www.phoenixcontact.com>

## X-ON Electronics

Largest Supplier of Electrical and Electronic Components

*Click to view similar products for [Temperature Sensor Modules](#) category:*

*Click to view products by [Phoenix Contact](#) manufacturer:*

Other Similar products are found below :

[084Z6042](#) [TX4L-14S](#) [084Z6041](#) [QP99](#) [CP-02](#) [CP82](#) [CP99](#) [R38-LAOO](#) [R38-LARR](#) [72-11304023-0150.0050](#) [72-11304027-0150.0050](#) [72-23304003-0150.0050.GGP](#) [72-23904001-0300.0040.TM](#) [72-34904001-0300.0040.TM](#) [TEM 73 A](#) [AT403-414-1000](#) [AT403-614-1000](#) [AT-503-1141-000](#) [AT-503-1161-000](#) [AT-503-6140-000](#) [AT-603-1141-000](#) [AT603-414-1000](#) [ATR121-AD](#) [TPMC-5](#) [TPMC-8W](#) [K39-HCRR](#) [K39T-HCRR](#) [K49-HCRR](#) [K49P-HCRR](#) [K85-HERR](#) [KR1-LCRR-D](#) [LHI968](#) [ZAD-1V2-24](#) [ZAD-ECO-V2](#) [RO](#) [E5CB-Q1P 100-240AC](#) [E5CB-Q1TCD 24AC/DC](#) [E5CB-R1PD 24AC/DC](#) [E5CSV-R1T-500 100-240AC](#) [E5CSV-R1TD-500 24AC/DC](#) [RT-4 SONDA DS18S20](#) [RTM-01](#) [RTM-02](#) [RTM-30](#) [RTM-30/S](#) [72-11301001-0300.0045.PP](#) [72-11301002-0300.0045.SS](#) [72-11301002-1000.0050.SS](#) [72-23304001-0150.0100.GGP](#) [CP82C](#)