

Mounting plate - FL PA 3K4K 8 - 2891108

Please be informed that the data shown in this PDF Document is generated from our Online Catalog. Please find the complete data in the user's documentation. Our General Terms of Use for Downloads are valid (<http://phoenixcontact.com/download>)



Mounting plate for FL SWITCH 30... and FL SWITCH 40... eight-port switches

Product Description

The FL PA 3K4K 8 and FL PA 3K4K 16 mounting plates provide a method for mounting FL SWITCH 3000 and FL SWITCH 4000 switches to a flat panel surface in any orientation. Exception: The FL SWITCH 3000E switches need to be mounted with the ventilation holes on top. The plate can be mounted on either side of the switch to allow the network ports to face the proper direction. The plate mounts to the panel with user-supplied M6 or 1/4-inch hardware.

Why buy this product

- Flexible panel mounting of FL SWITCH 3000 and 4000 series Ethernet managed switches
- FL PA 3K4K 8: Allows panel mounting of 5- and 8-port Ethernet switches
- Kit comes complete with screws need to mount the plate to the switch

Key Commercial Data

Packing unit	1 pc
GTIN	
GTIN	4055626057804

Technical data

Dimensions

Height	147 mm
Width	165 mm

Environmental Product Compliance

China RoHS	Environmentally friendly use period: unlimited = EFUP-e
	No hazardous substances above threshold values

Drawings

Mounting plate - FL PA 3K4K 8 - 2891108

Dimensional drawing

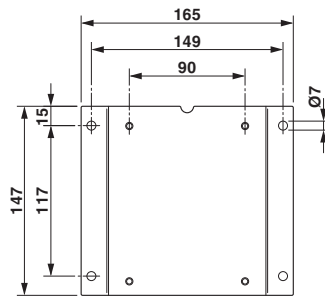

Phoenix Contact 2018 © - all rights reserved
<http://www.phoenixcontact.com>

PHOENIX CONTACT GmbH & Co. KG
Flachsmarktstr. 8
32825 Blomberg
Germany
Tel. +49 5235 300
Fax +49 5235 3 41200
<http://www.phoenixcontact.com>

X-ON Electronics

Largest Supplier of Electrical and Electronic Components

Click to view similar products for [Mounting Hardware](#) category:

Click to view products by [Phoenix Contact](#) manufacturer:

Other Similar products are found below :

[60687-01 LOCK WASHER Black](#) [627](#) [M3783-7001](#) [7717-139N](#) [7717-8DAP](#) [8351-832-A-24](#) [FPK-02-R10](#) [1-18023-0](#) [HD7-1](#) [R501-000-021](#)
[1404-0016-78](#) [154-006](#) [155-012](#) [1566](#) [1566](#) [BR16A](#) [195-003](#) [195-004](#) [195-012](#) [197-092](#) [21899-3](#) [1671](#) [194-001](#) [195-010](#) [AMCPJ51](#) [2193](#)
[2518](#) [448192-2](#) [4658](#) [4665](#) [4668](#) [4731](#) [BVX-BCK](#) [561-T001](#) [LDIN30](#) [4637](#) [4640](#) [4674](#) [1-18023-2](#) [1-18023-7](#) [63291-01 SMALL](#)
[PATTERN HEX NUT](#) [70001938](#) [70001953](#) [613](#) [616](#) [20607-1](#) [1585888-1](#) [2547](#) [90100002-1SW](#) [81517301](#)