

M5 to M12 circular plug-in connectors

Sensor/actuator device plug-in connectors

A comprehensive range of M5, M8, and M12 flush-type plug-in connectors and panel feed-throughs has emerged as a result of the various requirements for sensor/actuator device connection technology in industrial environments. Customer-specific developments enable optimum adaptation to individual device concepts.

Sensor/actuator plug-in connectors for assembly

Safe and efficient assembly is of utmost importance in field wiring. The 5 selection options of the connection technology enable precise adaptation to the respective application or requirements in the field. The plug-in connectors for assembly are available in various versions, unshielded and EMC-compliant.

Sensor/actuator device plug-in connectors

| | |
|------------------------------------|-----|
| M5, front/rear mounting | 224 |
| M8, front mounting | 225 |
| M8, rear mounting | 226 |
| M12, front mounting | 232 |
| M12, rear mounting | 242 |
| M12, rear mounting, two-piece | 252 |
| M12, for fieldbus systems | 260 |
| M12, plastic | 263 |
| M12, control cabinet feed-throughs | 264 |
| M12, stainless steel | 268 |
| 7/8", front mounting | 265 |
| 7/8", rear mounting | 266 |

Sensor/actuator plug-in connectors for assembly

| | |
|-------------------------|-----|
| M8 plug-in connectors | 272 |
| M12 plug-in connectors | 275 |
| 7/8" plug-in connectors | 285 |

M12 power plug-in connectors

| | |
|--|-----|
| Device plug-in connectors with litz wires | 286 |
| Two-piece device plug-in connectors for reflow processes | 288 |
| Plug-in connectors for assembly | 289 |
| SPEEDCON power cable | 290 |

Accessories

| | |
|-----------------|-----|
| Pin assignments | 298 |
|-----------------|-----|

M5 to M12 circular plug-in connectors

M5/M8 sensor/actuator device plug-in connectors

M5, front/rear mounting

Notes:
Flat nut recommended for housing wall thicknesses < 2.5 mm.



Front mounting,
with 0.5 m long litz wires



Rear mounting, one-piece, straight,
for wave soldering processes



| General data | |
|---|------------------|
| M5 circular plug-in connector according to: | |
| Pollution degree | 3 |
| Degree of protection | IP67 |
| Connection method | Individual wires |
| Electrical data | |
| Rated voltage | 60 V |
| Rated current | 1 A |
| Volume resistance | ≤ 3 mΩ |
| Material data | |
| Material contact / contact surface | CuSn / Au |
| Contact carrier material | PA 66 |
| Inflammability class according to UL 94 | HB |
| Cable type | TPE litz wire |
| Temperature data | |
| Plug / socket | [°C] -25 ... 85 |

| Technical data | | | |
|------------------|--|------------------|--|
| 3-pos. | | 4-pos. | |
| IEC 61076-2-105 | | IEC 61076-2-105 | |
| 3 | | 3 | |
| IP67 | | IP67 | |
| Individual wires | | Individual wires | |
| 60 V | | 60 V | |
| 1 A | | 1 A | |
| ≤ 3 mΩ | | ≤ 3 mΩ | |
| CuSn / Au | | CuSn / Au | |
| PA 66 | | PA 66 | |
| HB | | HB | |
| TPE litz wire | | TPE litz wire | |
| -25 ... 85 | | -25 ... 85 | |

| Technical data | | | |
|-----------------|--|-----------------|--|
| 3-pos. | | 4-pos. | |
| IEC 61076-2-105 | | IEC 61076-2-105 | |
| 3 | | 3 | |
| IP67 | | IP67 | |
| Solder pins | | Solder pins | |
| 60 V | | 60 V | |
| 1 A | | 1 A | |
| ≤ 3 mΩ | | ≤ 3 mΩ | |
| CuSn / Au | | CuSn / Au | |
| PA 66 | | PA 66 | |
| HB | | HB | |
| - | | - | |
| -25 ... 80 | | -25 ... 85 | |

| Ordering data | |
|----------------------------------|--------------|
| Description | Coding |
| Device plug-in connectors | |
| Socket | A - standard |
| Plug | A - standard |

| Ordering data | | | |
|---------------|-------------|-----------|-------------|
| Order No. | Pcs. / Pkt. | Order No. | Pcs. / Pkt. |
| 3-pos. | | 4-pos. | |
| 1530605 | 1 | 1530618 | 1 |
| 1530582 | 1 | 1530595 | 1 |

| Ordering data | | | |
|---------------|-------------|-----------|-------------|
| Order No. | Pcs. / Pkt. | Order No. | Pcs. / Pkt. |
| 3-pos. | | 4-pos. | |
| 1530647 | 20 | 1530650 | 20 |
| 1530621 | 20 | 1530634 | 20 |

| Accessories | |
|------------------------------|--|
| Flat nut, with: M5 thread | |

| Accessories | | |
|---------------|---------|-----|
| SACC-E-MU-M 5 | 1535901 | 100 |

| Accessories | | |
|-------------|--|--|
| | | |



M5 flush-type plug



M5 flush-type plug, one-piece

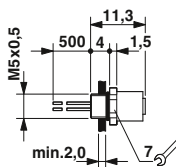

M5 flush-type socket

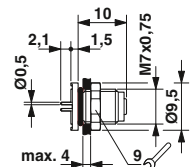

M5 flush-type socket, one-piece

M5 to M12 circular plug-in connectors

M5/M8 sensor/actuator device plug-in connectors

**M8, front mounting,
with 0.5 m long litz wires**



M8, 3, 4, 5-pos.



M8, 6, 8-pos.



| | Technical data | | | Technical data | | | |
|---|------------------|------------------|------------------|------------------|------------------|---------------|-------------|
| | 3-pos. | 4-pos. | 5-pos. | 6-pos. | 8-pos. | | |
| General data | | | | | | | |
| M8 circular plug-in connector according to: | IEC 61076-2-104 | IEC 61076-2-104 | IEC 61076-2-104 | IEC 61076-2-104 | IEC 61076-2-104 | - | |
| Pollution degree | 3 | 3 | 3 | 3 | 3 | - | |
| Degree of protection | IP67 | IP67 | IP67 | IP67 | IP67 | - | |
| Connection method | Individual wires | Individual wires | Individual wires | Individual wires | Individual wires | - | |
| Electrical data | | | | | | | |
| Rated voltage | 60 V | 30 V | 30 V | 30 V | 30 V | - | |
| Rated current | 4 A | 4 A | 3 A | 2 A | 1.5 A | - | |
| Volume resistance | ≤ 3 mΩ | ≤ 3 mΩ | ≤ 3 mΩ | ≤ 3 mΩ | ≤ 3 mΩ | - | |
| Material data | | | | | | | |
| Material contact / contact surface | Cu alloy / Au | Cu alloy / Au | Cu alloy / Au | Cu alloy / Au | Cu alloy / Au | - / - | |
| Contact carrier material | PA 66 | PA 66 | PA 66 | PA 66 | PA 66 | - | |
| Inflammability class according to UL 94 | HB | HB | HB | HB | HB | - | |
| Cable type | TPE litz wire | TPE litz wire | PVC litz wire | TPE litz wire | PVC litz wire | - | |
| Temperature data | | | | | | | |
| Plug / socket | [-25 ... 85 °C] | | | [-25 ... 85 °C] | | | |
| Ordering data | | | | | | | |
| Description | Coding | Order No. | Pcs. / Pkt. | Order No. | Pcs. / Pkt. | Order No. | Pcs. / Pkt. |
| | | 3-pos. | | 4-pos. | | 5-pos. | |
| Device plug-in connectors | | | | | | | |
| Socket | A - standard | 1500350 | 1 | 1500363 | 1 | 1542677 | 1 |
| Plug | A - standard | 1500334 | 1 | 1500347 | 1 | 1542664 | 1 |
| Socket | B - inverse | | | | 1424233 | 1424232 | 1 |
| Plug | B - inverse | | | | 1424234 | | 1 |
| Accessories | | | | | | | |
| Flat nut, with: | | SACC-E-MU-M 8 | | 1504071 | 100 | SACC-E-MU-M 8 | |
| M8 thread | | | | | | 1504071 | 100 |



M8 flush-type socket

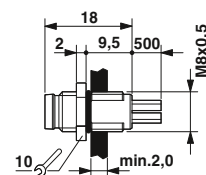

M8 flush-type plug

M5 to M12 circular plug-in connectors

M5/M8 sensor/actuator device plug-in connectors

M8, rear mounting, one-piece, straight, for wave soldering processes



M8, 3, 4-pos.



M8, 6, 8-pos.



Technical data

Technical data

| | 3-pos. | | 4-pos. | | 6-pos. | | 8-pos. | |
|---|-----------------|--|-----------------|--|-----------------|--|-----------------|--|
| | IEC 61076-2-104 | | IEC 61076-2-104 | | IEC 61076-2-104 | | IEC 61076-2-104 | |
| General data | 3 | | 3 | | 3 | | 3 | |
| M8 circular plug-in connector according to: | 3 | | 3 | | 3 | | 3 | |
| Pollution degree | IP67 | | IP67 | | IP67 | | IP67 | |
| Degree of protection | Solder pins | | Solder pins | | Solder pins | | Solder pins | |
| Connection method | 60 V | | 30 V | | 30 V | | 30 V | |
| Electrical data | 4 A | | 4 A | | 1.5 A | | 1.5 A | |
| Rated voltage | ≤ 3 mΩ | | ≤ 3 mΩ | | ≤ 3 mΩ | | ≤ 3 mΩ | |
| Rated current | CuSn / Au | | CuSn / Au | | CuSn / Au | | CuSn / Au | |
| Volume resistance | PA 66 | | PA 66 | | PA 66 | | PA 66 | |
| Material data | HB | | HB | | HB | | HB | |
| Material contact / contact surface | -25 ... 85 | | -25 ... 85 | | -25 ... 85 | | -25 ... 85 | |
| Contact carrier material | [°C] | | [°C] | | [°C] | | [°C] | |
| Inflammability class according to UL 94 | | | | | | | | |
| Temperature data | | | | | | | | |
| Plug / socket | | | | | | | | |

Ordering data

Ordering data

| Description | Coding | 3-pos. | | 4-pos. | | 6-pos. | | 8-pos. | |
|----------------------------------|--------------|-----------|-------------|-----------|-------------|-----------|-------------|-----------|-------------|
| | | Order No. | Pcs. / Pkt. | Order No. | Pcs. / Pkt. | Order No. | Pcs. / Pkt. | Order No. | Pcs. / Pkt. |
| Device plug-in connectors | | | | | | | | | |
| Socket | A - standard | 1694363 | 20 | 1694376 | 20 | 1436534 | 20 | 1424237 | 20 |
| Plug | A - standard | 1694334 | 20 | 1694347 | 20 | 1436521 | 20 | 1424238 | 20 |



M8 flush-type socket



M8 flush-type plug

M5 to M12 circular plug-in connectors

M5/M8 sensor/actuator device plug-in connectors

**M8, rear mounting,
with 0.5 m long litz wires**



3, 4-pos.



6, 8-pos.



| | Technical data | |
|---|------------------|------------------|
| | 3-pos. | 4-pos. |
| General data | | |
| M8 circular plug-in connector according to: | IEC 61076-2-104 | IEC 61076-2-104 |
| Pollution degree | 3 | 3 |
| Degree of protection | IP67 | IP67 |
| Connection method | Individual wires | Individual wires |
| Electrical data | | |
| Rated voltage | 60 V | 30 V |
| Rated current | 4 A | 4 A |
| Volume resistance | ≤ 3 mΩ | ≤ 3 mΩ |
| Material data | | |
| Material contact / contact surface | Cu alloy / Au | Cu alloy / Au |
| Contact carrier material | PUR / PA66 | PUR / PA66 |
| Inflammability class according to UL 94 | HB | HB |
| Cable type | TPE litz wire | TPE litz wire |
| Temperature data | | |
| Plug / socket | [°C] -25 ... 85 | [°C] -25 ... 85 |
| Cable, fixed installation | [°C] -25 ... 90 | [°C] -25 ... 90 |



| | Technical data | |
|---|------------------|------------------|
| | 6-pos. | 8-pos. |
| General data | | |
| M8 circular plug-in connector according to: | IEC 61076-2-104 | IEC 61076-2-104 |
| Pollution degree | 3 | 3 |
| Degree of protection | IP67 | IP67 |
| Connection method | Individual wires | Individual wires |
| Electrical data | | |
| Rated voltage | 30 V | 30 V |
| Rated current | 2 A | 1.5 A |
| Volume resistance | ≤ 3 mΩ | ≤ 3 mΩ |
| Material data | | |
| Material contact / contact surface | Cu alloy / Au | Cu alloy / Au |
| Contact carrier material | PUR / PA66 | PUR / PA66 |
| Inflammability class according to UL 94 | HB | HB |
| Cable type | TPE litz wire | PVC litz wire |
| Temperature data | | |
| Plug / socket | [°C] -25 ... 85 | [°C] -25 ... 85 |
| Cable, fixed installation | [°C] -25 ... 90 | [°C] -25 ... 85 |

| Description | Coding | Ordering data | | | |
|---|--------------|---------------|-------------|-----------|-------------|
| | | Order No. | Pcs. / Pkt. | Order No. | Pcs. / Pkt. |
| Flush-type plug-in connector, M8 fastening thread | | | | | |
| Plug | A - standard | 1453478 | 1 | 1453481 | 1 |
| Flush-type plug-in connector, M10 fastening thread | | | | | |
| Socket | A - standard | 1456080 | 1 | 1456093 | 1 |
| Flush-type plug-in connector, M12 fastening thread | | | | | |
| Socket | A - standard | 1453449 | 1 | 1453452 | 1 |

| Description | Coding | Ordering data | | | |
|---|--------------|---------------|-------------|-----------|-------------|
| | | Order No. | Pcs. / Pkt. | Order No. | Pcs. / Pkt. |
| Flush-type plug-in connector, M8 fastening thread | | | | | |
| Plug | A - standard | 1453494 | 1 | 1424230 | 1 |
| Flush-type plug-in connector, M10 fastening thread | | | | | |
| Socket | A - standard | 1456103 | 1 | 1424229 | 1 |
| Flush-type plug-in connector, M12 fastening thread | | | | | |
| Socket | A - standard | 1453465 | 1 | | |

| Accessories | Ordering data | |
|---------------------------|---------------|-------------|
| | Order No. | Pcs. / Pkt. |
| Flat nut, with: M8 thread | SACC-E-MU-M 8 | 1504071 100 |

| Accessories | Ordering data | |
|---------------------------|---------------|-------------|
| | Order No. | Pcs. / Pkt. |
| Flat nut, with: M8 thread | SACC-E-MU-M 8 | 1504071 100 |

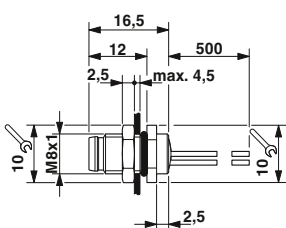

M8 flush-type plug, M8 fastening thread

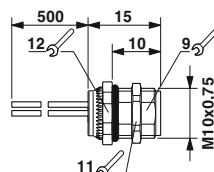

M8 flush-type socket, M10 fastening thread

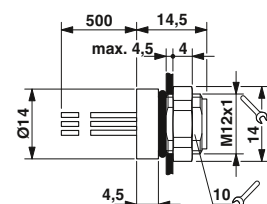

M8 flush-type socket, M12 fastening thread

M5 to M12 circular plug-in connectors

M5/M8 sensor/actuator device plug-in connectors

**M8, rear mounting, two-piece,
for wave soldering processes, shielded**



Angled, 3, 4-pos.



Angled, 5, 6-pos.

| | Technical data | | | |
|---|--------------------------|--|--------------------------|--|
| | 3-pos. | | 4-pos. | |
| General data | IEC 61076-2-104 | | IEC 61076-2-104 | |
| M8 circular plug-in connector according to: | 3 | | 3 | |
| Pollution degree | IP67 | | IP67 | |
| Degree of protection | Solder pins | | Solder pins | |
| Connection method | 30 V | | 30 V | |
| Electrical data | 4 A | | 4 A | |
| Rated voltage | $\leq 3 \text{ m}\Omega$ | | $\leq 3 \text{ m}\Omega$ | |
| Rated current | Cu alloy / Au | | Cu alloy / Au | |
| Volume resistance | PA 66 | | PA 66 | |
| Material data | HB | | HB | |
| Material contact / contact surface | -25 ... 85 | | -25 ... 85 | |
| Contact carrier material | -25 ... 85 | | -25 ... 85 | |
| Inflammability class according to UL 94 | -25 ... 85 | | -25 ... 85 | |
| Temperature data | -25 ... 85 | | -25 ... 85 | |
| Plug / socket | [°C] | | [°C] | |

| | Technical data | | | |
|---|--------------------------|--|--------------------------|--|
| | 5-pos. | | 6-pos. | |
| General data | IEC 61076-2-104 | | IEC 61076-2-104 | |
| M8 circular plug-in connector according to: | 3 | | 3 | |
| Pollution degree | IP67 | | IP67 | |
| Degree of protection | Solder pins | | Solder pins | |
| Connection method | 30 V | | 30 V | |
| Electrical data | 3 A | | 1.5 A | |
| Rated voltage | $\leq 3 \text{ m}\Omega$ | | $\leq 3 \text{ m}\Omega$ | |
| Rated current | Cu alloy / Au | | Cu alloy / Au | |
| Volume resistance | PA 66 | | PA 66 | |
| Material data | HB | | HB | |
| Material contact / contact surface | -25 ... 85 | | -25 ... 85 | |
| Contact carrier material | -25 ... 85 | | -25 ... 85 | |
| Inflammability class according to UL 94 | -25 ... 85 | | -25 ... 85 | |
| Temperature data | -25 ... 85 | | -25 ... 85 | |
| Plug / socket | [°C] | | [°C] | |

| | Coding | Ordering data | | | |
|----------------------------------|--------------|---------------|-------------|-----------|-------------|
| | | Order No. | Pcs. / Pkt. | Order No. | Pcs. / Pkt. |
| | | 3-pos. | | 4-pos. | |
| Device plug-in connectors | | | | | |
| Socket | A - standard | 1456145 | 20 | 1456158 | 20 |
| Plug | A - standard | 1456035 | 20 | 1456048 | 20 |
| Socket | B - inverse | | | | |
| Plug | B - inverse | | | | |

| | Coding | Ordering data | | | |
|--------|--------|---------------|-------------|-----------|-------------|
| | | Order No. | Pcs. / Pkt. | Order No. | Pcs. / Pkt. |
| | | 5-pos. | | 6-pos. | |
| Socket | | 1424239 | 20 | 1424243 | 20 |
| Plug | | 1424240 | 20 | 1424244 | 20 |

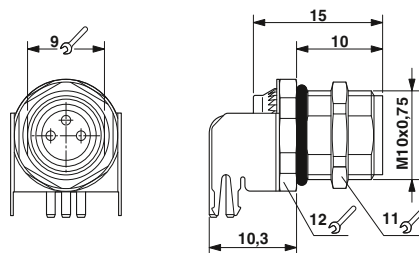

M8 flush-type socket, angled



M8 flush-type plug, angled

M5 to M12 circular plug-in connectors

M5/M8 sensor/actuator device plug-in connectors

M8, rear mounting, two-piece,
for wave soldering processes, shielded



Straight, 3, 4, 5-pos.



Straight, 6, 8-pos.



| | Technical data | | | Technical data | | | | | | | |
|---|----------------------|-----------------|-----------------|----------------------|-----------------|-----------|-------------|-----------|-------------|-----------|-------------|
| | 3-pos. | 4-pos. | 5-pos. | 6-pos. | 8-pos. | | | | | | |
| General data | | | | | | | | | | | |
| M8 circular plug-in connector according to: | IEC 61076-2-104 | IEC 61076-2-104 | IEC 61076-2-104 | IEC 61076-2-104 | IEC 61076-2-104 | - | | | | | |
| Pollution degree | 3 | 3 | 3 | 3 | 3 | - | | | | | |
| Degree of protection | IP67 | IP67 | IP67 | IP67 | IP67 | - | | | | | |
| Connection method | Solder pins | Solder pins | Solder pins | Solder pins | Solder pins | - | | | | | |
| Electrical data | | | | | | | | | | | |
| Rated voltage | 60 V | 30 V | 30 V | 30 V | 30 V | - | | | | | |
| Rated current | 4 A | 4 A | 3 A | 1.5 A | 1.5 A | - | | | | | |
| Volume resistance | ≤ 3 mΩ | ≤ 3 mΩ | ≤ 3 mΩ | ≤ 3 mΩ | ≤ 3 mΩ | - | | | | | |
| Material data | | | | | | | | | | | |
| Material contact / contact surface | Cu alloy / Au | Cu alloy / Au | Cu alloy / Au | Cu alloy / Au | Cu alloy / Au | - / - | | | | | |
| Contact carrier material | PA 66 | PA 66 | PA 66 | PA 66 | PA 66 | - | | | | | |
| Inflammability class according to UL 94 | HB | HB | HB | HB | HB | - | | | | | |
| Temperature data | | | | | | | | | | | |
| Plug / socket | -25 ... 85 | -25 ... 85 | -25 ... 85 | -25 ... 85 | -25 ... 85 | - | | | | | |
| | Ordering data | | | Ordering data | | | | | | | |
| Description | Coding | Order No. | Pcs. / Pkt. | Order No. | Pcs. / Pkt. | Order No. | Pcs. / Pkt. | Order No. | Pcs. / Pkt. | Order No. | Pcs. / Pkt. |
| | | 3-pos. | | 4-pos. | | 5-pos. | | 6-pos. | | 8-pos. | |
| Device plug-in connectors | | | | | | | | | | | |
| Socket | A - standard | 1456116 | 20 | 1456129 | 20 | | | 1456132 | 20 | 1424235 | 20 |
| Plug | A - standard | 1455997 | 20 | 1456019 | 20 | | | 1456022 | 20 | 1424236 | 20 |
| Socket | B - inverse | | | | | 1424241 | 20 | | | | |
| Plug | B - inverse | | | | | 1424242 | 20 | | | | |

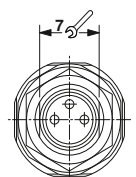
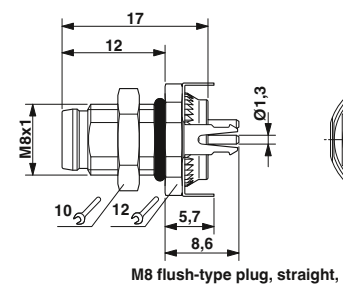
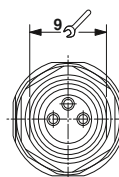
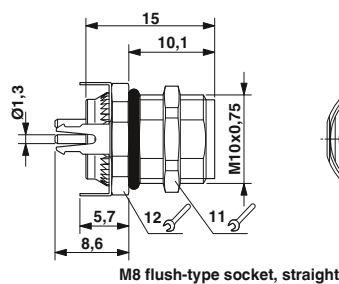

M5 to M12 circular plug-in connectors

M5/M8 sensor/actuator device plug-in connectors

M8, rear mounting, two-piece, for wave soldering processes, unshielded



Angled, 3, 4-pos.



Straight, 3, 4-pos.



| | Technical data | | | |
|---|--------------------------|--|--------------------------|--|
| | 3-pos. | | 4-pos. | |
| General data | IEC 61076-2-104 | | IEC 61076-2-104 | |
| M8 circular plug-in connector according to: | 3 | | 3 | |
| Pollution degree | IP67 | | IP67 | |
| Degree of protection | Solder pins | | Solder pins | |
| Connection method | 60 V | | 30 V | |
| Electrical data | 4 A | | 4 A | |
| Rated voltage | $\leq 3 \text{ m}\Omega$ | | $\leq 3 \text{ m}\Omega$ | |
| Rated current | CuSn / Au | | CuSn / Au | |
| Volume resistance | PA 66 | | PA 66 | |
| Material data | HB | | HB | |
| Material contact / contact surface | -25 ... 85 | | -25 ... 85 | |
| Contact carrier material | -25 ... 85 | | -25 ... 85 | |
| Inflammability class according to UL 94 | -25 ... 85 | | -25 ... 85 | |
| Temperature data | -25 ... 85 | | -25 ... 85 | |
| Plug / socket | -25 ... 85 | | -25 ... 85 | |

| | Coding | Ordering data | | | |
|---------------------------|--------------|---------------|-------------|-----------|-------------|
| | | Order No. | Pcs. / Pkt. | Order No. | Pcs. / Pkt. |
| Device plug-in connectors | | 3-pos. | | 4-pos. | |
| Socket | A - standard | 1524788 | 20 | 1526169 | 20 |
| Plug | A - standard | 1440070 | 20 | 1440096 | 20 |

| | Technical data | | | |
|---|--------------------------|--|--------------------------|--|
| | 3-pos. | | 4-pos. | |
| General data | IEC 61076-2-104 | | IEC 61076-2-104 | |
| M8 circular plug-in connector according to: | 3 | | 3 | |
| Pollution degree | IP67 | | IP67 | |
| Degree of protection | Solder pins | | Solder pins | |
| Connection method | 60 V | | 30 V | |
| Electrical data | 4 A | | 4 A | |
| Rated voltage | $\leq 3 \text{ m}\Omega$ | | $\leq 3 \text{ m}\Omega$ | |
| Rated current | CuSn / Au | | CuSn / Au | |
| Volume resistance | PA 66 | | PA 66 | |
| Material data | HB | | HB | |
| Material contact / contact surface | -25 ... 85 | | -25 ... 85 | |
| Contact carrier material | -25 ... 85 | | -25 ... 85 | |
| Inflammability class according to UL 94 | -25 ... 85 | | -25 ... 85 | |
| Temperature data | -25 ... 85 | | -25 ... 85 | |
| Plug / socket | -25 ... 85 | | -25 ... 85 | |

| | Coding | Ordering data | | | |
|---------------------------|--------------|---------------|-------------|-----------|-------------|
| | | Order No. | Pcs. / Pkt. | Order No. | Pcs. / Pkt. |
| Device plug-in connectors | | 3-pos. | | 4-pos. | |
| Socket | A - standard | 1524776 | 20 | 1524789 | 20 |
| Plug | A - standard | 1524776 | 20 | 1524789 | 20 |



M5 to M12 circular plug-in connectors

M12 sensor/actuator device plug-in connectors, front mounting

Pg9 fastening thread,
with 0.5 m long litz wires



4, 5, 8-pos.



Can be positioned, 4, 5, 8-pos.



| | Technical data | | | Technical data | | | |
|---|--|------------------|------------------|--|------------------|------------------|-------------|
| | 4-pos. | 5-pos. | 8-pos. | 4-pos. | 5-pos. | 8-pos. | |
| General data | M12 circular plug-in connector according to: | | | M12 circular plug-in connector according to: | | | |
| Pollution degree | 3 | 3 | 3 | 3 | 3 | 3 | |
| Degree of protection | IP67 | IP67 | IP67 | IP67 | IP67 | IP67 | |
| Connection method | Individual wires | Individual wires | Individual wires | Individual wires | Individual wires | Individual wires | |
| Electrical data | | | | | | | |
| Rated voltage | 250 V | 60 V | 30 V | 250 V | 60 V | 30 V | |
| Rated current | 4 A | 4 A | 2 A | 4 A | 4 A | 2 A | |
| Volume resistance | ≤ 3 mΩ | ≤ 3 mΩ | ≤ 3 mΩ | ≤ 3 mΩ | ≤ 3 mΩ | ≤ 3 mΩ | |
| Material data | | | | | | | |
| Material contact / contact surface | CuZn / Ni/Au | CuZn / Ni/Au | CuZn / Ni/Au | CuZn / Ni/Au | CuZn / Ni/Au | CuZn / Ni/Au | |
| Contact carrier material | PA66 | PA66 | PA66 | PA66 | PA66 | PA66 | |
| Inflammability class according to UL 94 | V0 | V0 | V0 | V0 | V0 | V0 | |
| Cable type | TPE litz wire | TPE litz wire | TPE litz wire | TPE litz wire | TPE litz wire | TPE litz wire | |
| Temperature data | | | | | | | |
| Plug / socket | [-25 ... 85 °C] | [-25 ... 85 °C] | [-25 ... 85 °C] | [-25 ... 85 °C] | [-25 ... 85 °C] | [-25 ... 85 °C] | |
| Ordering data | | | | | | | |
| Description | Coding | Order No. | Pcs. / Pkt. | Order No. | Pcs. / Pkt. | Order No. | Pcs. / Pkt. |
| | | 4-pos. | 5-pos. | 8-pos. | 4-pos. | 5-pos. | 8-pos. |
| Device plug-in connectors | | | | | | | |
| Socket | A - standard | 1693788 | 1 | 1671098 | 1 | 1513758 | 1 |
| Plug | A - standard | 1693762 | 1 | 1671111 | 1 | 1513774 | 1 |
| Socket | B - inverse | | | | | | |
| Plug | B - inverse | | | | | | |
| Accessories | | | | | | | |
| Flat nut, with: | | SACC-E-MU-PG9 | | 1504084 | 100 | | |
| Pg9 thread | | | | | | | |

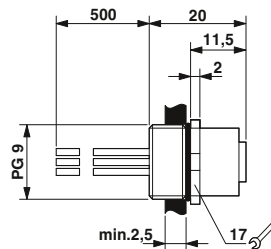

M12 flush-type socket

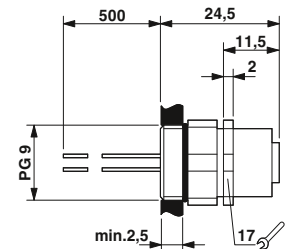

M12 flush-type socket, can be positioned



M12 flush-type plug



M12 flush-type plug, can be positioned

M5 to M12 circular plug-in connectors

M12 sensor/actuator device plug-in connectors, front mounting

M16 fastening thread,
with 0.5 m long litz wires



4, 5, 8-pos.



12, 17-pos.



| | Technical data | | |
|--|------------------|------------------|------------------|
| | 4-pos. | 5-pos. | 8-pos. |
| General data | | | |
| M12 circular plug-in connector according to: | IEC 61076-2-101 | IEC 61076-2-101 | IEC 61076-2-101 |
| Pollution degree | 3 | 3 | 3 |
| Degree of protection | IP67 | IP67 | IP67 |
| Connection method | Individual wires | Individual wires | Individual wires |
| Electrical data | | | |
| Rated voltage | 250 V | 60 V | 30 V |
| Rated current | 4 A | 4 A | 2 A |
| Volume resistance | ≤ 3 mΩ | ≤ 3 mΩ | ≤ 3 mΩ |
| Material data | | | |
| Material contact / contact surface | CuZn / Ni/Au | CuZn / Ni/Au | CuZn / Ni/Au |
| Contact carrier material | PA 66 | PA 66 | PA 66 |
| Inflammability class according to UL 94 | V0 | V0 | V0 |
| Cable type | TPE litz wire | TPE litz wire | TPE litz wire |
| Temperature data | | | |
| Plug / socket | -25 ... 85 | -25 ... 85 | -25 ... 85 |



| | Technical data | | |
|--|------------------|------------------|-------|
| | 12-pos. | 17-pos. | |
| General data | | | |
| M12 circular plug-in connector according to: | IEC 61076-2-101 | IEC 61076-2-101 | - |
| Pollution degree | 3 | 3 | - |
| Degree of protection | IP67 | IP67 | - |
| Connection method | Individual wires | Individual wires | - |
| Electrical data | | | |
| Rated voltage | 30 V | 30 V | - |
| Rated current | 1.5 A | 1.5 A | - |
| Volume resistance | ≤ 3 mΩ | ≤ 3 mΩ | - |
| Material data | | | |
| Material contact / contact surface | CuZn / Ni/Au | CuZn / Ni/Au | - / - |
| Contact carrier material | PA 66 | PA 66 | - |
| Inflammability class according to UL 94 | V0 | V0 | - |
| Cable type | TPE litz wire | TPE litz wire | - |
| Temperature data | | | |
| Plug / socket | -25 ... 85 | -25 ... 85 | - |

| Description | Coding | Ordering data | | | | | |
|----------------------------------|--------------|---------------|-------------|-----------|-------------|-----------|-------------|
| | | 4-pos. | | 5-pos. | | 8-pos. | |
| | | Order No. | Pcs. / Pkt. | Order No. | Pcs. / Pkt. | Order No. | Pcs. / Pkt. |
| Device plug-in connectors | | | | | | | |
| Socket | A - standard | 1523434 | 1 | 1520039 | 1 | 1523476 | 1 |
| Plug | A - standard | 1523450 | 1 | 1520055 | 1 | 1523492 | 1 |
| Socket | D - data | 1535202 | 1 | | | | |
| Plug | D - data | 1551558 | 1 | | | | |
| Socket | B - inverse | | | 1520000 | 1 | | |
| Plug | B - inverse | | | 1520013 | 1 | | |

| Description | Coding | Ordering data | | | | | |
|----------------------------------|--------------|---------------|-------------|-----------|-------------|-----------|-------------|
| | | 12-pos. | | 17-pos. | | | |
| | | Order No. | Pcs. / Pkt. | Order No. | Pcs. / Pkt. | Order No. | Pcs. / Pkt. |
| Device plug-in connectors | | | | | | | |
| Socket | A - standard | 1556252 | 1 | 1556294 | 1 | | |
| Plug | A - standard | 1556265 | 1 | 1556304 | 1 | | |

| | Accessories | | |
|-------------------------------|---------------|-------------|-----|
| | Order No. | Pcs. / Pkt. | |
| Flat nut, with: M16 thread | SACC-E-MU-M16 | 1504097 | 100 |

| | Accessories | | |
|-------------------------------|---------------|-------------|-----|
| | Order No. | Pcs. / Pkt. | |
| Flat nut, with: M16 thread | SACC-E-MU-M16 | 1504097 | 100 |

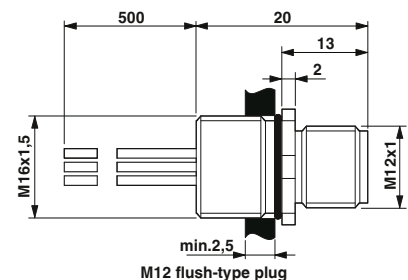
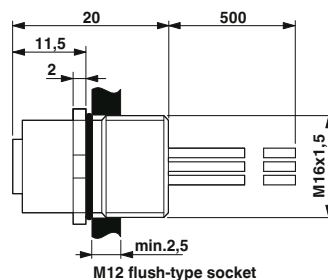

M5 to M12 circular plug-in connectors

M12 sensor/actuator device plug-in connectors, front mounting

M16 fastening thread, with 0.5 m long litz wires, can be positioned



Can be positioned, 4, 5-pos.



Can be positioned, 8-pos.



Technical data

| | |
|--|------------------|
| General data | |
| M12 circular plug-in connector according to: | IEC 61076-2-101 |
| Pollution degree | 3 |
| Degree of protection | IP67 |
| Connection method | Individual wires |
| Electrical data | |
| Rated voltage | 250 V |
| Rated current | 4 A |
| Volume resistance | ≤ 3 mΩ |
| Material data | |
| Material contact / contact surface | CuZn / Ni/Au |
| Contact carrier material | PA 66 |
| Inflammability class according to UL 94 | V0 |
| Cable type | TPE litz wire |
| Temperature data | |
| Plug / socket | -25 ... 85 [°C] |

4-pos.

5-pos.



Ordering data

| Description | Coding | 4-pos. | | 5-pos. | |
|----------------------------------|--------------|-----------|-------------|-----------|-------------|
| | | Order No. | Pcs. / Pkt. | Order No. | Pcs. / Pkt. |
| Device plug-in connectors | | | | | |
| Socket | A - standard | 1523447 | 1 | 1520042 | 1 |
| Plug | A - standard | 1523463 | 1 | 1520068 | 1 |
| Socket | D - data | 1535215 | 1 | | |
| Plug | D - data | 1552256 | 1 | | |
| Socket | B - inverse | | | 1519998 | 1 |
| Plug | B - inverse | | | 1520026 | 1 |



Technical data

| | |
|--|--------------------|
| General data | |
| M12 circular plug-in connector according to: | IEC 61076-2-101 |
| Pollution degree | 3 |
| Degree of protection | IP67 |
| Connection method | Individual wires |
| Electrical data | |
| Rated voltage | 30 V |
| Rated current | 2 A |
| Volume resistance | ≤ 3 mΩ |
| Material data | |
| Material contact / contact surface | CuZn / Ni/Au - / - |
| Contact carrier material | PA 66 |
| Inflammability class according to UL 94 | V0 |
| Cable type | TPE litz wire |
| Temperature data | |
| Plug / socket | -25 ... 85 |

8-pos.



Ordering data

| Description | Coding | 8-pos. | |
|----------------------------------|--------------|-----------|-------------|
| | | Order No. | Pcs. / Pkt. |
| Device plug-in connectors | | | |
| Socket | A - standard | 1523489 | 1 |
| Plug | A - standard | 1523502 | 1 |

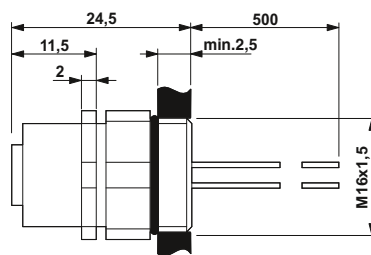

M12 flush-type socket, can be positioned

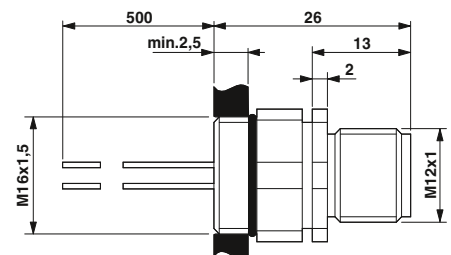

M12 flush-type plug, can be positioned

**M20 fastening thread,
with 0.5 m long litz wires**

– Housing material: brass, nickel-plated

N



4, 5, 8-pos.

Technical data

| | Technical data | | |
|--|------------------|------------------|------------------|
| | 4-pos. | 5-pos. | 8-pos. |
| General data | | | |
| M12 circular plug-in connector according to: | IEC 61076-2-101 | IEC 61076-2-101 | IEC 61076-2-101 |
| Pollution degree | 3 | 3 | 3 |
| Degree of protection | IP67/IP69K | IP67/IP69K | IP67/IP69K |
| Connection method | Individual wires | Individual wires | Individual wires |
| Electrical data | | | |
| Rated voltage | 250 V | 60 V | 30 V |
| Rated current | 4 A | 4 A | 2 A |
| Volume resistance | ≤ 3 mΩ | ≤ 3 mΩ | ≤ 3 mΩ |
| Material data | | | |
| Material contact / contact surface | CuZn / Au | CuZn / Au | CuZn / Au |
| Contact carrier material | PA 66 | PA 66 | PA 66 |
| Inflammability class according to UL 94 | V0 | V0 | V0 |
| Cable type | TPE litz wire | TPE litz wire | TPE litz wire |
| Temperature data | | | |
| Plug / socket | [°C] | [°C] | [°C] |
| Cable, fixed installation | -25 ... 85 | -25 ... 85 | -25 ... 85 |
| | -25 ... 90 | -25 ... 90 | -25 ... 90 |

Ordering data

| Description | Coding | 4-pos. | | 5-pos. | | 8-pos. | |
|----------------------------------|--------------|-----------|-------------|-----------|-------------|-----------|-------------|
| | | Order No. | Pcs. / Pkt. | Order No. | Pcs. / Pkt. | Order No. | Pcs. / Pkt. |
| Device plug-in connectors | | | | | | | |
| Socket | A - standard | 1408436 | 1 | 1408454 | 1 | 1408453 | 1 |
| Plug | A - standard | 1408451 | 1 | 1408446 | 1 | 1408442 | 1 |

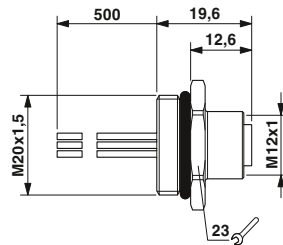

M12 flush-type socket

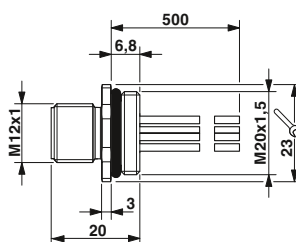

M12 flush-type plug

M5 to M12 circular plug-in connectors

M12 sensor/actuator device plug-in connectors, front mounting

One-piece, 20 mm square flange, with 0.5 m long litz wires

- 4 x fixing hole, 3.2 mm
- With form seal for M3 screws



4, 5, 8-pos.



12, 17-pos.



| | Technical data | | | Technical data | | | | | | | |
|--|-------------------|------------------|------------------|------------------|------------------|---------------|-------------|----------------|---|----------------|---|
| | 4-pos. | 5-pos. | 8-pos. | 12-pos. | 17-pos. | | | | | | |
| General data | | | | | | | | | | | |
| M12 circular plug-in connector according to: | IEC 61076-2-101 | IEC 61076-2-101 | IEC 61076-2-101 | IEC 61076-2-101 | IEC 61076-2-101 | - | | | | | |
| Pollution degree | 3 | 3 | 3 | 3 | 3 | - | | | | | |
| Degree of protection | IP67 | IP67 | IP67 | IP67 | IP67 | - | | | | | |
| Connection method | Individual wires | Individual wires | Individual wires | Individual wires | Individual wires | - | | | | | |
| Electrical data | | | | | | | | | | | |
| Rated voltage | 250 V | 60 V | 30 V | 30 V | 30 V | - | | | | | |
| Rated current | 4 A | 4 A | 2 A | 1.5 A | 1.5 A | - | | | | | |
| Volume resistance | ≤ 3 mΩ | ≤ 3 mΩ | ≤ 3 mΩ | ≤ 3 mΩ | ≤ 3 mΩ | - | | | | | |
| Material data | | | | | | | | | | | |
| Material contact / contact surface | CuZn / Ni/Au | CuZn / Ni/Au | CuZn / Ni/Au | CuZn / Ni/Au | CuZn / Ni/Au | - / - | | | | | |
| Contact carrier material | PA 66 | PA 66 | PA 66 | PA 66 | PA 66 | - | | | | | |
| Inflammability class according to UL 94 | V0 | V0 | V0 | V0 | V0 | - | | | | | |
| Cable type | TPE litz wire | TPE litz wire | TPE litz wire | TPE litz wire | TPE litz wire | - | | | | | |
| Temperature data | | | | | | | | | | | |
| Plug / socket | [-25 ... 85] [°C] | [-25 ... 85] | [-25 ... 85] | [-25 ... 85] | [-25 ... 85] | - | | | | | |
| Description | Coding | Ordering data | | | Ordering data | | | | | | |
| | | Order No. | Pcs. / Pkt. | Order No. | Pcs. / Pkt. | Order No. | Pcs. / Pkt. | | | | |
| Device plug-in connectors | | 4-pos. | | 5-pos. | | 8-pos. | | 12-pos. | | 17-pos. | |
| Socket | A - standard | 1419797 | 1 | 1441655 | 1 | 1441697 | 1 | 1441710 | 1 | 1441736 | 1 |
| Plug | A - standard | 1419784 | 1 | 1441642 | 1 | 1441684 | 1 | 1441707 | 1 | 1441723 | 1 |
| Socket | D - data | 1441639 | 1 | | | | | | | | |
| Plug | D - data | 1441626 | 1 | | | | | | | | |
| Socket | B - inverse | | | 1441671 | 1 | | | | | | |
| Plug | B - inverse | | | 1441668 | 1 | | | | | | |



M12 flush-type socket, square flange



M12 flush-type plug, square flange

M5 to M12 circular plug-in connectors

M12 sensor/actuator device plug-in connectors, front mounting

One-piece, 25 mm square flange, with 0.5 m long litz wires

- 4 x fixing hole, 2.7 mm
- With form seal for M2.5 screws



4, 5, 8-pos.

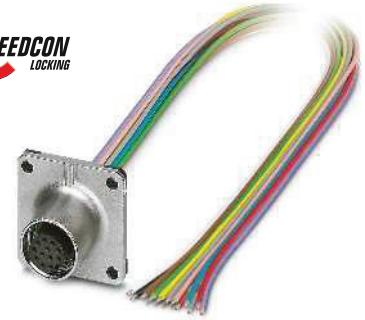

12, 17-pos.



| | Technical data | | | Technical data | | |
|--|------------------|------------------|------------------|------------------|------------------|-------|
| | 4-pos. | 5-pos. | 8-pos. | 12-pos. | 17-pos. | |
| General data | | | | | | |
| M12 circular plug-in connector according to: | IEC 61076-2-101 | IEC 61076-2-101 | IEC 61076-2-101 | IEC 61076-2-101 | IEC 61076-2-101 | - |
| Pollution degree | 3 | 3 | 3 | 3 | 3 | - |
| Degree of protection | IP67 | IP67 | IP67 | IP67 | IP67 | - |
| Connection method | Individual wires | Individual wires | Individual wires | Individual wires | Individual wires | - |
| Electrical data | | | | | | |
| Rated voltage | 250 V | 60 V | 30 V | 30 V | 30 V | - |
| Rated current | 4 A | 4 A | 2 A | 1.5 A | 1.5 A | - |
| Volume resistance | ≤ 3 mΩ | ≤ 3 mΩ | ≤ 3 mΩ | ≤ 3 mΩ | ≤ 3 mΩ | - |
| Material data | | | | | | |
| Material contact / contact surface | CuZn / Ni/Au | CuZn / Ni/Au | CuZn / Ni/Au | CuZn / Ni/Au | CuZn / Ni/Au | - / - |
| Contact carrier material | PA 66 | PA 66 | PA 66 | PA 66 | PA 66 | - |
| Inflammability class according to UL 94 | V0 | V0 | V0 | V0 | V0 | - |
| Cable type | TPE litz wire | TPE litz wire | TPE litz wire | TPE litz wire | TPE litz wire | - |
| Temperature data | | | | | | |
| Plug / socket | -25 ... 85 | -25 ... 85 | -25 ... 85 | -25 ... 85 | -25 ... 85 | - |

| Description | Coding | Ordering data | | | | | | | | | |
|----------------------------------|--------------|---------------|-------------|-----------|-------------|-----------|-------------|---------|---|---------|---|
| | | Order No. | Pcs. / Pkt. | Order No. | Pcs. / Pkt. | Order No. | Pcs. / Pkt. | | | | |
| Device plug-in connectors | | | | | | | | | | | |
| Socket | A - standard | 1420003 | 1 | 1440986 | 1 | 1441574 | 1 | 1441590 | 1 | 1441613 | 1 |
| Plug | A - standard | 1419991 | 1 | 1440973 | 1 | 1441561 | 1 | 1441587 | 1 | 1441600 | 1 |
| Socket | D - data | 1440960 | 1 | | | | | | | | |
| Plug | D - data | 1440957 | 1 | | | | | | | | |
| Socket | B - inverse | | | 1441558 | 1 | | | | | | |
| Plug | B - inverse | | | 1440999 | 1 | | | | | | |

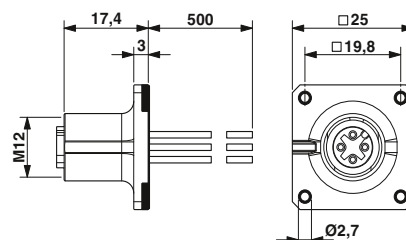

M12 flush-type socket, square flange

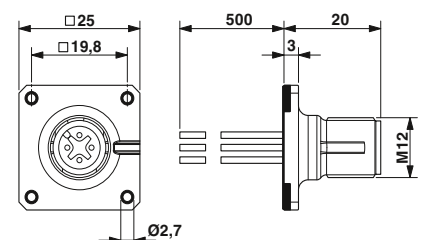

M12 flush-type plug, square flange

M5 to M12 circular plug-in connectors

M12 sensor/actuator device plug-in connectors, front mounting

Modular, 25 mm square flange, pre-assembled



Flange housing, housing bore holes 3.2 mm



With 0.5 m long litz wires, assembled contact carrier and insulating body



Technical data

| | | | |
|--|------------------------------|------------|-------|
| General data | | | |
| M12 circular plug-in connector according to: | IEC 61076-2-101 | - | - |
| Pollution degree | - | - | - |
| Degree of protection | - | - | - |
| Connection method | - | - | - |
| Electrical data | | | |
| Rated voltage | - | - | - |
| Rated current | - | - | - |
| Volume resistance | - | - | - |
| Material data | | | |
| Material contact / contact surface | - / - | - / - | - / - |
| Contact carrier material | - | - | - |
| Cable gland material | Zinc die-cast, nickel-plated | - | - |
| Inflammability class according to UL 94 | - | - | - |
| Cable type | - | - | - |
| Temperature data | | | |
| Plug / socket | [°C] | -25 ... 85 | - |
| Cable, fixed installation | [°C] | - | - |

Ordering data

| Description | Coding | Order No. | Pcs. / Pkt. | Order No. | Pcs. / Pkt. | Order No. | Pcs. / Pkt. |
|---|--------------|-----------|-------------|-----------|-------------|-----------|-------------|
| | | 4-pos. | 5-pos. | 8-pos. | | | |
| Square flange housing, with O-ring | | 1419959 | 10 | | | | |
| Assembled contact carrier and insulating body, with 0.5 m litz wires and crimp contacts | | | | | | | |
| Plug | A - standard | | | | | | |
| Plug | D - data | | | | | | |
| Plug | B - inverse | | | | | | |

Technical data

| 4-pos. | 5-pos. | 8-pos. |
|-----------------|-----------------|-----------------|
| IEC 61076-2-101 | IEC 61076-2-101 | IEC 61076-2-101 |
| 3 | 3 | 3 |
| IP67 | IP67 | IP67 |
| Crimp contacts | Crimp contacts | Crimp contacts |
| 250 V | 60 V | 30 V |
| 4 A | 4 A | 2 A |
| ≤ 3 mΩ | ≤ 3 mΩ | ≤ 3 mΩ |
| CuZn / Au | CuZn / Au | CuZn / Au |
| PA 66 | PA 66 | PA 66 |
| - | - | - |
| V0 | V0 | V0 |
| TPE litz wire | TPE litz wire | TPE litz wire |
| -25 ... 85 | -25 ... 85 | -25 ... 85 |
| -25 ... 85 | -25 ... 85 | -25 ... 85 |

Ordering data

| Order No. | Pcs. / Pkt. | Order No. | Pcs. / Pkt. | Order No. | Pcs. / Pkt. |
|-----------|-------------|-----------|-------------|-----------|-------------|
| 4-pos. | 5-pos. | 8-pos. | | | |
| 1440805 | 1 | 1440818 | 1 | 1457827 | 1 |
| 1440821 | 1 | 1440759 | 1 | | |



M12 square flange housing



M12 contact carrier, with litz wires

Modular, 25 mm square flange,
for free assembly



Flange housing,
housing bore holes 3.2 mm



Contact carriers
and insulating bodies for assembly



Technical data

| | | | |
|--|------------------------------|---|---|
| General data | | | |
| M12 circular plug-in connector according to: | IEC 61076-2-101 | - | - |
| Pollution degree | - | - | - |
| Degree of protection | - | - | - |
| Connection method | - | - | - |
| Electrical data | | | |
| Rated voltage | - | - | - |
| Rated current | - | - | - |
| Volume resistance | - | - | - |
| Material data | | | |
| Contact carrier material | - | - | - |
| Cable gland material | Zinc die-cast, nickel-plated | - | - |
| Inflammability class according to UL 94 | - | - | - |
| Temperature data | | | |
| Plug / socket | -25 ... 85 | - | - |

Ordering data

| | | | | | | | |
|--|--------------|-----------|-------------|-----------|-------------|-----------|-------------|
| Description | Coding | Order No. | Pcs. / Pkt. | Order No. | Pcs. / Pkt. | Order No. | Pcs. / Pkt. |
| Square flange housing, with O-ring | | 1419959 | 10 | | | | |
| Contact carriers and insulating bodies | | | | | | | |
| Plug | A - standard | | | | | | |
| Plug | D - data | | | | | | |
| Plug | B - inverse | | | | | | |
| Crimp contacts, for 4 and 5-pos. contact carriers, contact material: CuZn, surface: gold-plated, connection cross section: 0.08 mm ² ... 0.34 mm ² | | | | | | | |
| Contact Ø: 1.0 mm | | | | | | | |
| Crimp contacts, for 8-pos. contact carriers, contact material: CuZn, surface: gold-plated, connection cross section: 0.08 mm ² ... 0.34 mm ² | | | | | | | |
| Contact Ø: 0.8 mm | | | | | | | |

Accessories

| | | | |
|-----------------|--|--|--|
| Crimping pliers | | | |
|-----------------|--|--|--|



Technical data

| 4-pos. | 5-pos. | 8-pos. |
|-----------------|-----------------|-----------------|
| IEC 61076-2-101 | IEC 61076-2-101 | IEC 61076-2-101 |
| 3 | 3 | 3 |
| IP67 | IP67 | IP67 |
| Crimp contacts | Crimp contacts | Crimp contacts |
| 250 V | 60 V | 30 V |
| 4 A | 4 A | 2 A |
| ≤ 3 mΩ | ≤ 3 mΩ | ≤ 3 mΩ |
| PA 66 | PA 66 | PA 66 |
| - | - | - |
| V0 | V0 | V0 |
| -25 ... 85 | -25 ... 85 | -25 ... 85 |

Ordering data

| 4-pos. | 5-pos. | 8-pos. | | | |
|-----------|-------------|-----------|-------------|-----------|-------------|
| Order No. | Pcs. / Pkt. | Order No. | Pcs. / Pkt. | Order No. | Pcs. / Pkt. |
| 1440931 | 10 | 1419988 | 10 | 1440928 | 10 |
| 1440944 | 10 | 1440915 | 10 | | |
| 1452356 | 100 | 1452356 | 100 | | |
| | | | | 1452372 | 100 |

Accessories

| | | |
|----------------|---------|---|
| CRIMPFOX-TC MP | 1212510 | 1 |
|----------------|---------|---|



M12 square flange housing



M12 contact carrier

M5 to M12 circular plug-in connectors

M12 sensor/actuator device plug-in connectors, front mounting

One-piece, 20 mm square flange, for wave soldering processes

- M12 PCB connector for direct soldering with integrated torsion protection and shield connection



4, 5-pos.



8-pos.

| | Technical data | | Technical data | | Technical data | | |
|--|-----------------|-----------------|-----------------|---------------|----------------|---------------|-------------|
| | 4-pos. | 5-pos. | 8-pos. | | | | |
| General data | | | | | | | |
| M12 circular plug-in connector according to: | IEC 61076-2-101 | IEC 61076-2-101 | IEC 61076-2-101 | | | - | |
| Pollution degree | 3 | 3 | 3 | | | - | |
| Degree of protection | IP67 | IP67 | IP67 | | | - | |
| Connection method | Solder pins | Solder pins | Solder pins | | | - | |
| Electrical data | | | | | | | |
| Rated voltage | 250 V | 60 V | 30 V | | | - | |
| Rated current | 4 A | 4 A | 2 A | | | - | |
| Volume resistance | ≤ 3 mΩ | ≤ 3 mΩ | ≤ 3 mΩ | | | - | |
| Material data | | | | | | | |
| Material contact / contact surface | CuZn / Au | CuZn / Au | CuZn / Au | | | - / - | |
| Contact carrier material | PA 66 | PA 66 | PA 66 | | | - | |
| Inflammability class according to UL 94 | V0 | V0 | V0 | | | - | |
| Temperature data | | | | | | | |
| Plug / socket [°C] | -25 ... 85 | -25 ... 85 | -25 ... 85 | | | - | |
| | | Ordering data | | Ordering data | | Ordering data | |
| Description | Coding | Order No. | Pcs. / Pkt. | Order No. | Pcs. / Pkt. | Order No. | Pcs. / Pkt. |
| | | 4-pos. | | 5-pos. | | 8-pos. | |
| Device plug-in connectors | | | | | | | |
| Socket | A - standard | 1456420 | 10 | 1456446 | 10 | 1408573 | 10 |
| Plug | A - standard | 1456417 | 10 | 1456433 | 10 | 1408574 | 10 |
| Socket | D - data | 1456404 | 10 | | | | |
| Plug | D - data | 1456394 | 10 | | | | |
| Socket | B - inverse | | | 1456462 | 10 | | |
| Plug | B - inverse | | | 1456459 | 10 | | |

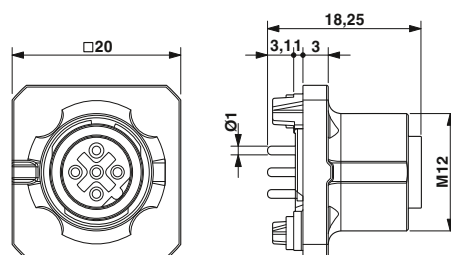

M12 flush-type socket, square flange (4/5-pos. version)

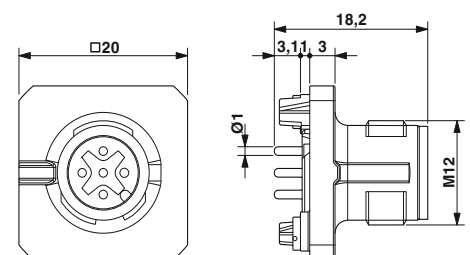

M12 flush-type plug, square flange (4/5-pos. version)

Contact carrier, plastic,
with solder cups or with litz wires



Solder connection, 5, 8-pos.



With 0.5 m long litz wires, 5, 8-pos.



Technical data

| | 5-pos. | 8-pos. |
|--|-----------------|-----------------|
| General data | | |
| M12 circular plug-in connector according to: | IEC 61076-2-101 | IEC 61076-2-101 |
| Pollution degree | 3 | 3 |
| Degree of protection | IP67 | IP67 |
| Connection method | Solder cup | Solder cup |
| Electrical data | | |
| Rated voltage | 60 V | 30 V |
| Rated current | 4 A | 2 A |
| Volume resistance | ≤ 3 mΩ | ≤ 3 mΩ |
| Material data | | |
| Material contact / contact surface | CuZn / Au | CuZn / Au |
| Contact carrier material | PA 66 | PA 66 |
| Inflammability class according to UL 94 | HB | HB |
| Cable type | - | - |
| Temperature data | | |
| Plug / socket | [-25 ... 85 °C] | [-25 ... 85 °C] |
| Cable, fixed installation | - | - |



Technical data

| | 5-pos. | 8-pos. |
|--|------------------|------------------|
| General data | | |
| M12 circular plug-in connector according to: | IEC 61076-2-101 | IEC 61076-2-101 |
| Pollution degree | 3 | 3 |
| Degree of protection | IP67 | IP67 |
| Connection method | Individual wires | Individual wires |
| Electrical data | | |
| Rated voltage | 60 V | 30 V |
| Rated current | 4 A | 2 A |
| Volume resistance | ≤ 3 mΩ | ≤ 3 mΩ |
| Material data | | |
| Material contact / contact surface | CuZn / Au | CuZn / Au |
| Contact carrier material | PA 66 | PA 66 |
| Inflammability class according to UL 94 | HB | HB |
| Cable type | TPE litz wire | TPE litz wire |
| Temperature data | | |
| Plug / socket | [-25 ... 85 °C] | [-25 ... 85 °C] |
| Cable, fixed installation | [-25 ... 90 °C] | [-25 ... 90 °C] |

Ordering data

| Description | Coding | 5-pos. | | 8-pos. | |
|--|--------------|-----------|-------------|-----------|-------------|
| | | Order No. | Pcs. / Pkt. | Order No. | Pcs. / Pkt. |
| Flush-type plug-in connector, M16 fastening thread | | | | | |
| Plug | A - standard | 1436398 | 20 | 1436408 | 20 |
| Flush-type plug-in connector, M12 fastening thread | | | | | |
| Plug | A - standard | 1436437 | 20 | 1436440 | 20 |

Ordering data

| Description | Coding | 5-pos. | | 8-pos. | |
|--|--------------|-----------|-------------|-----------|-------------|
| | | Order No. | Pcs. / Pkt. | Order No. | Pcs. / Pkt. |
| Flush-type plug-in connector, M16 fastening thread | | | | | |
| Plug | A - standard | 1436411 | 1 | 1436424 | 1 |
| Flush-type plug-in connector, M12 fastening thread | | | | | |
| Plug | A - standard | | | | |



M12 pin, M12 fastening thread, solder cups

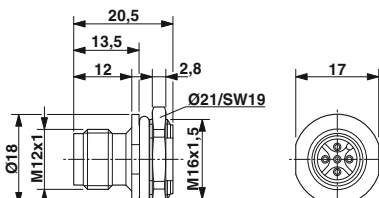

M12 pin, M16 fastening thread, solder cups

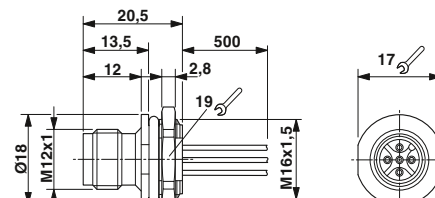

M12 pin, M16 fastening thread

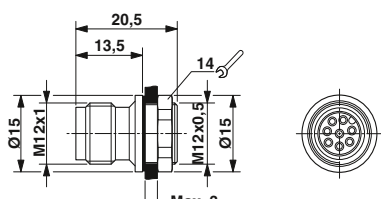

M12 pin, M12 fastening thread, solder cups

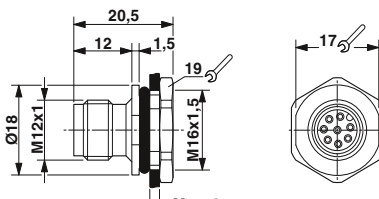

M12 pin, M16 fastening thread, solder cups

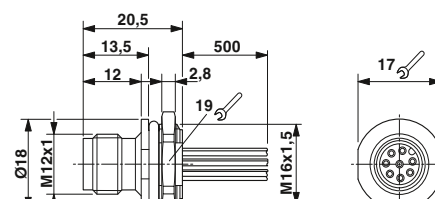

M12 pin, M16 fastening thread

M5 to M12 circular plug-in connectors

M12 sensor/actuator device plug-in connectors, rear mounting

Pg9 fastening thread,
with 0.5 m long litz wires



4, 5, 8-pos.



12, 17-pos.



| | Technical data | | |
|--|--------------------------|--------------------------|--------------------------|
| | 4-pos. | 5-pos. | 8-pos. |
| General data | | | |
| M12 circular plug-in connector according to: | IEC 61076-2-101 | IEC 61076-2-101 | IEC 61076-2-101 |
| Pollution degree | 3 | 3 | 3 |
| Degree of protection | IP67 | IP67 | IP67 |
| Connection method | Individual wires | Individual wires | Individual wires |
| Electrical data | | | |
| Rated voltage | 250 V | 60 V | 30 V |
| Rated current | 4 A | 4 A | 2 A |
| Volume resistance | $\leq 3 \text{ m}\Omega$ | $\leq 3 \text{ m}\Omega$ | $\leq 3 \text{ m}\Omega$ |
| Material data | | | |
| Material contact / contact surface | CuZn / Au | CuZn / Au | CuZn / Au |
| Contact carrier material | PA 66 | PA 66 | PA 66 |
| Inflammability class according to UL 94 | V0 | V0 | V0 |
| Cable type | TPE litz wire | TPE litz wire | TPE litz wire |
| Temperature data | | | |
| Plug / socket | [°C] | [°C] | [°C] |
| Cable, fixed installation | -25 ... 85 | -25 ... 85 | -25 ... 85 |



| | Technical data | | |
|--|--------------------------|--------------------------|-------|
| | 12-pos. | 17-pos. | |
| General data | | | |
| M12 circular plug-in connector according to: | IEC 61076-2-101 | IEC 61076-2-101 | - |
| Pollution degree | 3 | 3 | - |
| Degree of protection | IP67 | IP67 | - |
| Connection method | Individual wires | Individual wires | - |
| Electrical data | | | |
| Rated voltage | 30 V | 30 V | - |
| Rated current | 1.5 A | 1.5 A | - |
| Volume resistance | $\leq 3 \text{ m}\Omega$ | $\leq 3 \text{ m}\Omega$ | - |
| Material data | | | |
| Material contact / contact surface | CuZn / Au | CuZn / Au | - / - |
| Contact carrier material | PA 66 | PA 66 | - |
| Inflammability class according to UL 94 | V0 | V0 | - |
| Cable type | TPE litz wire | TPE litz wire | - |
| Temperature data | | | |
| Plug / socket | -25 ... 85 | -25 ... 85 | - |
| Cable, fixed installation | -25 ... 85 | -25 ... 85 | - |

| Description | Coding | Ordering data | | | | | | | | | |
|----------------------------------|--------------|---------------|-------------|-----------|-------------|-----------|-------------|-------------|---|---------|---|
| | | Order No. | Pcs. / Pkt. | Order No. | Pcs. / Pkt. | Order No. | Pcs. / Pkt. | | | | |
| | | 4-pos. | 5-pos. | 8-pos. | 12-pos. | 17-pos. | Order No. | Pcs. / Pkt. | | | |
| Device plug-in connectors | | | | | | | | | | | |
| Socket | A - standard | 1556621 | 1 | 1542729 | 1 | 1542732 | 1 | 1430446 | 1 | 1430462 | 1 |
| Plug | A - standard | 1556618 | 1 | 1542703 | 1 | 1542716 | 1 | 1430459 | 1 | 1430475 | 1 |
| Socket | D - data | 1551529 | 1 | | | | | | | | |
| Plug | D - data | 1551532 | 1 | | | | | | | | |
| Socket | B - inverse | | | 1543676 | 1 | | | | | | |
| Plug | B - inverse | | | 1543663 | 1 | | | | | | |

| Description | Coding | Ordering data | | | | | | | | | |
|----------------------------------|--------------|---------------|-------------|-----------|-------------|-----------|-------------|-------------|---|---------|---|
| | | Order No. | Pcs. / Pkt. | Order No. | Pcs. / Pkt. | Order No. | Pcs. / Pkt. | | | | |
| | | 4-pos. | 5-pos. | 8-pos. | 12-pos. | 17-pos. | Order No. | Pcs. / Pkt. | | | |
| Device plug-in connectors | | | | | | | | | | | |
| Socket | A - standard | 1556621 | 1 | 1542729 | 1 | 1542732 | 1 | 1430446 | 1 | 1430462 | 1 |
| Plug | A - standard | 1556618 | 1 | 1542703 | 1 | 1542716 | 1 | 1430459 | 1 | 1430475 | 1 |
| Socket | D - data | 1551529 | 1 | | | | | | | | |
| Plug | D - data | 1551532 | 1 | | | | | | | | |
| Socket | B - inverse | | | 1543676 | 1 | | | | | | |
| Plug | B - inverse | | | 1543663 | 1 | | | | | | |

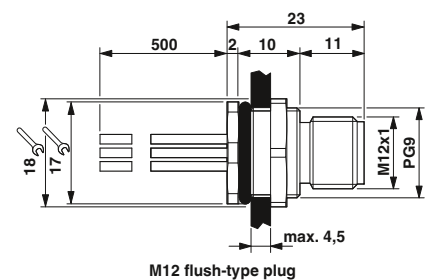
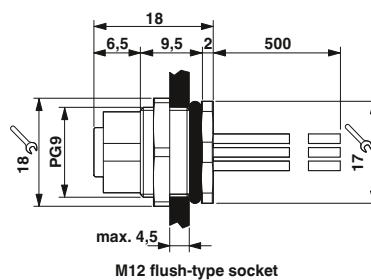

M5 to M12 circular plug-in connectors

M12 sensor/actuator device plug-in connectors, rear mounting

M12 fastening thread,
with 0.5 m long litz wires



4, 5, 8-pos.



12, 17-pos.



| | Technical data | | |
|--|------------------|------------------|------------------|
| | 4-pos. | 5-pos. | 8-pos. |
| General data | | | |
| M12 circular plug-in connector according to: | IEC 61076-2-101 | IEC 61076-2-101 | IEC 61076-2-101 |
| Pollution degree | 3 | 3 | 3 |
| Degree of protection | IP67 | IP67 | IP67 |
| Connection method | Individual wires | Individual wires | Individual wires |
| Electrical data | | | |
| Rated voltage | 250 V | 60 V | 30 V |
| Rated current | 4 A | 4 A | 2 A |
| Volume resistance | ≤ 3 mΩ | ≤ 3 mΩ | ≤ 3 mΩ |
| Material data | | | |
| Material contact / contact surface | CuZn / Au | CuZn / Au | CuZn / Au |
| Contact carrier material | PA 66 | PA 66 | PA 66 |
| Inflammability class according to UL 94 | V0 | V0 | V0 |
| Cable type | TPE litz wire | TPE litz wire | TPE litz wire |
| Temperature data | | | |
| Plug / socket [°C] | -25 ... 85 | -25 ... 85 | -25 ... 85 |
| Cable, fixed installation [°C] | -25 ... 85 | -25 ... 85 | -25 ... 85 |



| | Technical data | | |
|--|------------------|------------------|-------|
| | 12-pos. | 17-pos. | |
| General data | | | |
| M12 circular plug-in connector according to: | IEC 61076-2-101 | IEC 61076-2-101 | - |
| Pollution degree | 3 | 3 | - |
| Degree of protection | IP67 | IP67 | - |
| Connection method | Individual wires | Individual wires | - |
| Electrical data | | | |
| Rated voltage | 30 V | 30 V | - |
| Rated current | 1.5 A | 1.5 A | - |
| Volume resistance | ≤ 3 mΩ | ≤ 3 mΩ | - |
| Material data | | | |
| Material contact / contact surface | CuZn / Au | CuZn / Au | - / - |
| Contact carrier material | PA 66 | PA 66 | - |
| Inflammability class according to UL 94 | V0 | V0 | - |
| Cable type | TPE litz wire | TPE litz wire | - |
| Temperature data | | | |
| Plug / socket [°C] | -25 ... 85 | -25 ... 85 | - |
| Cable, fixed installation [°C] | -25 ... 85 | -25 ... 85 | - |

| Description | Coding | Ordering data | | | | | |
|----------------------------------|--------------|---------------|-------------|-----------|-------------|-----------|-------------|
| | | Order No. | Pcs. / Pkt. | Order No. | Pcs. / Pkt. | Order No. | Pcs. / Pkt. |
| | | 4-pos. | | 5-pos. | | 8-pos. | |
| Device plug-in connectors | | | | | | | |
| Plug | A - standard | 1551875 | 1 | 1551888 | 1 | 1551914 | 1 |
| Plug | D - data | 1551901 | 1 | | | | |
| Plug | B - inverse | | | 1551891 | 1 | | |

| Description | Coding | Ordering data | | | | | |
|----------------------------------|--------------|---------------|-------------|-----------|-------------|-----------|-------------|
| | | Order No. | Pcs. / Pkt. | Order No. | Pcs. / Pkt. | Order No. | Pcs. / Pkt. |
| | | 12-pos. | | 17-pos. | | | |
| Device plug-in connectors | | | | | | | |
| Plug | A - standard | 1437122 | 1 | 1437135 | 1 | | |

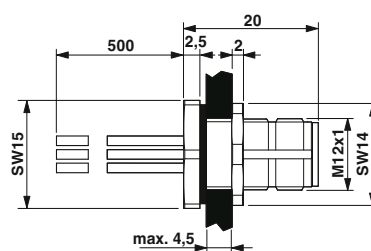

M12 flush-type plug, M12 fastening thread

M5 to M12 circular plug-in connectors

M12 sensor/actuator device plug-in connectors, rear mounting

M16 fastening thread, with 0.5 m long litz wires



4, 5, 8-pos.



12, 17-pos.



| | Technical data | | |
|--|------------------|------------------|------------------|
| | 4-pos. | 5-pos. | 8-pos. |
| General data | | | |
| M12 circular plug-in connector According to: | IEC 61076-2-101 | IEC 61076-2-101 | IEC 61076-2-101 |
| Pollution degree | 3 | 3 | 3 |
| Degree of protection | IP67 | IP67 | IP67 |
| Connection method | Individual wires | Individual wires | Individual wires |
| Electrical data | | | |
| Rated voltage | 250 V | 60 V | 30 V |
| Rated current | 4 A | 4 A | 2 A |
| Volume resistance | ≤ 3 mΩ | ≤ 3 mΩ | ≤ 3 mΩ |
| Material data | | | |
| Material contact / contact surface | CuZn / Au | CuZn / Au | CuZn / Au |
| Contact carrier material | PA 66 | PA 66 | PA 66 |
| Inflammability class according to UL 94 | V0 | V0 | V0 |
| Cable type | TPE litz wire | TPE litz wire | TPE litz wire |
| Temperature data | | | |
| Plug / socket | [°C] | [°C] | [°C] |
| Cable, fixed installation | -25 ... 85 | -25 ... 85 | -25 ... 85 |



| | Technical data | | |
|--|------------------|------------------|-------|
| | 12-pos. | 17-pos. | |
| General data | | | |
| M12 circular plug-in connector According to: | IEC 61076-2-101 | IEC 61076-2-101 | - |
| Pollution degree | 3 | 3 | - |
| Degree of protection | IP67 | IP67 | - |
| Connection method | Individual wires | Individual wires | - |
| Electrical data | | | |
| Rated voltage | 30 V | 30 V | - |
| Rated current | 1.5 A | 1.5 A | - |
| Volume resistance | ≤ 3 mΩ | ≤ 3 mΩ | - |
| Material data | | | |
| Material contact / contact surface | CuZn / Au | CuZn / Au | - / - |
| Contact carrier material | PA 66 | PA 66 | - |
| Inflammability class according to UL 94 | V0 | V0 | - |
| Cable type | TPE litz wire | TPE litz wire | - |
| Temperature data | | | |
| Plug / socket | -25 ... 85 | -25 ... 85 | - |
| Cable, fixed installation | -25 ... 85 | -25 ... 85 | - |

| Description | Coding | Ordering data | | | | | |
|----------------------------------|--------------|---------------|-------------|-----------|-------------|-----------|-------------|
| | | Order No. | Pcs. / Pkt. | Order No. | Pcs. / Pkt. | Order No. | Pcs. / Pkt. |
| | | 4-pos. | | 5-pos. | | 8-pos. | |
| Device plug-in connectors | | | | | | | |
| Socket | A - standard | 1419632 | 1 | 1419658 | 1 | 1419690 | 1 |
| Plug | A - standard | 1419629 | 1 | 1419645 | 1 | 1419687 | 1 |
| Socket | D - data | 1419616 | 1 | | | | |
| Plug | D - data | 1419603 | 1 | | | | |
| Socket | B - inverse | | | 1419674 | 1 | | |
| Plug | B - inverse | | | 1419661 | 1 | | |

| Description | Coding | Ordering data | | | | | |
|-------------|--------|---------------|-------------|-----------|-------------|-----------|-------------|
| | | Order No. | Pcs. / Pkt. | Order No. | Pcs. / Pkt. | Order No. | Pcs. / Pkt. |
| | | 12-pos. | | 17-pos. | | | |
| | | | | | | | |
| | | 1419713 | 1 | 1419739 | 1 | | |
| | | 1419700 | 1 | 1419726 | 1 | | |



M12 flush-type plug

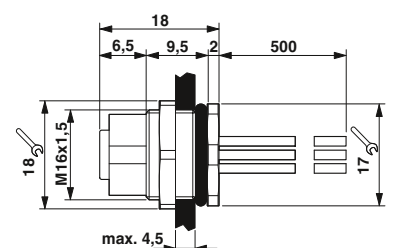

M12 flush-type socket

M5 to M12 circular plug-in connectors

M12 sensor/actuator device plug-in connectors, rear mounting

M16 fastening thread,
with assembled cable, shielded



PUR cable, 4, 5, 8-pos., shielded



PVC cable, 12, 17-pos., shielded

| | Technical data | | | Technical data | | | | | | | | |
|--|------------------------|------------------------|------------------------|-----------------|-----------------|-------------|---------------|-------------|-----------|-------------|-----------|-------------|
| | 4-pos. | 5-pos. | 8-pos. | 12-pos. | 17-pos. | | | | | | | |
| General data | | | | | | | | | | | | |
| M12 circular plug-in connector according to: | IEC 61076-2-101 | IEC 61076-2-101 | IEC 61076-2-101 | IEC 61076-2-101 | IEC 61076-2-101 | - | | | | | | |
| Pollution degree | 3 | 3 | 3 | 3 | 3 | - | | | | | | |
| Degree of protection | IP67 | IP67 | IP67 | IP67 | IP67 | - | | | | | | |
| Connection method | Free cable end | Free cable end | Free cable end | Free cable end | Free cable end | - | | | | | | |
| Electrical data | | | | | | | | | | | | |
| Rated voltage | 60 V | 60 V | 30 V | 30 V | 30 V | - | | | | | | |
| Rated current | 4 A | 4 A | 2 A | 1.5 A | 1.5 A | - | | | | | | |
| Volume resistance | ≤ 3 mΩ | ≤ 3 mΩ | ≤ 3 mΩ | ≤ 3 mΩ | ≤ 3 mΩ | - | | | | | | |
| Material data | | | | | | | | | | | | |
| Material contact / contact surface | CuZn / Au | CuZn / Au | CuZn / Au | CuZn / Au | CuZn / Au | - / - | | | | | | |
| Contact carrier material | PA 66 | PA 66 | PA 66 | PA 66 | PA 66 | - | | | | | | |
| Inflammability class according to UL 94 | V0 | V0 | V0 | V0 | V0 | - | | | | | | |
| Cable type | PUR halogen-free black | PUR halogen-free black | PUR halogen-free black | PVC black | PVC black | - | | | | | | |
| Temperature data | | | | | | | | | | | | |
| Plug / socket [°C] | -25 ... 85 | -25 ... 85 | -25 ... 85 | -25 ... 85 | -25 ... 85 | - | | | | | | |
| Cable, fixed installation [°C] | -30 ... 85 | -30 ... 85 | -30 ... 85 | -30 ... 85 | -30 ... 85 | - | | | | | | |
| | Ordering data | | | | | | Ordering data | | | | | |
| | Description | Cable length | Order No. | Pcs. / Pkt. | Order No. | Pcs. / Pkt. | Order No. | Pcs. / Pkt. | Order No. | Pcs. / Pkt. | Order No. | Pcs. / Pkt. |
| 4-pos. | | | 5-pos. | 8-pos. | 12-pos. | 17-pos. | 12-pos. | 17-pos. | 12-pos. | 17-pos. | | |
| Flush-type plug-in connector, A-coded | | | | | | | | | | | | |
| Socket | 1 m | 1419302 | 1 | 1419328 | 1 | 1419357 | 1 | 1442188 | 1 | 1442269 | 1 | |
| Plug | 1 m | 1419399 | 1 | 1419409 | 1 | 1419425 | 1 | 1442227 | 1 | 1442308 | 1 | |
| Socket | 2 m | 1419315 | 1 | 1419331 | 1 | 1419344 | 1 | 1442191 | 1 | 1442272 | 1 | |
| Plug | 2 m | 1419386 | 1 | 1419412 | 1 | 1419438 | 1 | 1442230 | 1 | 1442311 | 1 | |

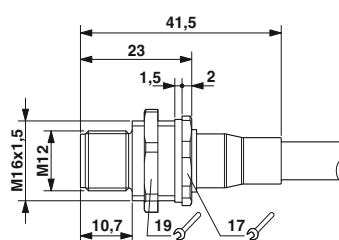

M12 flush-type plug

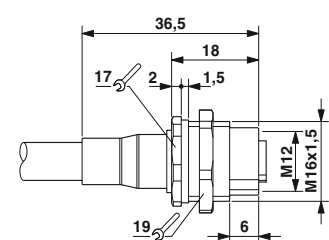

M12 flush-type socket

M5 to M12 circular plug-in connectors

M12 sensor/actuator device plug-in connectors, rear mounting

Pg9 fastening thread, one-piece, for wave soldering processes



Straight, 4, 5, 8-pos.



Straight, 12, 17-pos.



| | Technical data | | |
|--|-----------------|-----------------|-----------------|
| | 4-pos. | 5-pos. | 8-pos. |
| General data | | | |
| M12 circular plug-in connector according to: | IEC 61076-2-101 | IEC 61076-2-101 | IEC 61076-2-101 |
| Pollution degree | 3 | 3 | 3 |
| Degree of protection | IP67 | IP67 | IP67 |
| Connection method | Solder pins | Solder pins | Solder pins |
| Electrical data | | | |
| Rated voltage | 250 V | 60 V | 30 V |
| Rated current | 4 A | 4 A | 2 A |
| Volume resistance | ≤ 3 mΩ | ≤ 3 mΩ | ≤ 3 mΩ |
| Material data | | | |
| Material contact / contact surface | CuZn / Au | CuZn / Au | CuZn / Au |
| Contact carrier material | PA 66 | PA 66 | PA 66 |
| Inflammability class according to UL 94 | V0 | V0 | V0 |
| Temperature data | | | |
| Plug / socket | -25 ... 85 | -25 ... 85 | -25 ... 85 |



| | Technical data | | |
|--|-----------------|-----------------|-------|
| | 12-pos. | 17-pos. | |
| General data | | | |
| M12 circular plug-in connector according to: | IEC 61076-2-101 | IEC 61076-2-101 | - |
| Pollution degree | 3 | 3 | - |
| Degree of protection | IP67 | IP67 | - |
| Connection method | Solder pins | Solder pins | - |
| Electrical data | | | |
| Rated voltage | 30 V | 30 V | - |
| Rated current | 1.5 A | 1.5 A | - |
| Volume resistance | ≤ 3 mΩ | ≤ 3 mΩ | - |
| Material data | | | |
| Material contact / contact surface | CuZn / Au | CuZn / Au | - / - |
| Contact carrier material | PA 66 | PA 66 | - |
| Inflammability class according to UL 94 | V0 | V0 | - |
| Temperature data | | | |
| Plug / socket | -25 ... 85 | -25 ... 85 | - |

| Description | Coding | Ordering data | | |
|---|--------------|---------------|-------------|-----------|
| | | Order No. | Pcs. / Pkt. | Order No. |
| Device plug-in connector, solder pin length: 6 mm | | | | |
| Socket | A - standard | 1553462 | 20 | 1542761 |
| Plug | A - standard | 1553459 | 20 | 1542745 |
| Socket | D - data | 1551503 | 20 | 1542758 |
| Plug | D - data | 1551516 | 20 | |
| Socket | B - inverse | | | 1543650 |
| Plug | B - inverse | | | 1543647 |
| Device plug-in connector, solder pin length: 12 mm | | | | |
| Socket | A - standard | | | 1552285 |
| Plug | A - standard | | | 1552311 |
| Socket | D - data | 1552272 | 20 | 1408770 |
| Plug | D - data | 1552308 | 20 | |
| Socket | B - inverse | | | 1552298 |
| Plug | B - inverse | | | 1552324 |

| Description | Coding | Ordering data | | |
|--|--------------|---------------|-------------|-----------|
| | | Order No. | Pcs. / Pkt. | Order No. |
| Device plug-in connector, solder pin length: 6 mm | | | | |
| Socket | A - standard | 1559929 | 20 | 1559958 |
| Plug | A - standard | 1559932 | 20 | 1559961 |



M12 flush-type socket, contact length: 12 mm

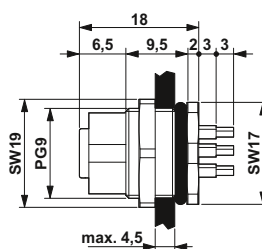

M12 flush-type socket, contact length: 6 mm



M12 flush-type plug, contact length: 6 mm

Pg9 fastening thread, one-piece, for wave soldering processes, shielded



Ethernet



Straight, 4, 5, 8-pos.



Straight, 12, 17-pos.



| | Technical data | | | Technical data | | |
|--|-----------------|-----------------|-----------------|-----------------|-----------------|-------|
| | 4-pos. | 5-pos. | 8-pos. | 12-pos. | 17-pos. | |
| General data | | | | | | |
| M12 circular plug-in connector according to: | IEC 61076-2-101 | IEC 61076-2-101 | IEC 61076-2-101 | IEC 61076-2-101 | IEC 61076-2-101 | - |
| Pollution degree | 3 | 3 | 3 | 3 | 3 | - |
| Degree of protection | IP67 | IP67 | IP67 | IP67 | IP67 | - |
| Connection method | Solder pins | Solder pins | Solder pins | Solder pins | Solder pins | - |
| Electrical data | | | | | | |
| Rated voltage | 250 V | 60 V | 30 V | 30 V | 30 V | - |
| Rated current | 4 A | 4 A | 2 A | 1.5 A | 1.5 A | - |
| Volume resistance | ≤ 3 mΩ | ≤ 3 mΩ | ≤ 3 mΩ | ≤ 3 mΩ | ≤ 3 mΩ | - |
| Material data | | | | | | |
| Material contact / contact surface | CuZn / Au | CuZn / Au | CuZn / Au | CuZn / Au | CuZn / Au | - / - |
| Contact carrier material | PA 66 | PA 66 | PA 66 | PA 66 | PA 66 | - |
| Inflammability class according to UL 94 | V0 | V0 | V0 | V0 | V0 | - |
| Temperature data | | | | | | |
| Plug / socket | -25 ... 85 | -25 ... 85 | -25 ... 85 | -25 ... 85 | -25 ... 85 | - |

| | Ordering data | | | | | | Ordering data | | | | | |
|--|---------------|-------------|-----------|-------------|-----------|-------------|---------------|-------------|-----------|-------------|-----------|-------------|
| | 4-pos. | | 5-pos. | | 8-pos. | | 12-pos. | | 17-pos. | | | |
| Description | Order No. | Pcs. / Pkt. | Order No. | Pcs. / Pkt. | Order No. | Pcs. / Pkt. | Order No. | Pcs. / Pkt. | Order No. | Pcs. / Pkt. | Order No. | Pcs. / Pkt. |
| Device plug-in connector, solder pin length: 6 mm | | | | | | | | | | | | |
| Socket A - standard | 1556841 | 20 | 1553019 | 20 | 1553860 | 20 | 1436770 | 20 | 1436806 | 20 | | |
| Plug A - standard | | | 1553048 | 20 | 1553873 | 20 | 1436783 | 20 | 1436819 | 20 | | |
| Socket D - data | 1553006 | 20 | | | | | | | | | | |
| Plug D - data | 1553035 | 20 | | | | | | | | | | |
| Socket B - inverse | | | 1553022 | 20 | | | | | | | | |
| Plug B - inverse | | | 1553051 | 20 | | | | | | | | |
| Device plug-in connector, solder pin length: 12 mm | | | | | | | | | | | | |
| Socket A - standard | 1558522 | 20 | 1558548 | 20 | 1408771 | 20 | | | | | | |
| Plug A - standard | 1558535 | 20 | 1558551 | 20 | | | | | | | | |
| Socket D - data | 1558506 | 20 | | | | | | | | | | |
| Plug D - data | 1558519 | 20 | | | | | | | | | | |
| Socket B - inverse | | | 1558564 | 20 | | | | | | | | |
| Plug B - inverse | | | 1558577 | 20 | | | | | | | | |

| Accessories | | | Accessories | | | |
|--|--------------------|---------|-------------|--------------------|---------|----|
| EMC hexagonal nuts with fine toothing, for all flush-type plug-in connectors with: Pg9 fastening thread | SACC-PG9-KD-NUT-SH | 1440177 | 10 | SACC-PG9-KD-NUT-SH | 1440177 | 10 |



M12 flush-type socket, contact length: 12 mm

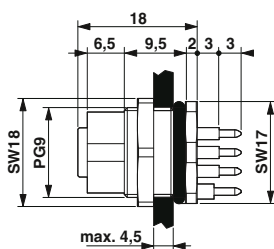

M12 flush-type socket, contact length: 6 mm



M12 flush-type plug, contact length: 6 mm

M5 to M12 circular plug-in connectors

M12 sensor/actuator device plug-in connectors, rear mounting

M12 fastening thread, one-piece, for wave soldering processes



Straight, 4, 5, 8-pos.



Straight, 12, 17-pos.



| | Technical data | | | Technical data | | | | | | | |
|--|-----------------|-----------------|-----------------|-----------------|-----------------|-----------|-------------|-----------|-------------|-----------|-------------|
| | 4-pos. | 5-pos. | 8-pos. | 12-pos. | 17-pos. | | | | | | |
| General data | | | | | | | | | | | |
| M12 circular plug-in connector according to: | IEC 61076-2-101 | IEC 61076-2-101 | IEC 61076-2-101 | IEC 61076-2-101 | IEC 61076-2-101 | - | | | | | |
| Pollution degree | 3 | 3 | 3 | 3 | 3 | - | | | | | |
| Degree of protection | IP67 | IP67 | IP67 | IP67 | IP67 | - | | | | | |
| Connection method | Solder pins | Solder pins | Solder pins | Solder pins | Solder pins | - | | | | | |
| Electrical data | | | | | | | | | | | |
| Rated voltage | 250 V | 60 V | 30 V | 30 V | 30 V | - | | | | | |
| Rated current | 4 A | 4 A | 2 A | 1.5 A | 1.5 A | - | | | | | |
| Volume resistance | ≤ 3 mΩ | ≤ 3 mΩ | ≤ 3 mΩ | ≤ 3 mΩ | ≤ 3 mΩ | - | | | | | |
| Material data | | | | | | | | | | | |
| Material contact / contact surface | CuZn / Au | CuZn / Au | CuZn / Au | CuZn / Au | CuZn / Au | - / - | | | | | |
| Contact carrier material | PA 66 | PA 66 | PA 66 | PA 66 | PA 66 | - | | | | | |
| Inflammability class according to UL 94 | V0 | V0 | V0 | V0 | V0 | - | | | | | |
| Temperature data | | | | | | | | | | | |
| Plug / socket | [°C] | -25 ... 85 | -25 ... 85 | -25 ... 85 | -25 ... 85 | - | | | | | |
| | Ordering data | | | Ordering data | | | | | | | |
| Description | Coding | Order No. | Pcs. / Pkt. | Order No. | Pcs. / Pkt. | Order No. | Pcs. / Pkt. | Order No. | Pcs. / Pkt. | Order No. | Pcs. / Pkt. |
| | | 4-pos. | | 5-pos. | | 8-pos. | | 12-pos. | | 17-pos. | |
| Device plug-in connectors | | | | | | | | | | | |
| Plug | A - standard | 1551820 | 20 | 1551833 | 20 | 1551862 | 20 | 1559945 | 20 | 1559974 | 20 |
| Plug | D - data | 1551859 | 20 | | | | | | | | |
| Plug | B - inverse | | | 1551846 | 20 | | | | | | |



M12 fastening thread, one-piece, for wave soldering processes, shielded



Straight, 4, 5, 8-pos.



Straight, 12, 17-pos.



| | Technical data | | |
|--|-----------------|-----------------|-----------------|
| | 4-pos. | 5-pos. | 8-pos. |
| General data | | | |
| M12 circular plug-in connector according to: | IEC 61076-2-101 | IEC 61076-2-101 | IEC 61076-2-101 |
| Pollution degree | 3 | 3 | 3 |
| Degree of protection | IP67 | IP67 | IP67 |
| Connection method | Solder pins | Solder pins | Solder pins |
| Electrical data | | | |
| Rated voltage | 250 V | 60 V | 30 V |
| Rated current | 4 A | 4 A | 2 A |
| Volume resistance | ≤ 3 mΩ | ≤ 3 mΩ | ≤ 3 mΩ |
| Material data | | | |
| Material contact / contact surface | CuZn / Au | CuZn / Au | CuZn / Au |
| Contact carrier material | PA 66 | PA 66 | PA 66 |
| Inflammability class according to UL 94 | V0 | V0 | V0 |
| Temperature data | | | |
| Plug / socket | -25 ... 85 | -25 ... 85 | -25 ... 85 |



| | Technical data | | |
|--|-----------------|-----------------|-----|
| | 12-pos. | 17-pos. | |
| General data | | | |
| M12 circular plug-in connector according to: | IEC 61076-2-101 | IEC 61076-2-101 | - |
| Pollution degree | 3 | 3 | - |
| Degree of protection | IP67 | IP67 | - |
| Connection method | Solder pins | Solder pins | - |
| Electrical data | | | |
| Rated voltage | 30 V | 30 V | - |
| Rated current | 1.5 A | 1.5 A | - |
| Volume resistance | ≤ 3 mΩ | ≤ 3 mΩ | - |
| Material data | | | |
| Material contact / contact surface | CuZn / Au | CuZn / Au | -/- |
| Contact carrier material | PA 66 | PA 66 | - |
| Inflammability class according to UL 94 | V0 | V0 | - |
| Temperature data | | | |
| Plug / socket | -25 ... 85 | -25 ... 85 | - |

| Description | Coding | Ordering data | | | | | |
|----------------------------------|--------------|---------------|-------------|-----------|-------------|-----------|-------------|
| | | 4-pos. | | 5-pos. | | 8-pos. | |
| | | Order No. | Pcs. / Pkt. | Order No. | Pcs. / Pkt. | Order No. | Pcs. / Pkt. |
| Device plug-in connectors | | | | | | | |
| Plug | A - standard | 1552955 | 20 | 1552968 | 20 | 1552997 | 20 |
| Plug | D - data | 1552984 | 20 | | | | |
| Plug | B - inverse | | | 1552971 | 20 | | |

| Description | Coding | Ordering data | | | | | |
|----------------------------------|--------------|---------------|-------------|-----------|-------------|-----------|-------------|
| | | 12-pos. | | 17-pos. | | | |
| | | Order No. | Pcs. / Pkt. | Order No. | Pcs. / Pkt. | Order No. | Pcs. / Pkt. |
| Device plug-in connectors | | | | | | | |
| Plug | A - standard | 1437106 | 20 | 1437119 | 20 | | |

| Accessories | | |
|--|--------------------|------------|
| EMC hexagonal nuts with fine toothing, for all flush-type plug-in connectors with: | | |
| M12 fastening thread | SACC-M12-KD-NUT-SH | 1440151 10 |

| Accessories | | |
|--|--------------------|------------|
| EMC hexagonal nuts with fine toothing, for all flush-type plug-in connectors with: | | |
| M12 fastening thread | SACC-M12-KD-NUT-SH | 1440151 10 |



M5 to M12 circular plug-in connectors

M12 sensor/actuator device plug-in connectors, rear mounting

M16 fastening thread, one-piece, for wave soldering processes



Straight, 4, 5, 8-pos.



Straight, 12, 17-pos.



| | Technical data | | | | | |
|--|-----------------|--|-----------------|--|-----------------|--|
| | 4-pos. | | 5-pos. | | 8-pos. | |
| General data | IEC 61076-2-101 | | | | | |
| M12 circular plug-in connector according to: | IEC 61076-2-101 | | IEC 61076-2-101 | | IEC 61076-2-101 | |
| Pollution degree | 3 | | 3 | | 3 | |
| Degree of protection | IP67 | | IP67 | | IP67 | |
| Connection method | Solder pins | | Solder pins | | Solder pins | |
| Electrical data | 250 V | | 60 V | | 30 V | |
| Rated voltage | 4 A | | 4 A | | 2 A | |
| Rated current | ≤ 3 mΩ | | ≤ 3 mΩ | | ≤ 3 mΩ | |
| Volume resistance | CuZn / Au | | CuZn / Au | | CuZn / Au | |
| Material data | PA 66 | | PA 66 | | PA 66 | |
| Material contact / contact surface | V0 | | V0 | | V0 | |
| Contact carrier material | -25 ... 85 | | -25 ... 85 | | -25 ... 85 | |
| Inflammability class according to UL 94 | - | | - | | - | |
| Temperature data | - | | - | | - | |
| Plug / socket | [°C] | | [°C] | | [°C] | |

| | Technical data | | | | | |
|--|-----------------|--|-----------------|--|-------|--|
| | 12-pos. | | 17-pos. | | | |
| General data | IEC 61076-2-101 | | | | | |
| M12 circular plug-in connector according to: | IEC 61076-2-101 | | IEC 61076-2-101 | | - | |
| Pollution degree | 3 | | 3 | | - | |
| Degree of protection | IP67 | | IP67 | | - | |
| Connection method | Solder pins | | Solder pins | | - | |
| Electrical data | 30 V | | 30 V | | - | |
| Rated voltage | 1.5 A | | 1.5 A | | - | |
| Rated current | ≤ 3 mΩ | | ≤ 3 mΩ | | - | |
| Volume resistance | CuZn / Au | | CuZn / Au | | - / - | |
| Material data | PA 66 | | PA 66 | | - | |
| Material contact / contact surface | V0 | | V0 | | - | |
| Contact carrier material | -25 ... 85 | | -25 ... 85 | | - | |
| Inflammability class according to UL 94 | - | | - | | - | |
| Temperature data | - | | - | | - | |
| Plug / socket | [°C] | | [°C] | | [°C] | |

| Description | Coding | Ordering data | | | | | |
|----------------------------------|--------------|---------------|-------------|-----------|-------------|-----------|-------------|
| | | Order No. | Pcs. / Pkt. | Order No. | Pcs. / Pkt. | Order No. | Pcs. / Pkt. |
| Device plug-in connectors | | 4-pos. | | 5-pos. | | 8-pos. | |
| Socket | A - standard | 1419755 | 20 | 1441778 | 20 | 1441817 | 20 |
| Plug | A - standard | 1419742 | 20 | 1441765 | 20 | 1441804 | 20 |
| Socket | D - data | 1441752 | 20 | | | | |
| Plug | D - data | 1441749 | 20 | | | | |
| Socket | B - inverse | | | 1441794 | 20 | | |
| Plug | B - inverse | | | 1441781 | 20 | | |



M12 flush-type socket



M12 flush-type plug

M16 fastening thread, one-piece, for wave soldering processes, shielded



Straight, 4, 5, 8-pos.



Straight, 12, 17-pos.



| | Technical data | | | | | |
|---|--|--|-------------|--|-------------|--|
| | 4-pos. | | 5-pos. | | 8-pos. | |
| General data | M12 circular plug-in connector according to: | | | | | |
| Pollution degree | 3 | | 3 | | 3 | |
| Degree of protection | IP67 | | IP67 | | IP67 | |
| Connection method | Solder pins | | Solder pins | | Solder pins | |
| Electrical data | 250 V | | 60 V | | 30 V | |
| Rated voltage | 4 A | | 4 A | | 2 A | |
| Rated current | ≤ 3 mΩ | | ≤ 3 mΩ | | ≤ 3 mΩ | |
| Volume resistance | CuZn / Au | | CuZn / Au | | CuZn / Au | |
| Material data | PA 66 | | PA 66 | | PA 66 | |
| Material contact / contact surface | V0 | | V0 | | V0 | |
| Contact carrier material | -25 ... 85 | | -25 ... 85 | | -25 ... 85 | |
| Inflammability class according to UL 94 | -25 ... 85 | | -25 ... 85 | | -25 ... 85 | |
| Temperature data | - | | - | | - | |
| Plug / socket | - | | - | | - | |

| | Technical data | | | | | |
|---|--|--|-------------|--|-------|--|
| | 12-pos. | | 17-pos. | | | |
| General data | M12 circular plug-in connector according to: | | | | | |
| Pollution degree | 3 | | 3 | | - | |
| Degree of protection | IP67 | | IP67 | | - | |
| Connection method | Solder pins | | Solder pins | | - | |
| Electrical data | 30 V | | 30 V | | - | |
| Rated voltage | 1.5 A | | 1.5 A | | - | |
| Rated current | ≤ 3 mΩ | | ≤ 3 mΩ | | - | |
| Volume resistance | CuZn / Au | | CuZn / Au | | - / - | |
| Material data | PA 66 | | PA 66 | | - | |
| Material contact / contact surface | V0 | | V0 | | - | |
| Contact carrier material | -25 ... 85 | | -25 ... 85 | | - | |
| Inflammability class according to UL 94 | - | | - | | - | |
| Temperature data | - | | - | | - | |
| Plug / socket | - | | - | | - | |

| Description | Coding | Ordering data | | | | | | | | | |
|----------------------------------|--------------|---------------|-------------|-----------|-------------|-----------|-------------|---------|----|---------|----|
| | | Order No. | Pcs. / Pkt. | Order No. | Pcs. / Pkt. | Order No. | Pcs. / Pkt. | | | | |
| Device plug-in connectors | | 4-pos. | | 5-pos. | | 8-pos. | | 12-pos. | | 17-pos. | |
| Socket | A - standard | 1419771 | 20 | 1441891 | 20 | 1441930 | 20 | 1441956 | 20 | 1441972 | 20 |
| Plug | A - standard | 1419768 | 20 | 1441888 | 20 | 1441927 | 20 | 1441943 | 20 | 1441969 | 20 |
| Socket | D - data | 1441875 | 20 | | | | | | | | |
| Plug | D - data | 1441862 | 20 | | | | | | | | |
| Socket | B - inverse | | | 1441914 | 20 | | | | | | |
| Plug | B - inverse | | | 1441901 | 20 | | | | | | |

| Description | Accessories | | |
|--|--------------------|-------------|-----------|
| | Order No. | Pcs. / Pkt. | Order No. |
| EMC hexagonal nuts with fine toothing, for all flush-type plug-in connectors with: | | | |
| M16 fastening thread | SACC-M16-KD-NUT-SH | 1440164 | 10 |



M5 to M12 circular plug-in connectors

M12 sensor/actuator device plug-in connectors, rear mounting

Contact carrier, two-piece, angled,
for wave soldering processes



Angled, 4, 5, 8-pos.



Angled, shielded, 4, 5, 8-pos.



| | Technical data | | |
|--|-----------------|-----------------|-----------------|
| | 4-pos. | 5-pos. | 8-pos. |
| General data | | | |
| M12 circular plug-in connector according to: | IEC 61076-2-101 | IEC 61076-2-101 | IEC 61076-2-101 |
| Pollution degree | 3 | 3 | 3 |
| Degree of protection | IP67 | IP67 | IP67 |
| Connection method | Solder pins | Solder pins | Solder pins |
| Electrical data | | | |
| Rated voltage | 250 V | 60 V | 30 V |
| Rated current | 4 A | 4 A | 2 A |
| Volume resistance | ≤ 3 mΩ | ≤ 3 mΩ | ≤ 3 mΩ |
| Material data | | | |
| Material contact / contact surface | CuZn / Au | CuZn / Au | CuZn / Au |
| Contact carrier material | PA 66 | PA 66 | PA 66 |
| Inflammability class according to UL 94 | V0 | V0 | V0 |
| Temperature data | | | |
| Plug / socket | -25 ... 85 | -25 ... 85 | -25 ... 85 |



| | Technical data | | |
|--|-----------------|-----------------|-----------------|
| | 4-pos. | 5-pos. | 8-pos. |
| General data | | | |
| M12 circular plug-in connector according to: | IEC 61076-2-101 | IEC 61076-2-101 | IEC 61076-2-101 |
| Pollution degree | 3 | 3 | 3 |
| Degree of protection | IP67 | IP67 | IP67 |
| Connection method | Solder pins | Solder pins | Solder pins |
| Electrical data | | | |
| Rated voltage | 250 V | 60 V | 30 V |
| Rated current | 4 A | 4 A | 2 A |
| Volume resistance | ≤ 3 mΩ | ≤ 3 mΩ | ≤ 3 mΩ |
| Material data | | | |
| Material contact / contact surface | CuZn / Au | CuZn / Au | CuZn / Au |
| Contact carrier material | PA 66 | PA 66 | PA 66 |
| Inflammability class according to UL 94 | V0 | V0 | V0 |
| Temperature data | | | |
| Plug / socket | -25 ... 85 | -25 ... 85 | -25 ... 85 |

| Description | Coding | Ordering data | | | | | |
|------------------------|--------------|---------------|-------------|-----------|-------------|-----------|-------------|
| | | 4-pos. | | 5-pos. | | 8-pos. | |
| | | Order No. | Pcs. / Pkt. | Order No. | Pcs. / Pkt. | Order No. | Pcs. / Pkt. |
| Contact carrier | | | | | | | |
| Socket | A - standard | 1436628 | 20 | 1436644 | 20 | 1436990 | 20 |
| Plug | A - standard | 1436660 | 20 | 1436686 | 20 | 1436987 | 20 |
| Socket | D - data | | | | | | |
| Plug | D - data | | | | | | |
| Socket | B - inverse | | | | | | |
| Plug | B - inverse | | | | | | |

| Description | Coding | Ordering data | | | | | |
|------------------------|--------------|---------------|-------------|-----------|-------------|-----------|-------------|
| | | 4-pos. | | 5-pos. | | 8-pos. | |
| | | Order No. | Pcs. / Pkt. | Order No. | Pcs. / Pkt. | Order No. | Pcs. / Pkt. |
| Contact carrier | | | | | | | |
| Socket | A - standard | 1432444 | 20 | 1432431 | 20 | 1437009 | 20 |
| Plug | A - standard | 1439887 | 20 | 1439890 | 20 | 1437038 | 20 |
| Socket | D - data | 1432457 | 20 | | | | |
| Plug | D - data | 1436673 | 20 | | | | |
| Socket | B - inverse | | | 1432512 | 20 | | |
| Plug | B - inverse | | | 1436699 | 20 | | |

| Accessories |
|----------------------|
| See page 258 onwards |

| Accessories |
|----------------------|
| See page 258 onwards |

Housing screw connections, SPEEDCON screw versions and press-in versions, for all two-piece THR and wave soldering contact carriers



M12 socket contact carrier, angled, 4, 5-pos.



M12 socket contact carrier, angled, 8-pos.

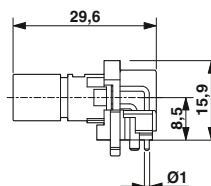

M12 pin contact carrier, angled, 4, 5-pos.

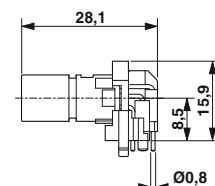

M12 pin contact carrier, angled, 8-pos.

Contact carrier, two-piece, angled,
for wave soldering processes



Angled, 12, 17-pos.



Angled, shielded, 12, 17-pos.

| | Technical data | | | Technical data | | | |
|--|----------------------|-----------------|-------------|----------------------|-----------------|-----------|-------------|
| | 12-pos. | 17-pos. | | 12-pos. | 17-pos. | | |
| General data | | | | | | | |
| M12 circular plug-in connector according to: | IEC 61076-2-101 | IEC 61076-2-101 | - | IEC 61076-2-101 | IEC 61076-2-101 | - | |
| Pollution degree | 3 | 3 | - | 3 | 3 | - | |
| Degree of protection | IP67 | IP67 | - | IP67 | IP67 | - | |
| Connection method | Solder pins | Solder pins | - | Solder pins | Solder pins | - | |
| Electrical data | | | | | | | |
| Rated voltage | 30 V | 30 V | - | 30 V | 30 V | - | |
| Rated current | 1.5 A | 1.5 A | - | 1.5 A | 1.5 A | - | |
| Volume resistance | ≤ 3 mΩ | ≤ 3 mΩ | - | ≤ 3 mΩ | ≤ 3 mΩ | - | |
| Material data | | | | | | | |
| Material contact / contact surface | CuZn / Au | CuZn / Au | - / - | CuZn / Au | CuZn / Au | - / - | |
| Contact carrier material | PA6T | PA6T | - | PA6T | PA6T | - | |
| Inflammability class according to UL 94 | V0 | V0 | - | V0 | V0 | - | |
| Temperature data | | | | | | | |
| Plug / socket | [°C] | -25 ... 85 | - | -25 ... 85 | -25 ... 85 | - | |
| | Ordering data | | | Ordering data | | | |
| Description | Coding | Order No. | Pcs. / Pkt. | Order No. | Pcs. / Pkt. | Order No. | Pcs. / Pkt. |
| | | 12-pos. | 17-pos. | 12-pos. | 17-pos. | 12-pos. | 17-pos. |
| Device plug-in connectors | | | | | | | |
| Socket | A - standard | 1424195 | 20 | 1424197 | 20 | 1424199 | 20 |
| Plug | A - standard | 1424194 | 20 | 1424196 | 20 | 1424198 | 20 |
| | Accessories | | | Accessories | | | |
| Housing screw connections, SPEEDCON screw versions and press-in versions, for all two-piece THR and wave soldering contact carriers | See page 258 onwards | | | See page 258 onwards | | | |

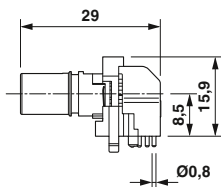

M12 socket contact carrier, angled, 12-pos.

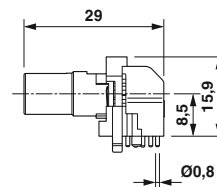

M12 socket contact carrier, angled, 17-pos.



M12 pin contact carrier, angled, 12-pos.



M12 pin contact carrier, angled, 17-pos.

M5 to M12 circular plug-in connectors

M12 sensor/actuator device plug-in connectors, rear mounting

Contact carrier, two-piece,
for wave soldering processes



Straight, 5-pos.



Straight, shielded, 4, 5-pos.



| | | Technical data | | | Technical data | | | |
|---|--------------|----------------------|-------------|-----------|----------------------|-----------------|-------------|--|
| | | 5-pos. | | | 4-pos. 5-pos. | | | |
| General data | | | | | | | | |
| M12 circular plug-in connector according to: | | IEC 61076-2-101 | - | - | IEC 61076-2-101 | IEC 61076-2-101 | - | |
| Pollution degree | | 3 | - | - | 3 | 3 | - | |
| Degree of protection | | IP67 | - | - | IP67 | IP67 | - | |
| Connection method | | Solder pins | - | - | Solder pins | Solder pins | - | |
| Electrical data | | | | | | | | |
| Rated voltage | | 60 V | - | - | 250 V | 60 V | - | |
| Rated current | | 4 A | - | - | 4 A | 4 A | - | |
| Volume resistance | | ≤ 3 mΩ | - | - | ≤ 3 mΩ | ≤ 3 mΩ | - | |
| Material data | | | | | | | | |
| Material contact / contact surface | | CuZn / Au | - / - | - / - | CuZn / Au | CuZn / Au | - / - | |
| Contact carrier material | | PA 66 | - | - | PA 66 | PA 66 | - | |
| Inflammability class according to UL 94 | | V0 | - | - | V0 | V0 | - | |
| Temperature data | | | | | | | | |
| Plug / socket [°C] | | -25 ... 85 | - | - | -25 ... 85 | -25 ... 85 | - | |
| | | Ordering data | | | Ordering data | | | |
| Description | Coding | Order No. | Pcs. / Pkt. | Order No. | Pcs. / Pkt. | Order No. | Pcs. / Pkt. | |
| | | 5-pos. | | | 4-pos. 5-pos. | | | |
| Contact carrier | | | | | | | | |
| Socket | A - standard | 1551464 | 20 | | | | | |
| Socket | D - data | | | | 1551480 | 20 | | |
| Socket | B - inverse | | | | 1551477 20 | | | |
| | | Accessories | | | Accessories | | | |
| Housing screw connections, SPEEDCON screw versions and press-in versions, for all two-piece THR and wave soldering contact carriers | | See page 258 onwards | | | See page 258 onwards | | | |

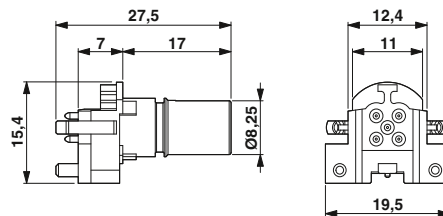

M12 socket contact carrier, straight, 4, 5-pos.

M5 to M12 circular plug-in connectors

M12 sensor/actuator device plug-in connectors, rear mounting

Two-piece, for reflow processes,
tray packaging, tape-on-reel packing



Straight, 4, 5, 8-pos.



Straight, 12, 17-pos.



| | Technical data | | | Technical data | | | |
|--|-----------------------|-----------------------|-----------------------|-----------------------|-----------------------|-----------|-------------|
| | 4-pos. | 5-pos. | 8-pos. | 12-pos. | 17-pos. | | |
| General data | | | | | | | |
| M12 circular plug-in connector according to: | IEC 61076-2-101 | IEC 61076-2-101 | IEC 61076-2-101 | IEC 61076-2-101 | IEC 61076-2-101 | - | |
| Pollution degree | 3 | 3 | 3 | 3 | 3 | - | |
| Degree of protection | IP67 | IP67 | IP67 | IP67 | IP67 | - | |
| Connection method | THR solder connection | THR solder connection | THR solder connection | THR solder connection | THR solder connection | - | |
| Electrical data | | | | | | | |
| Rated voltage | 250 V | 60 V | 30 V | 30 V | 30 V | - | |
| Rated current | 4 A | 4 A | 2 A | 1.5 A | 1.5 A | - | |
| Volume resistance | ≤ 3 mΩ | ≤ 3 mΩ | ≤ 3 mΩ | ≤ 3 mΩ | ≤ 3 mΩ | - | |
| Material data | | | | | | | |
| Material contact / contact surface | CuZn / Au | CuZn / Au | CuZn / Au | CuZn / Au | CuZn / Au | - / - | |
| Contact carrier material | PPA | PPA | PPA | PPA | PPA | - | |
| Inflammability class according to UL 94 | V0 | V0 | V0 | V0 | V0 | - | |
| Temperature data | | | | | | | |
| Plug / socket | -25 ... 85 | -25 ... 85 | -25 ... 85 | -25 ... 85 | -25 ... 85 | - | |
| | Ordering data | | | Ordering data | | | |
| Description | Coding | Order No. | Pcs. / Pkt. | Order No. | Pcs. / Pkt. | Order No. | Pcs. / Pkt. |
| | | 4-pos. | 5-pos. | 8-pos. | 12-pos. | 17-pos. | |
| Contact carrier, tray packaging | | | | | | | |
| Socket | A - standard | 1439942 | 60 | 1551448 | 60 | 1557808 | 60 |
| Plug | A - standard | 1437164 | 60 | 1552227 | 60 | 1552269 | 60 |
| Contact carrier, tape-on-reel packing with assembly pad | | | | | | | |
| Socket | A - standard | 1457610 | 100 | 1457649 | 100 | 1457678 | 100 |
| Plug | A - standard | 1457490 | 100 | 1457526 | 100 | 1457555 | 100 |
| | | Accessories | | | Accessories | | |
| Housing screw connections, SPEEDCON screw versions and press-in versions, for all two-piece THR and wave soldering contact carriers | | See page 258 onwards | | | See page 258 onwards | | |

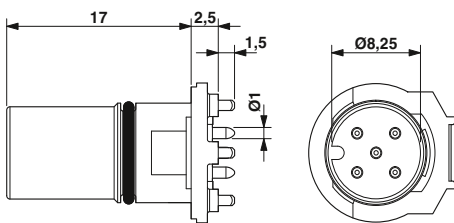

M12 socket contact carrier, straight, 4, 5-pos.

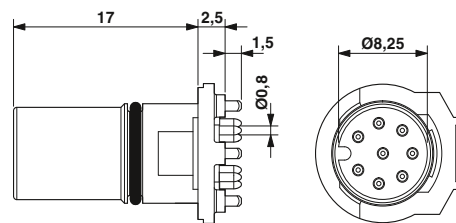

M12 socket contact carrier, straight, 8-pos.

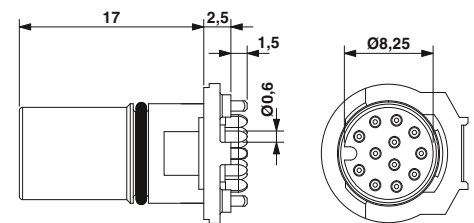

M12 socket contact carrier, straight, 12, 17-pos.

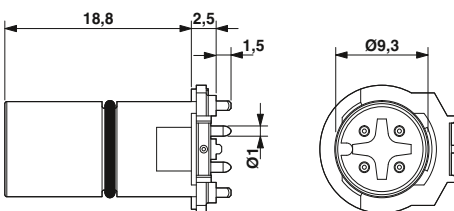

M12 plug contact carrier, straight, 4, 5-pos.

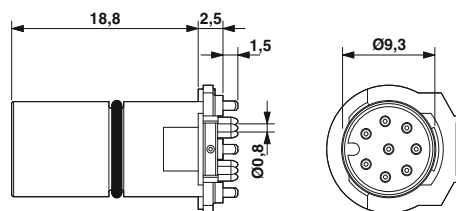

M12 plug contact carrier, straight, 8-pos.

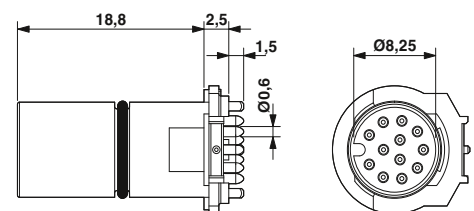

M12 plug contact carrier, straight, 12, 17-pos.

Two-piece, for reflow processes,
shielded, tray packaging,
tape-on-reel packing



Straight, 4, 5, 8-pos.



Straight, 12, 17-pos.



| | Technical data | | | Technical data | | |
|--|-----------------------|-----------------------|-----------------------|-----------------------|-----------------------|-------|
| | 4-pos. | 5-pos. | 8-pos. | 12-pos. | 17-pos. | |
| General data | | | | | | |
| M12 circular plug-in connector according to: | IEC 61076-2-101 | IEC 61076-2-101 | IEC 61076-2-101 | IEC 61076-2-101 | IEC 61076-2-101 | - |
| Pollution degree | 3 | 3 | 3 | 3 | 3 | - |
| Degree of protection | IP67 | IP67 | IP67 | IP67 | IP67 | - |
| Connection method | THR solder connection | THR solder connection | THR solder connection | THR solder connection | THR solder connection | - |
| Electrical data | | | | | | |
| Rated voltage | 250 V | 60 V | 30 V | 30 V | 30 V | - |
| Rated current | 4 A | 4 A | 2 A | 1.5 A | 1.5 A | - |
| Volume resistance | ≤ 3 mΩ | ≤ 3 mΩ | ≤ 3 mΩ | ≤ 3 mΩ | ≤ 3 mΩ | - |
| Material data | | | | | | |
| Material contact / contact surface | CuZn / Au | CuZn / Au | CuZn / Au | CuZn / Au | CuZn / Au | - / - |
| Contact carrier material | PPA | PPA | PPA | PPA | PPA | - |
| Inflammability class according to UL 94 | V0 | V0 | V0 | V0 | V0 | - |
| Temperature data | | | | | | |
| Plug / socket | [°C] | -25 ... 85 | -25 ... 85 | -25 ... 85 | -25 ... 85 | - |

| | Coding | Ordering data | | | Ordering data | | |
|--|--------------|---------------|-------------|-----------|---------------|-----------|-------------|
| | | Order No. | Pcs. / Pkt. | Order No. | Pcs. / Pkt. | Order No. | Pcs. / Pkt. |
| Contact carrier, tray packaging | | | | | | | |
| Socket | A - standard | 1439955 | 60 | 1432363 | 60 | 1551422 | 60 |
| Plug | A - standard | 1439939 | 60 | 1432350 | 60 | 1557581 | 60 |
| Socket | D - data | 1551451 | 60 | | | | |
| Plug | D - data | 1552214 | 60 | | | | |
| Socket | B - inverse | | | 1551435 | 60 | | |
| Plug | B - inverse | | | 1552230 | 60 | | |
| Contact carrier, tape-on-reel packing with assembly pad | | | | | | | |
| Socket | A - standard | 1457623 | 100 | 1457652 | 100 | 1457681 | 100 |
| Plug | A - standard | 1457500 | 100 | 1457539 | 100 | 1457568 | 100 |
| Socket | D - data | 1457636 | 100 | | | | |
| Plug | D - data | 1457513 | 100 | | | | |
| Socket | B - inverse | | | 1457665 | 100 | | |
| Plug | B - inverse | | | 1457542 | 100 | | |

| | Accessories | Accessories |
|---|----------------------|----------------------|
| Housing screw connections, SPEEDCON screw versions and press-in versions, for all two-piece THR and wave soldering contact carriers | See page 258 onwards | See page 258 onwards |

M5 to M12 circular plug-in connectors

M12 sensor/actuator device plug-in connectors, rear mounting

Housing screw connections, screw versions

– For two-piece M12 device plug-in connectors



With O-ring



With flat gasket



| |
|---------------------------------|
| Material data |
| Material |
| Temperature data |
| Ambient temperature (operation) |

| Technical data | | |
|------------------|-------------------------------|--|
| Material | Zinc die-cast (nickel-plated) | |
| Temperature data | -25 °C ... 85 °C | |

| Technical data | | |
|------------------|-------------------------------|--|
| Material | Zinc die-cast (nickel-plated) | |
| Temperature data | -25 °C ... 85 °C | |

| |
|---|
| Description |
| Housing screw connections, SPEEDCON screw versions for all two-piece THR and wave soldering contact carriers |
| Socket |
| Plug |

| Ordering data | | |
|-------------------|-----------|-------------|
| Type | Order No. | Pcs. / Pkt. |
| SACC-M12-SCO NUT | 1552243 | 60 |
| SACC-M12-SCO PLUG | 1551493 | 60 |

| Ordering data | | |
|------------------------|-----------|-------------|
| Type | Order No. | Pcs. / Pkt. |
| SACC-M12-SCO NUT L 90 | 1432460 | 10 |
| SACC-M12-SCO PLUG L 90 | 1436709 | 10 |



Socket housing screw connection, with O-ring

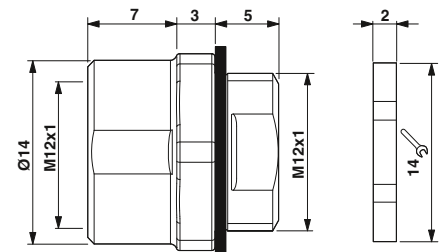

Socket housing screw connection, with flat gasket

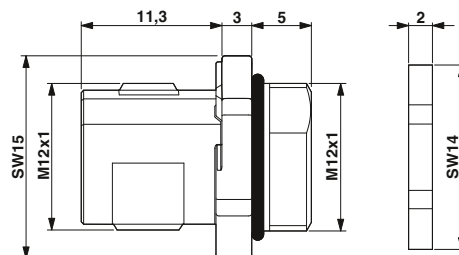

Pin housing screw connection, with O-ring



Pin housing screw connection, with flat gasket

Housing screw connections, press-in versions

– For two-piece M12 device plug-in connectors



M12 socket



M12 pin



Technical data

| | |
|---------------------------------|----------------------|
| Material data | |
| Material | CuZn (nickel-plated) |
| Temperature data | |
| Ambient temperature (operation) | -25 °C ... 85 °C |

Ordering data

| | |
|---|--|
| Description | |
| Housing screw connection , for all two-piece THR and wave soldering contact carriers | |
| Socket | |
| Plug | |

| Type | Order No. | Pcs. / Pkt. |
|--------------------|-----------|-------------|
| SACC-M12 NUT PRESS | 1437889 | 10 |



Technical data

| | |
|---------------------------------|----------------------|
| Material data | |
| Material | CuZn (nickel-plated) |
| Temperature data | |
| Ambient temperature (operation) | -25 °C ... 85 °C |

Ordering data

| Type | Order No. | Pcs. / Pkt. |
|---------------------|-----------|-------------|
| SACC-M12 PLUG PRESS | 1437892 | 10 |

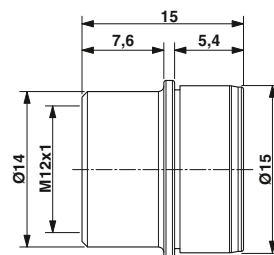

Socket housing screw connection

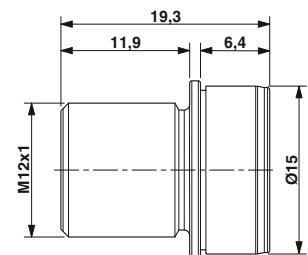

Pin housing screw connection

M5 to M12 circular plug-in connectors

M12 sensor/actuator device plug-in connectors, rear mounting

M12 flush-type plug-in connector, solder connection



CAT6_A, X-coded



Ethernet



CAT5/CAT5e



| Technical data | | | | Technical data | | | |
|--|---------------------------------------|----------------|-------------|---|---|---------------------------|--|
| SACC-DSI-...-L180-10G SCO | | | | SACC-DSI-...4CON-L180/... | | SACC-DSI-...8CON-L180/... | |
| Electrical data | | | | 250 V | 30 V | | |
| Nominal voltage U _N | 48 V | | | 4 A | 2 A | | |
| Rated current | 0.5 A | | | CAT5 (IEC 11801:2002), CAT5e (TIA 568B:2001) | CAT5 (IEC 11801:2002), CAT5e (TIA 568B:2001) | | |
| Transmission characteristics (category) | CAT6 _A | | | CuZn | CuZn | | |
| Contact material | CuZn | | | Zinc die-cast, nickel-plated | Zinc die-cast, nickel-plated | | |
| Material of grip body | Zinc die-cast, nickel-plated | | | V0 | V0 | | |
| Inflammability class according to UL 94 | V0 | | | 4 | 8 | | |
| No. of pos. | 8 | | | ≥ 100 | ≥ 100 | | |
| Insertion/withdrawal cycles | ≥ 100 | | | | | | |
| Temperature data | | | | | | | |
| Plug / socket | [°C] | -40 ... 85 | | -25 ... 85 | | -25 ... 85 | |
| Ordering data | | | | Ordering data | | | |
| Description | Type | Order No. | Pcs. / Pkt. | Type | Order No. | Pcs. / Pkt. | |
| Flush-type plug-in connector, CAT6_A, Ethernet, 8-pos., M12 SPEEDCON, rear/screw mounting with Pg9 thread, with straight solder connection Socket | SACC-DSIV-FS-8CON-L180-10G SCO | 1440669 | 20 | | | | |
| Contact carrier, CAT6_A, Ethernet, 8-pos., rear mounting, with straight solder connection Socket | SACC-CI-M12FS-8CON-L180-10G | 1402457 | 20 | | | | |
| Housing screw connections, SPEEDCON screw versions and press-in versions, for all two-piece THR and wave soldering contact carriers Socket | SACC-M12-SCO NUT L 90 | 1432460 | 10 | | | | |
| Flush-type plug-in connector, Ethernet, 4-pos., M12 SPEEDCON, with shield contact, D-coded, rear/screw mounting with M16 thread, with straight solder connection Socket | | | | SACC-DSI-FSD-4CON-L180/SH TQ | 1456527 | 20 | |
| Plug | | | | SACC-DSI-MSD-4CON-L180/SH TQ | 1456514 | 20 | |
| Flush-type plug-in connector, Ethernet, 8-pos., M12 SPEEDCON, with shield contact, rear/screw mounting with M16 thread, with polarity protection, with straight solder connection Socket | | | | SACC-DSI-FS-8CON-L180/SH TQ | 1456543 | 20 | |
| Plug | | | | SACC-DSI-MS-8CON-L180/SH TQ | 1456530 | 20 | |
| Flush-type plug-in connector, PROFINET, 4-pos., M12 SPEEDCON, with shield contact, D-coded, rear/screw mounting with M16 thread, with straight solder connection Socket | | | | SACC-DSI-FSD-4CON-L180/SH GN | 1456569 | 20 | |
| Plug | | | | SACC-DSI-MSD-4CON-L180/SH GN | 1456556 | 20 | |
| Flush-type plug-in connector, Ethernet, 4-pos., M12 SPEEDCON, with shield contact, D-coded, rear/screw mounting with M12 thread, with angled solder connection Socket | | | | SACC-DSIV-FSD-4CON-L90 SCO | 1436550 | 10 | |
| Plug | | | | SACC-DSIV-FSD-4CON-L180 SCO | 1542619 | 10 | |
| Flush-type plug-in connector, Ethernet, 8-pos., M12 SPEEDCON, with shield contact, A-coded, rear/screw mounting with M12 thread, with straight THR solder connection Socket | | | | SACC-DSIV-FS-8CON-L180-THR SH | 1557549 | 60 | |
| Plug | | | | SACC-DSIV-FSD-4CON-L180 SCOTHR | 1542648 | 60 | |

M12 flush-type plug-in connector, solder connection



CAT6_A, X-coded

Ethernet



CAT5e, Y-coded

| | Technical data | | | Technical data | | |
|--|--------------------------------|-----------|-------------|--|-----------|-------------|
| Electrical data | SACC-DSI-FSX-8CON... | | | VS-08-DSIV-L180-HYB SCO | | |
| Nominal voltage U _N | 48 V | | | 30 V (Data) | | |
| Rated current | 0.5 A | | | 0.5 A (Data) / 6 A (Power) | | |
| Transmission characteristics (category) | CAT6 _A | | | CAT5 (IEC 11801:2002), CAT5e (TIA 568B:2001) | | |
| Contact material | CuZn | | | CuZn | | |
| Material of grip body | Zinc die-cast, nickel-plated | | | Zinc die-cast, nickel-plated | | |
| Inflammability class according to UL 94 | V0 | | | V0 | | |
| No. of pos. | 8 | | | 8 | | |
| Insertion/withdrawal cycles | ≥ 100 | | | ≥ 100 | | |
| Temperature data | | | | | | |
| Plug / socket | [-40 ... 85] [°C] | | | -40 ... 85 | | |
| | Ordering data | | | Ordering data | | |
| Description | Type | Order No. | Pcs. / Pkt. | Type | Order No. | Pcs. / Pkt. |
| Flush-type socket , CAT6 _A , Ethernet, one-piece, 8-pos., M12 SPEEDCON, with straight solder connection, rear/screw mounting with: M16 fastening thread Pg9 fastening thread | SACC-DSI-FSX-8CON-M16-L180 SCO | 1424177 | 20 | VS-08-DSIV-L180-HYB SCO | 1456666 | 20 |
| | SACC-DSI-FSX-8CON-PG9-L180 SCO | 1404741 | 20 | | | |
| Hybrid flush-type plug-in connector for the reflow soldering process , with straight solder connection, 4 x power contacts, 4 x signal contacts, rear mounting, SPEEDCON | | | | | | |
| Socket | | | | | | |
| Hybrid flush-type plug-in connector for the wave soldering process , with straight solder connection, 4 x power contacts, 4 x signal contacts, rear mounting, SPEEDCON | | | | | | |
| Socket | | | | | | |
| Contact carrier, two-piece , CAT6 _A , Ethernet, 8-pos., rear mounting, with angled solder connection | SACC-CI-M12FSX-8CON-L90 | 1424180 | 20 | SACC-DSI-FSY-8CON-M16-L180 SCO | 1407503 | 20 |
| Hybrid contact carrier, two-piece , Ethernet, 8-pos., rear/screw mounting, with angled solder connection | | | | | | |
| | | | | SACC-CI-M12FSY-8CON-L90 | 1424193 | 20 |
| | Accessories | | | Accessories | | |
| Housing screw connection , SPEEDCON, for all two-piece THR and wave soldering contact carriers | See page 258 onwards | | | See page 258 onwards | | |

M5 to M12 circular plug-in connectors

M12 sensor/actuator device plug-in connectors, rear mounting

M12, two-piece,
for wave soldering processes

Ethernet



Straight, 4, 5, 8-pos.



Straight, shielded, 5-pos.



| | Technical data | | | Technical data | | |
|--|-----------------|-----------------|-----------------|-----------------|-------|-------|
| | 4-pos. | 5-pos. | 8-pos. | 5-pos. | | |
| General data | | | | | | |
| M12 circular plug-in connector according to: | IEC 61076-2-101 | IEC 61076-2-101 | IEC 61076-2-101 | IEC 61076-2-101 | - | - |
| Pollution degree | 3 | 3 | 3 | 3 | - | - |
| Degree of protection | IP67 | IP67 | IP67 | IP67 | - | - |
| Connection method | Solder pins | Solder pins | Solder pins | Solder pins | - | - |
| Electrical data | | | | | | |
| Rated voltage | 250 V | 60 V | 30 V | 60 V | - | - |
| Rated current | 4 A | 4 A | 2 A | 4 A | - | - |
| Volume resistance | ≤ 3 mΩ | ≤ 3 mΩ | ≤ 3 mΩ | ≤ 3 mΩ | - | - |
| Material data | | | | | | |
| Material contact / contact surface | CuZn / Au | CuZn / Au | CuZn / Au | CuZn / Au | - / - | - / - |
| Contact carrier material | PA 66 | PA 66 | PA 66 | PA 66 | - | - |
| Inflammability class according to UL 94 | HB | HB | HB | HB | - | - |
| Temperature data | | | | | | |
| Plug / socket [°C] | -25 ... 85 | -25 ... 85 | -25 ... 85 | -25 ... 85 | - | - |

| Description | Coding | Ordering data | | | Ordering data | | |
|---|--------------|---------------|-------------|-----------|---------------|-----------|-------------|
| | | Order No. | Pcs. / Pkt. | Order No. | Pcs. / Pkt. | Order No. | Pcs. / Pkt. |
| Flush-type plug-in connector, straight | | | | | | | |
| Socket | A - standard | | | 1694237 | 10 | 1556854 | 10 |
| Plug | A - standard | | | 1694211 | 10 | 1437193 | 10 |
| Socket | D - data | 1534627 | 10 | | | | |
| Socket | B - inverse | | | 1515934 | 10 | 1437180 | 10 |
| Plug | B - inverse | | | 1514883 | 10 | 1437203 | 10 |



M12 flush-type socket, straight,

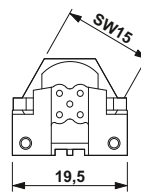

M12 flush-type plug, straight,

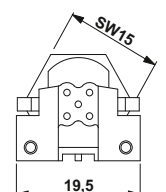

Pg9 fastening thread, plastic



Solder connection, 5, 8-pos.



With 0.5 m long litz wires, 5, 8-pos.



Technical data

| | 5-pos. | | 8-pos. | |
|---|--|---|--|---|
| | IEC 61076-2-101 | 3 | IEC 61076-2-101 | 3 |
| General data | M12 circular plug-in connector according to: | | M12 circular plug-in connector according to: | |
| Pollution degree | 3 | | 3 | |
| Degree of protection | IP67 | | IP67 | |
| Electrical data | 60 V | | 30 V | |
| Rated voltage | 4 A | | 2 A | |
| Rated current | ≤ 3 mΩ | | ≤ 3 mΩ | |
| Volume resistance | CuZn / Au | | CuZn / Au | |
| Material data | PA 66 | | PA 66 | |
| Material contact / contact surface | HB | | HB | |
| Contact carrier material | -25 ... 85 | | -25 ... 85 | |
| Inflammability class according to UL 94 | - | | - | |
| Temperature data | [°C] | | [°C] | |
| Plug / socket | - | | - | |
| Cable, fixed installation | - | | - | |



Technical data

| | 5-pos. | | 8-pos. | |
|---|--|---|--|---|
| | IEC 61076-2-101 | 3 | IEC 61076-2-101 | 3 |
| General data | M12 circular plug-in connector according to: | | M12 circular plug-in connector according to: | |
| Pollution degree | 3 | | 3 | |
| Degree of protection | IP67 | | IP67 | |
| Electrical data | 60 V | | 30 V | |
| Rated voltage | 4 A | | 2 A | |
| Rated current | ≤ 3 mΩ | | ≤ 3 mΩ | |
| Volume resistance | CuZn / Au | | CuZn / Au | |
| Material data | PA 66 | | PA 66 | |
| Material contact / contact surface | HB | | HB | |
| Contact carrier material | -25 ... 85 | | -25 ... 85 | |
| Inflammability class according to UL 94 | - | | - | |
| Temperature data | [°C] | | [°C] | |
| Plug / socket | - | | - | |
| Cable, fixed installation | - | | - | |

Ordering data

| Description | Coding | 5-pos. | | 8-pos. | |
|---|--------------|-----------|-------------|-----------|-------------|
| | | Order No. | Pcs. / Pkt. | Order No. | Pcs. / Pkt. |
| Flush-type plug-in connector, with solder pins | | | | | |
| Socket | A - standard | 1436330 | 20 | 1436343 | 20 |
| Flush-type plug-in connector, with solder cups | | | | | |
| Socket | A - standard | 1436314 | 20 | 1436327 | 20 |
| Flush-type plug-in connector, with litz wires | | | | | |
| Socket | A - standard | | | | |

Ordering data

| Description | Coding | 5-pos. | | 8-pos. | |
|--|--------------|-----------|-------------|-----------|-------------|
| | | Order No. | Pcs. / Pkt. | Order No. | Pcs. / Pkt. |
| Flush-type plug-in connector, with litz wires | | | | | |
| Socket | A - standard | 1436356 | 1 | 1436369 | 1 |

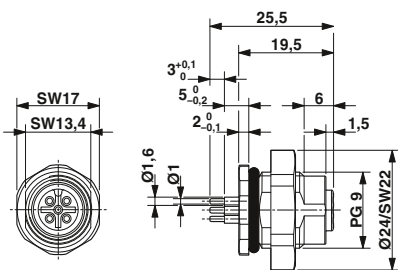

M12, Pg9 fastening thread, solder pins

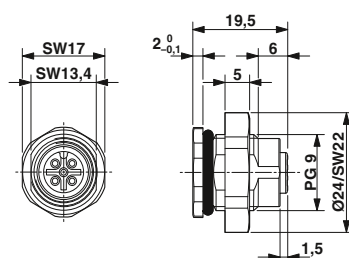

M12 socket, Pg9 fastening thread, solder cups

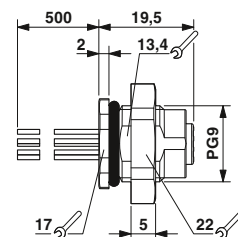

M12 socket, Pg9 fastening thread, with litz wires

M5 to M12 circular plug-in connectors

M12 sensor/actuator device plug-in connectors, rear mounting

Control cabinet feed-through



4, 5, 8-pos.

| | | Technical data | | | | | |
|---|--------------|-----------------|-----------------|-----------------|-------------|-----------|-------------|
| | | 4-pos. | 5-pos. | 8-pos. | | | |
| General data | | | | | | | |
| M12 circular plug-in connector according to: | | IEC 61076-2-101 | IEC 61076-2-101 | IEC 61076-2-101 | | | |
| Pollution degree | | 3 | 3 | 3 | | | |
| Degree of protection | | IP67 | IP67 | IP67 | | | |
| Electrical data | | | | | | | |
| Rated voltage | | 60 V | 24 V | 24 V | | | |
| Rated current | | 4 A | 4 A | 1.5 A | | | |
| Volume resistance | | ≤ 3 mΩ | ≤ 3 mΩ | ≤ 3 mΩ | | | |
| Material data | | | | | | | |
| Contact material | | CuZn | CuZn | CuZn | | | |
| Contact surface material | | Au | Au | Au | | | |
| Contact carrier material | | PA 66 | PA 66 | PA 66 | | | |
| Inflammability class according to UL 94 | | HB | HB | HB | | | |
| Temperature data | | | | | | | |
| Plug / socket [°C] | | -25 ... 85 | -25 ... 85 | -25 ... 85 | | | |
| | | Ordering data | | | | | |
| Description | Coding | Order No. | Pcs. / Pkt. | Order No. | Pcs. / Pkt. | Order No. | Pcs. / Pkt. |
| Control cabinet feed-through, M16 fastening thread | | | | | | | |
| Plug on socket | A - standard | | | 1551671 | 1 | 1551697 | 1 |
| Plug on socket | B - inverse | | | 1551684 | 1 | | |
| Socket to socket | D - data | 1424326 | 1 | | | | |

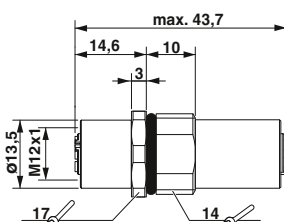

Control cabinet feed-through, socket to socket on both sides

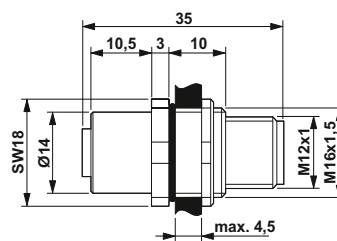

Control cabinet feed-through, socket to pin on both sides

Front mounting,
Pg13.5 fastening thread,
with 0.5 m long litz wires

Notes:

Flat nut recommended for housing wall thicknesses < 2.5 mm.



3, 4-pos.



5-pos.



| | Technical data | |
|---|------------------|------------------|
| | 3-pos. | 4-pos. |
| General data | | |
| Pollution degree | 3 | 3 |
| Degree of protection | IP67 | IP67 |
| Connection method | Individual wires | Individual wires |
| Electrical data | | |
| Rated voltage | 250 V | 250 V |
| Rated current | 12 A | 9 A |
| Volume resistance | ≤ 5 mΩ | ≤ 5 mΩ |
| Surge voltage category | II | II |
| Material data | | |
| Material contact / contact surface | CuZn / Au | CuZn / Au |
| Contact carrier material | PUR | PUR |
| Inflammability class according to UL 94 | HB | HB |
| Cable type | PVC litz wire | PVC litz wire |
| Temperature data | | |
| Plug / socket | [°C] -40 ... 85 | [°C] -40 ... 85 |
| Cable, fixed installation | [°C] -40 ... 85 | [°C] -40 ... 85 |



| | Technical data | |
|---|------------------|-------|
| | 5-pos. | |
| General data | | |
| Pollution degree | 3 | - |
| Degree of protection | IP67 | - |
| Connection method | Individual wires | - |
| Electrical data | | |
| Rated voltage | 250 V | - |
| Rated current | 9 A | - |
| Volume resistance | ≤ 5 mΩ | - |
| Surge voltage category | II | - |
| Material data | | |
| Material contact / contact surface | CuZn / Au | - / - |
| Contact carrier material | PUR | - |
| Inflammability class according to UL 94 | HB | - |
| Cable type | PVC litz wire | - |
| Temperature data | | |
| Plug / socket | [°C] -40 ... 85 | - |
| Cable, fixed installation | [°C] -40 ... 85 | - |

| Description | Coding | Ordering data | | | |
|----------------------------------|--------------|---------------|-------------|-----------|-------------|
| | | 3-pos. | | 4-pos. | |
| | | Order No. | Pcs. / Pkt. | Order No. | Pcs. / Pkt. |
| Device plug-in connectors | | | | | |
| Socket | A - standard | 1521407 | 1 | 1521423 | 1 |
| Plug | A - standard | 1521410 | 1 | 1521436 | 1 |

| Description | Coding | Ordering data | | | |
|----------------------------------|--------------|---------------|-------------|-----------|-------------|
| | | 5-pos. | | Order No. | Pcs. / Pkt. |
| | | Order No. | Pcs. / Pkt. | Order No. | Pcs. / Pkt. |
| Device plug-in connectors | | | | | |
| Socket | A - standard | 1521449 | 1 | | |
| Plug | A - standard | 1521452 | 1 | | |

| Accessories | | |
|----------------------------------|------------------|-------------|
| Flat nut, with: Pg13.5 thread | SACC-E-MU-PG13,5 | 1539143 100 |

| Accessories | | |
|----------------------------------|------------------|-------------|
| Flat nut, with: Pg13.5 thread | SACC-E-MU-PG13,5 | 1539143 100 |



7/8" flush-type socket

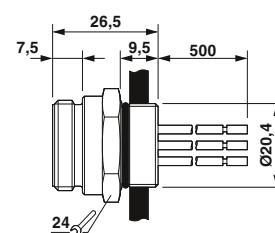

7/8" flush-type plug

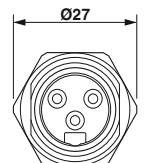

M5 to M12 circular plug-in connectors

7/8" sensor/actuator device plug-in connectors, rear mounting

7/8", with 1.0 m long litz wires



3, 4, 5-pos.



3, 4, 5-pos.



| | Technical data | | | Technical data | | |
|---|------------------|------------------|------------------|------------------|------------------|------------------|
| | 3-pos. | 4-pos. | 5-pos. | 3-pos. | 4-pos. | 5-pos. |
| General data | | | | | | |
| Pollution degree | 3 | 3 | 3 | 3 | 3 | 3 |
| Degree of protection | IP67 | IP67 | IP67 | IP67 | IP67 | IP67 |
| Connection method | Individual wires | Individual wires | Individual wires | Individual wires | Individual wires | Individual wires |
| Electrical data | | | | | | |
| Rated voltage | 250 V | 250 V | 250 V | 250 V | 250 V | 250 V |
| Rated current | 12 A | 9 A | 9 A | 12 A | 9 A | 9 A |
| Volume resistance | ≤ 5 mΩ | ≤ 5 mΩ | ≤ 5 mΩ | ≤ 5 mΩ | ≤ 5 mΩ | ≤ 5 mΩ |
| Surge voltage category | II | II | II | II | II | II |
| Material data | | | | | | |
| Contact material | CuZn | CuZn | CuZn | CuZn | CuZn | CuZn |
| Contact surface material | Au | Au | Au | Au | Au | Au |
| Contact carrier material | PUR | PUR | PUR | PUR | PUR | PUR |
| Inflammability class according to UL 94 | HB | HB | HB | HB | HB | HB |
| Temperature data | | | | | | |
| Plug / socket | [°C] | -40 ... 85 | -40 ... 85 | -40 ... 85 | -40 ... 85 | -40 ... 85 |
| Cable, fixed installation | [°C] | -40 ... 85 | -40 ... 85 | -40 ... 85 | -40 ... 85 | -40 ... 85 |
| | Ordering data | | | Ordering data | | |
| Description | Order No. | Pcs. / Pkt. | Order No. | Pcs. / Pkt. | Order No. | Pcs. / Pkt. |
| | 3-pos. | | 4-pos. | | 5-pos. | |
| Flush-type plug-in connector, M26 fastening thread | | | | | | |
| Socket | 1453782 | 1 | 1453795 | 1 | 1453805 | 1 |
| Flush-type plug-in connector, 7/8" fastening thread | | | | | | |
| Plug | 1453753 | 1 | 1453766 | 1 | 1453799 | 1 |

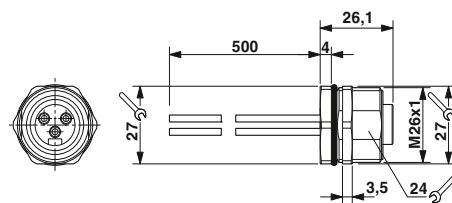

7/8" flush-type socket



7/8" flush-type plug

M5 to M12 circular plug-in connectors

7/8" sensor/actuator device plug-in connectors, rear mounting

7/8" rear mounting,
for wave soldering processes



3, 4, 5-pos.



3, 4, 5-pos.



Technical data

| | Technical data | | | Technical data | | |
|---|----------------|-------------|-------------|----------------|-------------|-------------|
| | 3-pos. | 4-pos. | 5-pos. | 3-pos. | 4-pos. | 5-pos. |
| General data | | | | | | |
| Pollution degree | 3 | 3 | 3 | 3 | 3 | 3 |
| Degree of protection | IP67 | IP67 | IP67 | IP67 | IP67 | IP67 |
| Connection method | Solder pins | Solder pins | Solder pins | Solder pins | Solder pins | Solder pins |
| Electrical data | | | | | | |
| Rated voltage | 250 V | 250 V | 250 V | 250 V | 250 V | 250 V |
| Rated current | 12 A | 9 A | 9 A | 12 A | 9 A | 9 A |
| Volume resistance | ≤ 5 mΩ | ≤ 5 mΩ | ≤ 5 mΩ | ≤ 5 mΩ | ≤ 5 mΩ | ≤ 5 mΩ |
| Surge voltage category | II | II | II | II | II | II |
| Material data | | | | | | |
| Contact material | CuZn | CuZn | CuZn | CuZn | CuZn | CuZn |
| Contact surface material | Au | Au | Au | Au | Au | Au |
| Contact carrier material | PUR | PUR | PUR | PUR | PUR | PUR |
| Inflammability class according to UL 94 | HB | HB | HB | HB | HB | HB |
| Temperature data | | | | | | |
| Plug / socket | [°C] | | | | | |
| | -40 ... 85 | -40 ... 85 | -40 ... 85 | -40 ... 85 | -40 ... 85 | -40 ... 85 |



Technical data

| Description | Coding | Ordering data | | | | | | Ordering data | | | | | | | | |
|---|--------------|---------------|-------------|-----------|-------------|-----------|-------------|---------------|-------------|-----------|-------------|-----------|-------------|--|--|--|
| | | 3-pos. | | 4-pos. | | 5-pos. | | 3-pos. | | 4-pos. | | 5-pos. | | | | |
| | | Order No. | Pcs. / Pkt. | Order No. | Pcs. / Pkt. | Order No. | Pcs. / Pkt. | Order No. | Pcs. / Pkt. | Order No. | Pcs. / Pkt. | Order No. | Pcs. / Pkt. | | | |
| Flush-type plug-in connector, M26 fastening thread | | | | | | | | | | | | | | | | |
| Socket | A - standard | 1457830 | 1 | 1457843 | 1 | 1457775 | 1 | | | | | | | | | |
| Flush-type plug-in connector, 7/8" fastening thread | | | | | | | | | | | | | | | | |
| Plug | A - standard | | | | | | | 1455007 | 1 | 1455010 | 1 | 1457487 | 1 | | | |



M5 to M12 circular plug-in connectors

M12 sensor/actuator device plug-in connectors, stainless steel versions

Front mounting,
Pg9/M16 fastening thread,
with 0.5 m long litz wires

– Housing material, stainless steel 1.4404



4, 5, 8-pos.



Can be positioned, 4, 5, 8-pos.



| | Technical data | | | Technical data | | | |
|--|--|------------------|------------------|--|------------------|------------------|---|
| | 4-pos. | 5-pos. | 8-pos. | 4-pos. | 5-pos. | 8-pos. | |
| General data | M12 circular plug-in connector according to: | | | M12 circular plug-in connector according to: | | | |
| Pollution degree | 3 | 3 | 3 | 3 | 3 | 3 | |
| Degree of protection | IP67/IP69K | IP67/IP69K | IP67/IP69K | IP67/IP69K | IP67/IP69K | IP67/IP69K | |
| Connection method | Individual wires | Individual wires | Individual wires | Individual wires | Individual wires | Individual wires | |
| Electrical data | | | | | | | |
| Rated voltage | 250 V | 60 V | 30 V | 250 V | 60 V | 30 V | |
| Rated current | 4 A | 4 A | 2 A | 4 A | 4 A | 2 A | |
| Volume resistance | ≤ 3 mΩ | ≤ 3 mΩ | ≤ 3 mΩ | ≤ 3 mΩ | ≤ 3 mΩ | ≤ 3 mΩ | |
| Material data | | | | | | | |
| Material contact / contact surface | CuZn / Au | CuZn / Au | CuZn / Au | CuZn / Au | CuZn / Au | CuZn / Au | |
| Contact carrier material | PA66 GF | PA66 GF | PA66 GF | PA66 GF | PA66 GF | PA66 GF | |
| Inflammability class according to UL 94 | V0 | V0 | V0 | V0 | V0 | V0 | |
| Cable type | TPE litz wire | TPE litz wire | TPE litz wire | TPE litz wire | TPE litz wire | TPE litz wire | |
| Temperature data | | | | | | | |
| Plug / socket | -25 ... 85 | -25 ... 85 | -25 ... 85 | -25 ... 85 | -25 ... 85 | -25 ... 85 | |
| | Ordering data | | | Ordering data | | | |
| Description | Order No. | Pcs. / Pkt. | Order No. | Pcs. / Pkt. | Order No. | Pcs. / Pkt. | |
| | 4-pos. | | 5-pos. | | 8-pos. | | |
| Device plug-in connector, Pg9 fastening thread | | | | | | | |
| Socket | A - standard | 1555448 | 1 | 1699863 | 1 | 1554607 | 1 |
| Plug | A - standard | 1554555 | 1 | 1554568 | 1 | 1554571 | 1 |
| Device plug-in connector, M16 fastening thread | | | | | | | |
| Socket | A - standard | 1458855 | 1 | 1458871 | 1 | 1458842 | 1 |
| Plug | A - standard | 1405233 | 1 | 1458868 | 1 | 1405221 | 1 |

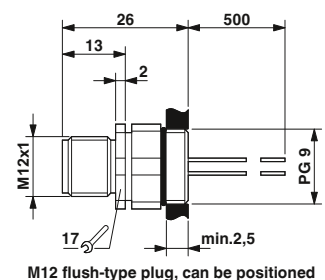
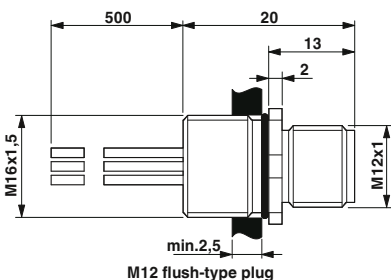

Front mounting,
M20 fastening thread,
with 0.5 m long litz wires

– Housing material, stainless steel 1.4404



4, 5, 8-pos.

Technical data

| | 4-pos. | 5-pos. | 8-pos. |
|--|------------------|------------------|------------------|
| General data | | | |
| M12 circular plug-in connector according to: | IEC 61076-2-101 | IEC 61076-2-101 | IEC 61076-2-101 |
| Pollution degree | 3 | 3 | 3 |
| Degree of protection | IP67/IP69K | IP67/IP69K | IP67/IP69K |
| Connection method | Individual wires | Individual wires | Individual wires |
| Electrical data | | | |
| Rated voltage | 250 V | 60 V | 30 V |
| Rated current | 4 A | 4 A | 2 A |
| Volume resistance | ≤ 3 mΩ | ≤ 3 mΩ | ≤ 3 mΩ |
| Material data | | | |
| Material contact / contact surface | CuZn / Au | CuZn / Au | CuZn / Au |
| Contact carrier material | PA 66 | PA 66 | PA 66 |
| Inflammability class according to UL 94 | V0 | V0 | V0 |
| Cable type | TPE litz wire | TPE litz wire | TPE litz wire |
| Temperature data | | | |
| Plug / socket | -25 ... 85 | -25 ... 85 | -25 ... 85 |

Ordering data

| Description | Coding | 4-pos. | | 5-pos. | | 8-pos. | |
|----------------------------------|--------------|-----------|-------------|-----------|-------------|-----------|-------------|
| | | Order No. | Pcs. / Pkt. | Order No. | Pcs. / Pkt. | Order No. | Pcs. / Pkt. |
| Device plug-in connectors | | | | | | | |
| Socket | A - standard | 1408416 | 1 | 1452071 | 1 | 1452110 | 1 |
| Plug | A - standard | 1408415 | 1 | 1452068 | 1 | 1452107 | 1 |
| Socket | B - inverse | | | 1452097 | 1 | | |
| Plug | B - inverse | | | 1452084 | 1 | | |

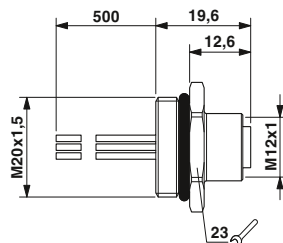

M12 flush-type socket

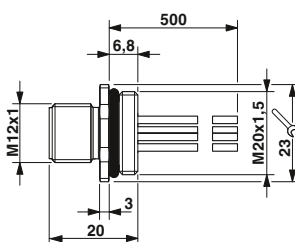

M12 flush-type plug

M5 to M12 circular plug-in connectors

M12 sensor/actuator device plug-in connectors, stainless steel versions

Device plug-in connector, rear mounting

– Housing material, stainless steel 1.4404



With 0.5 m long litz wires, 4, 5, 8-pos.



For wave soldering processes, 4, 5, 8-pos.



| | Technical data | | | | | | |
|--|-------------------|-----------|------------------|-----------|------------------|-----------|-------------|
| | 4-pos. | | 5-pos. | | 8-pos. | | |
| General data | | | | | | | |
| M12 circular plug-in connector according to: | IEC 61076-2-101 | | IEC 61076-2-101 | | IEC 61076-2-101 | | |
| Pollution degree | 3 | | 3 | | 3 | | |
| Degree of protection | IP67/IP69K | | IP67/IP69K | | IP67/IP69K | | |
| Connection method | Individual wires | | Individual wires | | Individual wires | | |
| Electrical data | | | | | | | |
| Rated voltage | 250 V | | 60 V | | 30 V | | |
| Rated current | 4 A | | 4 A | | 2 A | | |
| Volume resistance | ≤ 3 mΩ | | ≤ 3 mΩ | | ≤ 3 mΩ | | |
| Material data | | | | | | | |
| Material contact / contact surface | CuZn / Au | | CuZn / Au | | CuZn / Au | | |
| Contact carrier material | PA 66 | | PA 66 | | PA 66 | | |
| Inflammability class according to UL 94 | V0 | | V0 | | V0 | | |
| Cable type | TPE litz wire | | TPE litz wire | | TPE litz wire | | |
| Temperature data | | | | | | | |
| Plug / socket | [-25 ... 85] [°C] | | [-25 ... 85] | | [-25 ... 85] | | |
| | Ordering data | | | | | | |
| Description | Coding | Order No. | Pcs. / Pkt. | Order No. | Pcs. / Pkt. | Order No. | Pcs. / Pkt. |
| Device plug-in connectors | | 4-pos. | 5-pos. | 8-pos. | 4-pos. | 5-pos. | 8-pos. |
| Socket | A - standard | 1405240 | 1 | 1554717 | 1 | 1554720 | 1 |
| Plug | A - standard | 1405239 | 1 | 1554681 | 1 | 1554694 | 1 |
| | | 1404974 | 20 | 1554733 | 20 | 1529797 | 20 |
| | | 1404979 | 20 | 1554746 | 20 | 1529807 | 20 |



M12 flush-type socket



M12 flush-type socket



M12 flush-type plug



M12 flush-type plug

M5 to M12 circular plug-in connectors

Sensor/actuator plug-in connectors for assembly

M8, insulation displacement connection



0.08 mm² - 0.25 mm², 3, 4-pos.



0.25 mm² - 0.5 mm², 3, 4-pos.



Technical data

| | 3-pos. | 4-pos. |
|---|------------------------------------|--------|
| General data | | |
| M8 circular plug-in connector according to: | IEC 61076-2-104 | |
| Pollution degree | 3 | |
| Degree of protection | IP65/67 | |
| Connection method | Insulation displacement connection | |
| Cable diameter | 2.5 mm ... 5 mm ± 0.2 mm | |
| Electrical data | | |
| Rated voltage | 60 V | 30 V |
| Rated current | 4 A | |
| Volume resistance | ≤ 5 mΩ | |
| Insulation resistance | ≥ 100 MΩ | |
| Material data | | |
| Material contact / contact surface | CuSn / Ni/Au | |
| Contact carrier material | TPU GF | |
| Inflammability class according to UL 94 | HB | |
| Temperature data | | |
| Plug / socket | -25 ... 80 [°C] | |



Technical data

| | 3-pos. | 4-pos. |
|---|------------------------------------|--------|
| General data | | |
| M8 circular plug-in connector according to: | IEC 61076-2-104 | |
| Pollution degree | 3 | |
| Degree of protection | IP65/67 | |
| Connection method | Insulation displacement connection | |
| Cable diameter | 2.5 mm ... 5 mm ± 0.2 mm | |
| Electrical data | | |
| Rated voltage | 60 V | 30 V |
| Rated current | 4 A | |
| Volume resistance | ≤ 5 mΩ | |
| Insulation resistance | ≥ 100 MΩ | |
| Material data | | |
| Material contact / contact surface | CuSn / Ni/Au | |
| Contact carrier material | TPU GF | |
| Inflammability class according to UL 94 | HB | |
| Temperature data | | |
| Plug / socket | -25 ... 80 [°C] | |

Ordering data

| Description | 3-pos. | | 4-pos. | |
|--------------------------|-----------|-------------|-----------|-------------|
| | Order No. | Pcs. / Pkt. | Order No. | Pcs. / Pkt. |
| Plug-in connector | | | | |
| Socket, straight | 1441040 | 1 | 1441053 | 1 |
| Plug, straight | 1441008 | 1 | 1441011 | 1 |

Ordering data

| Description | 3-pos. | | 4-pos. | |
|--------------------------|-----------|-------------|-----------|-------------|
| | Order No. | Pcs. / Pkt. | Order No. | Pcs. / Pkt. |
| Plug-in connector | | | | |
| Socket, straight | 1441066 | 1 | 1441079 | 1 |
| Plug, straight | 1441024 | 1 | 1441037 | 1 |

M8, screw connections



Unshielded, 3, 4-pos.



Shielded, 3, 4-pos.



| | Technical data | |
|---|--|--------|
| | 3-pos. | 4-pos. |
| General data | | |
| M8 circular plug-in connector according to: | IEC 61076-2-104 | |
| Pollution degree | 3 | |
| Degree of protection | IP67 | |
| Connection method | Screw connection | |
| Cable diameter | 3.5 mm ... 5 mm | |
| Connection cross section [mm ²] | 0.14 mm ² ... 0.5 mm ² | |
| Electrical data | | |
| Rated voltage | 60 V | 30 V |
| Rated current | 4 A | |
| Volume resistance | ≤ 3 mΩ | |
| Insulation resistance | ≥ 100 MΩ | |
| Material data | | |
| Material contact / contact surface | CuZn / Au | |
| Contact carrier material | PA | |
| Inflammability class according to UL 94 | HB | |
| Temperature data | | |
| Plug / socket | -40 ... 85 | |



| | Technical data | |
|---|--|--------|
| | 3-pos. | 4-pos. |
| General data | | |
| M8 circular plug-in connector according to: | IEC 61076-2-104 | |
| Pollution degree | 3 | |
| Degree of protection | IP67 | |
| Connection method | Screw connection | |
| Cable diameter | 3.5 mm ... 5 mm | |
| Connection cross section [mm ²] | 0.14 mm ² ... 0.5 mm ² | |
| Electrical data | | |
| Rated voltage | 60 V | 30 V |
| Rated current | 4 A | |
| Volume resistance | ≤ 3 mΩ | |
| Insulation resistance | ≥ 100 MΩ | |
| Material data | | |
| Material contact / contact surface | CuSn / Au | |
| Contact carrier material | PUR / PA66 | |
| Inflammability class according to UL 94 | HB | |
| Temperature data | | |
| Plug / socket | -40 ... 85 | |

| Description | Ordering data | | | |
|--------------------------|---------------|-------------|-----------|-------------|
| | Order No. | Pcs. / Pkt. | Order No. | Pcs. / Pkt. |
| | 3-pos. | | 4-pos. | |
| Plug-in connector | | | | |
| Socket, straight | 1506888 | 1 | 1506891 | 1 |
| Plug, straight | 1501252 | 1 | 1501265 | 1 |
| Socket, angled | 1407582 | 1 | 1407584 | 1 |
| Plug, angled | 1407583 | 1 | 1407585 | 1 |

| Description | Ordering data | | | |
|--------------------------|---------------|-------------|-----------|-------------|
| | Order No. | Pcs. / Pkt. | Order No. | Pcs. / Pkt. |
| | 3-pos. | | 4-pos. | |
| Plug-in connector | | | | |
| Socket, straight | 1542907 | 1 | 1542910 | 1 |
| Plug, straight | 1542884 | 1 | 1542897 | 1 |

| Pressure screw and seal, for cable diameters: | Accessories | | |
|---|----------------------|-------------|-----------|
| | Order No. | Pcs. / Pkt. | Order No. |
| 2.5 mm ... 3.5 mm | SACC-M 8-SET/2,2-3,5 | 1436945 | 5 |

| Pressure screw and seal, for cable diameters: | Accessories | | |
|---|-------------|-------------|-----------|
| | Order No. | Pcs. / Pkt. | Order No. |
| 2.5 mm ... 3.5 mm | | | |

M5 to M12 circular plug-in connectors

Sensor/actuator plug-in connectors for assembly

M8, solder connection



Unshielded, 3, 4-pos.



Shielded, 3, 4-pos.



Technical data

| | 3-pos. | 4-pos. |
|---|---|--------|
| General data | | |
| M8 circular plug-in connector according to: | IEC 61076-2-104 | |
| Pollution degree | 3 | |
| Degree of protection | IP67 | |
| Connection method | Solder connection | |
| Cable diameter | 3.5 mm ... 5 mm | |
| Connection cross section [mm ²] | 0.08 mm ² ... 0.25 mm ² | |
| Electrical data | | |
| Rated voltage | 60 V | 30 V |
| Rated current | 4 A | |
| Volume resistance | ≤ 3 mΩ | |
| Insulation resistance | ≥ 100 MΩ | |
| Material data | | |
| Material contact / contact surface | CuSn / Au | |
| Contact carrier material | PUR / PA66 | |
| Inflammability class according to UL 94 | V0 | |
| Temperature data | | |
| Plug / socket | -40 ... 85 | |



Technical data

| | 3-pos. | 4-pos. |
|---|---|--------|
| General data | | |
| M8 circular plug-in connector according to: | IEC 61076-2-104 | |
| Pollution degree | 3 | |
| Degree of protection | IP67 | |
| Connection method | Solder connection | |
| Cable diameter | 3.5 mm ... 5 mm | |
| Connection cross section [mm ²] | 0.08 mm ² ... 0.25 mm ² | |
| Electrical data | | |
| Rated voltage | 60 V | 30 V |
| Rated current | 4 A | |
| Volume resistance | ≤ 3 mΩ | |
| Insulation resistance | ≥ 100 MΩ | |
| Material data | | |
| Material contact / contact surface | CuSn / Au | |
| Contact carrier material | PUR / PA66 | |
| Inflammability class according to UL 94 | HB | |
| Temperature data | | |
| Plug / socket | -40 ... 85 | |

Ordering data

| Description | Order No. | Pcs. / Pkt. | Order No. | Pcs. / Pkt. |
|--------------------------|-----------|-------------|-----------|-------------|
| | 3-pos. | | 4-pos. | |
| Plug-in connector | | | | |
| Socket, angled | 1529399 | 1 | 1513444 | 1 |
| Plug, angled | 1699902 | 1 | 1554209 | 1 |
| Socket, straight | 1681172 | 1 | 1681185 | 1 |
| Plug, straight | 1681156 | 1 | 1681169 | 1 |

Ordering data

| Description | Order No. | Pcs. / Pkt. | Order No. | Pcs. / Pkt. |
|--------------------------|-----------|-------------|-----------|-------------|
| | 3-pos. | | 4-pos. | |
| Plug-in connector | | | | |
| Socket, angled | 1436479 | 1 | 1436482 | 1 |
| Plug, angled | 1436453 | 1 | 1436466 | 1 |
| Socket, straight | 1506927 | 1 | 1506930 | 1 |
| Plug, straight | 1506901 | 1 | 1506914 | 1 |

Accessories

| Pressure screw and seal, for cable diameters: | Order No. | Pcs. / Pkt. |
|---|----------------------|-------------|
| 2.5 mm ... 3.5 mm | SACC-M 8-SET/2,2-3,5 | 1436945 5 |

Accessories

| Pressure screw and seal, for cable diameters: | Order No. | Pcs. / Pkt. |
|---|-----------|-------------|
| 2.5 mm ... 3.5 mm | | |

M5 to M12 circular plug-in connectors

Sensor/actuator plug-in connectors for assembly

M12, solder and Piercecon® connection



Solder connection, 12-pos.



Piercecon® connection, 12, 17-pos.



| | Technical data | | Technical data | | | | | | |
|--|-------------------|-----------|----------------------------|-----------|---------------|-----------|-------------|-----------|-------------|
| | Unshielded | Shielded | 12-pos. | | 17-pos. | | | | |
| General data | | | | | | | | | |
| M12 circular plug-in connector according to: | IEC 61076-2-101 | | IEC 61076-2-101 | | | | | | |
| Pollution degree | 3 | | 3 | | | | | | |
| Degree of protection | IP67 | | IP67 | | | | | | |
| Connection method | Solder connection | | Piercecon® fast connection | | | | | | |
| Cable diameter | 6 mm ... 8 mm | | 5.4 mm ... 8.2 mm | | | | | | |
| Electrical data | | | | | | | | | |
| Rated voltage | 30 V | | 30 V | | | | | | |
| Rated current | 1 A | | 1.5 A | | | | | | |
| Volume resistance | ≤ 3 mΩ | | ≤ 5 mΩ | | | | | | |
| Insulation resistance | > 10 GΩ | | ≥ 100 MΩ | | | | | | |
| Material data | | | | | | | | | |
| Material contact / contact surface | CuSn / Au | | CuZn / Ni/Au | | | | | | |
| Contact carrier material | PA | | PA | | | | | | |
| Inflammability class according to UL 94 | - | | V0 | | | | | | |
| Temperature data | | | | | | | | | |
| Plug / socket | -25 ... 85 [°C] | | -25 ... 85 | | | | | | |
| | Ordering data | | | | Ordering data | | | | |
| | Unshielded | | Shielded | | 12-pos. | | 17-pos. | | |
| Description | Coding | Order No. | Pcs. / Pkt. | Order No. | Pcs. / Pkt. | Order No. | Pcs. / Pkt. | Order No. | Pcs. / Pkt. |
| Plug-in connector | | | | | | | | | |
| Socket, straight | A - standard | 1404420 | 1 | 1404411 | 1 | 1559631 | 1 | 1559644 | 1 |
| Plug, straight | A - standard | 1404419 | 1 | 1404410 | 1 | 1559592 | 1 | 1559602 | 1 |
| Socket, angled | A - standard | 1404423 | 1 | 1404413 | 1 | | | | |
| Plug, angled | A - standard | 1404421 | 1 | 1404412 | 1 | | | | |

M5 to M12 circular plug-in connectors

Sensor/actuator plug-in connectors for assembly

M12 plug-in connector, for assembly

Ethernet



M12 plug-in connector, 10 Gbps, Piercecon® connection

Ethernet



M12 plug-in connector, 100 Mbps, screw connection



| Technical data | |
|---|------------------------------|
| Electrical data | VS-08-M12...-10G-P SCO |
| Nominal voltage U_N | 48 V |
| Rated current | 0.5 A |
| Transmission characteristics (category) | CAT6 _A |
| Material contact / contact surface | CuSn / Ni/Au |
| Material of grip body | Zinc die-cast, nickel-plated |
| Inflammability class according to UL 94 | V0 |
| No. of pos. | 8 |
| Connection method | Piercecon® |
| Connection cross section AWG | 26 |
| Insertion/withdrawal cycles | ≥ 100 |
| Temperature data | |
| Ambient temperature (operation) | -40 °C ... 85 °C |

| Ordering data | | | |
|--|-----------------------|-----------|-------------|
| Description | Type | Order No. | Pcs. / Pkt. |
| Plug-in connector , CAT6 _A , plug, 8-pos., shielded, X-coded, cable diameter: 4 mm ... 8 mm | | | |
| Straight | VS-08-M12MS-10G-P SCO | 1417430 | 1 |
| Angled | VS-08-M12MR-10G-P SCO | 1417443 | 1 |
| Plug-in connector , Pg7 screw connection, 4-pos., D-coded, cable diameter: 4 mm ... 6 mm | | | |
| Plug, straight | | | |
| Plug-in connector , Pg9 screw connection, 4-pos., D-coded, cable diameter: 4 mm ... 8 mm | | | |
| Plug, straight | | | |

| Accessories | | | |
|---|----------------------|---------|---|
| Stripping tool , for multiple-stage repositioning of shielded conductors | VS-CABLE-STRIP-VARIO | 1657407 | 1 |

| Technical data | |
|---|--|
| Electrical data | SACC-M12MSD-4CON-...-SH |
| Nominal voltage U_N | 60 V |
| Rated current | 4 A |
| Transmission characteristics (category) | CAT5 (IEC 11801:2002), CAT5e (TIA 568B:2001) |
| Material contact / contact surface | CuZn / Au |
| Material of grip body | Zinc die-cast, nickel-plated |
| Inflammability class according to UL 94 | HB |
| No. of pos. | 4 |
| Connection method | Screw connection |
| Connection cross section AWG | 24 ... 18 |
| Insertion/withdrawal cycles | ≥ 100 |
| Temperature data | |
| Ambient temperature (operation) | -40 °C ... 85 °C |

| Ordering data | | | |
|---|--------------------------|-----------|-------------|
| Description | Type | Order No. | Pcs. / Pkt. |
| Plug-in connector , CAT5e, plug, 4-pos., shielded, X-coded, cable diameter: 4 mm ... 6 mm | | | |
| Plug, straight | SACC-M12MSD-4CON-PG 7-SH | 1521258 | 1 |
| Plug, angled | SACC-M12MSD-4CON-PG 9-SH | 1521261 | 1 |

| Accessories | | | |
|---|----------------------|---------|---|
| Stripping tool , for multiple-stage repositioning of shielded conductors | VS-CABLE-STRIP-VARIO | 1657407 | 1 |

M5 to M12 circular plug-in connectors

Sensor/actuator plug-in connectors for assembly

M12, insulation displacement connection



0.14 mm² ... 0.34 mm²



0.34 mm² ... 0.75 mm²



| | Technical data | Technical data |
|--|------------------------------------|------------------------------------|
| General data | 4-pos. | 4-pos. |
| M12 circular plug-in connector according to: | IEC 61076-2-101 | IEC 61076-2-101 |
| Pollution degree | 3 | 3 |
| Degree of protection | IP65/67 | IP65/67 |
| Connection method | Insulation displacement connection | Insulation displacement connection |
| Cable diameter | 3.5 mm ... 6 mm | 4 mm ... 8 mm |
| Electrical data | | |
| Rated voltage | 125 V | 250 V |
| Rated current | 4 A | 4 A |
| Volume resistance | ≤ 5 mΩ | ≤ 5 mΩ |
| Insulation resistance | ≥ 100 MΩ | ≥ 100 MΩ |
| Material data | | |
| Material contact / contact surface | CuSn / Ni/Au | CuSn / Ni/Au |
| Contact carrier material | TPU | TPU |
| Inflammability class according to UL 94 | V0 | V0 |
| Temperature data | | |
| Plug / socket | -25 ... 80 [°C] | -25 ... 80 |

| | | Ordering data | | | Ordering data | | |
|--|--------------|------------------------|-----------|-------------|------------------------|-----------|-------------|
| Description | Coding | Type | Order No. | Pcs. / Pkt. | Type | Order No. | Pcs. / Pkt. |
| Plug-in connector, with plastic knurl | | | | | | | |
| Socket, straight | A - standard | SACC-M12FS-4QO-0,34 | 1641701 | 1 | SACC-M12FS-4QO-0,75 | 1641756 | 1 |
| Plug, straight | A - standard | SACC-M12MS-4QO-0,34 | 1641714 | 1 | SACC-M12MS-4QO-0,75 | 1641769 | 1 |
| Plug-in connector, with metal knurl, SPEEDCON | | | | | | | |
| Socket, straight | A - standard | SACC-FS-4QO-0,34-M SCO | 1521588 | 1 | SACC-FS-4QO-0,75-M SCO | 1521601 | 1 |
| Plug, straight | A - standard | SACC-MS-4QO-0,34-M SCO | 1521575 | 1 | SACC-MS-4QO-0,75-M SCO | 1521591 | 1 |
| Plug-in connector, with metal knurl | | | | | | | |
| Socket, straight | A - standard | SACC-M12FS-4QO-0,34-M | 1641688 | 1 | SACC-M12FS-4QO-0,75-M | 1641772 | 1 |
| Plug, straight | A - standard | SACC-M12MS-4QO-0,34-M | 1641691 | 1 | SACC-M12MS-4QO-0,75-M | 1641785 | 1 |
| Plug-in connector, with stainless steel knurl | | | | | | | |
| Socket, straight | A - standard | SACC-M12FS-4QO-0,34-VA | 1440766 | 1 | SACC-M12FS-4QO-0,75-VA | 1440782 | 1 |
| Plug, straight | A - standard | SACC-M12MS-4QO-0,34-VA | 1440753 | 1 | SACC-M12MS-4QO-0,75-VA | 1440779 | 1 |

M5 to M12 circular plug-in connectors

Sensor/actuator plug-in connectors for assembly

M12, spring-cage connections



Unshielded, 4, 5-pos.



Shielded, 4, 5-pos.



| | Technical data | |
|--|--|--------|
| | 4-pos. | 5-pos. |
| General data | | |
| M12 circular plug-in connector according to: | IEC 61076-2-101 | |
| Pollution degree | 3 | |
| Degree of protection | IP67 | |
| Connection method | Spring-cage conn. | |
| Cable diameter | 4 mm ... 8 mm | |
| Connection cross section [mm ²] | 0.14 mm ² ... 0.5 mm ² | |
| Electrical data | | |
| Rated voltage | 250 V | 60 V |
| Rated current | 4 A | |
| Volume resistance | ≤ 8 mΩ | |
| Insulation resistance | ≥ 100 MΩ | |
| Material data | | |
| Material contact / contact surface | CuSn / Ni/Au | |
| Contact carrier material | TPU | |
| Inflammability class according to UL 94 | V0 | |
| Temperature data | | |
| Plug / socket | -40 ... 85 | |



| | Technical data | |
|--|--|--------|
| | 4-pos. | 5-pos. |
| General data | | |
| M12 circular plug-in connector according to: | IEC 61076-2-101 | |
| Pollution degree | 3 | |
| Degree of protection | IP67 | |
| Connection method | Spring-cage conn. | |
| Cable diameter | 4 mm ... 8 mm | |
| Connection cross section [mm ²] | 0.14 mm ² ... 0.5 mm ² | |
| Electrical data | | |
| Rated voltage | 60 V | |
| Rated current | 4 A | |
| Volume resistance | ≤ 8 mΩ | |
| Insulation resistance | ≥ 100 MΩ | |
| Material data | | |
| Material contact / contact surface | CuSn / Ni/Au | |
| Contact carrier material | TPU | |
| Inflammability class according to UL 94 | V0 | |
| Temperature data | | |
| Plug / socket | -40 ... 85 | |

| Description | Coding | Ordering data | | | |
|--|--------------|---------------|-------------|-----------|-------------|
| | | 4-pos. | | 5-pos. | |
| | | Order No. | Pcs. / Pkt. | Order No. | Pcs. / Pkt. |
| Plug-in connector , terminal marking: standard color coding and numbering | | | | | |
| Socket, angled | A - standard | 1432622 | 1 | 1432596 | 1 |
| Plug, angled | A - standard | 1432606 | 1 | 1432570 | 1 |
| Socket, straight | A - standard | 1432619 | 1 | 1432583 | 1 |
| Plug, straight | A - standard | 1432635 | 1 | 1432567 | 1 |

| Description | Coding | Ordering data | | | |
|--|--------------|---------------|-------------|-----------|-------------|
| | | 4-pos. | | 5-pos. | |
| | | Order No. | Pcs. / Pkt. | Order No. | Pcs. / Pkt. |
| Plug-in connector , terminal marking: standard color coding and numbering | | | | | |
| Socket, angled | A - standard | 1432758 | 1 | 1432677 | 1 |
| Plug, angled | A - standard | 1432732 | 1 | 1432651 | 1 |
| Socket, straight | A - standard | 1432745 | 1 | 1432664 | 1 |
| Plug, straight | A - standard | 1432729 | 1 | 1432648 | 1 |

M5 to M12 circular plug-in connectors

Sensor/actuator plug-in connectors for assembly

M12, screw connections



Plastic knurl, 4, 5-pos.



Metal knurl, SPEEDCON, 4, 5-pos.



| Technical data | |
|--|--------|
| 4-pos. | 5-pos. |
| General data | |
| M12 circular plug-in connector according to: | |
| IEC 61076-2-101 | |
| Pollution degree | |
| 3 | |
| Degree of protection | |
| IP67 | |
| Connection method | |
| Screw connection | |
| Connection cross section [mm²] | |
| 0.25 mm² ... 0.75 mm² | |
| Electrical data | |
| Rated voltage | |
| 250 V | 60 V |
| Rated current | |
| 4 A | |
| Volume resistance | |
| ≤ 8 mΩ | |
| Insulation resistance | |
| ≥ 100 MΩ | |
| Material data | |
| Material contact / contact surface | |
| CuZn / CuSnZn | |
| Contact carrier material | |
| PA 66 | |
| Inflammability class according to UL 94 | |
| HB | |
| Temperature data | |
| Plug / socket [°C] | |
| -40 ... 85 | |



| Technical data | |
|--|--------|
| 4-pos. | 5-pos. |
| General data | |
| M12 circular plug-in connector according to: | |
| IEC 61076-2-101 | |
| Pollution degree | |
| 3 | |
| Degree of protection | |
| IP67 | |
| Connection method | |
| Screw connection | |
| Connection cross section [mm²] | |
| 0.25 mm² ... 0.75 mm² | |
| Electrical data | |
| Rated voltage | |
| 250 V | 60 V |
| Rated current | |
| 4 A | |
| Volume resistance | |
| ≤ 8 mΩ | |
| Insulation resistance | |
| ≥ 100 MΩ | |
| Material data | |
| Material contact / contact surface | |
| CuZn / CuSnZn | |
| Contact carrier material | |
| PA 66 | |
| Inflammability class according to UL 94 | |
| HB | |
| Temperature data | |
| Plug / socket [°C] | |
| -40 ... 85 | |



| Ordering data | |
|--|--------------|
| Description | Coding |
| Plug-in connector, with Pg7 screw connection, cable diameter: 4 mm ... 6 mm | |
| Socket, angled | A - standard |
| Plug, angled | A - standard |
| Socket, straight | A - standard |
| Plug, straight | A - standard |
| Plug-in connector, with Pg9 screw connection, cable diameter: 6 mm ... 8 mm | |
| Socket, angled | A - standard |
| Plug, angled | A - standard |
| Socket, straight | A - standard |
| Plug, straight | A - standard |
| Power plug-in connector, with Pg11 screw connection, cable diameter: 8 mm ... 10 mm, rated current: up to 8 A (5th pos. max. 2 A) with 1.5 mm² wires/litz wires | |
| Socket, straight | A - standard |
| Plug, straight | A - standard |



| Ordering data | | | | | | | |
|---------------|-------------|-----------|-------------|-----------|-------------|---------|---|
| Order No. | Pcs. / Pkt. | Order No. | Pcs. / Pkt. | Order No. | Pcs. / Pkt. | | |
| 4-pos. | | 5-pos. | | 4-pos. | | 5-pos. | |
| 1681130 | 1 | 1662308 | 1 | 1543058 | 1 | 1543061 | 1 |
| 1681091 | 1 | 1662269 | 1 | 1542981 | 1 | 1542994 | 1 |
| 1681114 | 1 | 1662298 | 1 | 1543029 | 1 | 1543032 | 1 |
| 1681088 | 1 | 1662256 | 1 | 1542952 | 1 | 1542965 | 1 |
| | | 1500790 | 1 | | | 1543414 | 1 |
| | | 1513431 | 1 | | | 1543003 | 1 |
| | | 1500787 | 1 | | | 1543045 | 1 |
| | | 1500774 | 1 | | | 1542978 | 1 |



| Accessories | |
|---|----------------------|
| Pressure screw and seal, for cable diameters: | |
| 2.5 mm ... 3.5 mm | SACC-M12-SET/2,5-3,5 |



| Accessories | |
|----------------------|-------------|
| Order No. | Pcs. / Pkt. |
| SACC-M12-SET/2,5-3,5 | 1436505 |
| | 5 |

M5 to M12 circular plug-in connectors

Sensor/actuator plug-in connectors for assembly



Metal knurl, 4, 5, 8-pos.



Metal knurl, 4, 5-pos., with SKINTOP® screw connection



Stainless steel knurl, 4, 5-pos.



| Technical data | | |
|---|--|-----------|
| 4-pos. | 5-pos. | 8-pos. |
| IEC 61076-2-101 | | |
| 3 | | |
| IP67 | | |
| Screw connection | | |
| 0.25 mm ² ... 0.75 mm ² | 0.25 mm ² ... 0.5 mm ² | |
| 250 V | 60 V | 30 V |
| 4 A | | 2 A |
| ≤ 8 mΩ | | ≤ 3 mΩ |
| | ≥ 100 MΩ | |
| CuZn / CuSnZn | | CuZn / Au |
| | PA 66 | |
| | HB | |
| | -40 ... 85 | |

| Technical data | | |
|---|------------|-------|
| 4-pos. | 5-pos. | |
| IEC 61076-2-101 | | |
| 3 | | |
| IP67 | | |
| Screw connection | | |
| 0.25 mm ² ... 0.75 mm ² | - ... - | |
| 250 V | 125 V | - |
| 4 A | | - |
| ≤ 8 mΩ | | - |
| | ≥ 100 MΩ | - |
| CuZn / CuSnZn | | - / - |
| | PA 66 | - |
| | HB | - |
| | -20 ... 80 | - |

| Technical data | | |
|---|------------|-------|
| 4-pos. | 5-pos. | |
| IEC 61076-2-101 | | |
| 3 | | |
| IP67/IP69K | | |
| Screw connection | | |
| 0.25 mm ² ... 0.75 mm ² | - ... - | |
| 250 V | 60 V | - |
| 4 A | | - |
| ≤ 3 mΩ | | - |
| | ≥ 100 MΩ | - |
| CuZn / Au | | - / - |
| | PA 66 | - |
| | V0 | - |
| | -40 ... 85 | - |

| Ordering data | | | | | |
|---------------|-------------|-----------|-------------|-----------|-------------|
| Order No. | Pcs. / Pkt. | Order No. | Pcs. / Pkt. | Order No. | Pcs. / Pkt. |
| 4-pos. | | 5-pos. | | 8-pos. | |
| 1681143 | 1 | 1662984 | 1 | | |
| 1681101 | 1 | 1663129 | 1 | | |
| 1681127 | 1 | 1662968 | 1 | | |
| 1662528 | 1 | 1663116 | 1 | | |
| | | 1681499 | 1 | | |
| | | 1681473 | 1 | | |
| | | 1681486 | 1 | 1513347 | 1 |
| | | 1681460 | 1 | 1513334 | 1 |

| Ordering data | | | | | |
|---------------|-------------|-----------|-------------|-----------|-------------|
| Order No. | Pcs. / Pkt. | Order No. | Pcs. / Pkt. | Order No. | Pcs. / Pkt. |
| 4-pos. | | 5-pos. | | | |
| 1430381 | 1 | 1559000 | 1 | | |
| 1556870 | 1 | 1456466 | 1 | | |
| | | 1556812 | 1 | | |
| | | 1561742 | 1 | | |
| | | 1556838 | 1 | | |
| | | 1556825 | 1 | | |

| Ordering data | | | | | |
|---------------|-------------|-----------|-------------|-----------|-------------|
| Order No. | Pcs. / Pkt. | Order No. | Pcs. / Pkt. | Order No. | Pcs. / Pkt. |
| 4-pos. | | 5-pos. | | | |
| 1553284 | 1 | 1553297 | 1 | | |
| 1553200 | 1 | 1553213 | 1 | | |
| 1553242 | 1 | 1553255 | 1 | | |
| 1553161 | 1 | 1553187 | 1 | | |
| | | 1553307 | 1 | | |
| 1553226 | 1 | 1553239 | 1 | | |
| 1553268 | 1 | 1553271 | 1 | | |
| 1553174 | 1 | 1553190 | 1 | | |

| | | | |
|---------|---|---------|---|
| 1404416 | 1 | 1404418 | 1 |
| 1404415 | 1 | 1404417 | 1 |

| Accessories | | | |
|----------------------|-------------|-----------|-------------|
| Order No. | Pcs. / Pkt. | Order No. | Pcs. / Pkt. |
| SACC-M12-SET/2,5-3,5 | | 1436505 | 5 |

| Accessories | | | |
|-------------|-------------|-----------|-------------|
| Order No. | Pcs. / Pkt. | Order No. | Pcs. / Pkt. |
| | | | |

| Accessories | | | |
|-------------|-------------|-----------|-------------|
| Order No. | Pcs. / Pkt. | Order No. | Pcs. / Pkt. |
| | | | |

M5 to M12 circular plug-in connectors

Sensor/actuator plug-in connectors for assembly

M12, screw connection, shielded



Zinc die-cast housing, 4, 5, 8-pos.



Stainless steel housing, 5-pos.



| | Technical data | | | | | | Technical data | | | | | | |
|--|-----------------------|---------------|-------------|-----------|-------------|-----------|-----------------------|---------------|-------------|-----------|-------------|-----------|-------------|
| | 4-pos. | | 5-pos. | | 8-pos. | | 5-pos. | | | | | | |
| General data | | | | | | | | | | | | | |
| M12 circular plug-in connector according to: | IEC 61076-2-101 | | | | | | IEC 61076-2-101 | | | | | | |
| Pollution degree | 3 | | | | | | 3 | | | | | | |
| Degree of protection | IP67 | | | | | | IP67/IP69K | | | | | | |
| Connection method | Screw connection | | | | | | Screw connection | | | | | | |
| Connection cross section [mm²] | 0.25 mm² ... 0.75 mm² | | | | | | 0.25 mm² ... 0.75 mm² | | | | | | |
| Electrical data | | | | | | | | | | | | | |
| Rated voltage | 60 V | | | | 30 V | | 60 V | | | | | | |
| Rated current | 4 A | | | | 2 A | | 4 A | | | | | | |
| Volume resistance | ≤ 3 mΩ | | | | | | ≤ 3 mΩ | | | | | | |
| Insulation resistance | ≥ 100 MΩ | | | | | | ≥ 100 MΩ | | | | | | |
| Material data | | | | | | | | | | | | | |
| Material contact / contact surface | CuZn / Au | | | | | | CuZn / Au | | | | | | |
| Contact carrier material | PA 66 | | | | | | PA 66 | | | | | | |
| Inflammability class according to UL 94 | HB | | | | | | V0 | | | | | | |
| Temperature data | | | | | | | | | | | | | |
| Plug / socket | -40 ... 85 | | | | | | -40 ... 85 | | | | | | |
| | [°C] | | | | | | | | | | | | |
| | | Ordering data | | | | | | Ordering data | | | | | |
| Description | Coding | Order No. | Pcs. / Pkt. | Order No. | Pcs. / Pkt. | Order No. | Pcs. / Pkt. | Order No. | Pcs. / Pkt. | Order No. | Pcs. / Pkt. | Order No. | Pcs. / Pkt. |
| | | 4-pos. | | 5-pos. | | 8-pos. | | 5-pos. | | | | | |
| Plug-in connector, with Pg7 screw connection, cable diameter: 4 mm ... 6 mm | | | | | | | | | | | | | |
| Plug, angled | A - standard | 1694279 | 1 | 1693429 | 1 | | | | | | | | |
| Socket, straight | A - standard | 1694295 | 1 | 1694305 | 1 | | | | | | | | |
| Plug, straight | A - standard | 1693830 | 1 | 1693416 | 1 | | | | | | | | |
| Plug-in connector, with Pg9 screw connection, cable diameter: 6 mm ... 8 mm | | | | | | | | | | | | | |
| Socket, angled | A - standard | | | 1430433 | 1 | | | | | | | | |
| Plug, angled | A - standard | | | 1694282 | 1 | | | | | | | | |
| Socket, straight | A - standard | 1515170 | 1 | 1694318 | 1 | 1511860 | 1 | | | | | | |
| Plug, straight | A - standard | 1501540 | 1 | 1694266 | 1 | 1511857 | 1 | | | | | | |
| Plug-in connector, with Pg9 screw connection, cable diameter: 6 mm ... 8.5 mm | | | | | | | | | | | | | |
| Socket, straight | A - standard | | | 1508365 | 1 | | | | | | | | |
| Plug, straight | A - standard | | | 1508352 | 1 | | | | | | | | |
| Plug-in connector, with M16 screw connection, cable diameter: 3 mm ... 5.5 mm | | | | | | | | | | | | | |
| Socket, straight | A - standard | | | | | | | 1440038 | 1 | | | | |
| Plug, straight | A - standard | | | | | | | 1440012 | 1 | | | | |
| Plug-in connector, with M16 screw connection, cable diameter: 5.5 mm ... 8.6 mm | | | | | | | | | | | | | |
| Socket, straight | A - standard | | | | | | | 1440041 | 1 | | | | |
| Plug, straight | A - standard | | | | | | | 1440025 | 1 | | | | |

M12, power plug-in connector, screw connection



Metal knurl, 3-pos. + PE, S-coded



Metal knurl, 4-pos., T-coded

| | Technical data | | | Technical data | | |
|--|--|-----------|-------------|--|-----------|-------------|
| | 3-pos. + PE | | | 4-pos. | | |
| General data | | | | | | |
| Pollution degree | 3 | | | 3 | | |
| Degree of protection | IP67 | | | IP67 | | |
| Connection method | Screw connection | | | Screw connection | | |
| Connection cross section [mm ²] | 0.75 mm ² ... 1.5 mm ² | | | 0.75 mm ² ... 1.5 mm ² | | |
| Electrical data | | | | | | |
| Rated voltage | 630 V | | | 60 V | | |
| Rated current | 12 A | | | 12 A | | |
| Volume resistance | ≤ 3 mΩ | | | ≤ 3 mΩ | | |
| Insulation resistance | > 10 GΩ | | | > 10 GΩ | | |
| Material data | | | | | | |
| Material contact / contact surface | CuZn / Au | | | CuZn / Au | | |
| Contact carrier material | PA 46 | | | PA 46 | | |
| Inflammability class according to UL 94 | V0 | | | V0 | | |
| Temperature data | | | | | | |
| Plug / socket | -40 ... 85 [°C] | | | -40 ... 85 | | |
| | Ordering data | | | Ordering data | | |
| Description | Type | Order No. | Pcs. / Pkt. | Type | Order No. | Pcs. / Pkt. |
| Plug-in connector, with Pg11 screw connection, cable diameter: 8 mm ... 10 mm | | | | | | |
| Socket, straight | SACC-M12FSS-3PECON-PG11-M | 1404642 | 1 | SACC-M12FST-3PECON-PG11-M | 1404644 | 1 |
| Plug, straight | SACC-M12MSS-3PECON-PG11-M | 1404641 | 1 | SACC-M12MST-3PECON-PG11-M | 1404643 | 1 |

M5 to M12 circular plug-in connectors

Sensor/actuator plug-in connectors for assembly

M12, DUO plug-in connector, screw connection

Notes:
SPEEDCON and plastic knurls without key areas.



Metal knurl, 4, 5-pos.



SPEEDCON metal knurl/plastic knurl, 5 pos.



| | Technical data | |
|--|---|--------|
| | 4-pos. | 5-pos. |
| General data | | |
| M12 circular plug-in connector according to: | IEC 61076-2-101 | |
| Pollution degree | 3 | |
| Degree of protection | IP67 | |
| Connection method | Screw connection | |
| Connection cross section [mm ²] | 0.25 mm ² ... 0.75 mm ² | |
| Electrical data | | |
| Rated voltage | 250 V | 60 V |
| Rated current | 4 A | |
| Volume resistance | ≤ 8 mΩ | |
| Insulation resistance | ≥ 100 MΩ | |
| Material data | | |
| Material contact / contact surface | CuZn / CuSnZn | |
| Contact carrier material | PA 66 | |
| Inflammability class according to UL 94 | V0 | |
| Temperature data | | |
| Plug / socket | -40 ... 85 [°C] | |



| | Technical data | |
|--|---|-----------------------|
| | Metal knurl, SPEEDCON, 5-pos. | Plastic knurl, 5-pos. |
| General data | | |
| M12 circular plug-in connector according to: | IEC 61076-2-101 | |
| Pollution degree | 3 | |
| Degree of protection | IP67 | |
| Connection method | Screw connection | |
| Connection cross section [mm ²] | 0.25 mm ² ... 0.75 mm ² | |
| Electrical data | | |
| Rated voltage | 60 V | |
| Rated current | 4 A | |
| Volume resistance | ≤ 8 mΩ | |
| Insulation resistance | ≥ 100 MΩ | |
| Material data | | |
| Material contact / contact surface | CuZn / CuSnZn | |
| Contact carrier material | PA 66 | |
| Inflammability class according to UL 94 | V0 | |
| Temperature data | | |
| Plug / socket | -40 ... 85 | -25 ... 85 |

| Description | Coding | Ordering data | | | |
|---|--------------|---------------|-------------|-----------|-------------|
| | | Order No. | Pcs. / Pkt. | Order No. | Pcs. / Pkt. |
| | | 4-pos. | | 5-pos. | |
| Plug-in connector, with Pg11 DUO screw connection, cable diameter: 2 x 3 mm ... 5.2 mm | | | | | |
| Socket, straight | A - standard | | | | |
| Plug, straight | A - standard | 1507052 | 1 | 1662748 | 1 |
| Plug, angled | A - standard | | | | |

| Description | Coding | Ordering data | | | |
|---|--------------|-------------------------------|-------------|-----------------------|-------------|
| | | Order No. | Pcs. / Pkt. | Order No. | Pcs. / Pkt. |
| | | Metal knurl, SPEEDCON, 5-pos. | | Plastic knurl, 5-pos. | |
| Plug-in connector, with Pg11 DUO screw connection, cable diameter: 2 x 3 mm ... 5.2 mm | | | | | |
| Socket, straight | A - standard | | | 1694596 | 1 |
| Plug, straight | A - standard | 1543016 | 1 | 1662285 | 1 |
| Plug, angled | A - standard | | | 1531044 | 1 |

M5 to M12 circular plug-in connectors

Sensor/actuator plug-in connectors for assembly

7/8", screw connection



Connection cross section:
1.5 mm², 3, 4, 5-pos.



Connection cross section:
2.5 mm², 5-pos.



| | Technical data | | | Technical data | | |
|---|----------------|--|--------|--|---------|-----|
| | 3-pos. | 4-pos. | 5-pos. | 5-pos. | | |
| General data | | | | | | |
| Pollution degree | | 3 | | 3 | | - |
| Degree of protection | | IP67 | | IP67 | | - |
| Connection method | | Screw connection | | Screw connection | | - |
| Connection cross section | | 0.34 mm ² ... 1.5 mm ² | | 0.34 mm ² ... 2.5 mm ² | - ... - | - |
| Connection cross section AWG | | 22 ... 16 | | 22 ... 14 | - ... - | - |
| Electrical data | | | | | | |
| Rated voltage | | 250 V | | 250 V | | - |
| Rated current | 12 A | | 9 A | 9 A | | - |
| Volume resistance | | ≤ 5 mΩ | | ≤ 5 mΩ | | - |
| Insulation resistance | | ≥ 100 MΩ | | ≥ 100 MΩ | | - |
| Material data | | | | | | |
| Material contact / contact surface | | CuZn / Au | | CuZn / Au | | -/- |
| Contact carrier material | | PUR / PA66 | | PUR / PA66 | | - |
| Inflammability class according to UL 94 | | HB | | HB | | - |
| Temperature data | | | | | | |
| Plug / socket | | -25 ... 85 | | -25 ... 85 | | - |

| Description | Ordering data | | | | | |
|---|---------------|-------------|-----------|-------------|-----------|-------------|
| | Order No. | Pcs. / Pkt. | Order No. | Pcs. / Pkt. | Order No. | Pcs. / Pkt. |
| Plug-in connector, with Pg9 screw connection, cable diameter: 6 mm ... 8 mm | | | | | | |
| Socket, angled | 1521478 | 1 | 1521494 | 1 | 1521517 | 1 |
| Plug, angled | 1521465 | 1 | 1521481 | 1 | 1521504 | 1 |
| Socket, straight | 1521300 | 1 | 1521342 | 1 | 1521384 | 1 |
| Plug, straight | 1521287 | 1 | 1521326 | 1 | 1521668 | 1 |
| Plug-in connector, with Pg11 screw connection, cable diameter: 8 mm ... 10 mm | | | | | | |
| Socket, angled | | | | 1456297 | | 1 |
| Plug, angled | | | | 1456242 | | 1 |
| Socket, straight | | | | 1456271 | | 1 |
| Plug, straight | | | | 1456226 | | 1 |
| Plug-in connector, with Pg13.5 screw connection, cable diameter: 10 mm ... 12 mm | | | | | | |
| Socket, angled | | | | | 1456307 | 1 |
| Plug, angled | | | | | 1456255 | 1 |
| Socket, straight | 1521313 | 1 | 1521355 | 1 | 1521397 | 1 |
| Plug, straight | 1521290 | 1 | 1521339 | 1 | 1521371 | 1 |
| Plug-in connector, with Pg16 screw connection, cable diameter: 12 mm ... 14 mm | | | | | | |
| Socket, straight | | | | 1559071 | | 1 |
| Plug, straight | | | | 1559039 | | 1 |

M5 to M12 circular plug-in connectors

M12 power plug-in connectors

M12 power flush-type plug-in connectors, with 0.5 m long litz wires



S-coded, 3-pos. + PE



T-coded, 4-pos.

| | Technical data | | | |
|--|------------------|-------------|------------------|-------------|
| | Front mounting | | Rear mounting | |
| General data | | | | |
| Pollution degree | 3 | | 3 | |
| Degree of protection | IP67 | | IP67 | |
| Connection method | Individual wires | | Individual wires | |
| Electrical data | | | | |
| Rated voltage | 630 V | | 630 V | |
| Rated current | 12 A | | 12 A | |
| Volume resistance | ≤ 3 mΩ | | ≤ 3 mΩ | |
| Insulation resistance | ≥ 100 MΩ | | ≥ 100 MΩ | |
| Surge voltage category | III | | III | |
| Material data | | | | |
| Material contact / contact surface | CuZn / Au | | CuZn / Au | |
| Contact carrier material | PA6 | | PA6 | |
| Cable type | PP litz wire | | PP litz wire | |
| Temperature data | | | | |
| Plug / socket | [°C] | -25 ... 85 | [°C] | -25 ... 85 |
| Cable, fixed installation | [°C] | -40 ... 90 | [°C] | -40 ... 90 |
| | Ordering data | | | |
| Description | Order No. | Pcs. / Pkt. | Order No. | Pcs. / Pkt. |
| | Front mounting | | Rear mounting | |
| Flush-type plug-in connector, M16 fastening thread | | | | |
| Socket | 1424137 | 1 | 1424133 | 1 |
| Plug | 1424139 | 1 | 1424132 | 1 |
| | Accessories | | | |
| Flat nut, with: M16 thread | SACC-E-MU-M16 | 1504097 | 100 | |

| | Technical data | | | |
|--|------------------|-------------|------------------|-------------|
| | Front mounting | | Rear mounting | |
| General data | | | | |
| Pollution degree | 3 | | 3 | |
| Degree of protection | IP67 | | IP67 | |
| Connection method | Individual wires | | Individual wires | |
| Electrical data | | | | |
| Rated voltage | 60 V | | 60 V | |
| Rated current | 12 A | | 12 A | |
| Volume resistance | ≤ 3 mΩ | | ≤ 3 mΩ | |
| Insulation resistance | ≥ 100 MΩ | | ≥ 100 MΩ | |
| Surge voltage category | III | | III | |
| Material data | | | | |
| Material contact / contact surface | CuZn / Au | | CuZn / Au | |
| Contact carrier material | PA6 | | PA6 | |
| Cable type | PP litz wire | | PP litz wire | |
| Temperature data | | | | |
| Plug / socket | [°C] | -25 ... 85 | [°C] | -25 ... 85 |
| Cable, fixed installation | [°C] | -40 ... 90 | [°C] | -40 ... 90 |
| | Ordering data | | | |
| Description | Order No. | Pcs. / Pkt. | Order No. | Pcs. / Pkt. |
| | Front mounting | | Rear mounting | |
| Flush-type plug-in connector, M16 fastening thread | | | | |
| Socket | 1424138 | 1 | 1424134 | 1 |
| Plug | 1424140 | 1 | 1424136 | 1 |
| | Accessories | | | |
| Flat nut, with: M16 thread | SACC-E-MU-M16 | 1504097 | 100 | |

M12 power flush-type plug-in connectors, modular, 25 mm square flange, pre-assembled



Flange housing, 2.7 mm housing bore holes



Pre-assembled contact carrier and insulating body with 0.5 m long litz wires

| | Technical data | | Technical data | | | | | |
|--|------------------------------|-------------|----------------------|-------------|-----------------------------|-------------|------------------------|-------------|
| | | | S-coded, 3-pos. + PE | | T-coded, 4-pos. | | | |
| General data | | | | | | | | |
| Pollution degree | - | - | 3 | | 3 | | | |
| Degree of protection | - | - | IP67 | | IP67 | | | |
| Connection method | - | - | Individual wires | | Individual wires | | | |
| Electrical data | | | | | | | | |
| Rated voltage | - | - | 630 V | | 60 V | | | |
| Rated current | - | - | 12 A | | 12 A | | | |
| Volume resistance | - | - | ≤ 3 mΩ | | ≤ 3 mΩ | | | |
| Surge voltage category | - | - | III | | III | | | |
| Material data | | | | | | | | |
| Material contact / contact surface | - / - | - / - | CuZn / Au | | CuZn / Au | | | |
| Contact carrier material | - | - | PA6 | | PA6 | | | |
| Cable gland material | Zinc die-cast, nickel-plated | - | - | | - | | | |
| Cable type | - | - | PP litz wire | | PP litz wire | | | |
| Temperature data | | | | | | | | |
| Plug / socket [°C] | -40 ... 85 | - | -25 ... 85 | | -25 ... 85 | | | |
| Cable, fixed installation [°C] | - | - | -40 ... 90 | | -40 ... 90 | | | |
| Description | Ordering data | | | | Ordering data | | | |
| | Order No. | Pcs. / Pkt. | Order No. | Pcs. / Pkt. | Order No. | Pcs. / Pkt. | Order No. | Pcs. / Pkt. |
| Square flange housing, with flat gasket | | | | | S-coded, 3-pos. + PE | | T-coded, 4-pos. | |
| | 1424131 | 10 | | | | | | |
| Assembled contact carrier and insulating body, with 0.5 m litz wires and crimp contacts | | | | | | | | |
| Plug | | | | | 1424129 | 1 | 1424130 | 1 |

M5 to M12 circular plug-in connectors

M12 power plug-in connectors

M12, power device plug-in connector, two-piece, for reflow processes, rear mounting



S-coded, 3-pos. + PE



T-coded, 4-pos.

| | Technical data | | Technical data | |
|--|-----------------------|-----------------------|-----------------------|-----------------------|
| | Plug | Socket | Plug | Socket |
| General data | | | | |
| Pollution degree | 3 | 3 | 3 | 3 |
| Degree of protection | IP67 | IP67 | IP67 | IP67 |
| Connection method | THR solder connection | THR solder connection | THR solder connection | THR solder connection |
| Electrical data | | | | |
| Rated voltage | 630 V | 630 V | 60 V | 60 V |
| Rated current | 12 A | 12 A | 12 A | 12 A |
| Volume resistance | ≤ 3 mΩ | ≤ 3 mΩ | ≤ 3 mΩ | ≤ 3 mΩ |
| Surge voltage category | III | III | III | III |
| Material data | | | | |
| Material contact / contact surface | CuZn / Au | CuZn / Au | CuZn / Au | CuZn / Au |
| Contact carrier material | PA4T | PA4T | PA4T | PA4T |
| Inflammability class according to UL 94 | V0 | V0 | V0 | V0 |
| Temperature data | | | | |
| Plug / socket | -40 ... 85 | -40 ... 85 | -40 ... 85 | -40 ... 85 |
| | [°C] | | | |
| | Ordering data | | Ordering data | |
| | Order No. | Pcs. / Pkt. | Order No. | Pcs. / Pkt. |
| Description | | | | |
| | Plug | Socket | Plug | Socket |
| Contact carrier, for reflow processes | 1406410 | 20 | 1406409 | 20 |
| Contact carrier, shielded, for reflow processes | | | | |
| | | | 1406396 | 60 |
| | | | 1406411 | 60 |
| | | | 1406397 | 60 |
| | | | 1406412 | 60 |
| | Accessories | | Accessories | |
| Housing screw connections, SPEEDCON screw versions and press-in versions, for all two-piece THR and wave soldering contact carriers | See page 258 onwards | | See page 258 onwards | |



M12 flush-type plug



M12 flush-type plug

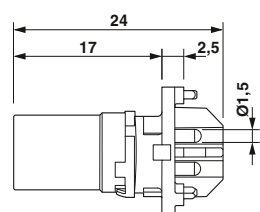

M12 flush-type socket

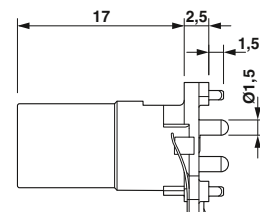

M12 flush-type socket



M12, power plug-in connector, screw connection



S-coded, 3-pos. + PE



T-coded, 4-pos.

| | Technical data | | | Technical data | | |
|--|--|-----------|-------------|--|-----------|-------------|
| General data | | | | | | |
| Pollution degree | 3 | | | 3 | | |
| Degree of protection | IP67 | | | IP67 | | |
| Connection method | Screw connection | | | Screw connection | | |
| Cable diameter | 8 mm ... 10 mm | | | 8 mm ... 10 mm | | |
| Connection cross section [mm ²] | 0.75 mm ² ... 1.5 mm ² | | | 0.75 mm ² ... 1.5 mm ² | | |
| Electrical data | | | | | | |
| Rated voltage | 630 V | | | 60 V | | |
| Rated current | 12 A | | | 12 A | | |
| Volume resistance | ≤ 3 mΩ | | | ≤ 3 mΩ | | |
| Surge voltage category | III | | | III | | |
| Material data | | | | | | |
| Material contact / contact surface | CuZn / Au | | | CuZn / Au | | |
| Contact carrier material | PA 46 | | | PA 46 | | |
| Temperature data | | | | | | |
| Plug / socket | [-40 ... 85 °C] | | | [-40 ... 85 °C] | | |
| | Ordering data | | | Ordering data | | |
| Description | Type | Order No. | Pcs. / Pkt. | Type | Order No. | Pcs. / Pkt. |
| Plug-in connector, with Pg11 screw connection, cable diameter: 8 mm ... 10 mm | | | | | | |
| Socket, straight | SACC-M12FSS-3PECON-PG11-M | 1404642 | 1 | SACC-M12FST-3PECON-PG11-M | 1404644 | 1 |
| Plug, straight | SACC-M12MSS-3PECON-PG11-M | 1404641 | 1 | SACC-M12MST-3PECON-PG11-M | 1404643 | 1 |



Pin assignment of M12 socket, 4-pos., S-coded, view of socket side



Pin assignment of M12 socket, 4-pos., T-coded, view of socket side



Pin assignment of M12 plug, 4-pos., S-coded, view of plug side



Pin assignment of M12 plug, 4-pos., T-coded, view of plug side

M5 to M12 circular plug-in connectors

M12 power plug-in connectors

M12-SPEEDCON power cable, 3-pos.+PE, S-coded, unshielded

Free end



M12 plug, SPEEDCON



Ordering data

Ordering data

Ordering data

Free end

Order No.

Order No.

Order No.



| | | | |
|------|---------|------|---------|
| 1 m | 1408835 | 1 m | 1408839 |
| 2 m | 1408836 | 2 m | 1408840 |
| 5 m | 1408837 | 5 m | 1408841 |
| 10 m | 1408838 | 10 m | 1408842 |

M12 socket, SPEEDCON, straight



| | |
|------|---------|
| 1 m | 1408843 |
| 2 m | 1408844 |
| 5 m | 1408845 |
| 10 m | 1408846 |

M12 socket, SPEEDCON, angled



| | |
|------|---------|
| 1 m | 1408848 |
| 2 m | 1408852 |
| 5 m | 1408853 |
| 10 m | 1408854 |

| Cable description | Cable type | Color coding | | Pin assignment |
|---------------------------|------------|--------------|---|----------------|
| PUR, halogen-free - black | PUR | BK1 | 1 | 1 |
| | | BK2 | 2 | 2 |
| | | BK3 | 3 | 3 |
| | | GNYE | | PE |

Technical data

| | | M12 |
|------------------------------|------|---|
| Rated voltage | [V] | 630 |
| Rated current | [A] | 12 |
| Volume resistance | | ≤ 3 mΩ |
| Material contact M12 | | CuZn |
| Material contact surface M12 | | Au |
| Material handle M12 | | TPU, hardly inflammable, self-extinguishing |
| Material, knurls | | Zinc die-cast, nickel-plated |
| Degree of protection | | IP65 / IP67 |
| Temperature data | | |
| Plug / socket | [°C] | -25 ... 85 |

M12-SPEEDCON power cable, 3-pos.+PE, S-coded, shielded

Free end



M12 plug, SPEEDCON, 360° shielded



Ordering data

Ordering data

Ordering data

| Free end | Order No. | Order No. | Order No. | Order No. | |
|----------|-----------|-----------|-----------|-----------|---------|
| | | 1.5 m | 1424104 | 1.5 m | 1424108 |
| | | 3 m | 1424105 | 3 m | 1424109 |
| | | 5 m | 1424245 | 5 m | 1424110 |
| | | 10 m | 1424107 | 10 m | 1424111 |
| | 1.5 m | 1424096 | | | |
| | 3 m | 1424097 | | | |
| | 5 m | 1424098 | | | |
| | 10 m | 1424099 | | | |
| | 1.5 m | 1424100 | | | |
| | 3 m | 1424101 | | | |
| | 5 m | 1424102 | | | |
| | 10 m | 1424103 | | | |

| Cable description | Cable type | Color coding | Pin assignment | |
|----------------------------|------------|--------------|----------------|----|
| PUR, halogen-free - orange | PUR | BK1 | 1 | 1 |
| | | BK2 | 2 | 2 |
| | | BK3 | 3 | 3 |
| | | GNYE | | PE |

Technical data

| | | M12 |
|------------------------------|------|---|
| Rated voltage | [V] | 630 |
| Rated current | [A] | 12 |
| Volume resistance | | ≤ 3 mΩ |
| Material contact M12 | | CuZn |
| Material contact surface M12 | | Au |
| Material handle M12 | | TPU, hardly inflammable, self-extinguishing |
| Material, knurls | | Zinc die-cast, nickel-plated |
| Degree of protection | | IP65 / IP67 |
| Temperature data | | |
| Plug / socket | [°C] | -25 ... 85 |

M5 to M12 circular plug-in connectors

M12 power plug-in connectors

M12-SPEEDCON power cable, 4-pos., T-coded, unshielded

Free end



M12 plug, SPEEDCON



Ordering data

Ordering data

Ordering data

| Free end | Order No. | Order No. | Order No. |
|---|-----------|-----------|--------------|
| | 1 m | 1408812 | 1 m 1408816 |
| | 2 m | 1408813 | 2 m 1408819 |
| | 5 m | 1408814 | 5 m 1408820 |
| | 10 m | 1408815 | 10 m 1408822 |
| M12 socket, SPEEDCON, straight | 1 m | 1408823 | 1 m 1408808 |
| | 2 m | 1408824 | 2 m 1408809 |
| | 5 m | 1408825 | 5 m 1408810 |
| | 10 m | 1408826 | 10 m 1408811 |
| M12 socket, SPEEDCON, angled | 1 m | 1408827 | |
| | 2 m | 1408828 | |
| | 5 m | 1408829 | |
| | 10 m | 1408830 | |

| Cable description | Cable type | Color coding | Pin assignment |
|---------------------------|------------|----------------------------------|----------------|
| PUR, halogen-free - black | PUR | BN 1 WH 2 BK 4 BU 3 | |

Technical data

| | | M12 |
|------------------------------|------|---|
| Rated voltage | [V] | 60 |
| Rated current | [A] | 12 |
| Volume resistance | | ≤ 3 mΩ |
| Material contact M12 | | CuZn |
| Material contact surface M12 | | Au |
| Material handle M12 | | TPU, hardly inflammable, self-extinguishing |
| Material, knurls | | Zinc die-cast, nickel-plated |
| Degree of protection | | IP65 / IP67 |
| Temperature data | | |
| Plug / socket | [°C] | -25 ... 85 |

M12-SPEEDCON power cable, 4-pos., T-coded, shielded



Ordering data Ordering data Ordering data

| Free end | Order No. | Order No. | Order No. | Order No. | |
|----------|-----------|-----------|-----------|-----------|---------|
| | | 1.5 m | 1424120 | 1.5 m | 1424124 |
| | | 3 m | 1424121 | 3 m | 1424125 |
| | | 5 m | 1424122 | 5 m | 1424126 |
| | | 10 m | 1424123 | 10 m | 1424127 |
| | 1.5 m | 1424112 | | | |
| | 3 m | 1424113 | | | |
| | 5 m | 1424114 | | | |
| | 10 m | 1424115 | | | |
| | 1.5 m | 1424116 | | | |
| | 3 m | 1424117 | | | |
| | 5 m | 1424118 | | | |
| | 10 m | 1424128 | | | |

| Cable description | Cable type | Color coding | Pin assignment |
|---------------------------|------------|--------------|----------------|
| PUR, halogen-free - black | PUR | BN | 1 |
| | | WH | 2 |
| | | BK | 4 |
| | | BU | 3 |

| Technical data | |
|------------------------------|---|
| M12 | |
| Rated voltage | [V] 60 |
| Rated current | [A] 12 |
| Volume resistance | ≤ 3 mΩ |
| Material contact M12 | CuZn |
| Material contact surface M12 | Au |
| Material handle M12 | TPU, hardly inflammable, self-extinguishing |
| Material, knurls | Zinc die-cast, nickel-plated |
| Degree of protection | IP65 / IP67 |
| Temperature data | |
| Plug / socket | [°C] -25 ... 85 |

M5 to M12 circular plug-in connectors

Accessories

Sealing elements

During transport or in the field, unoccupied plug-in connections must be protected or closed. The screw plugs, sealing caps and closing caps made of plastic or metal are suitable for this purpose. IP65/IP67 protection as well as IP69K protection is thereby achieved.



| Description | Ordering data | | |
|--|---------------------------|-----------|-------------|
| | Type | Order No. | Pcs. / Pkt. |
| M5 screw plug ① For unoccupied M5 sockets of the sensor/actuator cables, boxes and flush-type plug-in connectors | PROT-M5 | 1533288 | 10 |
| M8 screw plug ② For unoccupied M8 sockets of the sensor/actuator cables, boxes and flush-type plug-in connectors | PROT-M8 | 1682540 | 5 |
| M12 screw plug ③ For the unused M12 sockets of the sensor/actuator cables, boxes and flush-type plug-in connectors | PROT-M12 | 1680539 | 5 |
| M12 screw plug with SPEEDCON quick locking ④ For unoccupied M12 sockets of the sensor/actuator cables, boxes and flush-type plug-in connectors | PROT-MS SCO | 1553129 | 5 |
| M12 sealing cap ⑤ For unoccupied M12 plugs of the sensor/actuator cables, flush-type plug-in connectors and I/O devices in the field | PROT-M12 FS | 1560251 | 5 |
| M12 screw plug, metal ⑥ For unoccupied M12 sockets of the shielded sensor/actuator cables, boxes and flush-type plug-in connectors | PROT-M12 SH | 1503302 | 5 |
| M12 sealing cap, metal ⑦ For unoccupied M12 plugs of the sensor/actuator cables, flush-type plug-in connectors and I/O devices in the field | PROT-M12 FS-M | 1430488 | 10 |
| M12 screw plug, stainless steel ⑧ For unused M12 sockets of the sensor/actuator cables, boxes, and flush-type plug-in connectors in the food and outdoor range | PROT-M12 FB | 1555538 | 5 |
| Closing cap ⑨ For Pg9/ Pg11, to close unoccupied connections | Q-PROT 9/11 | 1670235 | 10 |
| M16 locking screw ⑩ With flat nut for oval housing cutouts | SACC-M16-SEALING PLUG SET | 1453368 | 10 |

Sealing elements with holding band or fixing chain

All IP67 interfaces can be closed tightly using the screw plugs and sealing caps in sizes M8, M12 and 7/8". The holding bands are fastened on the cable or the housing and are thus held captive.

The M12 metal protective cap with fixing chain is suitable for all pin versions. It is used in harsh industrial environments or for EMC applications.



| Ordering data | | | |
|---|---|--|--------------------------------|
| Description | Type | Order No. | Pcs. / Pkt. |
| Screw plug made from plastic with retaining strap, for sealing unused sockets ① M8 for SAC cables M8 with 3 mm fastening eye M8 with 12 mm fastening eye M12 for SAC cables M12 with 15 mm fastening eye 7/8" for SAC cables | PROT-M 8 MS-PA-CHAIN PROT-M 8 MS-PA-CHAIN-EYE-DM3 PROT-M 8 MS-PA-CHAIN-EYE PROT-M12 MS-PA-CHAIN PROT-M12 MS-PA-CHAIN-EYE-DM14 PROT-MINMS-PA-CHAIN | 1430860 1441105 1441095 1430899 1456200 1430925 | 10 10 10 5 5 10 |
| Plastic sealing cap with holding band, for closing unoccupied connectors ② M8 for SAC cables M8 with 8 mm fastening eye M12 for SAC cables M12 with 12 mm fastening eye M12 with 15 mm fastening eye 7/8" for SAC cables | PROT-M 8 FS-PA-CHAIN PROT-M 8 FS-PA-CHAIN-EYE PROT-M12 FS-PA-CHAIN PROT-M12 FS-PA-CHAIN-EYE-DM12 PROT-M12 FS-PA-CHAIN-EYE-DM14 PROT-MINFS-PA-CHAIN | 1430857 1441082 1430873 1456187 1456190 1430912 | 10 10 5 5 5 10 |
| Metal sealing cap with fixing chain, for closing unoccupied connectors ③ M12 with 16 mm fastening eye | PROT-M12 FS-M-CHAIN | 1430491 | 10 |

M5 to M12 circular plug-in connectors

Accessories

Accessories for flush-type plug-in connectors

Special fixing nuts are available for EMC-compliant installation of M12 flush-type plug-in connectors on coated or varnished housing surfaces. When tightened, these cut through the surface coating, thus establishing contact between the housing and the connector.

Alternatively, flat gaskets can be used as the seal between the housing panel and the device plug. Flat gaskets are recommended for thin panels, as the housing cutouts do not have to be chamfered.



| Description | Ordering data | | |
|--|---------------------------|----------------|-------------|
| | Type | Order No. | Pcs. / Pkt. |
| EMC hexagonal nuts with fine tooting, for all flush-type plug-in connectors with: ① | | | |
| M12 fastening thread | SACC-M12-KD-NUT-SH | 1440151 | 10 |
| EMC hexagonal nuts with fine tooting, for all flush-type plug-in connectors with: ② | | | |
| M16 fastening thread | SACC-M16-KD-NUT-SH | 1440164 | 10 |
| Pg9 fastening thread | SACC-PG9-KD-NUT-SH | 1440177 | 10 |
| Flat gasket for all flush-type plug-in connectors with: ③ | | | |
| M16 fastening thread | SACC-M16-SEAL CLM | 1430394 | 10 |
| Pg9 fastening thread | SACC-PG9-SEAL CLM | 1556320 | 10 |

Assembly tools for sensor/actuator cables

To achieve tight plug-in connections, we recommend using assembly tools. M12 and 7/8" circular plug-in connectors can be assembled using a torque screwdriver and plug attachment.

The benefits of the plug attachment become particularly clear when connecting the connectors to the distributor boxes. Thanks to the open design, it enables quick adjustment and installation even when space is at a premium.

The version for M12 connectors with hexagonal stainless steel knurl is also made from stainless steel. This prevents the connector knurls from being contaminated by corrosive materials.

For greater flexibility, screwdrivers with adjustable torque are also available. When used in conjunction with the adapter insert, they can also be used to accommodate the available plug attachments.



| | | Ordering data | | |
|--|---|---------------------------------------|-------------------------------|-------------|
| Description | | Type | Order No. | Pcs. / Pkt. |
| Torque screwdriver With a preset torque of 0.8 Nm and a 4 mm hexagonal drive | ① | TSD 08 SAC | 1212597 | 1 |
| Nut For assembling 7/8" plug-in connectors, with 4 mm hexagonal drive | ② | SAC BIT MIN-D25 | 1212512 | 1 |
| Torque screwdriver With preset torque of 0.4 Nm and 4 mm hexagonal drive | ③ | TSD 04 SAC | 1208429 | 1 |
| Nut For mounting M12 plug-in connectors with hexagonal stainless steel knurl, wrench size 14, with 4 mm hexagonal drive | ④ | SAC BIT M12-W14 | 1212513 | 1 |
| Torque screwdriver , accuracy according to standard EN ISO 6789 Adjustable from 0.3 - 1.2 Nm Adjustable from 1.2 - 3 Nm Adjustable from 3 - 6 Nm | ⑤ | TSD-M 1,2NM TSD-M 3NM TSD-M 6NM | 1212224 1212225 1212226 | 1 1 1 |
| Adapter insert For torque screwdrivers with adjustable torque, for accommodating plug attachments with 4 mm hexagonal drive | ⑥ | TSD-M SAC-BIT ADAPTER | 1212600 | 1 |

M5 to M12 circular plug-in connectors

Pin assignments

M5 flush-type plug-in connectors

Pin assignments

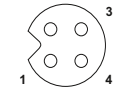

Socket, 3-pos.

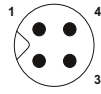

Plug, 3-pos.

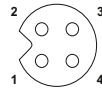

Socket, 4-pos.

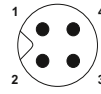

Plug, 4-pos.

Litz wire colors

| Pin | Wire color | | | |
|-----|------------|--|--------|--|
| | 3-pos. | | 4-pos. | |
| 1 | BN | | BN | |
| 2 | - | | WH | |
| 3 | BU | | BU | |
| 4 | BK | | BK | |

Assignment: M5 flush-type plugs/sockets

M8 flush-type plug-in connectors

Pin assignments



Socket, 3-pos.



Plug, 3-pos.



Socket, 4-pos.



Plug, 4-pos.



Socket, 6-pos.

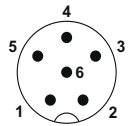

Plug, 6-pos.

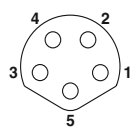

Socket, 5-pos.,
DeviceNet™, B-coded

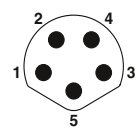

Plug, 5-pos.,
DeviceNet™, B-coded



Socket, 8-pos.

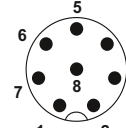

Plug, 8-pos.

Litz wire colors

| Pin | Wire color | | | | | | | |
|-----|------------|--|--------|--|--------|--|--------|--|
| | 3-pos. | | 4-pos. | | 6-pos. | | 8-pos. | |
| 1 | BN | | BN | | BN | | WH | |
| 2 | - | | WH | | WH | | BN | |
| 3 | BU | | BU | | BU | | GN | |
| 4 | BK | | BK | | BK | | YE | |
| 5 | - | | - | | GY | | GY | |
| 6 | - | | - | | PK | | PK | |
| 7 | - | | - | | - | | BU | |
| 8 | - | | - | | - | | RD | |

Assignment: M8 flush-type plugs/sockets

| Pin | Wire color | Signal DeviceNet™ |
|-----|------------|----------------------|
| 1 | Shield | Drain |
| 2 | RD | V+ |
| 4 | BK | V- |
| 3 | WH | CAN_H |
| 5 | BU | CAN_L |

Assignment: CANopen®/DeviceNet™

M12 flush-type plug-in connectors

Pin assignments

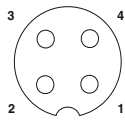

Socket, 4-pos., A-coded



Plug, 4-pos., A-coded



Socket, 5-pos., A-coded



Plug, 5-pos., A-coded



Socket, 8-pos.



Plug, 8-pos.

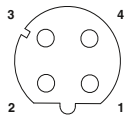

Socket, 4-pos., D-coded



Plug, 4-pos., D-coded



Socket, 5-pos., B-coded



Plug, 5-pos., B-coded



Socket, 12-pos.



Plug, 12-pos.

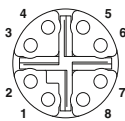

Socket, 8-pos., X-coded



Socket, 8-pos., Y-coded



Socket, 17-pos.



Plug, 17-pos.

Litz wire colors

| Pin | 4-pos., A-coded | 4-pos., D-coded |
|-----|-----------------|-----------------|
| 1 | BN | YE |
| 2 | WH | WH |
| 3 | BU | OG |
| 4 | BK | BU |
| - | - | - |

Assignment: M12 flush-type plugs/sockets

| Pin | 5-pos., A-coded | 5-pos., B-coded |
|-----|-----------------|-----------------|
| 1 | BN | BN |
| 2 | WH | WH |
| 3 | BU | BU |
| 4 | BK | BK |
| 5 | GY | GY |

Assignment: M12 flush-type plugs/sockets

| Pin | 8-pos. | 12-pos. |
|-----|--------|---------|
| 1 | WH | BN |
| 2 | BN | BU |
| 3 | GN | WH |
| 4 | YE | GN |
| 5 | GY | PK |
| 6 | PK | YE |
| 7 | BU | BK |
| 8 | RD | GY |
| 9 | - | RD |
| 10 | - | VT |
| 11 | - | GYPK |
| 12 | - | RDBU |

Assignment: M12 flush-type plugs/sockets

| Pin | Wire color | Signal PROFIBUS |
|-----|------------------|-----------------|
| 1 | - | - |
| 2 | GN | A cable |
| 3 | - | - |
| 4 | RD | B cable |
| 5 | Filler litz wire | - |

Shield on housing

Assignment: PROFIBUS

| Pin | Wire color | Signal CANopen® |
|-----|------------|-----------------|
| 1 | Shield | - |
| 2 | RD | - |
| 3 | BK | CAN_GND |
| 4 | WH | CAN_H |
| 5 | BU | CAN_L |

Shield on housing

Assignment: CANopen®

| Pin | Wire color | Signal DeviceNet™ |
|-----|------------|-------------------|
| 1 | Shield | Drain |
| 2 | RD | V+ |
| 3 | BK | V- |
| 4 | WH | CAN_H |
| 5 | BU | CAN_L |

Shield on housing

Assignment: DeviceNet™

| Pin | Wire color | Signal Ethernet |
|-----|------------|-----------------|
| 1 | WHOG | TD+ |
| 2 | WHGN | RD+ |
| 3 | OG | TD- |
| 4 | GN | RD- |

Shield on housing

Assignment: Ethernet

| Pin | 17-pos. |
|-----|---------|
| 1 | BN |
| 2 | BU |
| 3 | WH |
| 4 | GN |
| 5 | PK |
| 6 | YE |
| 7 | BK |
| 8 | GY |
| 9 | RD |
| 10 | VT |
| 11 | GYPK |
| 12 | RDBU |
| 13 | WHGN |
| 14 | BNGN |
| 15 | WHYE |
| 16 | YEEN |
| 17 | WHGY |

Assignment: M12 flush-type plugs/sockets

| Pin | Wire color | Signal INTERBUS |
|-----|------------|-----------------|
| 1 | YE | DO |
| 2 | GN | DI |
| 3 | GY | DI |
| 4 | PK | DI |
| 5 | BN | COM |
| - | WH | NC |

Shield on housing

Assignment: INTERBUS

| Pin | Wire color | Signal Ethernet |
|-----|------------|-----------------|
| 1 | WH | D1+ |
| 2 | OG | D1- |
| 3 | WH | D2+ |
| 4 | GN | D2- |
| 5 | WH | D4+ |
| 6 | BN | D4- |
| 7 | WH | D3- |
| 8 | BU | D3+ |

Assignment: Ethernet CAT6_A

M5 to M12 circular plug-in connectors

Pin assignments

M12 power flush-type plug-in connectors

Pin assignments



Socket, S-coded, 3+PE



Plug, A-coded, 3+PE



Socket, T-coded, 4-pos.



Plug, T-coded, 4-pos.

Litz wire colors

| Pin | 3+PE, S-cod. | Pin | 4-pos, T-cod. |
|-----|--------------|-----|---------------|
| 1 | BK1 | 1 | BN |
| 2 | BK2 | 2 | WH |
| 3 | BK3 | 3 | BU |
| PE | GNYE | 4 | BK |

Assignment: M12 flush-type plugs/sockets

7/8" flush-type plug-in connectors

Pin assignments



Socket, 3-pos.



Plug, 3-pos.



Socket, 4-pos.



Plug, 4-pos.



Socket, 5-pos.



Plug, 5-pos.

Litz wire colors

| Pin | 3-pos. | 4-pos. | 5-pos. |
|-----|--------|--------|--------|
| 1 | BK | BK | BK |
| 2 | BN | BU | BU |
| 3 | BU | BN | GNYE |
| 4 | - | WH | BN |
| 5 | - | - | WH |

Assignment: 7/8" flush-type plugs/sockets

THR processing notes

Information for THR processing

| | |
|--------------------------------|--------------------------------|
| PCB thickness | Max. 1.6 mm |
| Residual ring | Recommended: 0.5 mm |
| Overprinting on soldering mold | Residual ring diameter: 0.2 mm |
| Soldering mold thickness | 150 µm |
| Soldering profile | IEC 61760-3 |

Further information

| | |
|------------------|----------|
| RoHS conformance | Attained |
|------------------|----------|

X-ON Electronics

Largest Supplier of Electrical and Electronic Components

Click to view similar products for [Phoenix Contact](#) manufacturer:

Other Similar products are found below :

[1212619](#) [3240366](#) [1893300](#) [1582235](#) [1773093](#) [2814045](#) [2989433](#) [2963886](#) [2966537](#) [FFKDS/V-2.54](#) [2313944](#) [2834546](#) [DFK-PC 5/ 2-ST-7,62](#) [2834520](#) [2834407](#) [1687312](#) [3056145](#) [0902221](#) [1775619](#) [1674998](#) [2858894](#) [443023](#) [2905235](#) [2833547](#) [3240098](#) [0825544:3](#) [2905234](#) [0201391](#) [0201414](#) [CRIMPFOX 16 S](#) [CRIMPSET 25](#) [7001438](#) [MC 1,5/ 9-ST-3,5](#) [1840434](#) [ETD-BL-1T-F-300S](#) [MCR-1CLP-I-I-00](#) [MCR-4CLP-I-I-00](#) [MCR-DAC 8-I- 4-BUS](#) [MCR-SWS-I](#) [MCV 1,5/ 3-G-3,81](#) [1803439](#) [FL EPA WMS](#) [FLK 50/EZ-DR/ 400/KONFEK/S](#) [FLS PB M12 DO 8 M12-2A](#) [PPS CD BLADE](#) [PR1-RSC3-LV-120AC/21](#) [PSI-MOS-DNET CAN/FO 660/BM](#) [PSM-ME-RS232/RS232-P](#) [PSM PTK-4](#) [PSM-SET-FSMA/4-KT](#) [PT 2X2- 5DC-ST](#) [1201280](#)