



ESDB12VADB

Transient Voltage Suppressor

Descriptions

The ESDB12VADB is a Bi-directional transient voltage suppressor (TVS) to protect sensitive electronic components from electrostatic discharge (ESD). It is particularly well-suited for cellular phones, PMP, MID, PDA, digital cameras and other electronic equipment.

The ESDB12VADB is available in DFN1x0.6-2L package. Standard products are Pb-free and Halogen-free.

Features

- Small Body Outline Dimensions
- Low reverse stand-off voltage: 12V
- Ultra Low capacitance
- Low leakage current
- Transient protection for each line according to IEC61000-4-2 (ESD): $\pm 30\text{kV}$ (contact discharge)

Applications

- Display Ports
- MDDI Ports
- Cellular Handsets and Accessories
- Computer and Peripherals

Marking Code



Top View

DFN1x0.6-2L

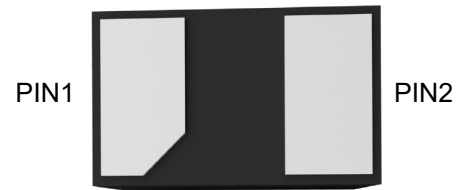

Bottom View

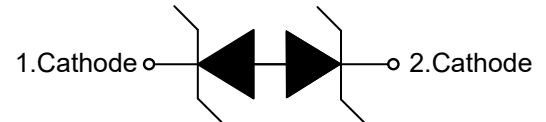



Absolute Maximum Ratings ($T_A=25^\circ\text{C}$)

Parameter		Symbols	Value	Unit
IEC61000-4-2 ESD Voltage	Air Model	V_{ESD}	± 30	KV
	Contact Model		± 30	
Junction Temperature		T_J	125	$^\circ\text{C}$
Operating Temperature Range		T_{OPR}	-40 to +125	$^\circ\text{C}$
Storage Temperature Range		T_{STG}	-55 to +150	$^\circ\text{C}$

Electrical Parameter

Symbol	Parameter
V_C	Clamping Voltage @ I_{PP}
I_{PP}	Peak Pulse Current
V_{BR}	Breakdown Voltage @ I_T
I_T	Test Current
I_R	Reverse Leakage Current @ V_{RWM}
V_{RWM}	Reverse Standoff Voltage

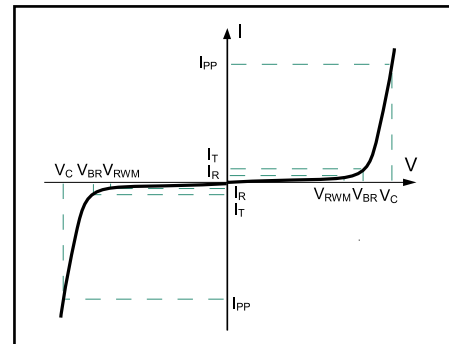

V-I characteristics for a Bi-directional TVS

Electrical Characteristics ($T_A=25^\circ\text{C}$)

Parameter	Symbols	Min.	Max.	Unit
Reverse stand-off voltage	V_{RWM}	--	12	V
Forward Voltage at $I_F = 10\text{ mA}$	V_F	--	1.1	V
Reverse Leakage Current at $V_{RWM} = \pm 12\text{ V}$	I_R	--	0.1	μA
Breakdown Voltage at $I_T = 1\text{ mA}$	$V_{R(BR)}$	13.3	16	V
Peak Pulse Current $t_p = 8/20\mu\text{s}$	I_{PP}	--	3.5	A
Clamping Voltage at $I_{PP} = 1\text{ A}$, $t_p=8/20\mu\text{s}$ at $I_{PP} = 3.5\text{ A}$, $t_p=8/20\mu\text{s}$	V_C	--	13 24	V
Junction Capacitance at $V_R = 0\text{ V}$, $f = 1\text{ MHz}$	C_J	--	9.5	pF



Typical Characteristic Curves

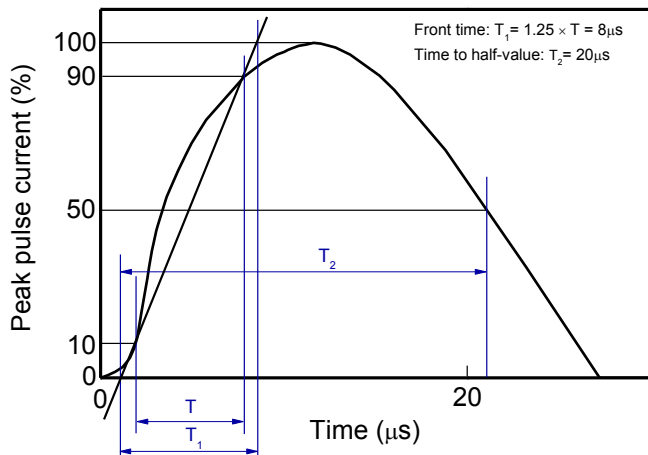

8/20 μs waveform per IEC61000-4-5

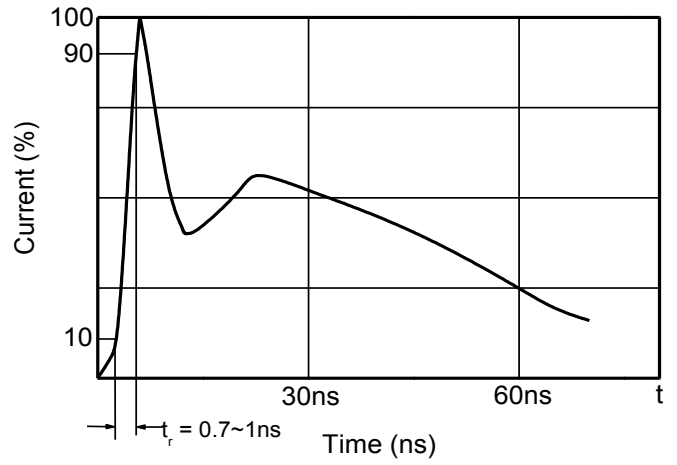

Contact discharge current waveform per IEC61000-4-2



ESDB12VADB Transient Voltage Suppressor

Package Outline

DFN1x0.6-2L-0011

Dimensions in mm

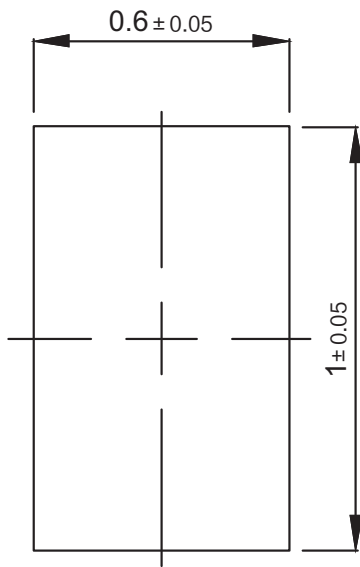

TOP VIEW

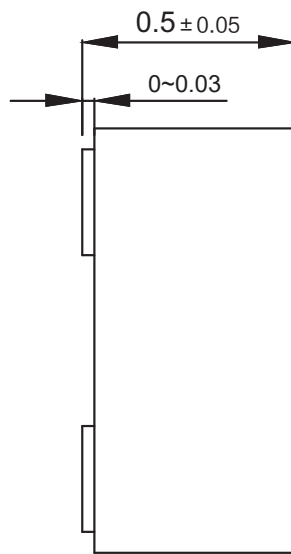

SIDE VIEW

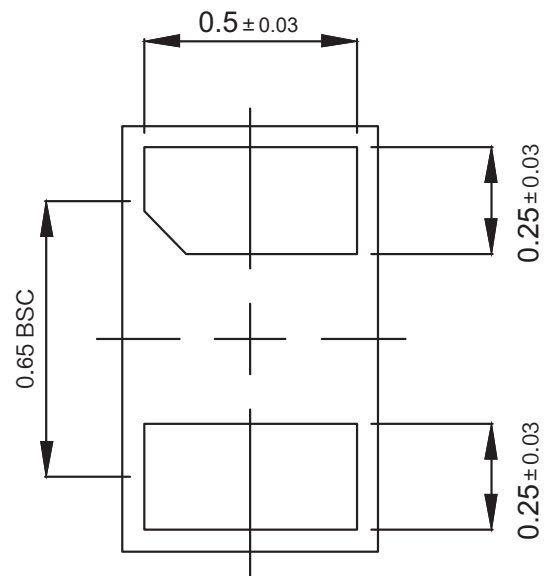

BOTTOM VIEW

Ordering Information

Device	Package	Shipping
ESDB12VADB	DFN1x0.6-2L	10,000PCS/Reel&7inches

X-ON Electronics

Largest Supplier of Electrical and Electronic Components

Click to view similar products for [ESD Suppressors / TVS Diodes](#) category:

Click to view products by [Pingjingsemi](#) manufacturer:

Other Similar products are found below :

[60KS200C](#) [D18V0L1B2LP-7B](#) [D5V0F4U5P5-7](#) [NTE4902](#) [P4KE27CA](#) [P6KE11CA](#) [P6KE8.2A](#) [SA60CA](#) [SA64CA](#) [SMBJ12CATR](#)
[SMBJ33CATR](#) [SMBJ6.5A](#) [SMBJ8.0A](#) [ESD101-B1-02ELS E6327](#) [ESD112-B1-02EL E6327](#) [ESD7451N2T5G](#) [19180-510](#) [CPDT-5V0USP-](#)
[HF](#) [3.0SMCJ33CA-F](#) [3.0SMCJ36A-F](#) [HSPC16701B02TP](#) [JANTX1N6126A](#) [D3V3Q1B2DLP3-7](#) [D55V0M1B2WS-7](#) [SCM1293A-04SO](#)
[ESD200-B1-CSP0201 E6327](#) [SM12-7](#) [CEN955 W/DATA](#) [VESD12A1A-HD1-GS08](#) [CPDQC5V0-HF](#) [D1213A-01LP4-7B](#) [ESD101-B1-02EL](#)
[E6327](#) [AOZ8808DI-03](#) [5KP15A](#) [5KP48A](#) [5KP90A](#) [ESD3V3D7-TP](#) [15KPA36A-LF](#) [P4KE56CA](#) [P4KE68A](#) [P4KE91CATR](#) [P6KE120A](#)
[P6KE13CA](#) [P6KE43CA](#) [P6KE6.8CA](#) [P6KE8.2](#) [P6SMBJ20CA](#) [JANTX1N6072A](#) [SR2835ESKG](#) [SA90CA](#)