

PS10U80S&PS10U80FS

10.0AMPS. SCHOTTKY BARRIER RECTIFIERS

FEATURE

- . High current capability
- . Ultra low forward voltage drop
- . Low power loss, high efficiency
- . High surge capability
- . High temperature soldering guaranteed
260°C /10seconds, 0.25"(6.35mm)from case.

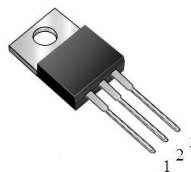

TO-220AB
PS10U80S

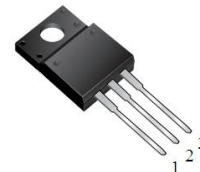

ITO-220AB
PS10U80FS

MECHANICAL DATA

- . Case: Molded with UL-94 Class V-0 recognized
Flame Retardant Epoxy
- . Mounting position: any

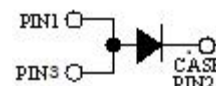

Single phase, half wave, 60Hz, resistive or inductive load.

For capacitive load, derate current by 20%

MAXIMUM RATINGS (T_C=25°C unless otherwise noted)

| Parameter | Symbol | PS10U80S&PS10U80FS | Units |
|---|----------------|--------------------|-------|
| Maximum Recurrent Peak Reverse Voltage | V_{RRM} | 80 | V |
| Maximum RMS Voltage | V_{RMS} | 56 | V |
| Maximum DC blocking Voltage | V_{DC} | 80 | V |
| Maximum Average Forward Rectified Current at T _C =100°C <i>Total device</i> | $I_{F(AV)}$ | 10.0 | A |
| Peak Forward Surge Current 8.3ms single half sine-wave superimposed on rated load (JEDEC method) <i>Terminals 1 and 3 short circuited</i> | I_{FSM} | 150.0 | A |
| Typical Junction Capacitance (Note 1) | C_J | 460 | pF |
| Operation Junction Temperature and Storage Temperature | T_J, T_{STG} | -55 to +150 | °C |

ELECTRICAL CHARACTERISTICS (T_C=25°C unless otherwise noted)

| Parameter | Symbol | Typ | Max | Units |
|--|--------|--------------|--------------|---|
| Maximum Forward Voltage at 5.0A DC at 10.0A DC | V_F | 0.50 0.60 | --- 0.65 | V |
| Maximum DC Reverse Current at rated DC blocking voltage | I_R | --- --- | 0.25 10.0 | mA |
| | | | | @T _A =25°C @T _A =100°C |

THERMAL CHARACTERISTICS (T_C=25°C unless otherwise noted)

| Parameter | Symbol | PS10U80S | PS10U80FS | Units |
|-------------------------------------|------------|----------|-----------|-------|
| Typical Thermal Resistance (Note 2) | $R_{(JC)}$ | 2.0 | 3.0 | °C/W |

Notes:

1. Measured at 1.0 MHz and applied reverse voltage of 4.0Vdc
2. Thermal Resistance from Junction to Case

RATING AND CHARACTERISTIC CURVES

FIG.1-TYPICAL FORWARD CURRENT DERATING CURVE

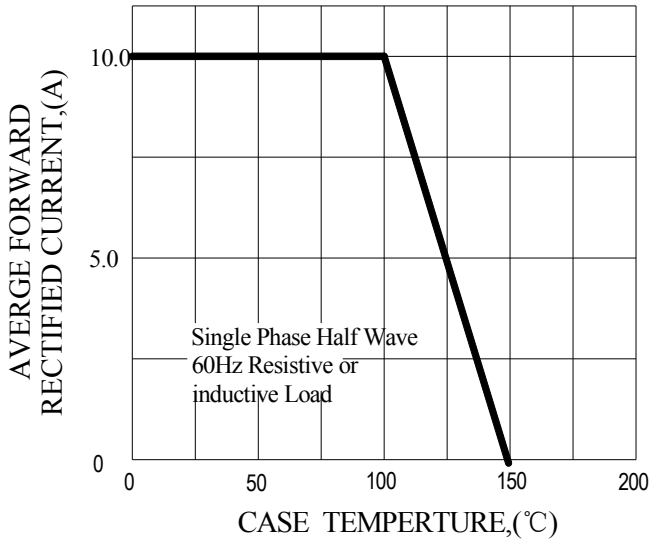

FIG.2-TYPICAL INSTANTANEOUS FORWARD CHARACTERISTICS

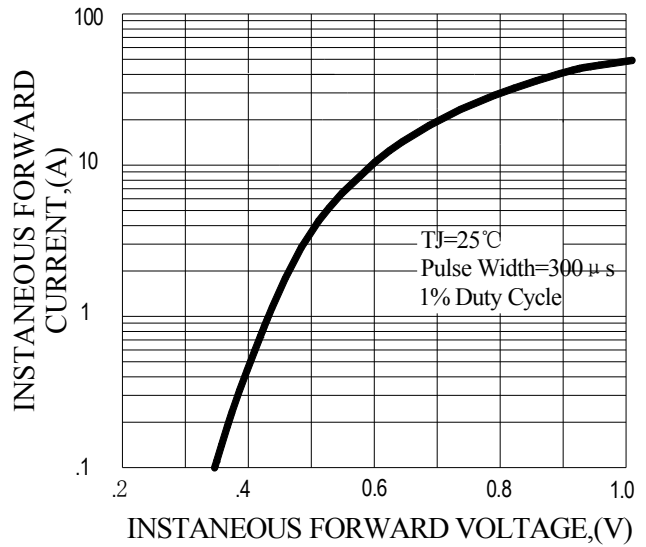

FIG.3-MAXIMUM NON-REPETITIVE FORWARD SURGE CURRENT

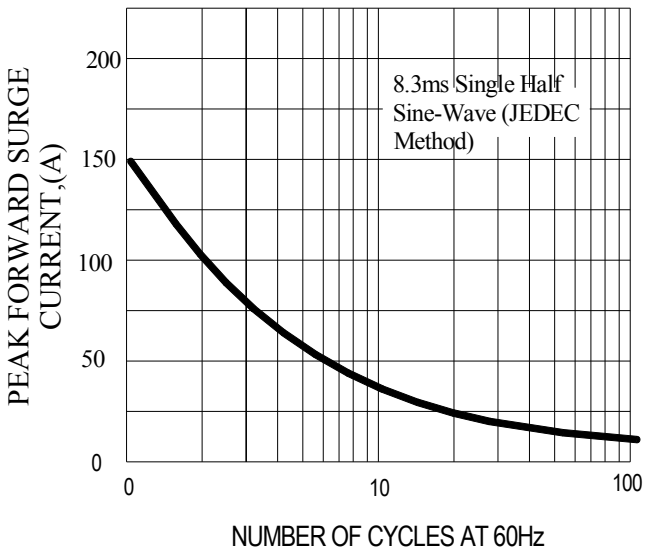
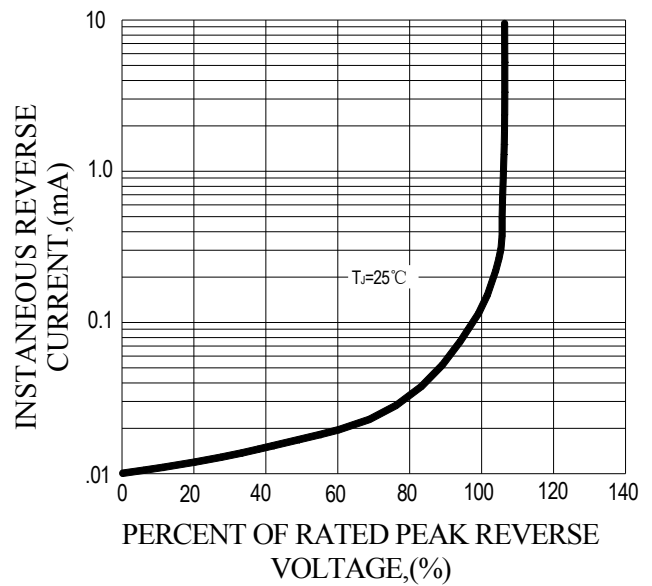
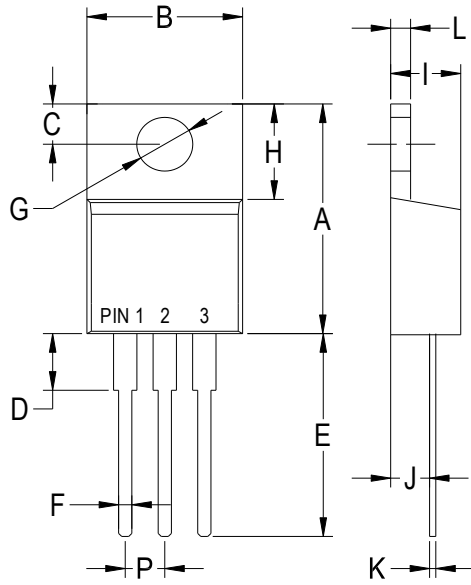

FIG.4-TYPICAL REVERSE CHARACTERISTICS



PACKAGE OUTLINE DIMENSIONS

TO-220AB



| TO-220AB | | |
|----------|--------------|--------------|
| Dim | Min | Max |
| A | .573 (14.55) | .603 (15.32) |
| B | — | .412 (10.5) |
| C | .103 (2.62) | .113 (2.87) |
| D | .140 (3.56) | .160 (4.06) |
| E | .510 (13.0) | .560 (14.3) |
| F | .027 (0.68) | .037 (0.94) |
| G | .148 (3.74) | .154 (3.91) |
| H | .230 (5.84) | .270 (6.86) |
| I | .175 (4.44) | .185 (4.86) |
| J | .100 (2.54) | .110 (2.79) |
| K | .014 (0.35) | .025 (0.64) |
| L | .045 (1.14) | .055 (1.40) |
| P | .095 (2.41) | .105 (2.67) |

Dimensions in inches and (millimeters)

ITO-220AB

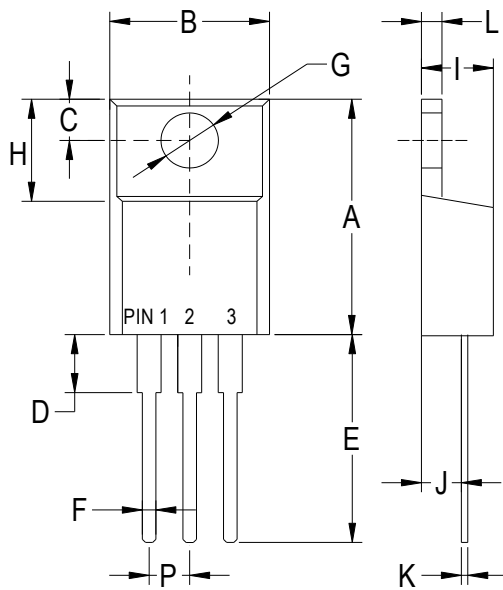

| ITO-220AB | | |
|-----------|-------------|-------------|
| Dim | Min | Max |
| A | .571 (14.5) | .610 (15.5) |
| B | .383 (9.72) | .406 (10.3) |
| C | .110 (2.80) | .126 (3.20) |
| D | .133 (3.38) | .162 (4.10) |
| E | .512 (13.0) | .551 (14.0) |
| F | .028 (0.70) | .035 (0.90) |
| G | .114 (2.90) | .138 (3.50) |
| H | .268 (6.80) | .291 (7.40) |
| I | .162 (4.10) | .185 (4.70) |
| J | .102 (2.60) | .110 (2.80) |
| K | .018 (0.45) | .026 (0.65) |
| L | .097 (2.46) | .113 (2.86) |
| P | .890 (2.25) | .113 (2.85) |

Dimensions in inches and (millimeters)

X-ON Electronics

Largest Supplier of Electrical and Electronic Components

Click to view similar products for [pingwei manufacturer](#):

Other Similar products are found below :

[KBJ1008](#) [SB5150L](#) [P6SMBJ68CA](#) [GBU410](#) [DB207S](#) [KBJ1006](#) [SB5P45](#) [KBJ1010](#) [GBL410](#) [GBU408](#) [PS40U60CT](#) [MBR20200CT](#) [D16-](#)
[DSS16](#) [MUR1040CT](#) [MBR30100CT](#) [MBR20200FCT](#) [MBR20100CT](#) [MBR20150FCT](#) [FR107](#) [GBU806](#) [HBRA10100BCT](#) [SB2200](#)
[MUR1620CTR](#) [SB5150](#) [GBU1006](#) [1N5404](#) [6A2](#) [PS10U100S](#) [GS1G](#) [GBJ2010](#) [GBU606](#) [16N65MF](#) [20N65NF](#) [HER303](#) [6A1](#) [1N5395](#)
[SF16](#) [18N50MF](#) [MBR30100FCT](#) [MUR1640FCT](#) [MBR30200FCT](#) [SS510B](#) [GBU406](#) [GBP206](#) [KBJ406](#) [100N10NF](#) [MBR10200FCT](#)
[GBU808](#) [SS3T10A](#) [PS40U100CT](#)