

# TERMINAL BLOCKS

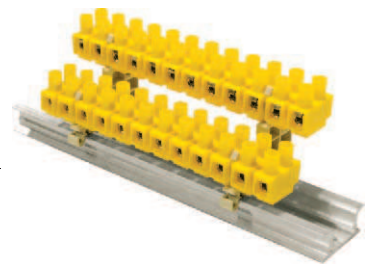
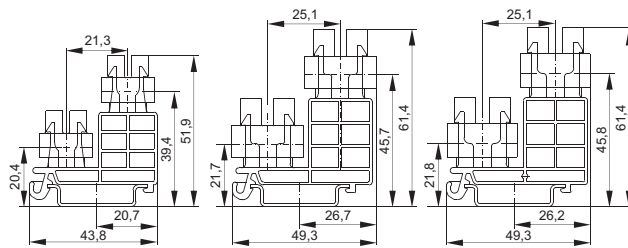

P2, ZKU, ZKR

TYPE	P2-4N	P2-10N	P2-16N
Catalogue number	45-272	45-274	45-276
Colour	yellow-1 ● white-2 ○ black-3 ● grey-8 ●	yellow-1 ● white-2 ○ black-3 ● grey-8 ●	yellow-1 ● white-2 ○ black-3 ● grey-8 ●
Use	TLZ-4N on TS35 rail assembly	TLZ-10N on TS35 rail assembly	TLZ-16N on TS35 rail assembly
Insulating material	polyamide	polyamide	polyamide
Ambient temperature	-25...+100°C	-25...+100°C	-25...+100°C
Package	10pcs.	10pcs.	10pcs.

## ZKU complete short-circuiting connectors

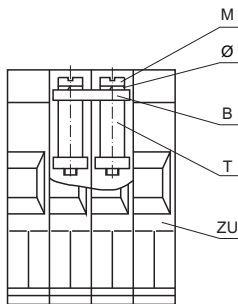

- B – bar
- T – sleeve
- Ø – spring washer
- M – screw
- ZU – terminal

A complete short-circuiting connector is used for short-circuiting current circuits of the ZUG-G and ZG-G thread terminal blocks installed on the TS mounting rails. The ZKM short-circuiting connector is used for short circuiting the current circuits of the BM terminal blocks.

## ZKR-10 complete, movable short-circuiting connectors

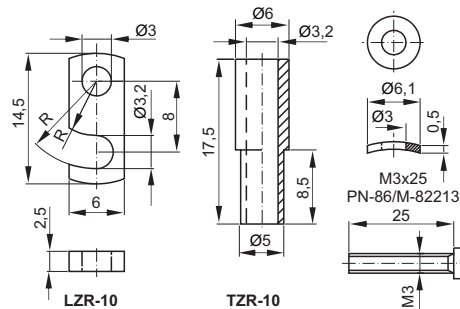

The short circuiting connector fits the terminals ZUG-G10, ZUG-G/P, ZUG-G/PG, ZUG-G/D, ZUG-G/DG. Package: 50pcs.

## ZKU complete short-circuiting connectors

The type of the complete short-circuiting connector depends on the number of terminal blocks, e.g. ZKU4/2 is used for short circuiting two adjacent ZUG-G4 terminal blocks. ZKU-10/5 is a short circuiting connector for five ZUG-G10 terminal blocks. Material - copper.



### No. of short circuited lines

Size		2,5	4	10	16	25	35	70	120	ZKM	ZKR
Type	<b>2</b>	ZKU-2,5/2	ZKU-4/2	ZKU-10/2	ZKU-16/2	ZKU-25/2	ZKU-35/2	ZKU-70/2	ZKU-120/2	ZKM-4/2	ZKR-10
Catalogue number		42-0020	42-0120	42-0220	42-0320	42-0420	42-0520	42-0620	42-0720	42-1120	42-2290
Package		50	50	50	50	20	20	10	5	50	50
Type	<b>3</b>	ZKU-2,5/3	ZKU-4/3	ZKU-10/3	ZKU-16/3	ZKU-25/3	ZKU-35/3	—	—	ZKM-4/3	—
Catalogue number		42-0030	42-0130	42-0230	42-0330	42-0430	42-0530	—	—	42-1130	—
Package		25	25	25	25	10	10	—	—	25	—
Type	<b>4</b>	ZKU-2,5/4	ZKU-4/4	ZKU-10/4	ZKU-16/4	—	—	—	—	ZKM-4/4	—
Catalogue number		42-0040	42-0140	42-0240	42-0340	—	—	—	—	42-1140	—
Package		25	25	25	25	—	—	—	—	25	—
Type	<b>5</b>	ZKU-2,5/5	ZKU-4/5	ZKU-10/5	ZKU-16/5	—	—	—	—	ZKM-4/5	—
Catalogue number		42-0050	42-0150	42-0250	42-0350	—	—	—	—	42-1150	—
Package		20	20	20	20	—	—	—	—	20	—
Type	<b>10</b>	ZKU-2,5/10	ZKU-4/10	ZKU-10/10	ZKU-16/10	—	—	—	—	ZKM-4/10	—
Catalogue number		42-0000	42-0100	42-0200	42-0300	—	—	—	—	42-1100	—
Package		10	10	10	10	—	—	—	—	10	—

\* Note: We offer only full packages

## **X-ON Electronics**

Largest Supplier of Electrical and Electronic Components

*Click to view similar products for [Fixed Terminal Blocks](#) category:*

*Click to view products by [POKOJ](#) manufacturer:*

Other Similar products are found below :

[00175550202](#) [MBE-1512](#) [MBE-1520](#) [MBE-154](#) [MBE-156](#) [MBES-1510](#) [MBES-153](#) [MBES-156](#) [MH-2512](#) [MHE-132](#) [MHE-133](#) [MHE-163](#)  
[MI-254 \(35\)](#) [MI-272](#) [8739](#) [880507](#) [880508](#) [MPT-275](#) [1546551-6](#) [ELM023100](#) [ELM10110G](#) [ELVD12100](#) [BA311TU](#) [BA411SU](#) [MV-152](#)  
[MV-253/NCNOC](#) [MV-254-D](#) [MV-255](#) [MV-462](#) [MV-472](#) [MV-493](#) [MVE-252](#) [MVE-253](#) [MVE-258](#) [MVE-273](#) [MVEB-153](#) [1700096](#)  
[1702246](#) [1705142](#) [1712417](#) [1713020](#) [1713088](#) [1776118-2](#) [1790852](#) [1-796689-8](#) [1-796692-6](#) [1800001](#) [1800114](#) [1823215](#) [1838462](#)