

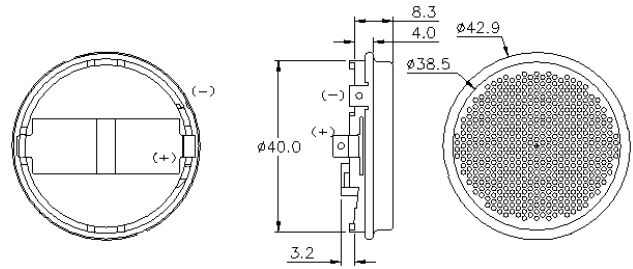

Dimensions: dimensions are in mm



Transmitting Sound Pressure Level

Tested under 300Vac pk-pk, 200Vdc bias @50 cm

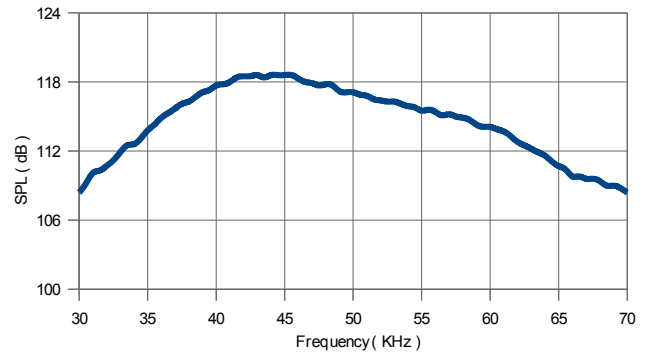

Specification

500ES430	Transceiver
Center Frequency	50.0±1.0KHz
Transmitting Sound Pressure Level at 50.0KHz; 0dB re 20µPa per 300Vac pk-pk, 200Vdc bias at 50 cm	116 dB min.
Receiving Sensitivity at 50.0KHz, 200Vdc bias, 0dB = 1 volt/Pa (0dB =1 volt/µbar)	-43 dB min. (-63 dB) min.
Capacitance at 1KHz ±20%	400 - 500 pF
Suggested DC Bias Voltage	200 V
Suggested AC Driving Voltage	300V pk-pk
Maximum Combined Voltage	400V
Total Beam Angle	-6dB 13° typical
Operation Temperature	0 to 60°C
Standard Finish	
Foil (Diaphragm)	See below
Housing	See below

All specification taken typical at 25°C

Models available

Model	Foil	Housing
500ES43AB	Aluminum	Black Painted Steel
500ES43AS	Aluminum	SUS 304
500ES43GB	Gold	Black Painted Steel
500ES43GS	Gold	SUS 304

Receiving Sensitivity: Tested under 200Vdc bias

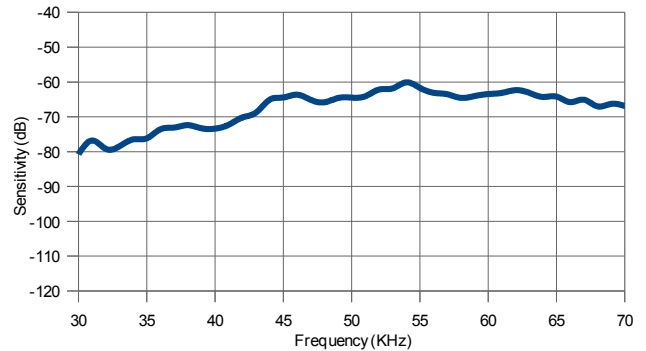

Beam Angle: Tested at 50.0Khz frequency

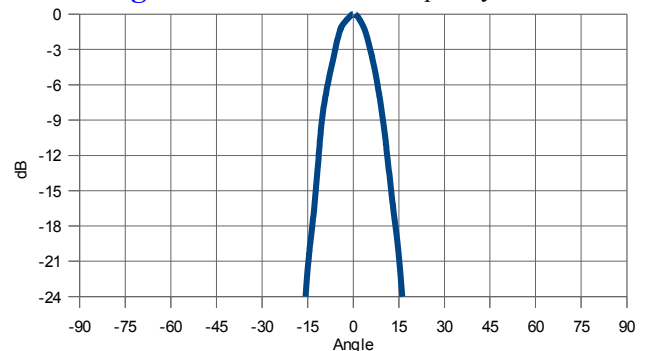

S. Square Enterprise Company Limited
Pro-Wave Electronics Corporation

[Http://www.pro-wave.com.tw](http://www.pro-wave.com.tw) ; E-mail: sales@pro-wave.com.tw ; Tel: 886-2-22465101 ; Fax: 886-2-22465105

X-ON Electronics

Largest Supplier of Electrical and Electronic Components

Click to view similar products for [Proximity Sensors](#) category:

Click to view products by [Pro-Wave Electronics](#) manufacturer:

Other Similar products are found below :

[01.001.5653.1](#) [70.340.1028.0](#) [70.360.2428.0](#) [70.364.4828.0](#) [70.810.1053.0](#) [72.360.1628.0](#) [73.363.6428.0](#) [8027AL20NL2CPXX](#) [FYCC8E1-2](#)
[9221350022](#) [922AA2W-A9P-L](#) [PLS2](#) [GL-12F-C2.5X10\(LOT3\)](#) [972AB2XM-A3N-L](#) [972AB3XM-A3P-L](#) [PS3251](#) [980659-1](#) [QT-12](#) [E2E2-](#)
[X5M41-M4](#) [E2E-X14MD1-G](#) [E2E-X2D1-G](#) [E2EX2ME2N](#) [E2EX3D1SM1N](#) [E2E-X4MD1-G](#) [E2E-X5E1-5M-N](#) [E2E-X5Y2-N](#) [E2E-X7D1-](#)
[M1J-T-0.3M-N](#) [E2FMX1R5D12M](#) [E2K-F10MC1](#) [5M](#) [EH-302](#) [EI3010TBOP](#) [EI5515NPAP](#) [MS605AU](#) [EP175-32000](#) [IFRM04N35B1/L](#)
[IFRM04P1513/S35L](#) [IFRM06P1703/S35L](#) [IFRM08P1501/S35L](#) [IFRM12N17G3/L](#) [IFRM12P17G3/L](#) [IFRM12P3502/L](#) [IFRM12P37G1/S14L](#)
[ILFK12E9189/I02](#) [ILFK12E9193/I02](#) [IMM2582C](#) [OISN-013](#) [25.161.3253.0](#) [25.332.0653.1](#) [25.352.0653.0](#) [25.352.0753.0](#)