



Encased protection transformers designed mainly for fitting into devices using T-35 bus. Elegant casing, featuring spring bracket significantly facilitates and speeds up attaching. The transformers are made with Class II insulation and protection grade IP20 (N-series), IP30 or IP40 (PSS10, PSS20). Maximum ambient temperature 40°C, thermal class of insulation B (130°C). Protected against overload and short circuit on secondary with PTC. To reset the protecting device disconnect the mains for 10 seconds. Manufactured in compliance with EN 61558-2-4 and EN 61558-2-6.

Rated power: 10 – 100VA

Rated voltage PRI: 110 – 500V 50/60 Hz

Rated voltage SEC: 6 – 250V

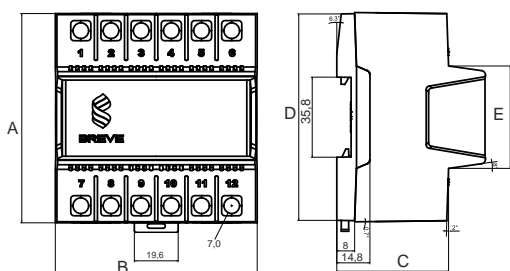
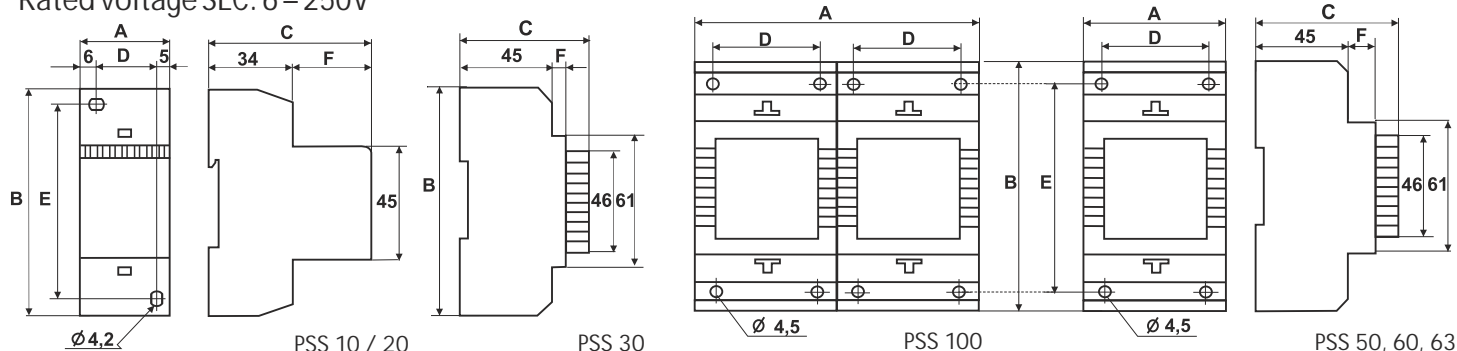

PSS 50N, PSS 63N, PSS 80N



PSS



PSS N

Type	Article number	Power [VA]	Dimensions [mm]					Weight [kg]
			A	B	C	D	E	
PSS 10 230/ 24V	16024-0150	10	35	92	66	24	79	0,32
PSS 20 230/ 24V	16024-0178	20	53	110	66	40	88	0,56
PSS 30 230/ 12V	16012-9983	30	72	110	63	52	98	0,9
PSS 30 230/ 24V	16024-9997	30	72	110	63	52	98	0,9
PSS 50 230/ 12V	16012-9981	50	72	110	72	52	98	1,1
PSS 50 230/ 24V	16024-9994	50	72	110	72	52	98	1,1
PSS 50N 230/ 12V	16012-9905	50	94	90	50	92	46	1,1
PSS 50N 230/ 24V	16024-9888	50	94	90	50	92	46	1,1
PSS 60 230/ 24V	16024-9938	60	72	110	72	52	98	1,2
PSS 63 230/ 12V	16012-9976	63	72	110	72	52	98	1,2
PSS 63 230/ 24V	16024-9979	63	72	110	72	52	98	1,2
PSS 63N 230/ 12V	16012-9907	63	94	90	50	92	46	1,1
PSS 63N 230/ 24V	16024-9890	63	94	90	50	92	46	1,1
PSS 80N 230/ 12V	16012-9906	80	94	90	50	92	46	1,3
PSS 80N 230/ 24V	16024-9889	80	94	90	50	92	46	1,3
PSS 100 230/ 12V	16012-9975	100	144	110	72	52	98	2,2
PSS 100 230/ 24V	16024-9973	100	144	110	72	52	98	2,2

As a result of constant development of product construction and changes concerning technical requirements, Breve Tufvassons reserves the right to change the parameters mentioned above.

## X-ON Electronics

Largest Supplier of Electrical and Electronic Components

*Click to view similar products for [Current Transformers](#) category:*

*Click to view products by [Breve Tufvassons](#) manufacturer:*

Other Similar products are found below :

[MP3500](#) [BV UI 302 0156](#) [45029](#) [BV EI 302 2863](#) [BV EI 303 2809](#) [BV EI 303 3060](#) [BV EI 305 2309](#) [BV EI 306 3604](#) [BV EI 481 1295](#) [BV EI 481 1325](#) [BV UI 301 0133](#) [BV UI 302 0144](#) [BV UI 302 0161](#) [BV UI 304 0019](#) [BV UI 304 0129](#) [BV UI 304 0159](#) [BV UI 304 0173](#) [TI-EF16-2X4V-4W](#) [SPCT62/40150/5AVA3CL1](#) [SPCT62/30100/5AVA1CL1](#) [SPCT62/3075/5AVA1CL3](#) [SPCT62/40150/5AVA1.5CL1](#) [SPCT62/40200/5AVA2.5CL0.5](#) [SPCT62/40300/5AVA3CL0.5](#) [CTD-KIT](#) [44013](#) [44017](#) [44021](#) [44098](#) [44101](#) [44134](#) [44171](#) [44174](#) [44178](#) [44180](#) [44248](#) [44250](#) [44278](#) [44339](#) [44340](#) [44373](#) [44375](#) [44376](#) [44378](#) [44379](#) [44436](#) [44831](#) [B82801B0925A200](#) [PA3655NL](#) [PA3828NL](#)