



Data Sheet	Insert PUI Audio Part Number
------------	------------------------------

Features:

- Wide 6 to 16 VDC operating voltage range
- Includes removable wash tab
- Small 12mm diameter with high 85 dB @ 10cm output

Specifications

Parameters	Values	Units
Rated Voltage	12	VDC
Operating Voltage Range	6 ~ 16	VDC
Current Draw at Rated Voltage	30	mA
Minimum SPL @ 10cm	85	dBA
Resonant Frequency	2,300 ±300	Hz
Tone or Pulse Rate	Continuous Tone	-
Housing Material	PBT	-
Terminal Material	Gold-plated Brass	-
Weight	2	Grams
Acceptable Soldering Methods	Hand Solder, Wave Solder	See page 2 for soldering information
Environmental Compliances	RoHS/REACH	-
Storage Temperature	-30 ~ +80	°C
Operating Temperature	-20 ~ +70	°C

Measurement Method

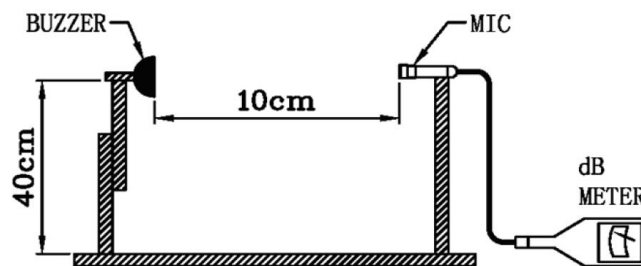
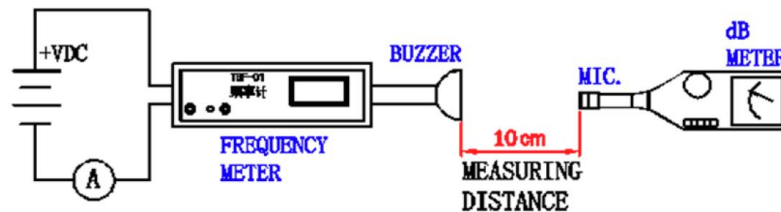

Typical SPL and Current Draw vs Input Voltage

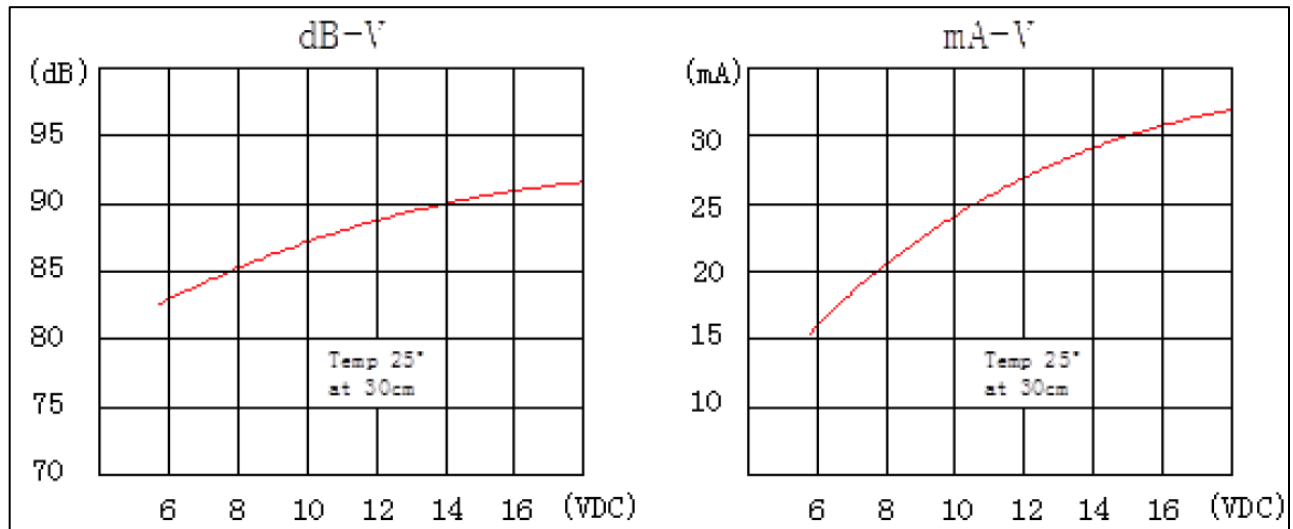

Recommended Wave Soldering Procedure

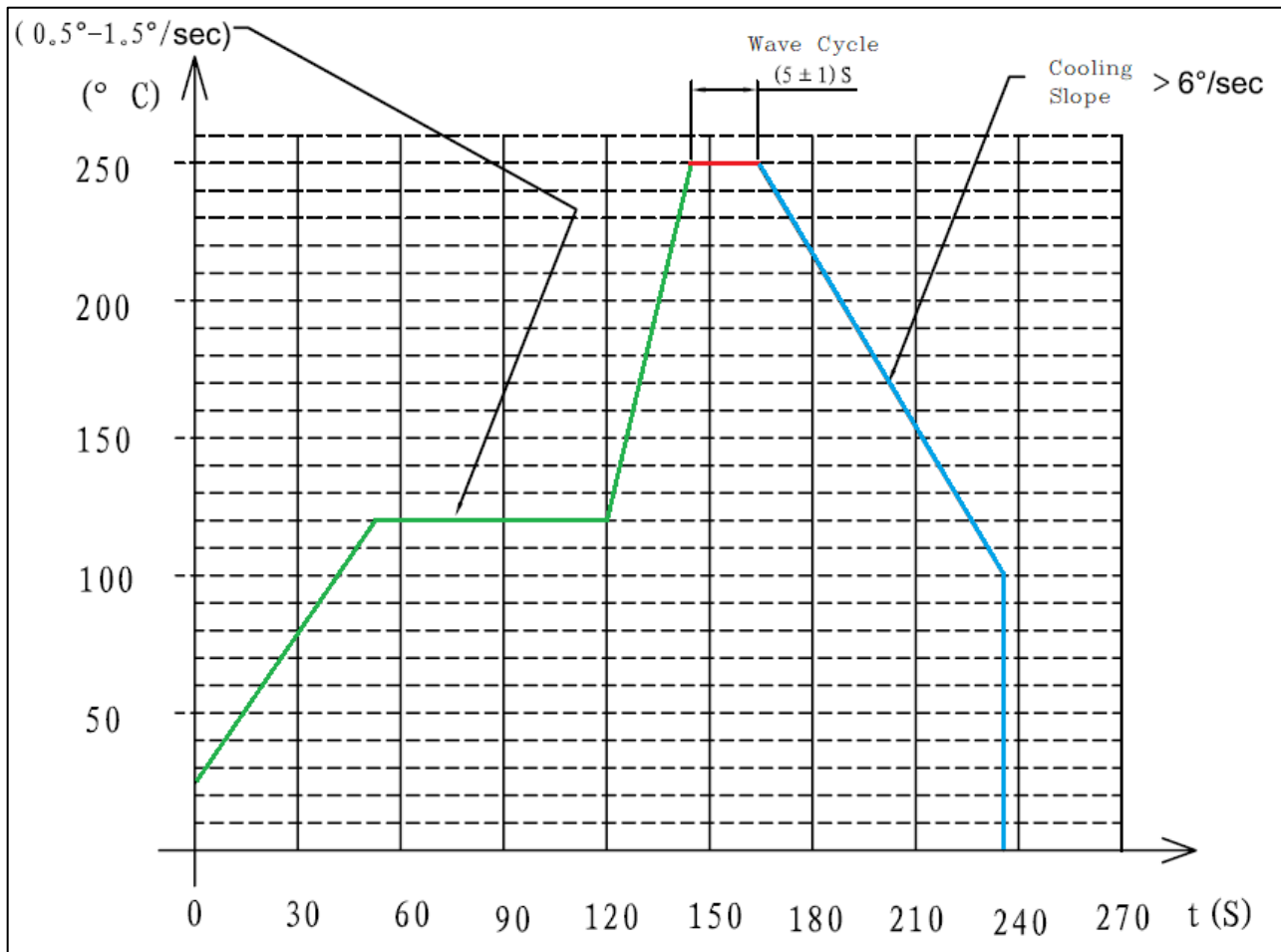

Reliability Testing

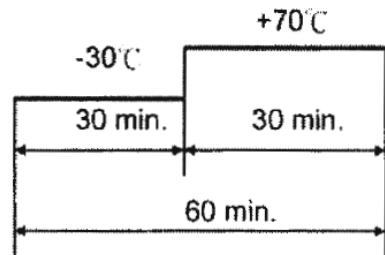
Type of Test	Test Specifications
High Temperature Test	96 hours at 80°C
Low Temperature Test	96 hours at -30°C
Humidity Test	96 hours at 40°C with relative humidity at 98%
Temperature Cycle Testing	The part is subjected to 10 cycles of the following test cycle: 
Vibration Test	The part is subjected to a vibration amplitude of 1.5mm with 10 to 55 Hz vibration frequency to each of the 3 axes (X, Y, Z) for 2 hours each.
Drop Test	The part is dropped from a height of 75 cm onto a 40mm thick wood board 3 times in each of the 3 axes (X, Y, Z) for a total of 9 drops.

After each test, the part shall meet specifications without any damage to appearance or performance. SPL shall be ± 10 dB when compared to the initial measurement.

Dimensions (4.5mm long pin is positive, polarity is also indicated on the wash tab)

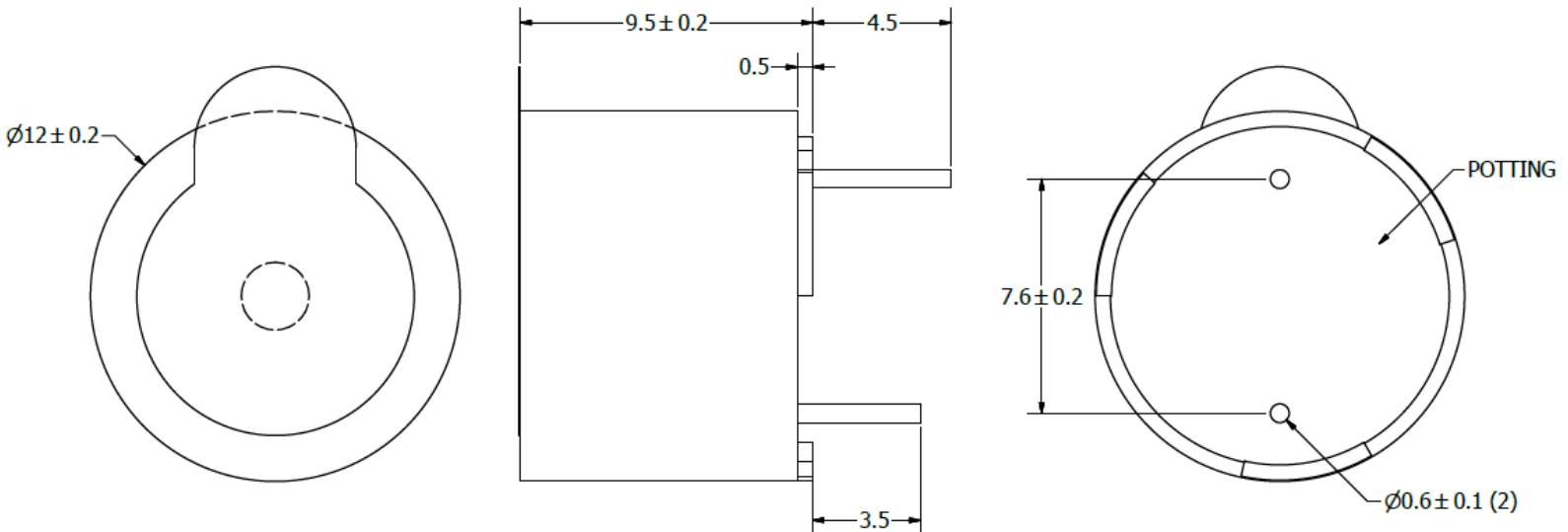

Specifications Revisions

Revision	Description	Date
-	Released from Engineering	6/25/2014
A	Revised Operating Voltage Range	3/16/2021

Note:

1. Unless otherwise specified:
 - A. All dimensions are in millimeters.
 - B. Default tolerances are $\pm 0.5\text{mm}$ and angles are $\pm 3^\circ$.
2. Specifications subject to change or withdrawal without notice.
3. This part is ROHS 2015/863/EU compliant. (Exemption 7c-1 for piezo type).

X-ON Electronics

Largest Supplier of Electrical and Electronic Components

Click to view similar products for [Piezo Buzzers & Audio Indicators](#) category:

Click to view products by [PUI Audio](#) manufacturer:

Other Similar products are found below :

[6-4](#) [68S1240-PA](#) [MBA-624](#) [FDG06PSLLF](#) [FDG111PLF](#) [F/EM12PLF](#) [F/NRMB 24 BLACK LF](#) [PF-35N29WQ](#) [PFD-21A29W](#) [PFD-27A35PQ](#) [PL-21N30WQ](#) [PL-27A35PSQ](#) [PLD-21N30W](#) [PLD-21N30WQ](#) [PS-531Q](#) [PT-3534FP](#) [EBPT-401](#) [B822B](#) [PB-1220PEQ](#) [S6109](#) [SBM616PR](#) [SC110E](#) [SC2036ACP](#) [SC616N-2](#) [SC628FW](#) [SC628MPG](#) [SC648D](#) [SCS045MD9DT3S](#) [FCM12PLF](#) [F/EB20P-DR LF](#) [F/SMD03A LF](#) [FSMD8585JSLF](#) [F/SU 21-02 LF](#) [F/TCW 12 WITH LABEL LF](#) [F/UCW 06 WITH LABEL LF](#) [PFD-27N36W](#) [PKM22EPPH40S1-B0](#) [PKM35-4A0](#) [PL-35N29WQ](#) [PS-552Q](#) [CM-5](#) [REF-202](#) [B/SE 128 RED LF](#) [KBS-20DA-7AS](#) [KBS-27DA-5C-105](#) [LSC628ANR](#) [03-810.001](#) [RTO-1R07-001](#) [PL-21N31PQ](#) [F-B-P1405ISB LF](#)