

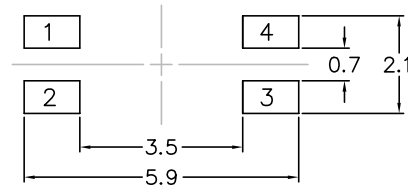

NOTES:

1. ROHS COMPLIANT
2. STORAGE TEMPERATURE: -50°C TO +150°C
3. COMPLIANCE TO J-STD:
  - A. J-STD-002: SOLDERABILITY AT 245°C REFLOW PROFILE
  - B. J-STD-020: LEVEL 1, NO MOISTURE SENSITIVE
4. QUALIFIED PER AEC-Q200
5. PPAP LEVEL 3
6. FACTORY TS-16949 CERTIFIED
7. PARTS ARE PACKAGED IN TAPE AND REEL

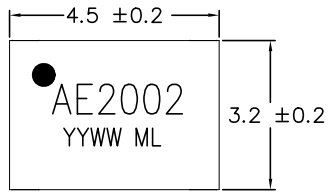

RECOMMENDED FOOTPRINT

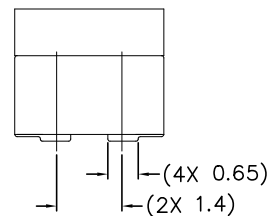
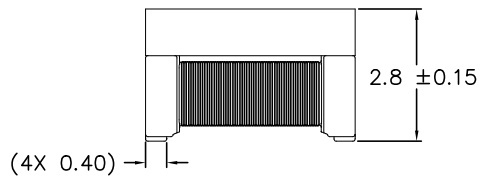

FINAL OUTLINE

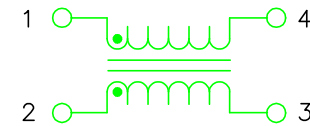

SCHEMATIC

ELECTRICAL CHARACTERISTICS AT +25°C UNLESS OTHER SPECIFIED

PARAMETER	SPECIFICATIONS		
OPERATING TEMP	-40°C TO +125°C		
URNS RATIO AND POLARITY PINS (1-4) TO PINS (2-3)	1.00 ± 2%, PER SCHEMATIC		
DC RESISTANCE PINS 1-4; PINS 2-3	5.0 OHMS MAX		
INDUCTANCE (OCL) PINS 1-4; PINS 2-3	160 uH TYP. @ 100 kHz, 100 mV		
	DC-100 KHz	1-60 MHz	
INSERTION LOSS (SDD21) PINS (1-2) TO PINS (3-4)	-0.5 dB MAX	-1.0 dB MAX	
	1-10 MHz	30 MHz	60 MHz
RETURN LOSS (SDD11) (Z OUT = 100 OHM ± 1%)	-26 dB MIN	-21.1 dB MIN	-18 dB MIN
	1 MHz	10-100 MHz	400 MHz
	1000 MHz		
COMMON- TO COMMON- MODE REJECTION (SCC21)	-23 dB MIN	-42 dB MIN	-25 dB MIN
			-15 dB MIN
COMMON- TO DIFFERENTIAL- MODE REJECTION (SDS21)	1-10 MHz	100 MHz	1000 MHz
	-70 dB MIN	-50 dB MIN	-24 dB MIN
CURRENT RATING	100 mA MAX		
VOLTAGE RATING	60 VDC MAX		

ALL DIMENSION ARE SHOWN IN MILLIMETERS.  
UNLESS OTHERWISE SPECIFIED,  
THE FOLLOWING TOLERANCES APPLY:  
X.X = ±0.1

© Copyright, 2019. Pulse Electronics Corp. All rights reserved. Pulse confidential & proprietary. (03/20/19)

PRODUCT DESCRIPTION	TLA DRAWING	PS DRAWING	SHEET	PART NO.	DATASHEET REV.
CM CHOKE,100BASE-T1,1812 SIZE	AE2002-10	PS-2808.002-D	1 OF 1	AE2002	S

## X-ON Electronics

Largest Supplier of Electrical and Electronic Components

*Click to view similar products for [Common Mode Chokes / Filters](#) category:*

*Click to view products by [Pulse manufacturer](#):*

Other Similar products are found below :

[74279408](#) [PE-62911NL](#) [PE-64683](#) [ST6118T-R](#) [T8114NLT](#) [RD5122-10-6M0](#) [TCM0806G-350-2P-T](#) [TCM0806G-650-2P-T](#) [IND-0110](#)  
[UAL21V07012500](#) [UAL21VR0802000](#) [UAL24VR06500CH](#) [UALSC023000000](#) [UALSC1020JH000](#) [UALSC1520JH000](#)  
[UALSU10VR20010](#) [UALSU16VD30030](#) [UALSU16VD40010](#) [UALSU9H0305000](#) [UALSU9HF060300](#) [UALSU9VD070100](#) [36-00037](#)  
[5701610000](#) [UALW21HS072450](#) [UALSU9VD070400](#) [UALSU9HF050500](#) [UALSU9H0208000](#) [UALSCF25081300](#) [UAL24VK06450CH](#)  
[PLT10HH501100PNB](#) [PLT10HH401100PNB](#) [PLT10HH1026R0PNB](#) [PE-67531](#) [EXC-X4CH120X](#) [TLH10UB 113 0R5](#) [2752041447](#)  
[2752045447](#) [CMS3-11-R](#) [7351V](#) [CMF16-153131](#) [744252510](#) [T8116NLT](#) [FE2X10-4-2NL](#) [744253200](#) [744253101](#) [744252220](#) [TX8111NLT](#)  
[UAL30VR3500470](#) [CTX01-19077-R](#) [T8003NLT](#)