

# DATA SHEET

## INDUCTOR

Chip Inductors

BSCL Series

RoHS compliant & Halogen Free



## SMD Multilayer Ferrite Chip Inductors - BSCL Series

### BSCL Series

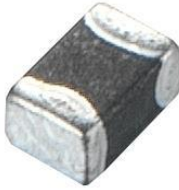

The SMD multi-layered ferrite chip inductors provide a cost-effective solution for densely packed PC board designs. BSCL series comes in 4 sizes and is suitable for low frequency applications.

#### Features

- RoHS compliant
- High mounting density of compact circuit due to crosstalk elimination that results from a closed magnetic flux in a ferrite material
- Suitable for flow and re-flow soldering
- Available in 4 sizes

#### Applications

- Personal computers, HDDs, other various electronic devices
- Any portable device where compact size and high mounting densities are required

#### Product Identification

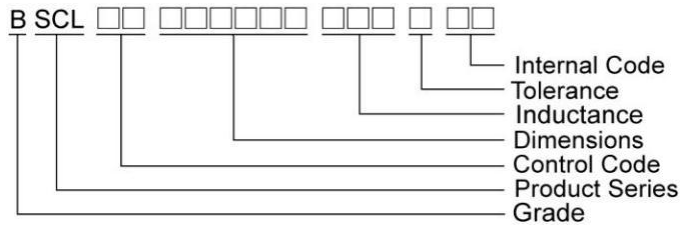

#### Shape and Dimensions

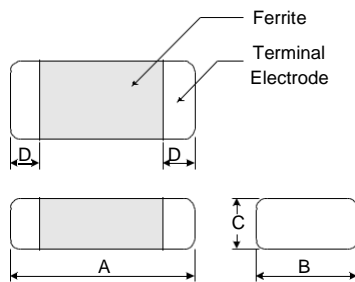

#### Recommended Pattern

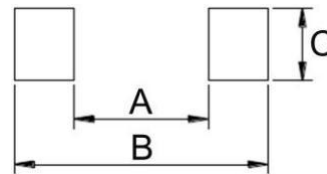

Dimensions in mm

| TYPE         | A        | B         | C         | D           |
|--------------|----------|-----------|-----------|-------------|
| BSCL00160808 | 1.6±0.20 | 0.80±0.20 | 0.80±0.20 | 2.00.3±0.20 |
| BSCL00201209 | 2.0±0.20 | 1.25±0.20 | 0.90±0.20 | 0.5±0.30    |
| BSCL00201212 | 2.0±0.20 | 1.25±0.20 | 1.25±0.20 | 0.5±0.30    |
| BSCL00321611 | 3.2±0.20 | 1.60±0.20 | 1.10±0.20 | 0.5±0.30    |

Dimensions in mm

| TYPE         | A         | B         | C         |
|--------------|-----------|-----------|-----------|
| BSCL00160808 | 0.7 ~ 0.8 | 1.8 ~ 2.0 | 0.6 ~ 0.8 |
| BSCL00201209 | 1.0 ~ 1.2 | 2.6 ~ 4.0 | 1.0 ~ 1.4 |
| BSCL00201212 | 1.0 ~ 1.2 | 2.6 ~ 4.0 | 1.0 ~ 1.2 |
| BSCL00321611 | 2.0 ~ 2.4 | 4.2 ~ 5.2 | 1.3 ~ 1.9 |

## SMD Multilayer Ferrite Chip Inductors – BSCL Series

### Electrical Characteristics

| Part Number                                | Inductance<br>( $\mu\text{H}$ ) | Tolerance<br>( $\pm\%$ ) | Q<br>Min | Test               | SRF<br>(MHz) Min | RDC<br>( $\Omega$ ) Max | IDC<br>(mA) Max |
|--|---------------------------------|--------------------------|----------|--------------------|------------------|-------------------------|-----------------|
|  |                                 |                          |          | Frequency<br>(MHz) |                  |                         |                 |
| BSCL0016080810N <sup>□</sup> <sub>00</sub> | 0.010                           | 20                       | 15       | 50                 | 300              | 0.2                     | 50              |
| BSCL0016080833N <sup>□</sup> <sub>00</sub> | 0.033                           | 20                       | 15       | 50                 | 270              | 0.2                     | 50              |
| BSCL0016080847N <sup>□</sup> <sub>00</sub> | 0.047                           | 20                       | 15       | 50                 | 260              | 0.3                     | 50              |
| BSCL0016080856N <sup>□</sup> <sub>00</sub> | 0.056                           | 20                       | 15       | 50                 | 255              | 0.3                     | 50              |
| BSCL0016080868N <sup>□</sup> <sub>00</sub> | 0.068                           | 20                       | 15       | 50                 | 250              | 0.3                     | 50              |
| BSCL0016080882N <sup>□</sup> <sub>00</sub> | 0.082                           | 20                       | 15       | 50                 | 245              | 0.3                     | 50              |
| BSCL00160808R10 <sup>□</sup> <sub>00</sub> | 0.10                            | 20/15/10                 | 25       | 25                 | 240              | 0.5                     | 50              |
| BSCL00160808R12 <sup>□</sup> <sub>00</sub> | 0.12                            | 20/15/10                 | 25       | 25                 | 205              | 0.5                     | 50              |
| BSCL00160808R15 <sup>□</sup> <sub>00</sub> | 0.15                            | 20/15/10                 | 25       | 25                 | 180              | 0.6                     | 50              |
| BSCL00160808R18 <sup>□</sup> <sub>00</sub> | 0.18                            | 20/15/10                 | 25       | 25                 | 165              | 0.6                     | 50              |
| BSCL00160808R22 <sup>□</sup> <sub>00</sub> | 0.22                            | 20/15/10                 | 25       | 25                 | 150              | 0.8                     | 50              |
| BSCL00160808R27 <sup>□</sup> <sub>00</sub> | 0.27                            | 20/15/10                 | 25       | 25                 | 136              | 0.8                     | 50              |
| BSCL00160808R33 <sup>□</sup> <sub>00</sub> | 0.33                            | 20/15/10                 | 25       | 25                 | 125              | 0.85                    | 35              |
| BSCL00160808R39 <sup>□</sup> <sub>00</sub> | 0.39                            | 20/15/10                 | 25       | 25                 | 110              | 1.00                    | 35              |
| BSCL00160808R47 <sup>□</sup> <sub>00</sub> | 0.47                            | 20/15/10                 | 25       | 25                 | 105              | 1.35                    | 35              |
| BSCL00160808R56 <sup>□</sup> <sub>00</sub> | 0.56                            | 20/15/10                 | 25       | 25                 | 95               | 1.50                    | 35              |
| BSCL00160808R68 <sup>□</sup> <sub>00</sub> | 0.68                            | 20/15/10                 | 25       | 25                 | 85               | 1.70                    | 35              |
| BSCL00160808R82 <sup>□</sup> <sub>00</sub> | 0.82                            | 20/15/10                 | 25       | 25                 | 75               | 2.10                    | 35              |
| BSCL001608081R0 <sup>□</sup> <sub>00</sub> | 1.0                             | 20/15/10                 | 35       | 10                 | 65               | 0.60                    | 25              |
| BSCL001608081R2 <sup>□</sup> <sub>00</sub> | 1.2                             | 20/15/10                 | 35       | 10                 | 60               | 0.80                    | 25              |
| BSCL001608081R5 <sup>□</sup> <sub>00</sub> | 1.5                             | 20/15/10                 | 35       | 10                 | 55               | 0.80                    | 25              |
| BSCL001608081R8 <sup>□</sup> <sub>00</sub> | 1.8                             | 20/15/10                 | 35       | 10                 | 50               | 0.95                    | 25              |
| BSCL001608082R2 <sup>□</sup> <sub>00</sub> | 2.2                             | 20/15/10                 | 35       | 10                 | 45               | 1.00                    | 15              |
| BSCL001608082R7 <sup>□</sup> <sub>00</sub> | 2.7                             | 20/15/10                 | 35       | 10                 | 40               | 1.15                    | 15              |
| BSCL001608083R3 <sup>□</sup> <sub>00</sub> | 3.3                             | 20/15/10                 | 35       | 10                 | 38               | 1.30                    | 15              |
| BSCL001608083R9 <sup>□</sup> <sub>00</sub> | 3.9                             | 20/15/10                 | 35       | 10                 | 36               | 1.50                    | 15              |
| BSCL001608084R7 <sup>□</sup> <sub>00</sub> | 4.7                             | 20/15/10                 | 35       | 10                 | 33               | 1.60                    | 15              |
| BSCL001608085R6 <sup>□</sup> <sub>00</sub> | 5.6                             | 20/15/10                 | 35       | 4                  | 22               | 1.10                    | 5               |
| BSCL001608086R8 <sup>□</sup> <sub>00</sub> | 6.8                             | 20/15/10                 | 35       | 4                  | 20               | 1.30                    | 5               |
| BSCL001608088R2 <sup>□</sup> <sub>00</sub> | 8.2                             | 20/15/10                 | 30       | 4                  | 18               | 1.50                    | 5               |
| BSCL00160808100 <sup>□</sup> <sub>00</sub> | 10                              | 20/15/10                 | 30       | 2                  | 17               | 1.70                    | 5               |
| BSCL00160808120 <sup>□</sup> <sub>00</sub> | 12                              | 20/15/10                 | 30       | 2                  | 15               | 1.80                    | 3               |
| BSCL00160808150 <sup>□</sup> <sub>00</sub> | 15                              | 20/15/10                 | 20       | 1                  | 14               | 1.50                    | 1               |
| BSCL00160808220 <sup>□</sup> <sub>00</sub> | 22                              | 20/15/10                 | 20       | 1                  | 11               | 1.70                    | 1               |

**Note: When ordering, please specify tolerance code. Tolerance : K= $\pm 10\%$  , L= $\pm 15\%$  , M= $\pm 20\%$**

- Operating temperature range - 40°C ~ 125°C(Including self - temperature rise)
- IDC : Applied the current to coils, the inductance shall be less than 10% initial value
- Measure Equipment :



**CHIP INDUCTORS**

BSPQ

SRF : Agilent HP8753D/Agilent E4991A

RDC : HP4338B or CHEN HWA 502

## SMD Multilayer Ferrite Chip Inductors – BSCL Series

### Electrical Characteristics

| Part Number                    | Inductance<br>( $\mu$ H) | Tolerance<br>( $\pm$ %) | Q<br>Min | Test Frequency<br>(MHz) | SRF<br>MHz) Min | RDC<br>( $\Omega$ ) Max | IDC<br>(mA) Max |
|--------------------------------|--------------------------|-------------------------|----------|-------------------------|-----------------|-------------------------|-----------------|
| BSCL0020120922N□ <sub>00</sub> | 0.022                    | 20                      | 20       | 50                      | 320             | 0.20                    | 300             |
| BSCL0020120933N□ <sub>00</sub> | 0.033                    | 20/15                   | 20       | 50                      | 320             | 0.20                    | 300             |
| BSCL0020120947N□ <sub>00</sub> | 0.047                    | 20/15                   | 20       | 50                      | 320             | 0.20                    | 300             |
| BSCL0020120956N□ <sub>00</sub> | 0.056                    | 20/15                   | 20       | 50                      | 320             | 0.20                    | 300             |
| BSCL0020120968N□ <sub>00</sub> | 0.068                    | 20/15                   | 20       | 50                      | 280             | 0.20                    | 300             |
| BSCL0020120982N□ <sub>00</sub> | 0.082                    | 20/15                   | 20       | 50                      | 255             | 0.20                    | 300             |
| BSCL00201209R10□ <sub>00</sub> | 0.10                     | 20/15/0                 | 25       | 25                      | 235             | 0.30                    | 250             |
| BSCL00201209R12□ <sub>00</sub> | 0.12                     | 20/15/10                | 25       | 25                      | 220             | 0.30                    | 250             |
| BSCL00201209R15□ <sub>00</sub> | 0.15                     | 20/15/10                | 25       | 25                      | 200             | 0.40                    | 250             |
| BSCL00201209R18□ <sub>00</sub> | 0.18                     | 20/15/10                | 25       | 25                      | 185             | 0.40                    | 250             |
| BSCL00201209R22□ <sub>00</sub> | 0.22                     | 20/15/10                | 25       | 25                      | 170             | 0.50                    | 250             |
| BSCL00201209R27□ <sub>00</sub> | 0.27                     | 20/15/10                | 25       | 25                      | 150             | 0.50                    | 250             |
| BSCL00201209R33□ <sub>00</sub> | 0.33                     | 20/15/10                | 25       | 25                      | 145             | 0.55                    | 250             |
| BSCL00201209R39□ <sub>00</sub> | 0.39                     | 20/15/10                | 25       | 25                      | 135             | 0.65                    | 250             |
| BSCL00201209R47□ <sub>00</sub> | 0.47                     | 20/15/10                | 25       | 25                      | 125             | 0.65                    | 250             |
| BSCL00201209R56□ <sub>00</sub> | 0.56                     | 20/15/10                | 25       | 25                      | 115             | 0.75                    | 150             |
| BSCL00201209R68□ <sub>00</sub> | 0.68                     | 20/15/10                | 25       | 25                      | 105             | 0.80                    | 150             |
| BSCL00201209R82□ <sub>00</sub> | 0.82                     | 20/15/10                | 25       | 25                      | 100             | 1.00                    | 150             |
| BSCL002012091R0□ <sub>00</sub> | 1.0                      | 20/15/10                | 45       | 10                      | 75              | 0.40                    | 50              |
| BSCL002012091R2□ <sub>00</sub> | 1.2                      | 20/15/10                | 45       | 10                      | 65              | 0.50                    | 50              |
| BSCL002012091R5□ <sub>00</sub> | 1.5                      | 20/15/10                | 45       | 10                      | 60              | 0.50                    | 50              |
| BSCL002012091R8□ <sub>00</sub> | 1.8                      | 20/15/10                | 45       | 10                      | 55              | 0.60                    | 50              |
| BSCL002012092R2□ <sub>00</sub> | 2.2                      | 20/15/10                | 45       | 10                      | 50              | 0.65                    | 30              |

**Note: When ordering, please specify tolerance code. Tolerance : K= $\pm$ 10% , L= $\pm$ 15% , M= $\pm$ 20%**

- Operating temperature range - 40°C ~ 125°C(Including self - temperature rise)
- IDC : Applied the current to coils, the inductance shall be less than 10% initial value

- Measure Equipment :

L & Q : HP4291A

SRF : Agilent HP8753D/Agilent E4991A

RDC : HP4338B or CHEN HWA 502

## SMD Multilayer Ferrite Chip Inductors – BSCL Series

### Electrical Characteristics

| Part Number                     | Inductance<br>( $\mu$ H) | Tolerance<br>( $\pm$ %) | Q<br>Min | Test Frequency<br>(MHz) | SRF<br>(MHz) Min | RDC<br>( $\Omega$ ) Max | IDC<br>(mA) Max |
|---------------------------------|--------------------------|-------------------------|----------|-------------------------|------------------|-------------------------|-----------------|
| BSCL002012122R7 <sup>□</sup> 00 | 2.7                      | 20/15/10                | 45       | 10                      | 45               | 0.75                    | 30              |
| BSCL002012123R3 <sup>□</sup> 00 | 3.3                      | 20/15/10                | 45       | 10                      | 41               | 0.80                    | 30              |
| BSCL002012123R9 <sup>□</sup> 00 | 3.9                      | 20/15/10                | 45       | 10                      | 38               | 0.90                    | 30              |
| BSCL002012124R7 <sup>□</sup> 00 | 4.7                      | 20/15/10                | 45       | 10                      | 35               | 1.00                    | 30              |
| BSCL002012125R6 <sup>□</sup> 00 | 5.6                      | 20/15/10                | 45       | 4                       | 32               | 0.90                    | 15              |
| BSCL002012126R8 <sup>□</sup> 00 | 6.8                      | 20/15/10                | 45       | 4                       | 29               | 1.00                    | 15              |
| BSCL002012128R2 <sup>□</sup> 00 | 8.2                      | 20/15/10                | 45       | 4                       | 26               | 1.10                    | 15              |
| BSCL00201212100 <sup>□</sup> 00 | 10                       | 20/15/10                | 45       | 2                       | 24               | 1.10                    | 15              |
| BSCL00201212120 <sup>□</sup> 00 | 12                       | 20/15/10                | 45       | 2                       | 22               | 1.20                    | 15              |
| BSCL00201212150 <sup>□</sup> 00 | 15                       | 20/15/10                | 30       | 1                       | 19               | 0.80                    | 5               |
| BSCL00201212180 <sup>□</sup> 00 | 18                       | 20/15/10                | 30       | 1                       | 18               | 0.90                    | 5               |
| BSCL00201212220 <sup>□</sup> 00 | 22                       | 20/15/10                | 30       | 1                       | 16               | 1.1                     | 5               |

**Note: When ordering, please specify tolerance code. Tolerance : K= $\pm$ 10% , L= $\pm$ 15% , M= $\pm$ 20%**

- Operating temperature range - 40°C ~ 125°C(Including self - temperature rise)
- IDC : Applied the current to coils, the inductance shall be less than 10% initial value

- Measure Equipment :

L & Q : HP4291A

SRF : Agilent HP8753D/Agilent E4991A

RDC : HP4338B or CHEN HWA 502

## SMD Multilayer Ferrite Chip Inductors – BSCL Series

### Electrical Characteristics

| Part Number                    | Inductance (μH) | Tolerance (±%) | Q Min | Test Frequency (MHz) | SRF (MHz) Min | RDC (Ω) Max | IDC (mA) Max |
|--------------------------------|-----------------|----------------|-------|----------------------|---------------|-------------|--------------|
| BSCL0032161147N□ <sub>00</sub> | 0.047           | 20             | 20    | 50                   | 320           | 0.15        | 300          |
| BSCL0032161156N□ <sub>00</sub> | 0.056           | 20             | 20    | 50                   | 280           | 0.25        | 300          |
| BSCL0032161168N□ <sub>00</sub> | 0.068           | 20             | 20    | 50                   | 280           | 0.25        | 300          |
| BSCL0032161182N□ <sub>00</sub> | 0.082           | 20             | 20    | 50                   | 250           | 0.25        | 300          |
| BSCL00321611R10□ <sub>00</sub> | 0.10            | 20/15/10       | 25    | 25                   | 235           | 0.25        | 250          |
| BSCL00321611R12□ <sub>00</sub> | 0.12            | 20/15/10       | 25    | 25                   | 220           | 0.30        | 250          |
| BSCL00321611R15□ <sub>00</sub> | 0.15            | 20/15/10       | 25    | 25                   | 200           | 0.30        | 250          |
| BSCL00321611R18□ <sub>00</sub> | 0.18            | 20/15/10       | 25    | 25                   | 185           | 0.40        | 250          |
| BSCL00321611R22□ <sub>00</sub> | 0.22            | 20/15/10       | 25    | 25                   | 170           | 0.40        | 250          |
| BSCL00321611R27□ <sub>00</sub> | 0.27            | 20/15/10       | 25    | 25                   | 150           | 0.50        | 250          |
| BSCL00321611R33□ <sub>00</sub> | 0.33            | 20/15/10       | 25    | 25                   | 145           | 0.60        | 250          |
| BSCL00321611R39□ <sub>00</sub> | 0.39            | 20/15/10       | 25    | 25                   | 135           | 0.50        | 200          |
| BSCL00321611R47□ <sub>00</sub> | 0.47            | 20/15/10       | 25    | 25                   | 125           | 0.60        | 200          |
| BSCL00321611R56□ <sub>00</sub> | 0.56            | 20/15/10       | 25    | 25                   | 115           | 0.70        | 150          |
| BSCL00321611R68□ <sub>00</sub> | 0.68            | 20/15/10       | 25    | 25                   | 105           | 0.80        | 150          |
| BSCL00321611R82□ <sub>00</sub> | 0.82            | 20/15/10       | 25    | 25                   | 100           | 0.90        | 150          |
| BSCL003216111R0□ <sub>00</sub> | 1.0             | 20/15/10       | 45    | 10                   | 75            | 0.40        | 100          |
| BSCL003216111R2□ <sub>00</sub> | 1.2             | 20/15/10       | 45    | 10                   | 65            | 0.50        | 100          |
| BSCL003216111R5□ <sub>00</sub> | 1.5             | 20/15/10       | 45    | 10                   | 60            | 0.50        | 80           |
| BSCL003216111R8□ <sub>00</sub> | 1.8             | 20/15/10       | 45    | 10                   | 55            | 0.50        | 70           |
| BSCL003216112R2□ <sub>00</sub> | 2.2             | 20/15/10       | 45    | 10                   | 50            | 0.60        | 60           |
| BSCL003216112R7□ <sub>00</sub> | 2.7             | 20/15/10       | 45    | 10                   | 45            | 0.60        | 60           |
| BSCL003216113R3□ <sub>00</sub> | 3.3             | 20/15/10       | 45    | 10                   | 41            | 0.70        | 60           |
| BSCL003216113R9□ <sub>00</sub> | 3.9             | 20/15/10       | 45    | 10                   | 38            | 0.80        | 50           |
| BSCL003216114R7□ <sub>00</sub> | 4.7             | 20/15/10       | 45    | 10                   | 35            | 0.90        | 50           |
| BSCL003216115R6□ <sub>00</sub> | 5.6             | 20/15/10       | 45    | 4                    | 32            | 0.70        | 25           |
| BSCL003216116R8□ <sub>00</sub> | 6.8             | 20/15/10       | 45    | 4                    | 29            | 0.80        | 25           |
| BSCL003216118R2□ <sub>00</sub> | 8.2             | 20/15/10       | 45    | 4                    | 26            | 0.90        | 25           |
| BSCL00321611100□ <sub>00</sub> | 10              | 20/15/10       | 45    | 2                    | 24            | 1.00        | 25           |
| BSCL00321611120□ <sub>00</sub> | 12              | 20/15/10       | 45    | 2                    | 22            | 1.00        | 15           |
| BSCL00321611150□ <sub>00</sub> | 15              | 20/15/10       | 35    | 1                    | 19            | 0.70        | 5            |
| BSCL00321611180□ <sub>00</sub> | 18              | 20/15/10       | 35    | 1                    | 18            | 0.75        | 5            |
| BSCL00321611220□ <sub>00</sub> | 22              | 20/15/10       | 35    | 1                    | 16            | 0.90        | 5            |
| BSCL00321611270□ <sub>00</sub> | 27              | 20/15/10       | 35    | 1                    | 14            | 0.90        | 5            |

**Note:** When ordering, please specify tolerance code. Tolerance : K=±10% , L=±15% , M=±20%

- Operating temperature range - 40°C ~ 125°C(Including self - temperature rise)
- IDC : Applied the current to coils, the inductance shall be less than 10% initial value
- Measure Equipment :  
L & Q : HP4291A



**CHIP INDUCTORS**

BSPQ

RDC : HP4338B or CHEN HWA 502



# SMD Multilayer Ferrite Chip Inductors – BSCL Series

Test Instruments : Agilent E4991A Impedance / Material Analyzer

**BSCL00160808**

INDUCTANCE v.s. FREQUENCY CHARACTERISTICS      Q v.s. FREQUENCY CHARACTERISTICS

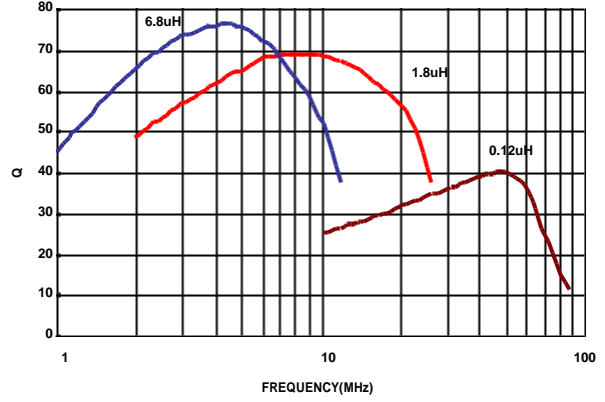
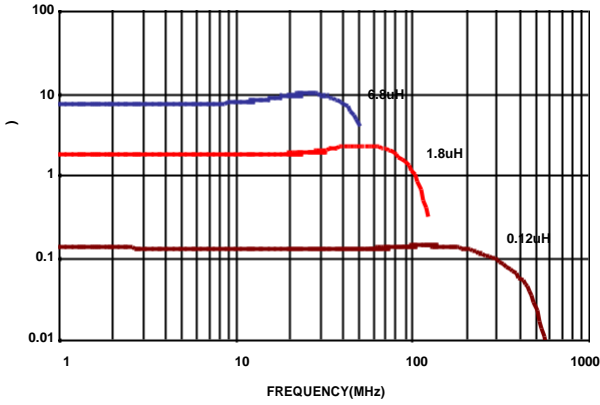

**BSCL00201209**

INDUCTANCE v.s. FREQUENCY CHARACTERISTICS

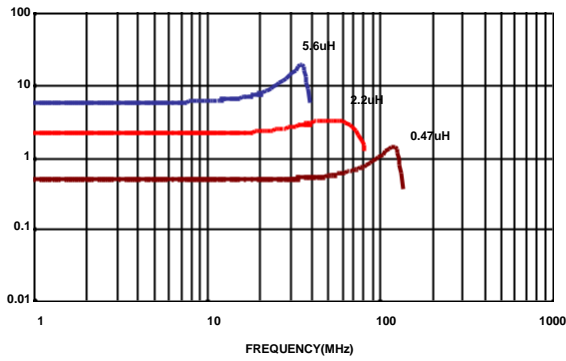

Q v.s. FREQUENCY CHARACTERISTICS

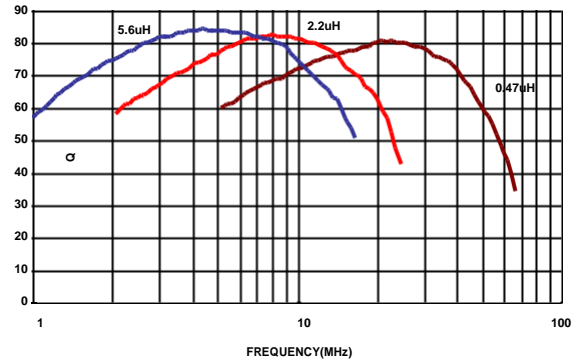

**BSCL00321611**

INDUCTANCE v.s. FREQUENCY CHARACTERISTICS

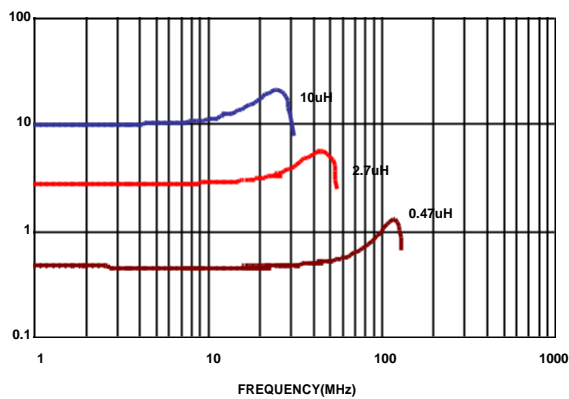

Q v.s. FREQUENCY CHARACTERISTICS

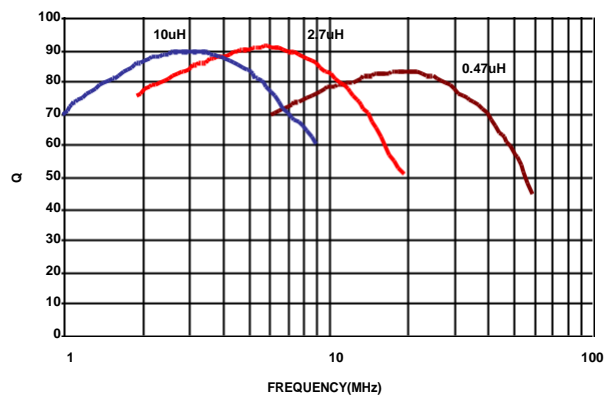



**SMD Multilayer Ferrite Chip Inductors - BSCL Series**

**Packaging Specifications**

**Tape Dimensions**

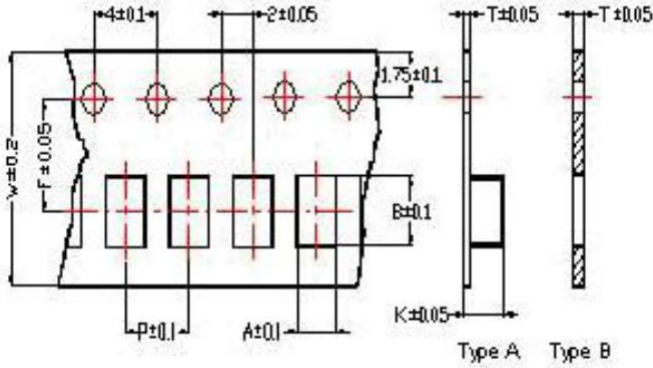

**Tape Material**

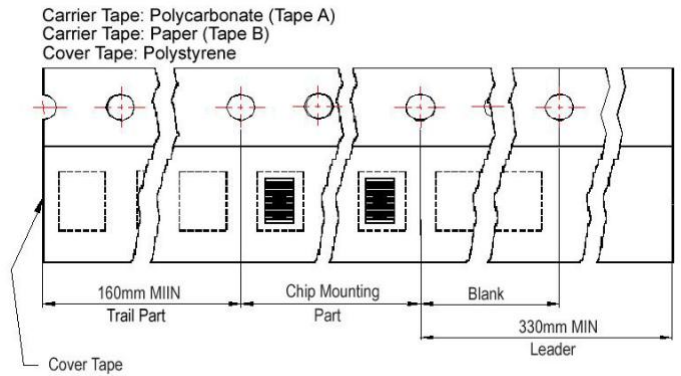

**Reel Dimensions**

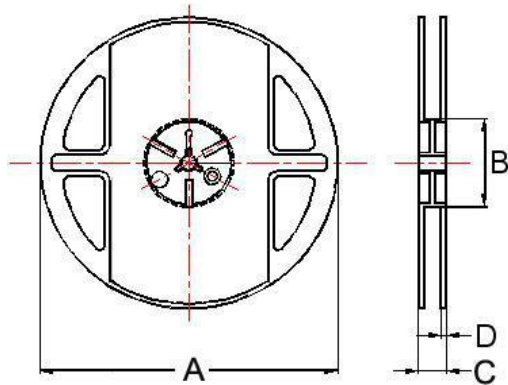

**Dimensions in mm**

| TYPE         | Tape Dimensions |      |      |     |     |     |      |      | Reel Dimensions |    |    |     | Quantity<br>PCS / Reel |
|--------------|-----------------|------|------|-----|-----|-----|------|------|-----------------|----|----|-----|------------------------|
|              | A               | B    | T    | W   | P   | F   | K    | Tape | A               | B  | C  | D   |                        |
| BSCL00160808 | 1.05            | 1.85 | 0.95 | 8.0 | 4.0 | 3.5 | -    | B    | 178             | 60 | 12 | 1.5 | 4000                   |
| BSCL00201209 | 1.50            | 2.30 | 0.97 | 8.0 | 4.0 | 3.5 | -    | B    | 178             | 60 | 12 | 1.5 | 4000                   |
| BSCL00201212 | 1.35            | 2.25 | 0.22 | 8.0 | 4.0 | 3.5 | 1.35 | A    | 178             | 60 | 12 | 1.5 | 3000                   |
| BSCL00321611 | 1.88            | 3.50 | 0.22 | 8.0 | 4.0 | 3.5 | 1.27 | A    | 178             | 60 | 12 | 1.5 | 3000                   |

## X-ON Electronics

Largest Supplier of Electrical and Electronic Components

*Click to view similar products for [RF inductors - SMD category](#):*

*Click to view products by [Pulse manufacturer](#):*

Other Similar products are found below :

[MHL1ECTTP82NJ](#) [MHL1ECTTP8N2J](#) [CIH10T12NJNC](#) [B82498B1332J000](#) [B82498B3121J000](#) [0805WL220GT](#) [1008WL101GT](#)  
[0805WL681GT](#) [IWC0402D27NR-3G](#) [IWC0603F68NR-3G](#) [IWC0402AR10R-3G](#) [0603WL470JT](#) [IWC0402D33NR-3G](#) [IWC0603F47NR-3G](#)  
[0805WL151JT](#) [IWC0402A68NR-3G](#) [IWC0402AR12R-3G](#) [IWC0402A82NR-3G](#) [IWC0402B39NR-3G](#) [IWC0603CR12R-3G](#)  
[IWC0603AR33R-3G](#) [IWC0603BR18R-3G](#) [IWC0603F39NR-3G](#) [IWC0603BR22R-3G](#) [IWC0402A47NR-3G](#) [IWC0603AR27R-3G](#)  
[IWC0603F27NR-3G](#) [IWC1008DR68R-3G](#) [IWC1008FR12R-3G](#) [IWC1008FR18R-3G](#) [IWC1008J33NR-3G](#) [IWC1008J82NR-3G](#)  
[IWC1008DR47R-3G](#) [IWC1008J18NR-3G](#) [IWC0805E22NR-3G](#) [IWC1008DR82R-3G](#) [IWC0805E33NR-3G](#) [IWC1008J68NR-3G](#)  
[IWC0805D82NR-3G](#) [IWC0805DR10R-3G](#) [IWC0805E39NR-3G](#) [IWC1008DR39R-3G](#) [IWC0805DR15R-3G](#) [IWC1008J39NR-3G](#)  
[IWC1008J27NR-3G](#) [IWC0805DR18R-3G](#) [IWC0805E68NR-3G](#) [IWC1008ER27R-3G](#) [IWC1008FR10R-3G](#) [IWC1008J22NR-3G](#)