

# RF Balun Transformers

For Wideband RF Applications



- Low cost construction
- Miniature surface mount package
- Excellent insertion loss
- Ideal for balanced-to-unbalanced applications
- Designed for:
  - CATV Distribution/Drop Amplifiers
  - Set Top Boxes
  - Residential Gateways

## Electrical Specifications @ 25°C - Operating Temperature -40°C to +85°C

Standard Part Number	RoHS-6 Compliant Part No.	Impedance Ratio <sup>1</sup> (Pri:Sec ±2%)	Insertion Loss <sup>2</sup>			Return Loss			Phase Unbalance (50/1000MHz)	Amplitude Unbalance	
			10MHz (TYP/MAX)	50-750MHz (TYP/MAX)	750-1000MHz (TYP/MAX)	10MHz (TYP/MIN)	50-750MHz (TYP/MIN)	750-1000MHz (TYP/MIN)		(50MHz)	(100-1000MHz)
CX2024	CX2024NL	1:1	0.46/1.00dB	0.37/0.50dB	0.48/0.60B	>40/20dB	>30/20dB	30/16dB	20° MAX	1.4dB MAX	1.25dB MAX
CX2024A	CX2024ANL	1:1	0.46/1.00dB	0.37/0.50dB	0.48/0.60B	>40/20dB	>30/20dB	30/16dB	20° MAX	1.4dB MAX	1.25dB MAX
			50MHz (TYP/MAX)	208MHz (TYP/MAX)	870MHz (TYP/MAX)	50MHz (TYP/MAX)	208MHz (TYP/MAX)	870MHz (TYP/MAX)	50-870MHz	50MHz	100-870MHz
CX2149	CX2149NL	1:1	0.40/1.00B	0.40/1.00B	0.6/1.0B	>30/20dB	30/20dB	22/18dB	±4° from 180°	1.4dB MAX	1.3dB MAX

Notes: 1. Part with cover plate is designated CX2024A. Optional Tape & Reel packaging can be ordered by adding a "T" suffix to the part number (ex: CX2024T or CX2024AT).

## Mechanical

## Schematic

### CX2024/NL, CX2024A/NL & CX2149/NL

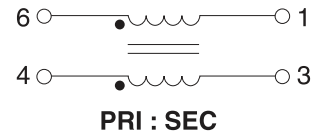
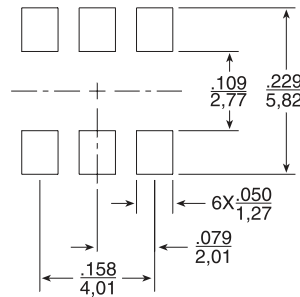
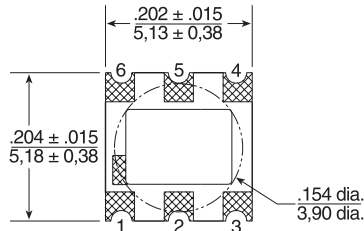

NOTE: CX2024A has optional cover plate

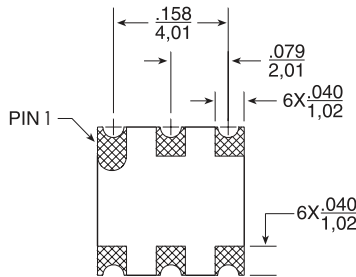
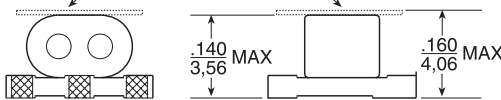

Tape & Reel .....2000/reel

Tray .....100/tray

Power Rating .....30 mA MAX; 0.25 W MAX

Dimensions:  $\frac{\text{Inches}}{\text{mm}}$

Unless otherwise specified, all tolerances are  $\pm \frac{.010}{0,25}$

USA 858 674 8100

Germany 49 7032 7806 0

Singapore 65 6287 8998

Shanghai 86 21 62787060

China 86 755 33966678

Taiwan 886 3 4356768

# RF Balun Transformers

For Wideband RF Applications

## Application Notes

- Bandwidth specifications for **CX2024**, **CX2024A** and **CX2149** are for a 75  $\Omega$  system.
  - Materials used in the products are UL94-V0 recognized. Products meet requirements of IEC 695-2-2 (Needle Flame Test).
- For additional impedance ratios and frequency ranges, please contact Applications Engineering.
  - Pick and place operation: smooth upper surface of device allows automatic pick and place.

## Notes from Tables

- Impedance and turns ratios are specified primary :secondary.
- These transformers are verified to operate from  $-40^{\circ}\text{C}$  to  $+85^{\circ}\text{C}$ . Contact Applications Engineering for performance data.

Typical Insertion Loss

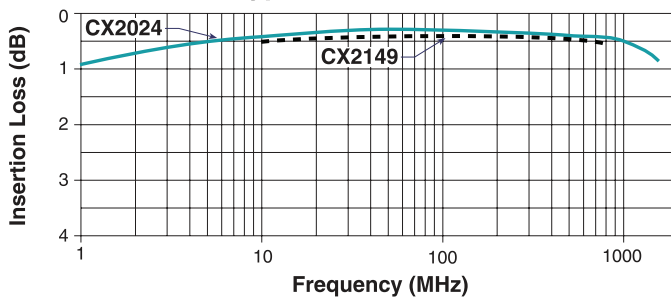

Amplitude

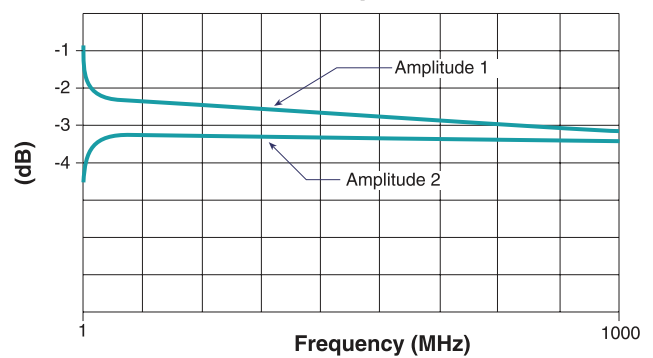

Phase Unbalance

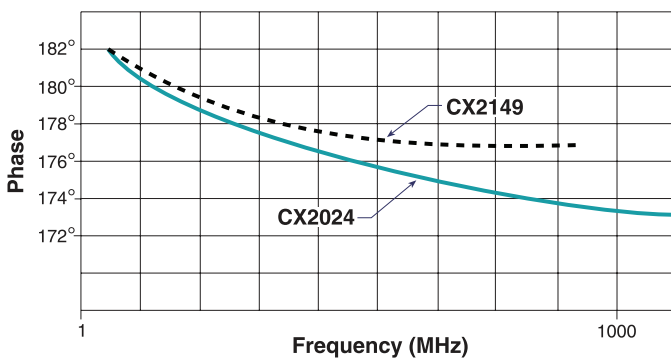

Amplitude Unbalance

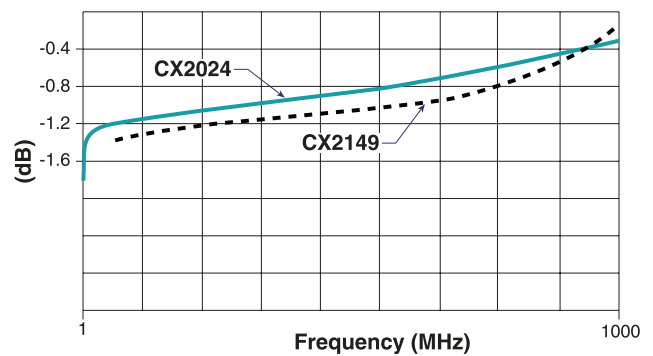

## For More Information

**Pulse Worldwide Headquarters**  
12220 World Trade Drive  
San Diego, CA  
92128  
U.S.A.

Tel: 858 674 8100  
Fax: 858 674 8262

**Pulse Europe**  
Einsteinstrasse 1  
D-71083 Herrenberg  
Germany

Tel: 49 7032 78060  
Fax: 49 7032 7806 135

**Pulse China Headquarters**  
B402, Shenzhen Academy of  
Aerospace Technol-  
ogy Bldg.  
10th Kejian Road  
High-Tech Zone  
Nanshan District  
Shenzhen, PR China  
518057  
Tel: 86 755 33966678  
Fax: 86 755 33966700

**Pulse North China**  
Room 2704/2705  
Super Ocean Finance  
Ctr.  
2067 Yan An Road  
West  
Shanghai 200336  
China  
Tel: 86 21 62787060  
Fax: 86 2162786973

**Pulse South Asia**  
135 Joo Seng Road  
#03-02  
PM Industrial Bldg.  
Singapore 368363  
Tel: 65 6287 8998  
Fax: 65 6287 8998

**Pulse North Asia**  
3F, No. 198  
Zhongyuan Road  
Zhongli City  
Taoyuan County 320  
Taiwan R. O. C.  
Tel: 886 3 4356768  
Fax: 886 3 4356823 (Pulse)  
Fax: 886 3 4356820 (FRE)

Performance warranty of products offered on this data sheet is limited to the parameters specified. Data is subject to change without notice. Other brand and product names mentioned herein may be trademarks or registered trademarks of their respective owners. © Copyright, 2012. Pulse Electronics, Inc. All rights reserved.

## X-ON Electronics

Largest Supplier of Electrical and Electronic Components

*Click to view similar products for [Audio Transformers](#) / [Signal Transformers](#) category:*

*Click to view products by [Pulse manufacturer](#):*

Other Similar products are found below :

[CU4S0506AT-2655-H1](#) [MGPWT-00449-P](#) [PE-64961](#) [1812WBT2-4](#) [BX1194WNL](#) [1879479-1](#) [PA1528ANL](#) [T1137NLT](#) [PE-65848FNLT](#)  
[H5019EFNL](#) [CX2045ALNLT](#) [TG1G-E201NV6LF](#) [MGPWT-00059-P](#) [MGPWT-00266-P](#) [MGPWT-00278-P](#) [MGPWT-00431-P](#) [TTC-100](#)  
[TTC-143-H](#) [TTC-5032-1](#) [4-1879391-0](#) [100213](#) [T1142NL](#) [TG1G-S001NZLF](#) [T1124NL](#) [1879732-1](#) [2-1879391-5](#) [MABA-010321-CT1A42](#)  
[TX1341NL](#) [H0013FNL](#) [H5020FNL](#) [H2009FNLT](#) [H5004NLT](#) [S553-5999-52-F](#) [SCMS7D43AY100PT1](#) [T5008NLT](#) [PE-68517T](#) [MGPWT-](#)  
[00339-P](#) [H5014FNLT](#) [TX1473NLT](#) [PE-69011NLT](#) [CX2043LNLT](#) [H7137FNLT](#) [H1259NLT](#) [TX1344NLT](#) [LM-LP-1005L](#) [H0013NLT](#)  
[S558-5500-JV](#) [TX1193NLT](#) [T7015NL](#) [T1124NLT](#)