

REVISION RECORD			
REV	ECO	DESCRIPTION	DRFT
△		ADD P/N	10/17/05*
△		ADD P/N	1/21/05*
△		ADD P/N	7/19/06
△		ADD P/N	10/26/08

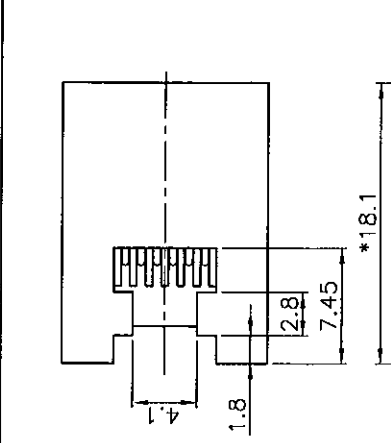

PC Board Layout t=1.60mm
Component Side Shown

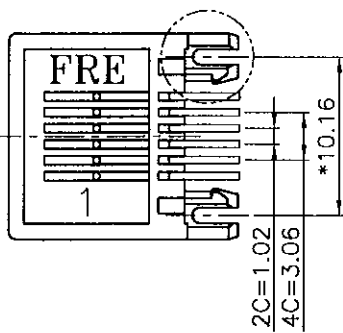
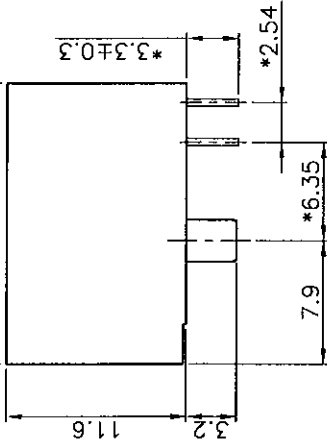
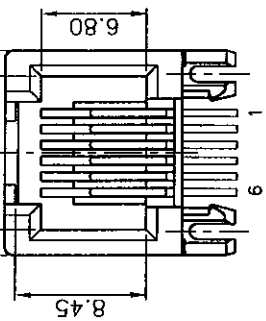

- NOTES:**
- ELECTRICAL:**
- VOLTAGE RATING : 150 VAC RMS.
 - CURRENT RATING : 1.5 AMP.
 - CONTACT RESISTANCE : 30 MILLIOHMS MAX.
 - INSULATION RESISTANCE : 1000 MEGOHMS MIN @ 500 VDC.
 - DIELECTRIC STRENGTH : 1000 VAC RMS 60Hz, 1MIN.
- MECHANICAL:**
- HOUSING MATERIAL : FR50&PBT+30% G.F UL94V-0.
 - CONTACT MATERIAL : PHOSPHOR BRONZE Ø0.46mm.
 - PLATING : GOLD PLATING OVER NICKEL.
 - OPERATING LIFE : 750 CYCLES MIN.
 - PCB RETENTION PRE-SOLDER : 1 LB MIN.
 - PCB RETENTION POST-SOLDER: 10 LBS MIN.
- ENVIRONMENTAL:**
- STORAGE : -40°C TO +85°C.
 - OPERATION : -40°C TO +85°C.
 - WAVE SOLDERING TEMPERATURE: 230~250°C (5~10 SECONDS)
- MATES WITH MODULAR PLUG CONFORMING TO FCC PART 68, SUBPART F.
CUL FILE NO. E163191
ROHS PART NUMBER: E536X-300XX-L

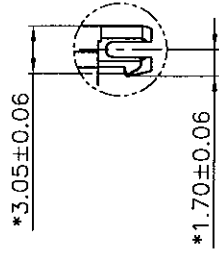
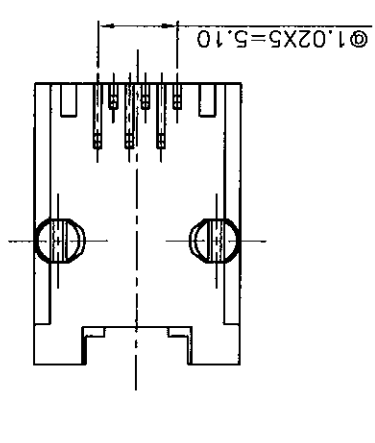

TOLERANCES UNLESS NOTED		DATE	
MM	INCH	CHG'D	CHK'D
±0.012		DATE: 10/17/05	DATE: 10/17/05
±0.0015		DATE: 1/21/05	DATE: 1/21/05
±0.0075		DATE: 7/19/06	DATE: 7/19/06
±0.5		DATE: 10/26/08	DATE: 10/26/08

APPROVED: [Signature]

DFTO C/O: [Signature]

DATE: 10/17/05

CHG'D: [Signature]

CHK'D: [Signature]

DATE: 10/17/05

DATE: 1/21/05

DATE: 7/19/06

DATE: 10/26/08

MATERIAL: [Blank]

QTY: [Blank]

FINISH: [Blank]

THIRD ANGLE PROJECTION

SCALE: 3:1

DO NOT SCALE DRAWING

SHEET 1 OF 1

FULL RISE ELECTRONIC CO., LTD

TITLE
11.5mm SIDE PCB JACK 6P

DRAWING NO. GF53022-LC

REV SIZE REV
A3 4

DO NOT SCALE DRAWING

SHEET 1 OF 1

DATE: 10/17/05

DATE: 1/21/05

DATE: 7/19/06

DATE: 10/26/08

MATERIAL OF HS'G :

- 0G-PBT BK.
- 4G-FR50 BK
- △ AG-PBT+30% G.F. WHITE (PBT NATURAL COLOR)
- △ AG-PBT+30% G.F. PANTON RED 186C
- △ BG-PBT+30% G.F. PANTON GREEN 7479C
- △ EH-PBT+30% G.F. PANTON YELLOW 114C

1- 3u" 2- 6u" 3-15u"

2- 2C

4- 30u" 5-50u"

6- 6C

7

8

X-ON Electronics

Largest Supplier of Electrical and Electronic Components

Click to view similar products for [Modular Connectors](#) / [Ethernet Connectors](#) category:

Click to view products by [Pulse](#) manufacturer:

Other Similar products are found below :

[8949-H88/06BLKA/SN](#) [74441-0010/BKN](#) [MP1010RX-1000](#) [MP44RX-1000](#) [PHJ-4P4C-1-V-4](#) [PHP-6P6C-5](#) [GAX-3-66](#) [GAX-8-62](#) [GDCX-PA-66-50](#) [GDCX-PN-64](#) [GDCX-PN-66](#) [GDCX-PN-66-50](#) [GDLX-A-66](#) [GDLX-N-66](#) [GDLX-S-66](#) [GDLX-S-88K](#) [GDLX-SMT-S-88](#) [GDTX-S-88-50](#) [GDX-PA-1010](#) [GLX-N-1010M-BLK](#) [GLX-S-88M-BLK](#) [GMX-N-1010](#) [GMX-S-1010](#) [GMX-S-66](#) [GMX-SMT4-N-88](#) [GPX-2-64](#) [GSGX-N-2-88](#) [GSGX-N-4-88](#) [GSX-NS2-88-3.05](#) [GSX-NS2-88-3.05-50](#) [GSX-NS-88-3.05-50](#) [PT-108A-8C-UL](#) [PT-J951-8C](#) [PTS-J531-8CS-50UL](#) [1-1775629-2](#) [A-2014-0-4](#) [GWLX-S-88-GR](#) [GWLX-S9-88-YG](#) [DC-1021-8-WH-6](#) [1300530003](#) [1324640-4](#) [RJ11FTVC2G](#) [RJ11FTVC2N](#) [RJFTVX2SA1G](#) [132764-001](#) [1413235](#) [MP88X-1000](#) [MPS88RX-5000](#) [E5288-S000K3-L](#) [E5908-15A242-L](#)