

Qty per:		Tray	45
		Carton	900
PART NUMBER : SFP CAGE011-L			
No.	DESCRIPTION	Q'ty	MATERIAL
01	CAGE TOP	1	COPPER ALLOY Nickel
02	CAGE BOTTOM	1	COPPER ALLOY Nickel

DETAILED LISTS	
MM	0.0 ± 0.2
MM	0.00 ± 0.15
MM	0.00 ± 0.075
ANGLES ± 0.5	
THIRD ANGLE PROJECTION	

TITLE		SFP+ CAGE 1 BY 1, PRESS-FIT, FOR PCI	
DFTO		Peter	
DRAWING NO.		SFP CAGE011-L	
/PART NO.			
DATE		07/22/08	
SCALE		1:1	
DO NOT SCALE DRAWING			
SHEET		1 OF 2	
REV	SIZE		
R9	A3		



RoHS Compliant

TABS USED TO MOUNT LIGHT PIPE

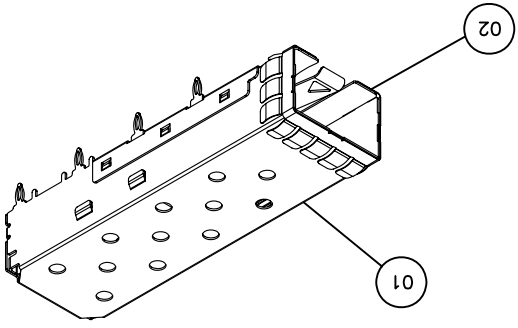
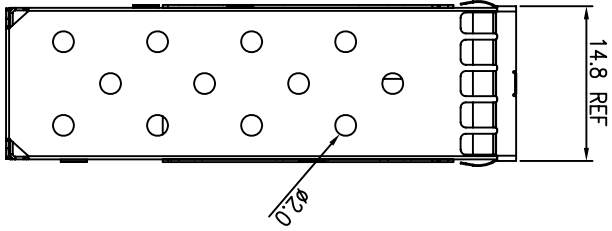
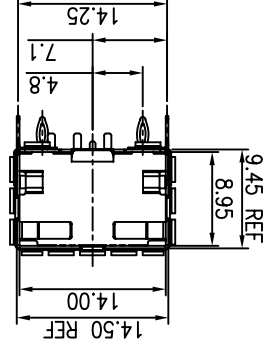
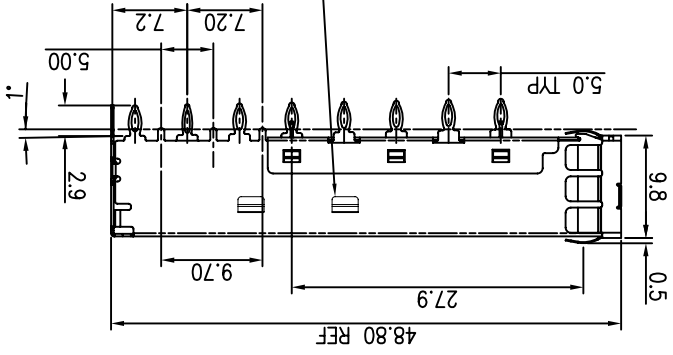

A
B
C
D
E
F
G
H

DETAILED LISTS

THIRD ANGLE PROJECTION	
SCALE : 1:1	
DATE 07/22/08	
DFTO Peter	
DRAWING NO. SFP+CGE011-L	
/PART NO.	
DO NOT SCALE DRAWING	
SHEET 2 OF 2	
REV R9	
SIZE A3	
REV R9	
TOLERANCES EXCEPT AS NOTED	
(INCH)	
MM	
MM	
±	0.2
±	0.15
±	0.075
±	0.5



RoHS Compliant

SFP+ CAGE 1 BY 1, PRESS-FIT, FOR PCI

TITLE

PCB LAYOUT THICKNESS=3.0mm (TOP VIEW)

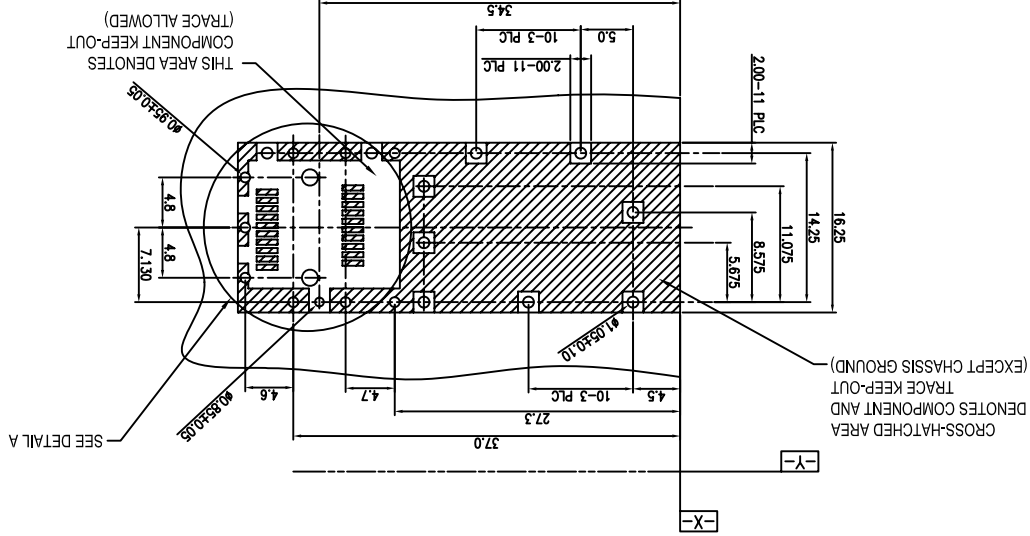

DETAIL A
SCALE 2:1

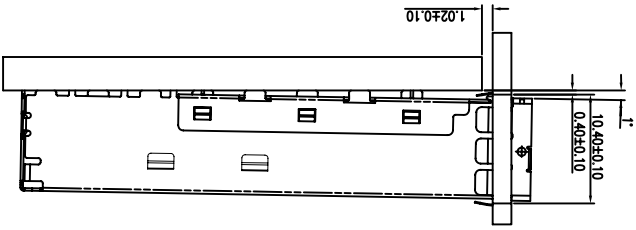
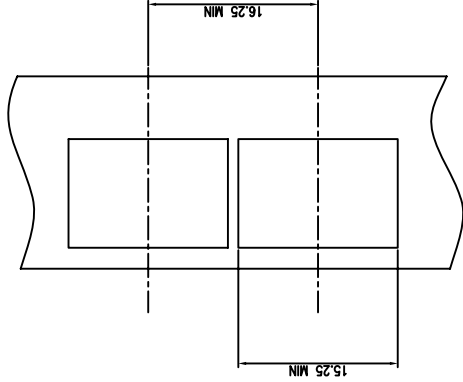
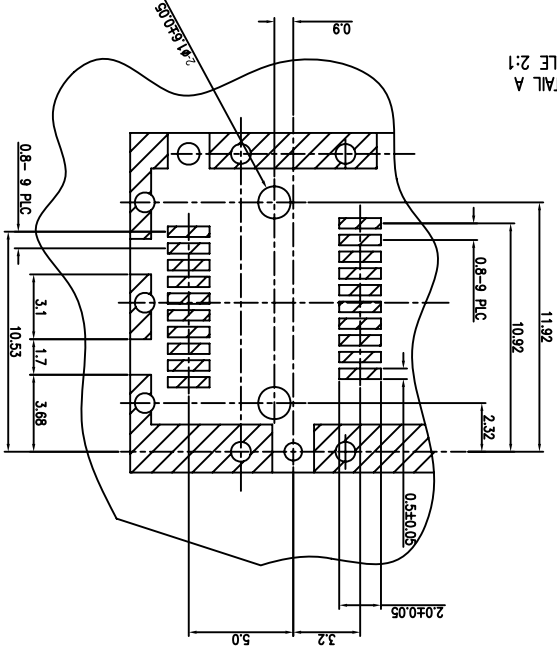

A

B

C

D

F

F

G

H

X-ON Electronics

Largest Supplier of Electrical and Electronic Components

Click to view similar products for [Modular Connectors](#) / [Ethernet Connectors](#) category:

Click to view products by [Pulse manufacturer](#):

Other Similar products are found below :

[RJE231881317T](#) [MP1010RX-1000](#) [MP44RX-1000](#) [GAX-3-66](#) [GAX-8-62](#) [93606-0253](#) [GD-A-44](#) [GDCX-PA-66-50](#) [GDCX-PN-64](#) [GDCX-PN-66](#) [GDCX-PN-66-50](#) [GDLX-A-66](#) [GDLX-A-88](#) [GDLX-N-66](#) [GDLX-S-88K](#) [GDTX-S-88-50](#) [GDX-PA-1010](#) [GLX-N-1010M-BLK](#) [GLX-N-44M](#) [GLX-S-88M-BLK](#) [GMX-N-1010](#) [GMX-S-1010](#) [GMX-S-66](#) [GMX-SMT2-N-1010](#) [GMX-SMT2-N-64-50](#) [GMX-SMT2-S6-88](#) [GMX-SMT4-N-88](#) [GPX-2-64](#) [GRT1-BT1-5](#) [GSGX-N-2-88](#) [GSX-NS2-88-3.05](#) [GSX-NS2-88-3.05-50](#) [GSX-NS-88-3.05-30](#) [GSX-NS-88-3.05-50](#) [GSX-NS-88-3.68](#) [1-1775629-2](#) [GWLX-S-88-GR](#) [GWLX-S9-88-YG](#) [1300500326](#) [1300500227](#) [1300530003](#) [1300570002](#) [1324640-4](#) [RJ11FTVC2G](#) [RJ11FTVC2N](#) [RJFTVX2SA1G](#) [132764-001](#) [1400000](#) [1413176](#) [1413235](#)