

<b>MALE-FEMALE ADAPTOR PUSH-ON</b>	<b>R125.791.501</b>
	<b>SERIES SMA</b>

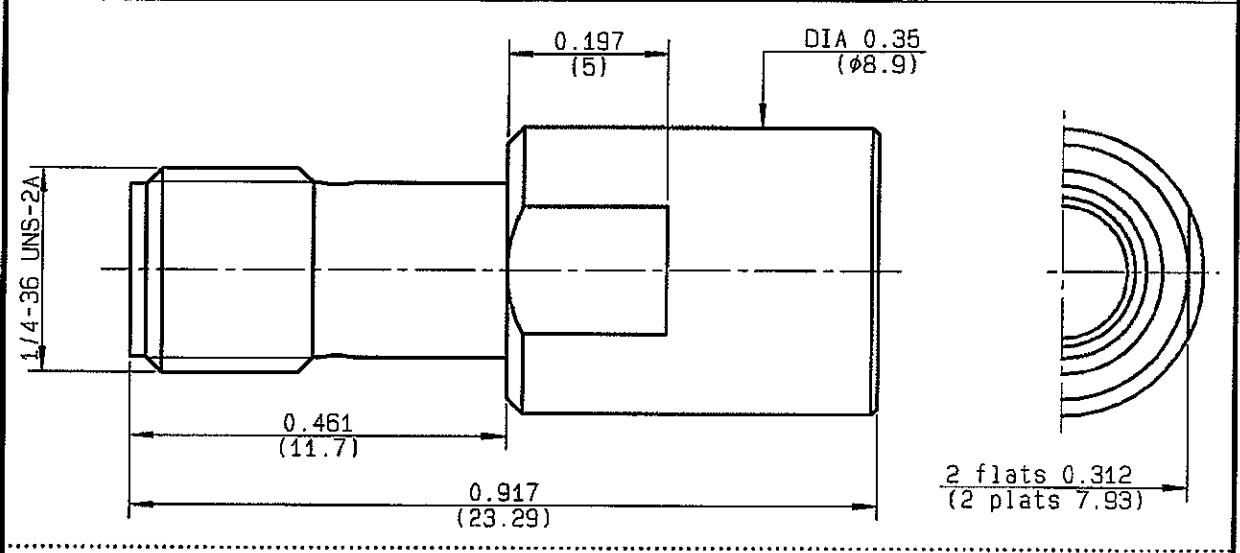

<table> <tr><td>NOMINAL IMPEDANCE</td><td><b>50</b> Ω</td></tr> <tr><td>FREQUENCY RANGE</td><td><b>0-18</b> GHz</td></tr> <tr><td>TEMPERATURE RATING</td><td><b>-65/+165</b> °C</td></tr> <tr><td>V.S.W.R</td><td><b>1.08 + 0.01</b> × F(GHz)Maxi</td></tr> <tr><td>RF INSERTION LOSS</td><td><b>0.07</b> √F(GHz) dB Maxi</td></tr> <tr><td>VOLTAGE RATING</td><td><b>500</b> Veff Maxi</td></tr> <tr><td>DIELECTRIC WITHSTANDING VOLTAGE</td><td><b>1000</b> Veff Mini</td></tr> <tr><td>INSULATION RESISTANCE</td><td><b>5000</b> M ΩMini</td></tr> <tr><td>HERMETIC SEAL</td><td><b>NA</b> Atm.cm<sup>3</sup>/s</td></tr> <tr><td>LEAKAGE (pressurized only)</td><td><b>NA</b></td></tr> <tr><td>MECHANICAL DURABILITY</td><td><b>500</b> Cycles</td></tr> <tr><td>WEIGHT</td><td>gr</td></tr> <tr><td>SPECIFICATION</td><td></td></tr> </table>	NOMINAL IMPEDANCE	<b>50</b> Ω	FREQUENCY RANGE	<b>0-18</b> GHz	TEMPERATURE RATING	<b>-65/+165</b> °C	V.S.W.R	<b>1.08 + 0.01</b> × F(GHz)Maxi	RF INSERTION LOSS	<b>0.07</b> √F(GHz) dB Maxi	VOLTAGE RATING	<b>500</b> Veff Maxi	DIELECTRIC WITHSTANDING VOLTAGE	<b>1000</b> Veff Mini	INSULATION RESISTANCE	<b>5000</b> M ΩMini	HERMETIC SEAL	<b>NA</b> Atm.cm <sup>3</sup> /s	LEAKAGE (pressurized only)	<b>NA</b>	MECHANICAL DURABILITY	<b>500</b> Cycles	WEIGHT	gr	SPECIFICATION		<table> <tr><td>CABLES :</td><td></td></tr> <tr><td>OTHERS CHARACTERISTICS</td><td></td></tr> <tr><td>CABLE RETENTION</td><td><b>NA</b> N Mini</td></tr> <tr><td>CENTER CONTACT RETENTION</td><td></td></tr> <tr><td>    Axial force - mating end</td><td><b>27</b> N Mini</td></tr> <tr><td>    Axial force - opposite end</td><td><b>27</b> N Mini</td></tr> <tr><td>    Torque</td><td><b>2.8</b> cm.N Mini</td></tr> <tr><td>RECOMMENDED TORQUES</td><td></td></tr> <tr><td>    Mating</td><td><b>NA</b> cm.N</td></tr> <tr><td>    Panel nut</td><td><b>NA</b> cm.N</td></tr> <tr><td>    Clamp nut</td><td><b>NA</b> cm.N</td></tr> </table>	CABLES :		OTHERS CHARACTERISTICS		CABLE RETENTION	<b>NA</b> N Mini	CENTER CONTACT RETENTION		Axial force - mating end	<b>27</b> N Mini	Axial force - opposite end	<b>27</b> N Mini	Torque	<b>2.8</b> cm.N Mini	RECOMMENDED TORQUES		Mating	<b>NA</b> cm.N	Panel nut	<b>NA</b> cm.N	Clamp nut	<b>NA</b> cm.N
NOMINAL IMPEDANCE	<b>50</b> Ω																																																
FREQUENCY RANGE	<b>0-18</b> GHz																																																
TEMPERATURE RATING	<b>-65/+165</b> °C																																																
V.S.W.R	<b>1.08 + 0.01</b> × F(GHz)Maxi																																																
RF INSERTION LOSS	<b>0.07</b> √F(GHz) dB Maxi																																																
VOLTAGE RATING	<b>500</b> Veff Maxi																																																
DIELECTRIC WITHSTANDING VOLTAGE	<b>1000</b> Veff Mini																																																
INSULATION RESISTANCE	<b>5000</b> M ΩMini																																																
HERMETIC SEAL	<b>NA</b> Atm.cm <sup>3</sup> /s																																																
LEAKAGE (pressurized only)	<b>NA</b>																																																
MECHANICAL DURABILITY	<b>500</b> Cycles																																																
WEIGHT	gr																																																
SPECIFICATION																																																	
CABLES :																																																	
OTHERS CHARACTERISTICS																																																	
CABLE RETENTION	<b>NA</b> N Mini																																																
CENTER CONTACT RETENTION																																																	
Axial force - mating end	<b>27</b> N Mini																																																
Axial force - opposite end	<b>27</b> N Mini																																																
Torque	<b>2.8</b> cm.N Mini																																																
RECOMMENDED TORQUES																																																	
Mating	<b>NA</b> cm.N																																																
Panel nut	<b>NA</b> cm.N																																																
Clamp nut	<b>NA</b> cm.N																																																

CONNECTOR PARTS:	MATERIALS	FINISH	(all values are given in micrometers)
BODY	STAINLESS STEEL	PASSIVATED .	
OUTER CONTACT	BERYLLIUM COPPER	NICKEL 2	
CENTER CONTACT	BERYLLIUM COPPER	GOLD 2.54 OVER NICKEL 2	
INSULATOR	PTFE	-	
GASKET		-	
OTHERS PIECES			

<b>ISSUE</b> 0549 C	<b>CREATION DATE</b> 12/04/1994	<b>FILE PART-NUMBER</b> 94-0400-052	
------------------------	------------------------------------	--	--

The information given here is subject to change without notice. Design changes may be in order to improve the product.

*Connect to the future*

MASTRAND

## X-ON Electronics

Largest Supplier of Electrical and Electronic Components

*Click to view similar products for [RF Adapters - In Series category:](#)*

*Click to view products by [Radiall manufacturer:](#)*

Other Similar products are found below :

[5916-1103-603](#) [5919-1503-000](#) [5919-9503-000](#) [651A505](#) [82-5552](#) [9030-9523-502](#) [PN2C](#) [A0407000](#) [R114703000W](#) [R125771001](#)  
[R127871001](#) [R141710000W](#) [R141723161](#) [R141730000](#) [R143730700](#) [R143770000](#) [R161703000W](#) [R161753000W](#) [R161791530W](#)  
[R201705000](#) [R222705200](#) [R222M40010W](#) [R222M40050](#) [R223703180](#) [R316754000](#) [R405006000](#) [R443162000](#) [AD78TL](#) [HRM-513S](#)  
[1996352-2](#) [2157155-1](#) [252169-75](#) [AD158](#) [2101130-1](#) [252186](#) [R114704000W](#) [R114720000W](#) [R125705001](#) [R125705701](#) [R125771000](#)  
[R125771001W](#) [R127704001](#) [R127.870.001](#) [R127872001](#) [R141717000](#) [R142710000](#) [R142723000](#) [R143703000](#) [R143704000](#) [R143705700](#)