

N 50 Ω

PLUGS

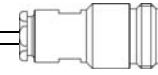

STRAIGHT PLUGS, FULL CRIMP TYPE, FOR FLEXIBLE CABLES (single piece body)

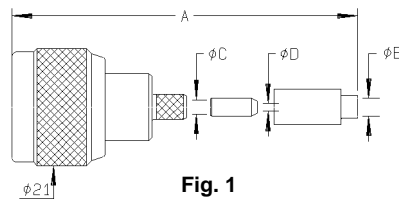
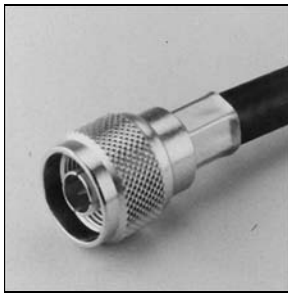

Fig. 1

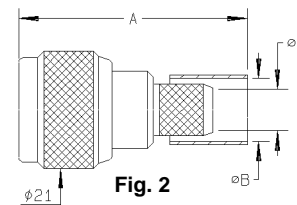

Fig. 2

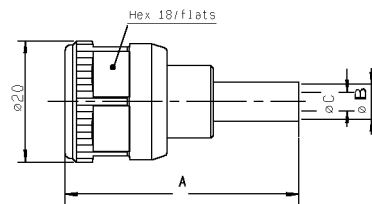

Fig. 3

Cable group	Part number	Fig.	Dimensions (mm)				Captured center contact	Assembly instructions	Note
			A	B	C	D			
2.6 / 50 / S+D	R161 072 000	1	39.7	3.25	3.38	1.63	yes	M09	
5 / 50 / S	R161 082 000	2	38.5	5.41	3.11		yes	M12	
5 / 50 / D	R161 083 000	2	38.5	5.8	3.11		yes	M12	
5 / 50 / D	R161 083 137	3	38.5	5.8	3.11		yes	M11	For intermodulation application / tool
10 / 50 / S	R161 075 000	2	40.2	11.05	7.46		yes	M10	
10.3 / 50 / S	R161 075 060	2	40.2	11.05	7.46		yes	M10	LMR 400 cable
10.3 / 50 / D	R161 076 000	2	40.2	11.4	6.4		yes	M10	ETHERNET cable
11 / 50 / D	R161 088 000	2	40.2	11.4	7.46		yes	M10	
11 / 50 / D	R161 088 137	3						M11	For intermodulation application / tool

STRAIGHT PLUGS, CLAMP TYPE, FOR FLEXIBLE CABLES

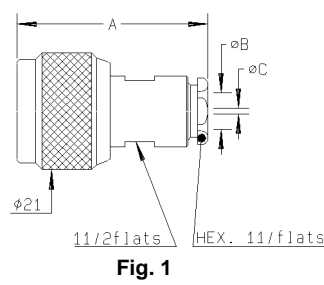

Fig. 1

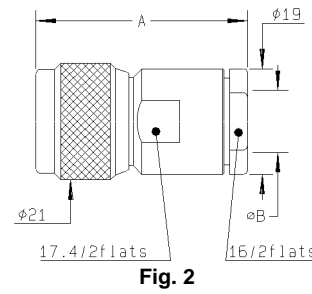

Fig. 2

Cable group	Part number	Fig.	Dimensions (mm)			Captured center contact	Assembly instructions
			A	B	C		
2.6 / 50 / S + D	R161 004 000	1	33.9	3.1	1.7	yes	M01
5 / 50 / S + D	R161 006 000	1	34.4	5.6		no	M02
5 / 50 / S + D	R161 010 000	1	34.9	5.6		yes	M03
10 + 11 / 50 / S + D	R161 020 000	2	38.1	11.2		no	M04
10 + 11 / 50 / S + D	R161 022 000	2	38.9	11.2		yes	M05

X-ON Electronics

Largest Supplier of Electrical and Electronic Components

Click to view similar products for [RF Connectors / Coaxial Connectors](#) category:

Click to view products by [Radiall](#) manufacturer:

Other Similar products are found below :

[8915-1511-000](#) [89674-0827](#) [6001-7071-019](#) [6002-7051-003](#) [6002-7551-202](#) [6059674-1](#) [619550-1](#) [630059-000](#) [M39030/3-01N](#) [M3933/25-36N](#) [6500-7071-046](#) [6769](#) [CX050L2AQ](#) [7002-1542-011](#) [7002-1572-002](#) [7004-1512-000](#) [7009-1511-004](#) [7010-1511-000](#) [7029-1511-060](#) [7101-1541-010](#) [7101-1571-002](#) [7105-1521-002](#) [7145-1521-002](#) [7203-1571-003](#) [7209-1511-011](#) [7210-1511-015](#) [7210-1511-019](#) [73137-5015](#) [73216-2241](#) [7325-1512-000](#) [73404-2300](#) [7405-1521-005](#) [7405-1521-802](#) [7406-1521-005](#) [8527](#) [8547](#) [FS11V](#) [8808-1511-001](#) [9049-9513-000](#) [9074-9513-000](#) [9101-9573-002](#) [910A205F](#) [9130-9573-002](#) [PL11SC-026](#) [PL375-33](#) [PL40-5](#) [PL71-9](#) [PL74C-221](#) [PL75MC-217](#) [PL803-7](#)